

50 HUDSON STREET

TRIBECA | NEW YORK CITY

Prime Tribeca Corner Retail Opportunity

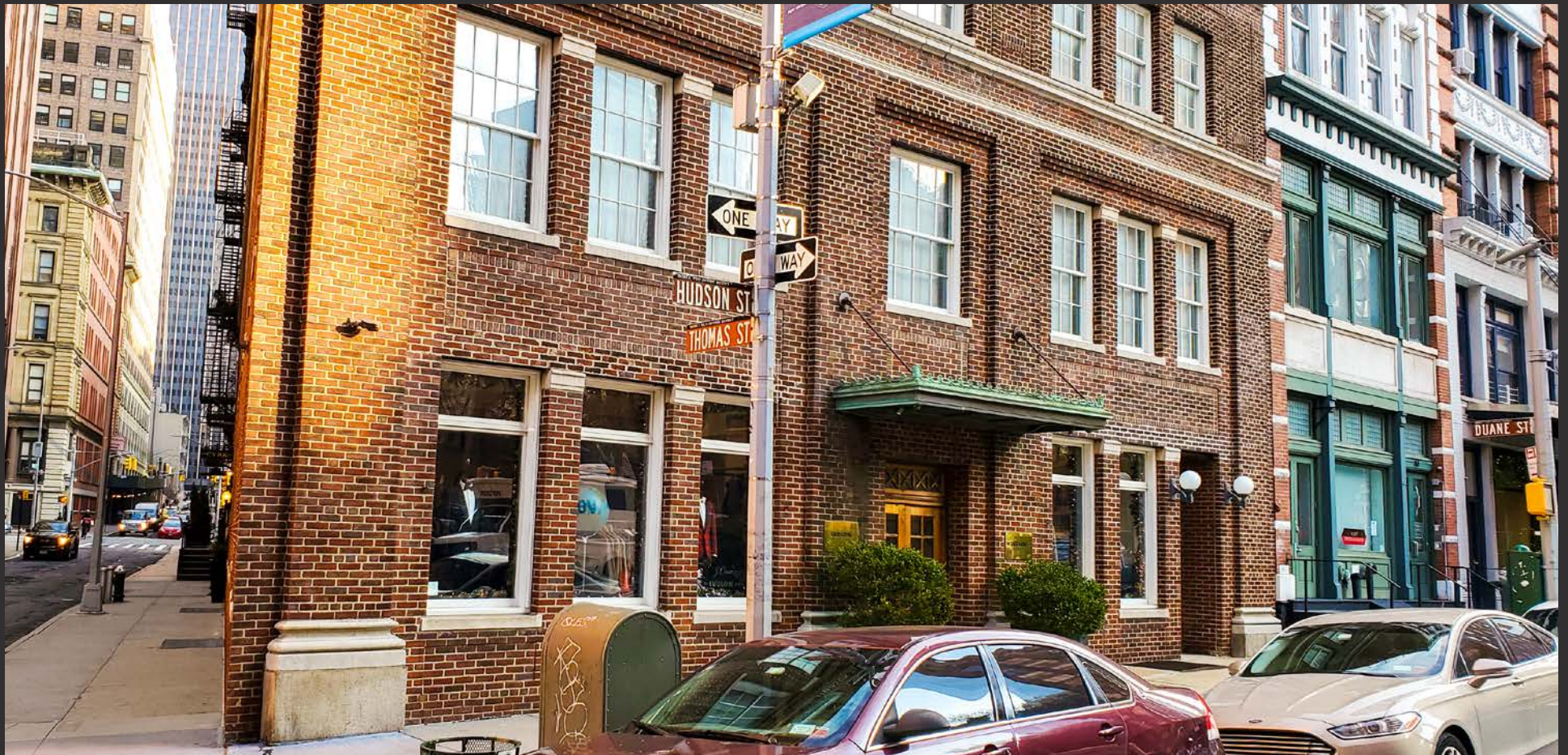
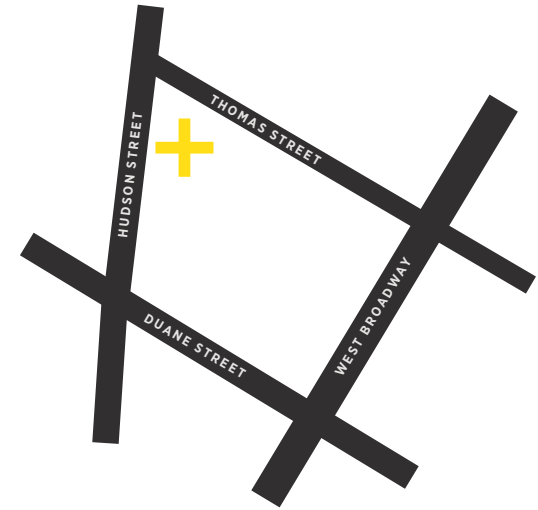

In the heart of Tribeca's
most established and
sought-after corridor



107 FT

OF WRAPAROUND
FRONTAGE
ON THOMAS AND
HUDSON STREETS

Once-in-a-generation
opportunity



Architecturally significant
building and space with
a grand entry canopy

2,100 SF

OF GROUND
FLOOR RETAIL
SPACE



TWO BLOCKS FROM
TRANSPORTATION INCLUDING

A look at the details

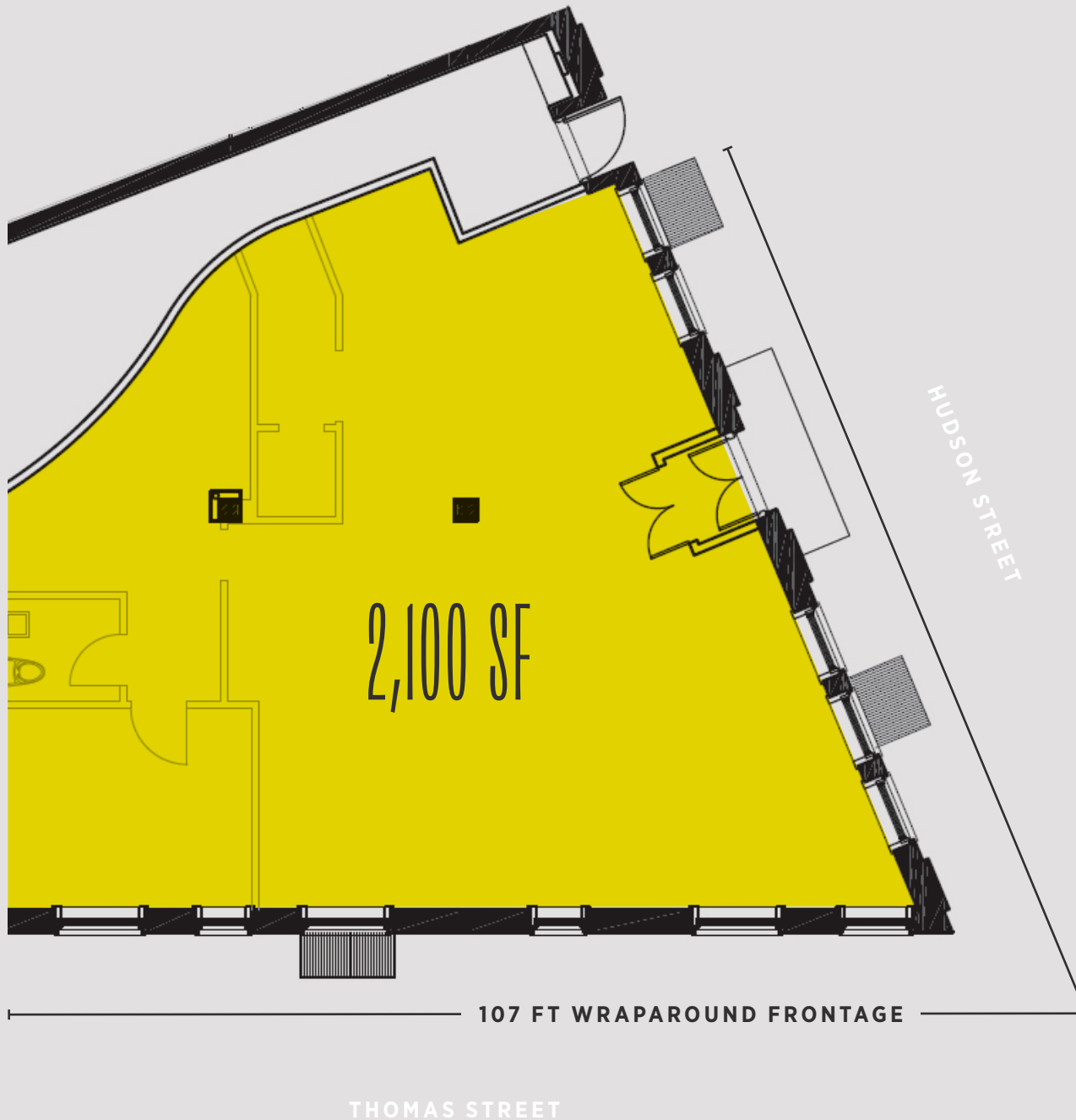

LOCATION

SOUTHEAST CORNER
OF THOMAS STREET

APPROXIMATE SIZE

GROUND FLOOR 2,100 SF

POSSESSION

ARRANGED

FRONTAGE

107 FT OF WRAPAROUND
FRONTAGE

SITE STATUS

CURRENTLY J.CREW
THE LUDLOW SHOP



Tribeca

WHERE RESIDENTIAL, RETAIL
AND LIFESTYLE CONVERGE



Welcome to the neighborhood

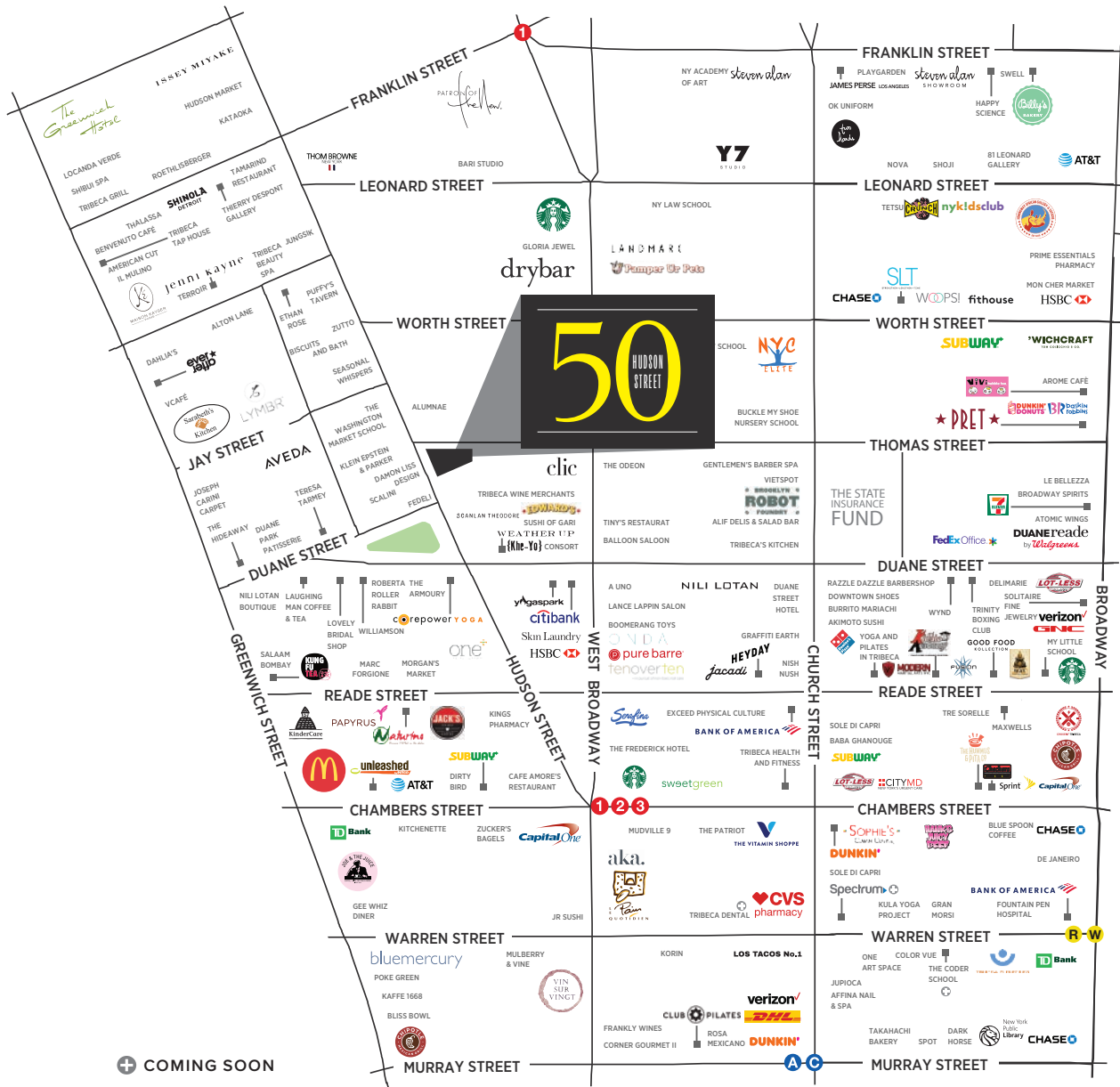

NEIGHBORING RETAILERS INCLUDE

NILI LOTAN, SCANLAN THEODORE, ALUMNAE, JENNI KAYNE, CLIC GALLERY, LAUGHING MAN COFFEE & TEA, THE ARMOURY, KLEIN EPSTEIN & PARKER, FLORAVERE, MARC FORGIONE, SARABETH'S, JACADI, CYNTHIA ROWLEY, LOVELY BRIDAL AND HEYDAY.

CONTACT

ANDREW STERN

212.351.9353

ANDREW.STERN@NGKF.COM



NGKF.COM

© 2020 NEWMARK KNIGHT FRANK RETAIL. The information contained herein has been obtained from sources deemed reliable but has not been verified and no guarantee, warranty or representation, either express or implied, is made with respect to such information.

Terms of sale or lease and availability are subject to change or withdrawal without notice.