



STIRLING



Lot 16
OCEAN RANCH CORPORATE CENTRE
Oceanside, California 92056

BUILD-TO-SUIT OPPORTUNITY

29,000 - 250,000 SQUARE FEET

Proposed Plans

- ▶ Plan A
 - Building A: 116,650 Square Feet
 - Building B: 130,050 Square Feet
- ▶ Plan B
 - Building A: 60,500 Square Feet
 - Building B: 72,120 Square Feet
 - Building C: 29,000 Square Feet
 - Building D: 32,800 Square Feet
- ▶ Plan C/D
 - Building A: 203,000 Square Feet
- ▶ Plan E
 - Building A: 250,000 Square Feet

* Site plans on subsequent pages
** All plans are divisible



Highlights

- Located in a 400 acre master-planned business park
- Hamann Companies has completed 90% of all build-to-suits in Ocean Ranch Corporate Centre
- Ten (10) build-to-suits completed (785,000 square feet)
- Near new hotels, retail, medical offices and office developments
- Corporate neighbors include Genentech, Coca Cola, Amerillum Brands and OneSource Distribution
- Easy access to Interstate 5, Highway 76 and Highway 78

FOR MORE INFORMATION, PLEASE CONTACT:

DAVID ONOSKO

Senior Director

(760) 517-5869

david.onosko@cushwake.com

CA License #: 01062746

RONALD L. KING, SIOR

Senior Director

(760) 517-5830

ron.king@cushwake.com

CA License #: 00868661

CUSHMAN & WAKEFIELD OF SAN DIEGO, INC

5800 Armada Drive, Suite 101

Carlsbad, CA 92008

(760) 602-4800

cushmanwakefield.com

CA License No: 01329963



The depiction in the included photograph of any person, entity, sign, logo or property, other than Cushman & Wakefield's (C&W) client and the property offered by C&W, is incidental only, and is not intended to connote any affiliation, connection, association, sponsorship or approval by or between that which is incidentally depicted and C&W or its client.

This listing shall not be deemed an offer to lease, sublease or sell such property, and, in the event of any transaction for such property, no commission shall be earned by or payable to any cooperating broker except if otherwise provided pursuant to the express terms, rates and conditions of C&W's agreement with its principal, if, as and when such commission (if any) is actually received from such principal. (A copy of the rates and conditions referred to above with respect to this property is available upon request.)



Potential Building Plans

Lot 16
OCEAN RANCH CORPORATE CENTRE
Oceanside, California 92056

Preliminary Site Plan A

- ▶ Building A: 116,650 Square Feet
- ▶ Building B: 130,050 Square Feet
- TOTAL AREA: 246,700
- ▶ Parking: 421 Spaces : 1.71 / 1,000

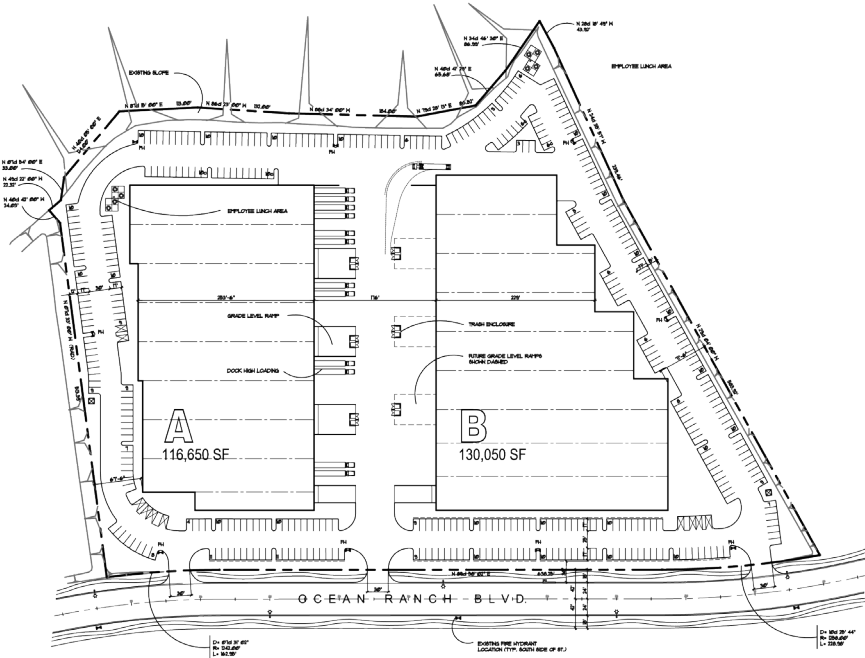

Preliminary Site Plan B

- ▶ Building A: 60,500 Square Feet
- ▶ Building B: 72,120 Square Feet
- ▶ Building C: 29,000 Square Feet
- ▶ Building D: 32,800 Square Feet
- TOTAL AREA: 194,420
- ▶ Parking: 464 Spaces : 2.39 / 1,000

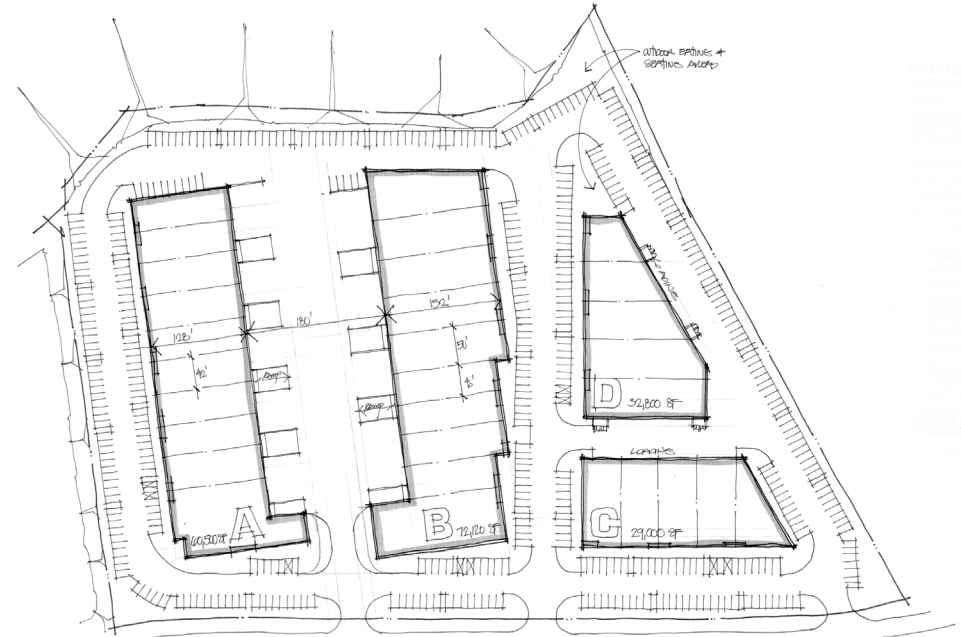

FOR MORE INFORMATION, PLEASE CONTACT:
DAVID ONOSKO **RONALD L. KING, SIOR**
 Senior Director Senior Director
 (760) 517-5869 (760) 517-5830
 david.onosko@cushwake.com ron.king@cushwake.com
 CA License #: 01062746 CA License #: 00868661

CUSHMAN & WAKEFIELD OF SAN DIEGO, INC
 5800 Armada Drive, Suite 101
 Carlsbad, CA 92008
 (760) 602-4800
 cushmanwakefield.com
 CA License No: 01329963



The depiction in the included photograph of any person, entity, sign, logo or property, other than Cushman & Wakefield's (C&W) client and the property offered by C&W, is incidental only, and is not intended to connote any affiliation, connection, association, sponsorship or approval by or between that which is incidentally depicted and C&W or its client.
 This listing shall not be deemed an offer to lease, sublease or sell such property, and, in the event of any transaction for such property, no commission shall be earned by or payable to any cooperating broker except if otherwise provided pursuant to the express terms, rates and conditions of C&W's agreement with its principal, if, as and when such commission (if any) is actually received from such principal. (A copy of the rates and conditions referred to above with respect to this property is available upon request.)



Potential Building Plans

Lot 16 OCEAN RANCH CORPORATE CENTRE Oceanside, California 92056

Preliminary Site Plan C

- ▶ Building: 203,000 Square Feet
- ▶ Parking: 704 Spaces : 3.46 / 1,000

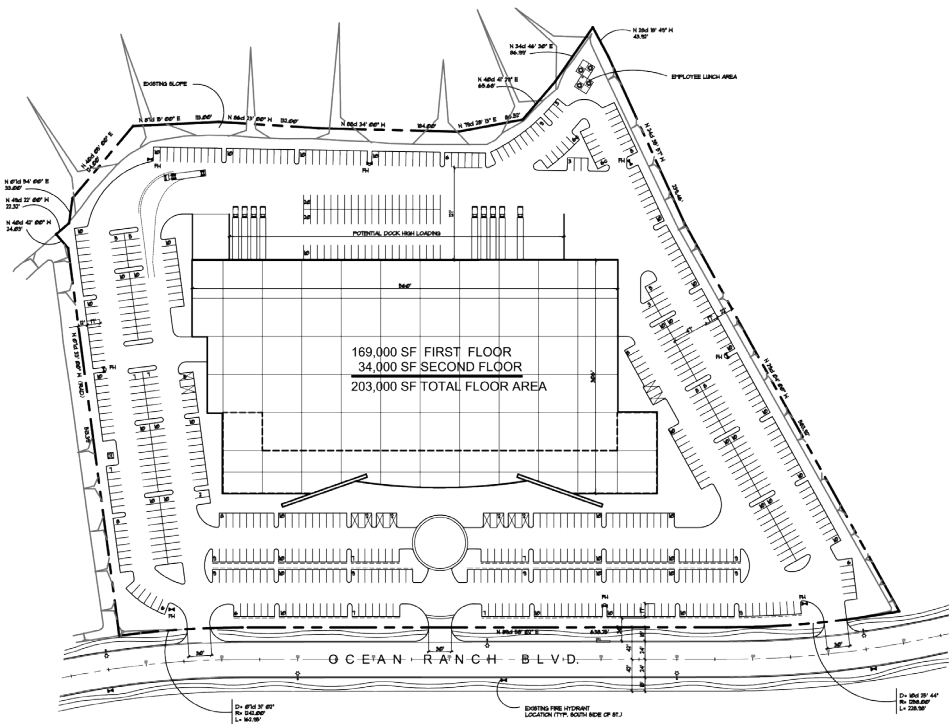

Preliminary Site Plan D

- ▶ Building: 203,000 Square Feet
- ▶ Parking: 682 Spaces : 3.32 / 1,000

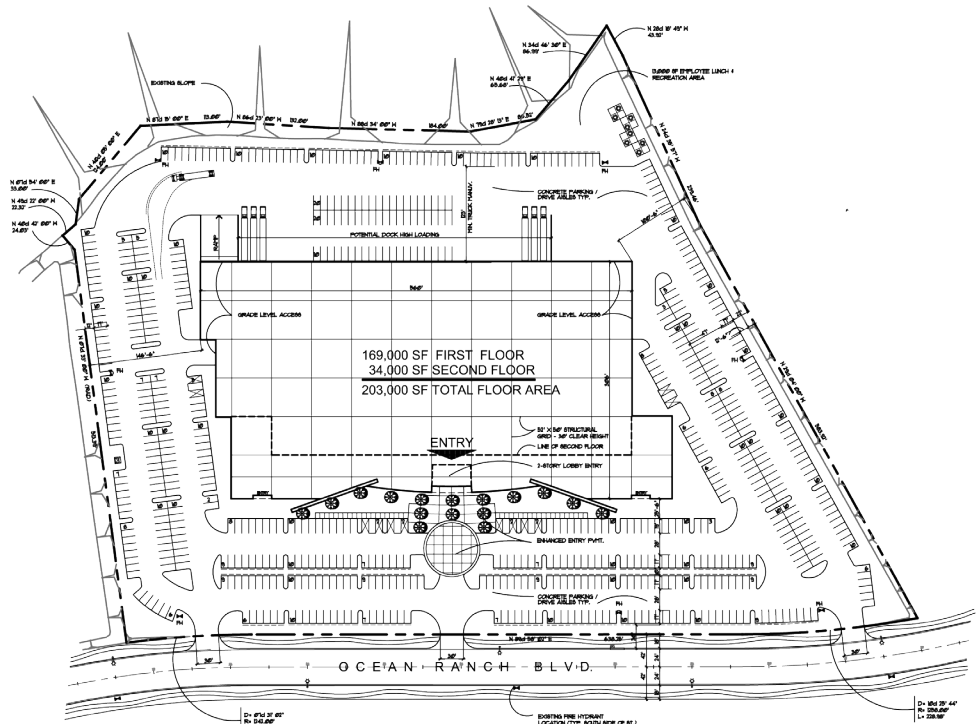

FOR MORE INFORMATION, PLEASE CONTACT:
DAVID ONOSKO **RONALD L. KING, SIOR**
 Senior Director Senior Director
 (760) 517-5869 (760) 517-5830
 david.onosko@cushwake.com ron.king@cushwake.com
 CA License #: 01062746 CA License #: 00868661

CUSHMAN & WAKEFIELD OF SAN DIEGO, INC
 5800 Armada Drive, Suite 101
 Carlsbad, CA 92008
 (760) 602-4800
 cushmanwakefield.com
 CA License No: 01329963



The depiction in the included photograph of any person, entity, sign, logo or property, other than Cushman & Wakefield's (C&W) client and the property offered by C&W, is incidental only, and is not intended to connote any affiliation, connection, association, sponsorship or approval by or between that which is incidentally depicted and C&W or its client.
 This listing shall not be deemed an offer to lease, sublease or sell such property; and, in the event of any transaction for such property, no commission shall be earned by or payable to any cooperating broker except if otherwise provided pursuant to the express terms, rates and conditions of C&W's agreement with its principal, if, as and when such commission (if any) is actually received from such principal. (A copy of the rates and conditions referred to above with respect to this property is available upon request.)



Potential Building Plans

Lot 16
OCEAN RANCH CORPORATE CENTRE
Oceanside, California 92056

Preliminary Site Plan E

- ▶ Building: 250,000 Square Feet
- ▶ Parking: 741 Spaces : 2.96 / 1,000

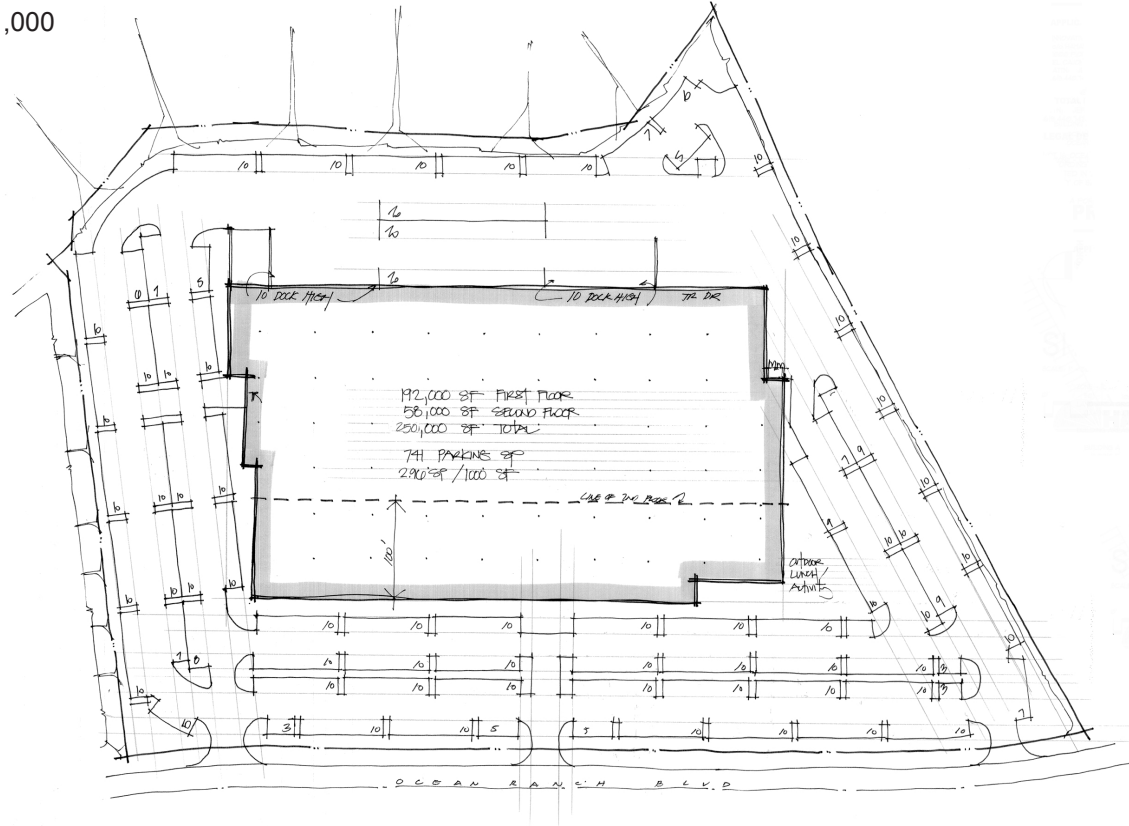

FOR MORE INFORMATION, PLEASE CONTACT:
DAVID ONOSKO
Senior Director
(760) 517-5869
david.onosko@cushwake.com
CA License #: 01062746

RONALD L. KING, SIOR
Senior Director
(760) 517-5830
ron.king@cushwake.com
CA License #: 00868661

CUSHMAN & WAKEFIELD OF SAN DIEGO, INC
5800 Armada Drive, Suite 101
Carlsbad, CA 92008
(760) 602-4800
cushmanwakefield.com
CA License No: 01329963

The depiction in the included photograph of any person, entity, sign, logo or property, other than Cushman & Wakefield's (C&W) client and the property offered by C&W, is incidental only, and is not intended to connote any affiliation, connection, association, sponsorship or approval by or between that which is incidentally depicted and C&W or its client.

This listing shall not be deemed an offer to lease, sublease or sell such property, and, in the event of any transaction for such property, no commission shall be earned by or payable to any cooperating broker except if otherwise provided pursuant to the express terms, rates and conditions of C&W's agreement with its principal, if, as and when such commission (if any) is actually received from such principal. (A copy of the rates and conditions referred to above with respect to this property is available upon request.)

