

1020 S Bellevue

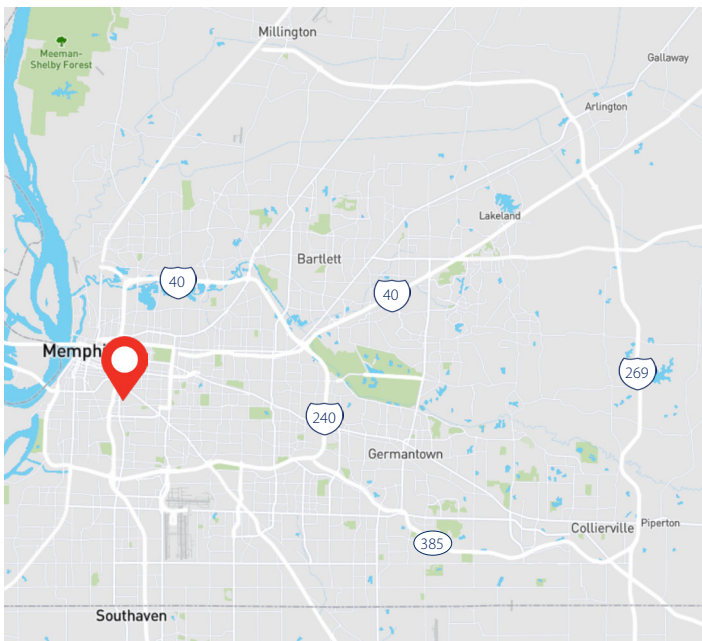

OPPORTUNITY

- Located at the corner of S Bellevue and Walker St
- Mixed-Use Redevelopment Project located at the "Gateway of Soulsville"
- Future Headquarters of the South Memphis Association
- Can provide industrial with office, flex, or retail space
- Public/private partnership with the goal to provide job growth/creation

DOCKS

- 3 Dock High Doors and 2 Grade Level Doors
- 16' Clear Height
- Two 5 ton bridge cranes
- 52,923 sf; divisible

Michael Donahoe, Vice President
D 901 231 1402
C 901 230 0601
michael.donahoe@avisonyoung.com

Paul Banks, Senior Associate
D 901 410 4525
C 901 240 5400
paul.banks@avisonyoung.com

Avison Young
5350 Poplar Avenue
Suite 205
Memphis, TN 38119

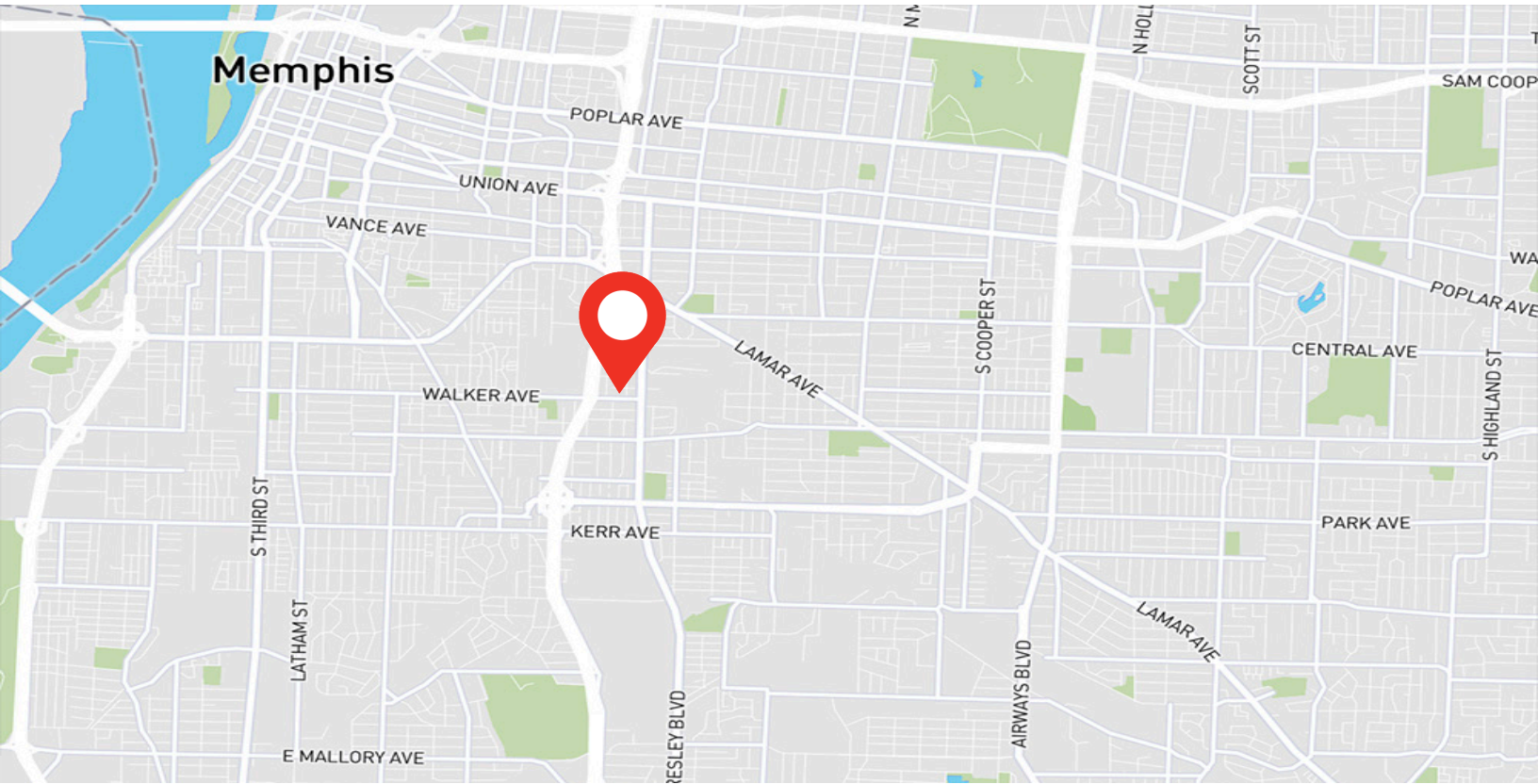

Destination	Distance
Stax Museum	0.8 Miles
Midtown	2.6 Miles
Downtown	3.1 Miles
I-240	1.0 Miles
I-40	2.3 Miles
Lamar Avenue	2.5 Miles

BUILDING PLAN

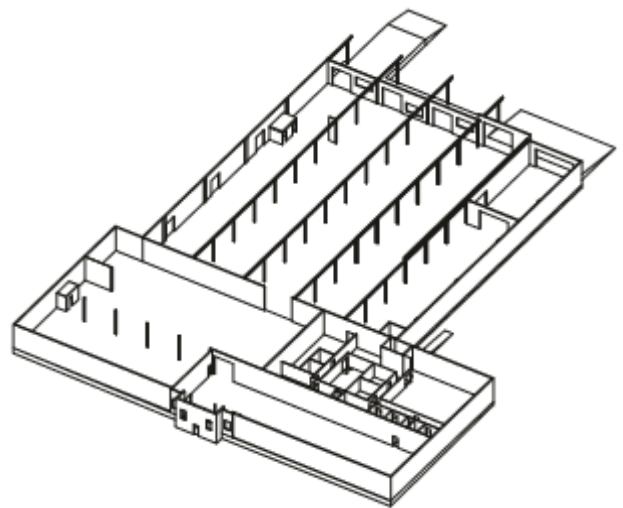

Michael Donahoe, Vice President
D 901 231 1402
C 901 230 0601
michael.donahoe@avisonyoung.com

Paul Banks, Senior Associate
D 901 410 4525
C 901 240 5400
paul.banks@avisonyoung.com