

MILPITAS TOWN CENTER

CALAVERAS BLVD. AT NORTH MILPITAS BLVD. • MILPITAS, CA



Prime Jr. Anchor Space

±12,105 SF

±2,182 SF 2nd Gen. Restaurant
& Shop Retail Available

Meacham/Oppenheimer, Inc.
8 N. San Pedro St., Suite 300
San Jose, California 95110
Tel: 408.378.5900
www.moinc.net

Ryan Warner
Lic. #01397580
rwarner@moinc.net
408.477.2505

Michael Messinger
Lic. #00879292
mike@moinc.net
408.378.5900



Highlights



- Center anchored by Safeway, Staples, 24hr Fitness and BevMo!
- Jr. Anchor space of 12,105± SF
- 2,182± SF 2ND Generation Restaurant Space
- Available Retail: 1,400± SF to 2,513± SF
- Asking \$3.00 to \$4.50 per SF, plus NNN
- Suite available for Sublease, 1,300± SF - Call for details
- Co-Tenants: Peet's Coffee, Jamba Juice, HSBC Bank, AAA, Erik's DeliCafe, and many more
- Prime location in the heart of Milpitas
- Neighboring businesses include: Johnson & Johnson, Cisco Systems, Kaiser Permanente & Milpitas City Hall.
- Traffic Count Calaveras Blvd 71,180/Day
- Traffic Count North Milpitas Blvd 25,700/Day

Site Plan



NEW
QSR
RESTAURANT
COMING

Shops Building 571 — 7,071 SF

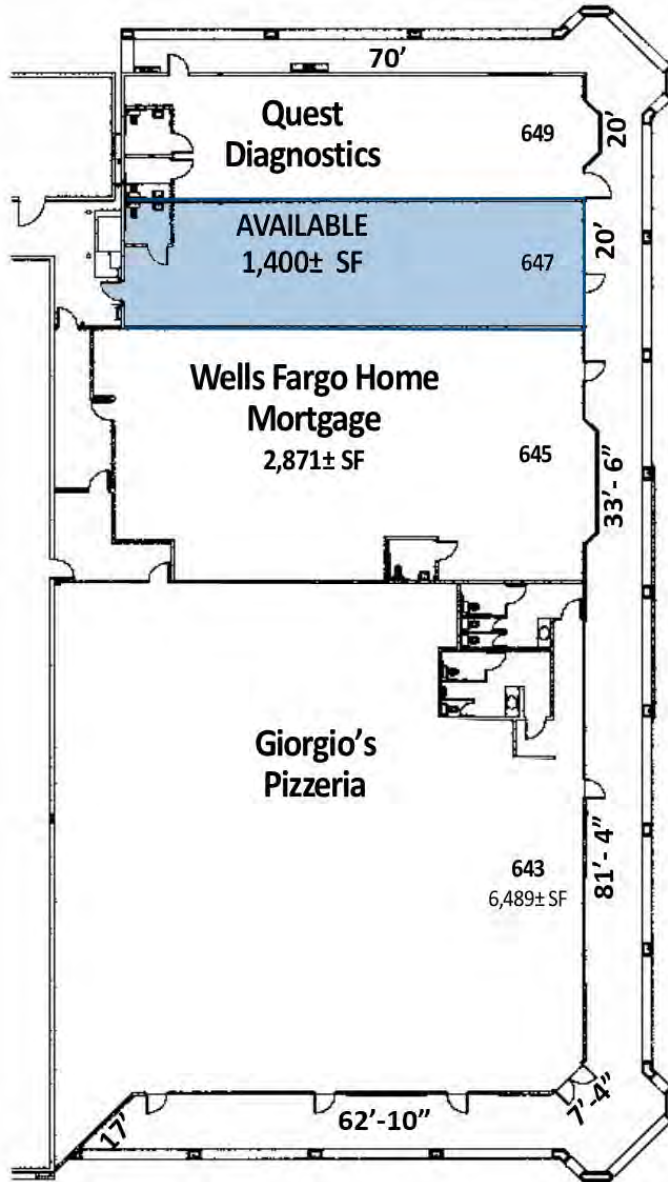

Shops Building 794 — 75,000 SF

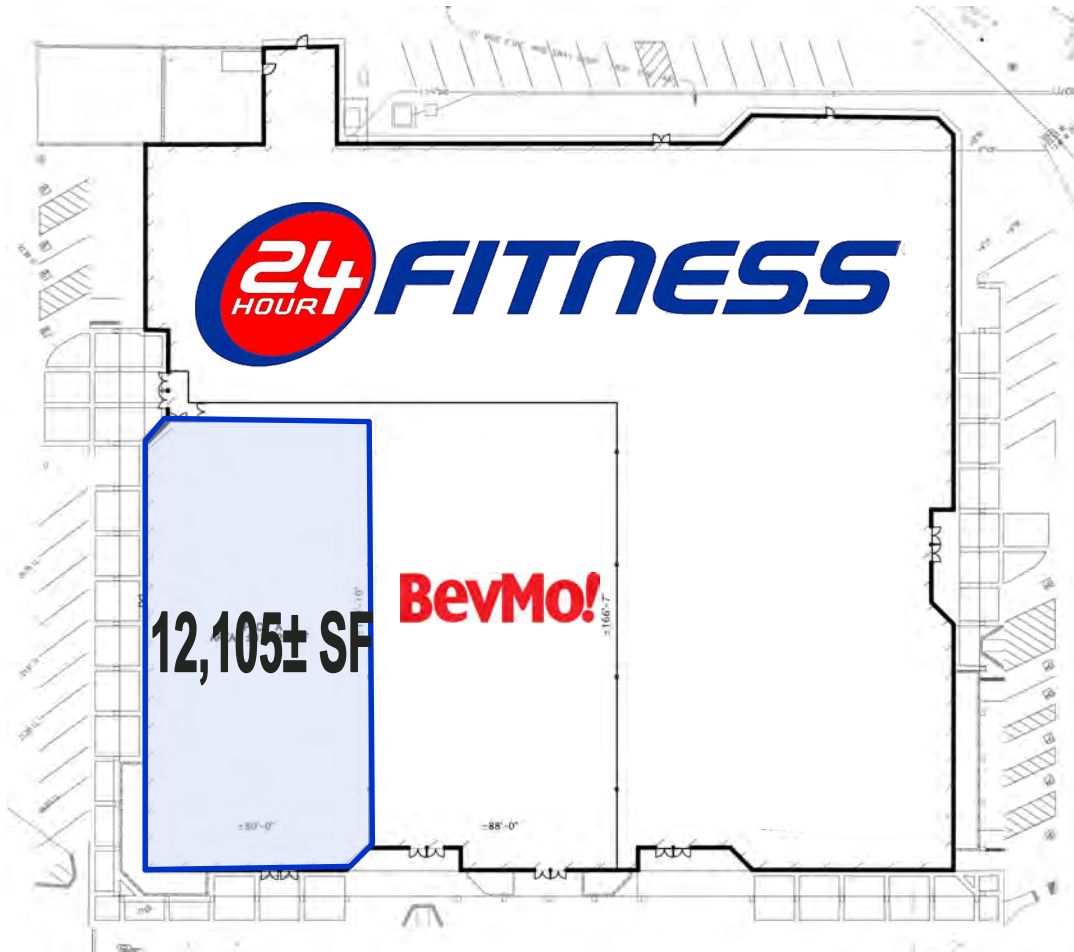

Shops Building 479 — 12,113 SF

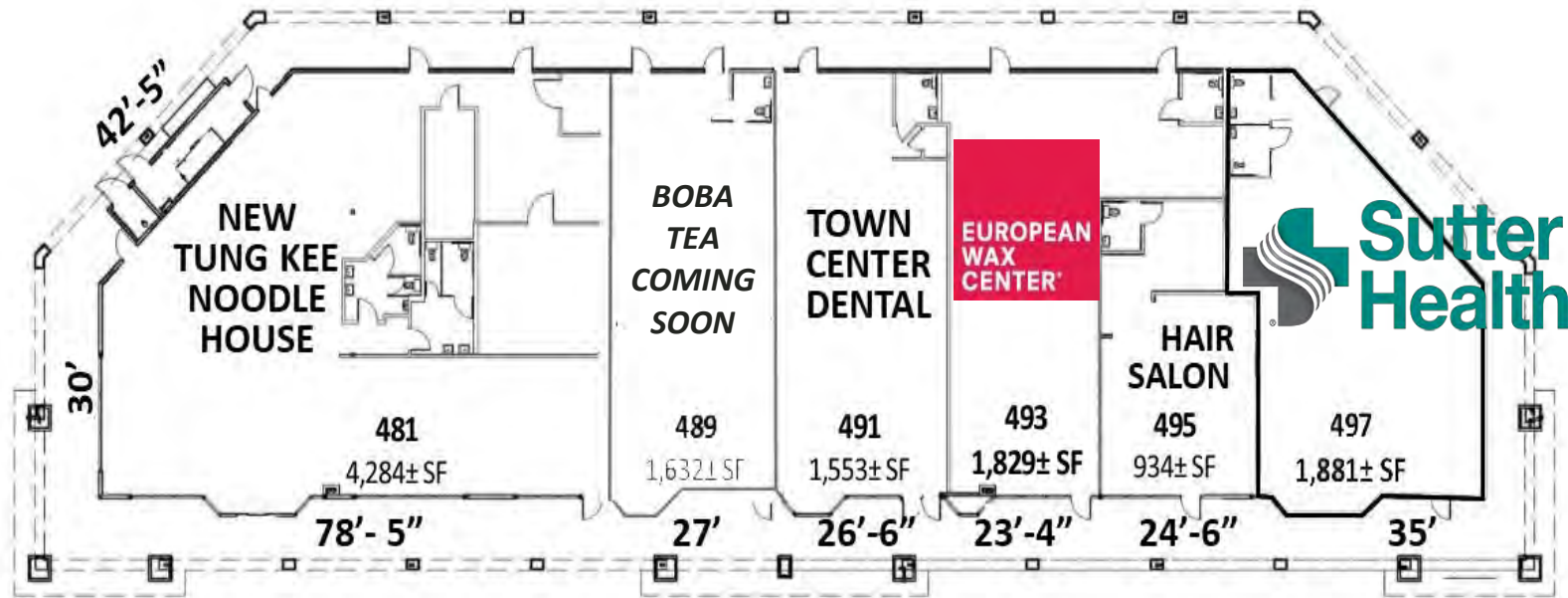

Shops Building 130 — 8,415 SF

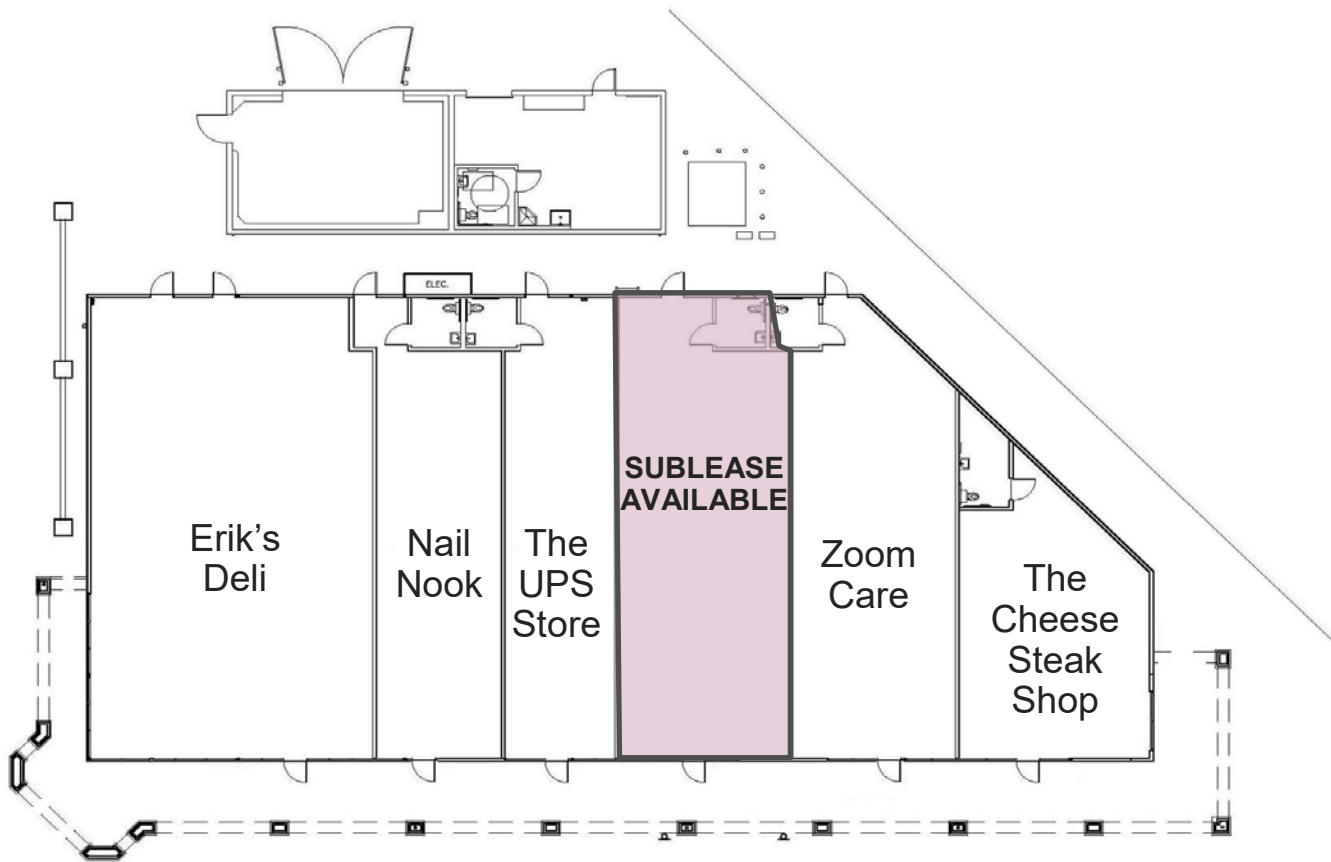

Shops Building 596-627 — 34,400 SF

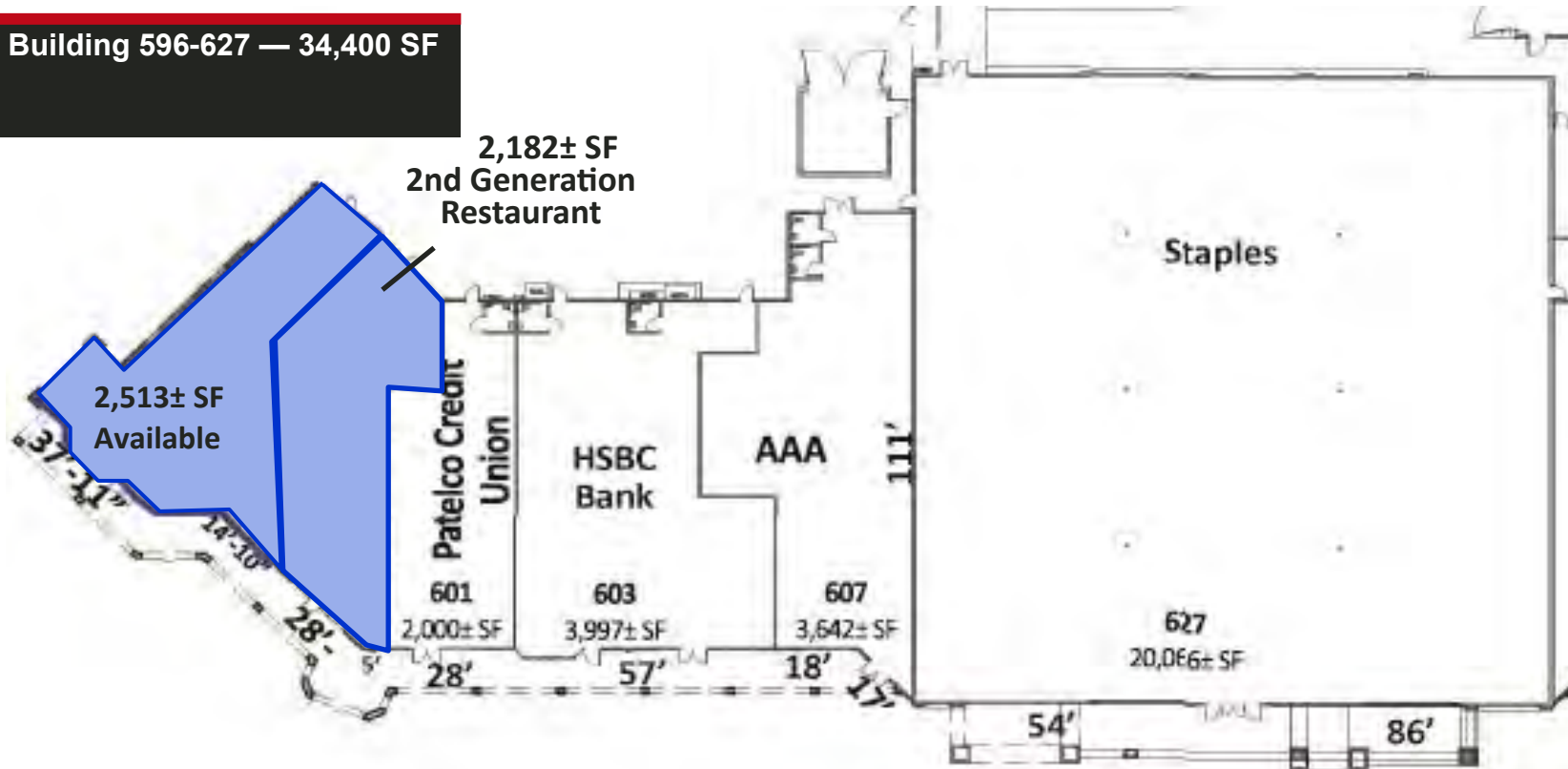



	1 Mile	3 Miles	5 Miles
Population	25,110	134,325	264,069
Average HH Income	\$158,741	\$169,784	\$169,227
Employee Population	19,115	79,800	241,660