

FOR LEASE > RETAIL SPACE

Piazza Bella Centro

12120-12160 Alta Carmel Court, San Diego, California 92128



PROPERTY DESCRIPTION

- » Superior Trade Area Demographics
- » Serves Communities of Rancho Bernardo and Carmel Mountain Ranch
- » Excellent location for retail service use types
- » Freestanding pad building available

DEMOGRAPHICS

	1 Mile	3 Miles	5 Miles
Population (2013 est)	13,638	95,037	193,615
Average HH (2012)	\$112,404	\$115,119	\$123,862
Daytime Population	13,748	49,717	76,638

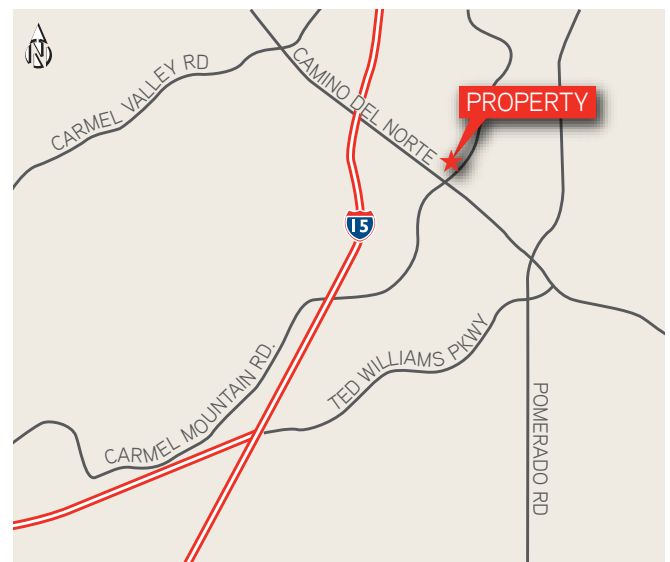

Kirk Allison
760 930 7922
kirk.allison@colliers.com
Lic. #01049184

Vic Gausepohl
760 930 7912
vic.gausepohl@colliers.com
Lic. #01070105

Colliers International
5901 Priestly Drive, Suite 100
Carlsbad, CA 92008
www.colliers.com/carlsbad



FOR LEASE > RETAIL SPACE

Piazza Bella Centro

12120-12160 Alta Carmel Court, San Diego, California 92128

AERIAL

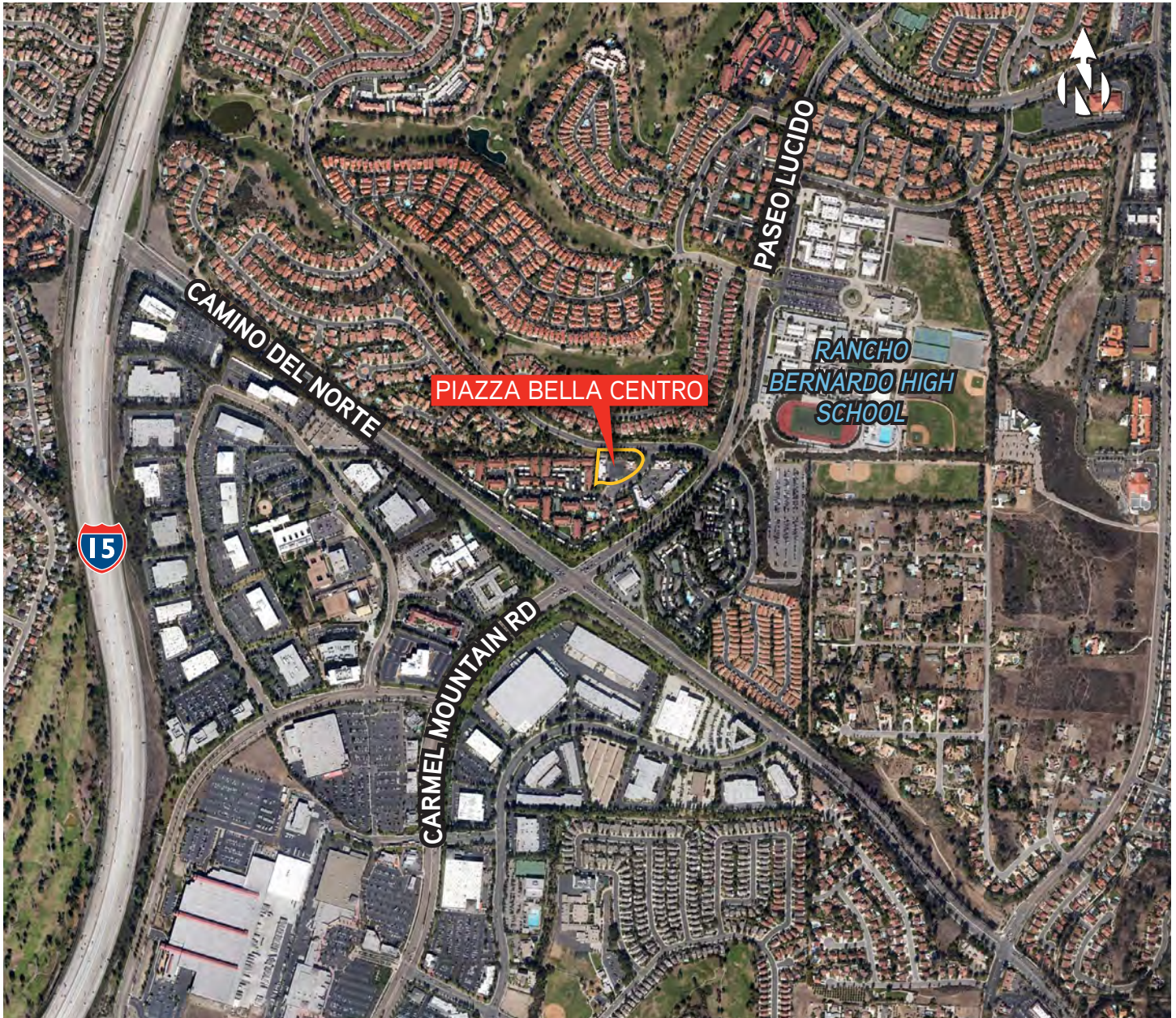

This document has been prepared by Colliers International for advertising and general information only. Colliers International makes no guarantees, representations or warranties of any kind, expressed or implied, regarding the information including, but not limited to, warranties of content, accuracy and reliability. Any interested party should undertake their own inquiries as to the accuracy of the information. Colliers International excludes unequivocally all inferred or implied terms, conditions and warranties arising out of this document and excludes all liability for loss and damages arising there from. Colliers International is a worldwide affiliation of independently owned and operated companies.

Kirk Allison
760 930 7922
kirk.allison@colliers.com
Lic. #01049184

Vic Gausepohl
760 930 7912
vic.gausepohl@colliers.com
Lic. #01070105

Colliers International
5901 Priestly Drive, Suite 100
Carlsbad, CA 92008
www.colliers.com/carlsbad



FOR LEASE > RETAIL SPACE

Piazza Bella Centro

12120-12160 Alta Carmel Court, San Diego, California 92128

TRADE AREA RETAILERS



Kirk Allison
760 930 7922
kirk.allison@colliers.com
Lic. #01049184

Vic Gausepohl
760 930 7912
vic.gausepohl@colliers.com
Lic. #01070105

Colliers International
5901 Priestly Drive, Suite 100
Carlsbad, CA 92008
www.colliers.com/carlsbad



FOR LEASE > RETAIL SPACE

Piazza Bella Centro

12120-12160 Alta Carmel Court, San Diego, California 92128

SITE PLAN



Kirk Allison
760 930 7922
kirk.allison@colliers.com
Lic. #01049184

Vic Gausepohl
760 930 7912
vic.gausepohl@colliers.com
Lic. #01070105

Colliers International
5901 Priestly Drive, Suite 100
Carlsbad, CA 92008
www.colliers.com/carlsbad



FOR LEASE > RETAIL SPACE

Piazza Bella Centro

12120-12160 Alta Carmel Court, San Diego, California 92128

MILEAGE MAP

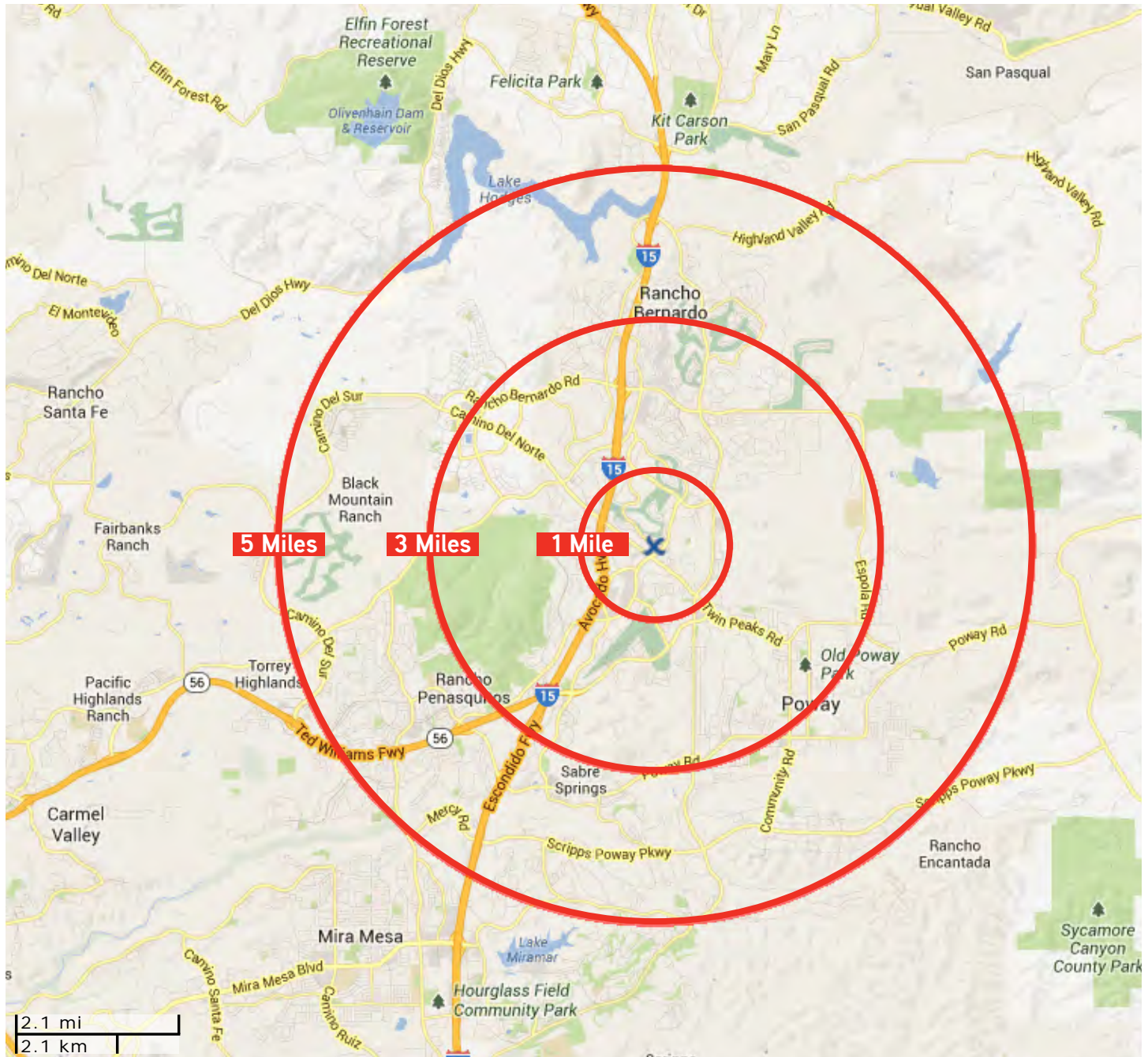

Kirk Allison
760 930 7922
kirk.allison@colliers.com
Lic. #01049184

Vic Gausepohl
760 930 7912
vic.gausepohl@colliers.com
Lic. #01070105

Colliers International
5901 Priestly Drive, Suite 100
Carlsbad, CA 92008
www.colliers.com/carlsbad



Piazza Bella Centro

12120-12160 Alta Carmel Court, San Diego, California 92128

SOCIO ECONOMIC BENCHMARK REPORT (%)

	1 mi Ring	3 mi Ring	5 mi Ring
POPULATION			
2000 Population	13,444	84,467	162,953
2010 Population	13,227	92,230	187,480
2012 Population	13,638	95,037	193,615
2017 Population	14,004	99,840	205,049
% Population Change 2000 to 2010	-1.61%	9.19%	15.05%
% Population Change 2000 to 2012	1.44%	12.51%	18.82%
% Population Change 2012 to 2017	2.68%	5.05%	5.91%
HOUSEHOLDS			
2000 Households	5,195	31,765	58,403
2010 Households	5,106	34,621	67,031
2012 Households	5,141	34,830	67,625
2017 Households	5,254	36,341	71,140
% Household Change 2000 to 2010	-1.71%	8.99%	14.77%
% Household Change 2000 to 2012	-1.04%	9.65%	15.79%
% Household Change 2012 to 2017	2.20%	4.34%	5.20%
2010 Average Household Size	2.5	2.6	2.8
2012 Average Household Size	2.6	2.7	2.8
2017 Average Household Size	2.6	2.7	2.9
FAMILIES			
% 2010 Family Households	70.82%	72.93%	76.30%
% 2010 Nonfamily Households	29.18%	27.07%	23.70%
INCOME			
2010 Per Capita Income	\$44,283	\$43,418	\$44,352
2012 Per Capita Income	\$43,596	\$42,587	\$43,526
2017 Per Capita Income	\$44,603	\$43,293	\$44,156
2010 Average Household Income	\$111,497	\$114,539	\$123,236
2012 Average Household Income	\$112,404	\$115,119	\$123,862
2017 Average Household Income	\$115,515	\$117,872	\$126,528
2010 Median Household Income	\$90,050	\$90,551	\$98,208
2012 Median Household Income	\$92,431	\$92,565	\$100,790
2017 Median Household Income	\$101,988	\$102,041	\$109,686
2010 Aggregate Household Income	\$569,305,000	\$3,965,450,000	\$8,260,609,000
2012 Aggregate Household Income	\$577,868,400	\$4,009,588,000	\$8,376,186,000
2017 Aggregate Household Income	\$606,916,600	\$4,283,580,000	\$9,001,201,000