



3300 NORTH BROADWAY

NORTHWEST CORNER OF
BROADWAY ST & ALDINE AVE
CHICAGO, IL

RETAIL / RESTAURANT
SPACE AVAILABLE

3300 N. BROADWAY

Northwest Corner of Broadway St & Aldine Ave | Chicago, IL

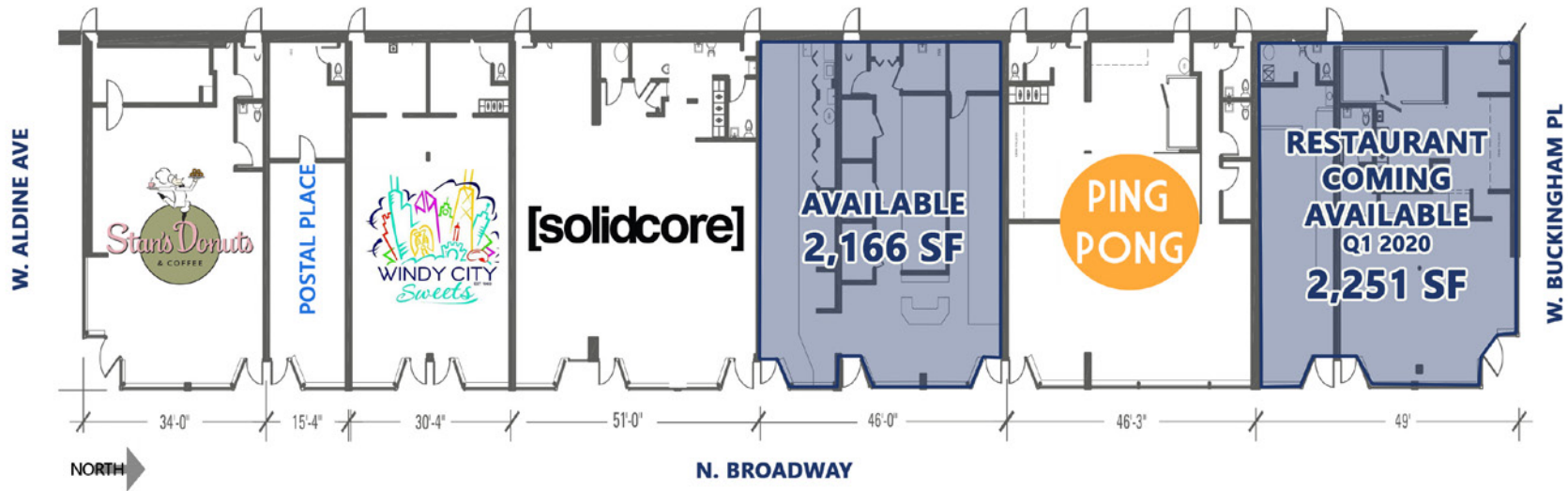

SPACE AVAILABLE

700 SF - 2,300 SF

SITE SUMMARY

- Space with ample frontage in Lakeview at the intersection of Broadway and W. Aldine, just north of Belmont
- Nearly 6,000 pedestrians and over 14,000 vehicles per day
- Second generation restaurant endcap with outdoor seating along Broadway and Buckingham
- Strong urban density with average HH Income over \$100k within 1 mile
- Surrounded by a great mix of unique, local and national restaurants and boutiques

NEIGHBORS

Join SolidCore, Stan's Donuts, Ping Pong Restaurant & Bar and popular area restaurants include Dry Hop, Mortar and Pestle, Eggsperience, and more. Blocks from Mariano's & Lakeview Athletic Club.

POPULATION DENSITY	33,823	½ Mile
	84,563	1 Mile
	208,462	2 Mile
DAYTIME EMPLOYMENT	10,750	½ Mile
	24,506	1 Mile
	60,413	2 Mile
AVERAGE HH INCOME	\$92,979	½ Mile
	\$101,364	1 Mile
	\$112,527	2 Mile

LAKEVIEW RETAIL / RESTAURANT SPACE AVAILABLE
3300 N. BROADWAY
 Northwest Corner of Broadway St & Aldine Ave | Chicago, IL



CONTACT

Matt Cavanagh
 matt@arcgrp.com
 (630) 908-5694

Cooper Annenberg
 cooper@arcgrp.com
 (630) 908-5697

© 2019 A-R-C Real Estate. All information is from sources believed reliable, not independently verified, and thus subject to errors, omissions, and modifications such as price, listing, square footage, rates and commissions. All information, estimates and projections subject to change, market assumptions, unknown facts and conditions, and future potentialities. A-R-C Real Estate makes no express or implied representations or warranties, as facts and results may vary materially from all information, estimates and projections. All renderings presented are conceptual.

