

# GANDY RETAIL

3126 W. Gandy Blvd. | Tampa, FL 33611  
RETAIL SPACE FOR LEASE



## PROPERTY HIGHLIGHTS

- AVAILABLE SPACES: 3,135 SF
- ASKING RENT: \$10.50/SF plus NNN
- Excellent visibility and access along **Gandy Blvd.**
- Surrounded by strong demographics within the trade area
- Area Retailers Include: Publix, Target, Home Depot, Sam's Club, CVS, Walgreens, Yogurtology, ABC Fine Wine & Spirits, Starbucks, & more

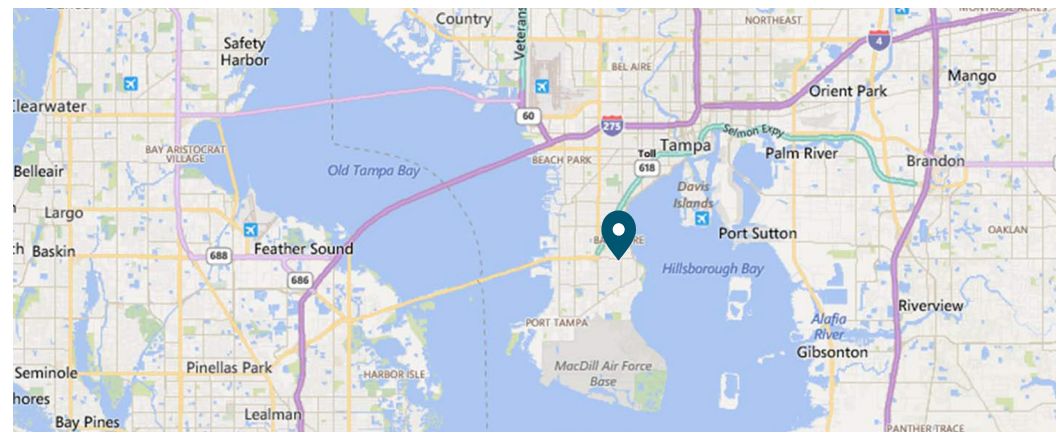

### DAILY TRAFFIC COUNTS



W. Gandy Blvd. 27,000 AADT

### POPULATION



1 Mile	14,753
3 Mile	76,645
5 Mile	144,871

### AVE. HOUSEHOLD INCOME



1 Mile	\$136,442
3 Mile	\$123,731
5 Mile	\$111,589

### DAYTIME POPULATION



1 Mile	10,226
3 Mile	45,187
5 Mile	178,077

LICENSED REAL ESTATE BROKER

FranklinSt.com

**KYLE COUGHLIN**  
LEASING ASSOCIATE

813.386.0457  
Alex.Coughlin@FranklinSt.com

**ALEX WRIGHT**  
SENIOR DIRECTOR

813.682.6135  
Alex.Wright@FranklinSt.com

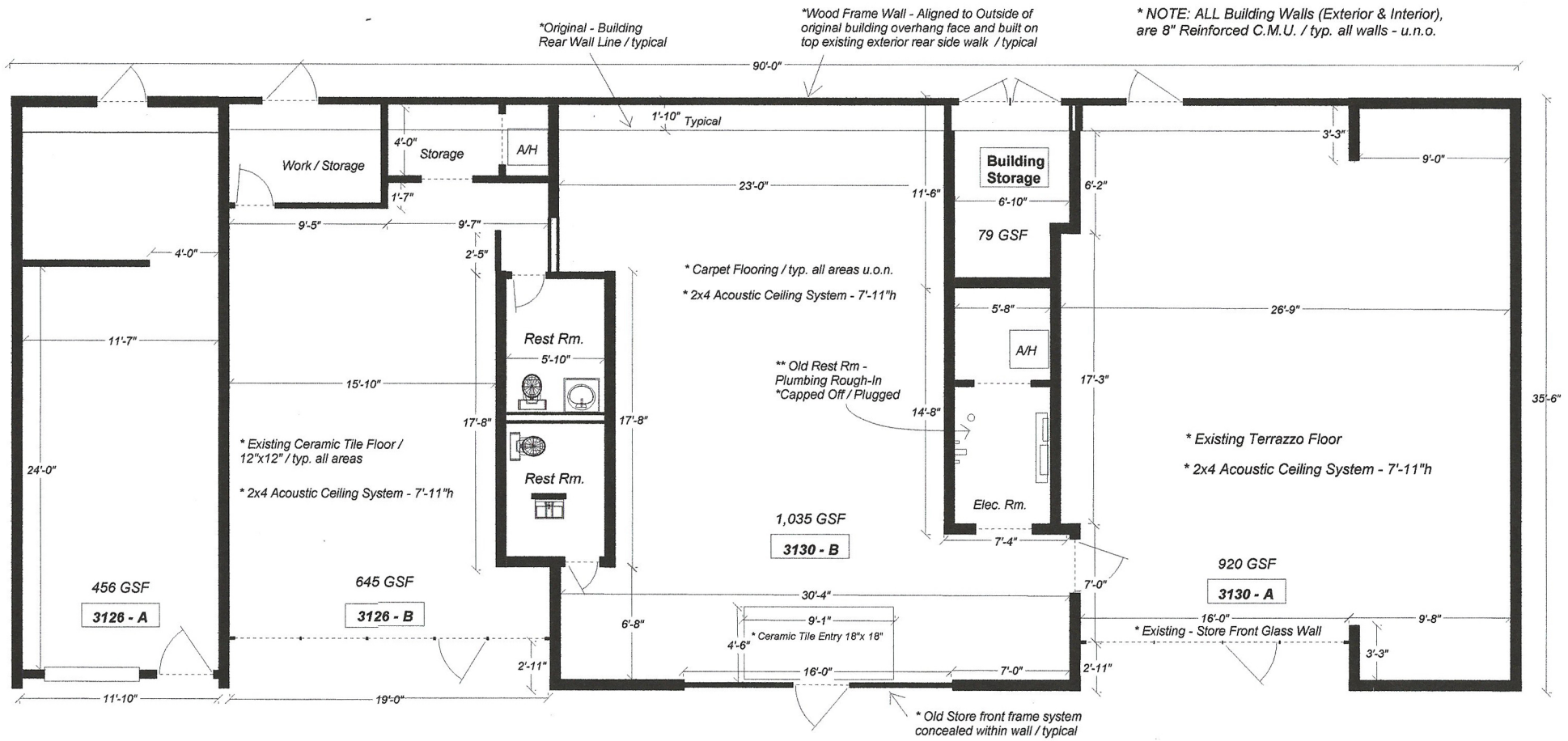

6th St.

Gandy Blvd.