

# Publix #1038 - Shoppes at Williston

5200 SW 34th Street  
Gainesville, FL 32608  
29.605, -82.372

FOR LEASE



1,200 - 1,810 SF AVAILABLE

## PROPERTY HIGHLIGHTS

- Publix-Anchored
- Located Just Off Interstate-75 at the High Traffic Signalized Intersection of 34th Street & Williston Road
- Convenient to the University of Florida and Shands Hospital
- Excellent Visibility and Access
- Combined Traffic Count: 50,600 VPD

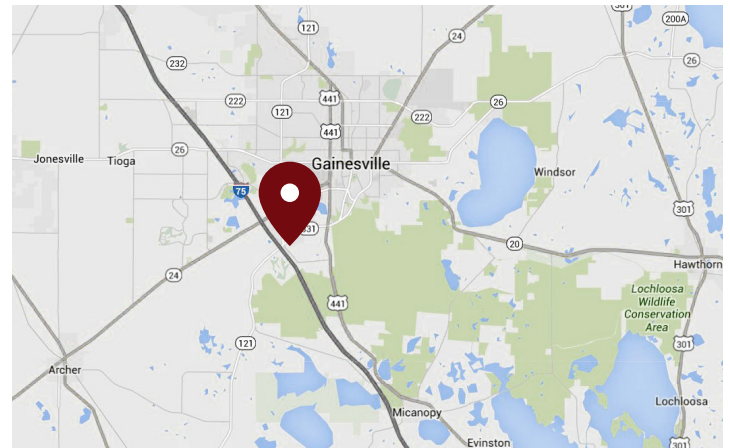

DEMOGRAPHICS	1 Mile	3 Miles	5 Miles
Total Population	8,638	44,349	123,645
Daytime Population	9,275	52,481	143,782
Total Households	3,758	19,760	50,334
Avg. HH Income	\$41,390	\$44,807	\$65,561

Data provided by Placer Labs Inc. (www.placer.ai) & Esri

## Tyler Wilkins

407.581.6245 | [twilkins@crossmanco.com](mailto:twilkins@crossmanco.com)

3333 South Orange Avenue, Suite 201, Orlando, FL

Licensed Real Estate Broker. No warranty expressed or implied has been made to the accuracy of the information provided herein, no liability assumed for error or omission.



[www.crossmanco.com](http://www.crossmanco.com)

# Publix #1038 - Shoppes at Williston

5200 SW 34th Street  
Gainesville, FL 32608  
29.605, -82.372

## SITE PLAN

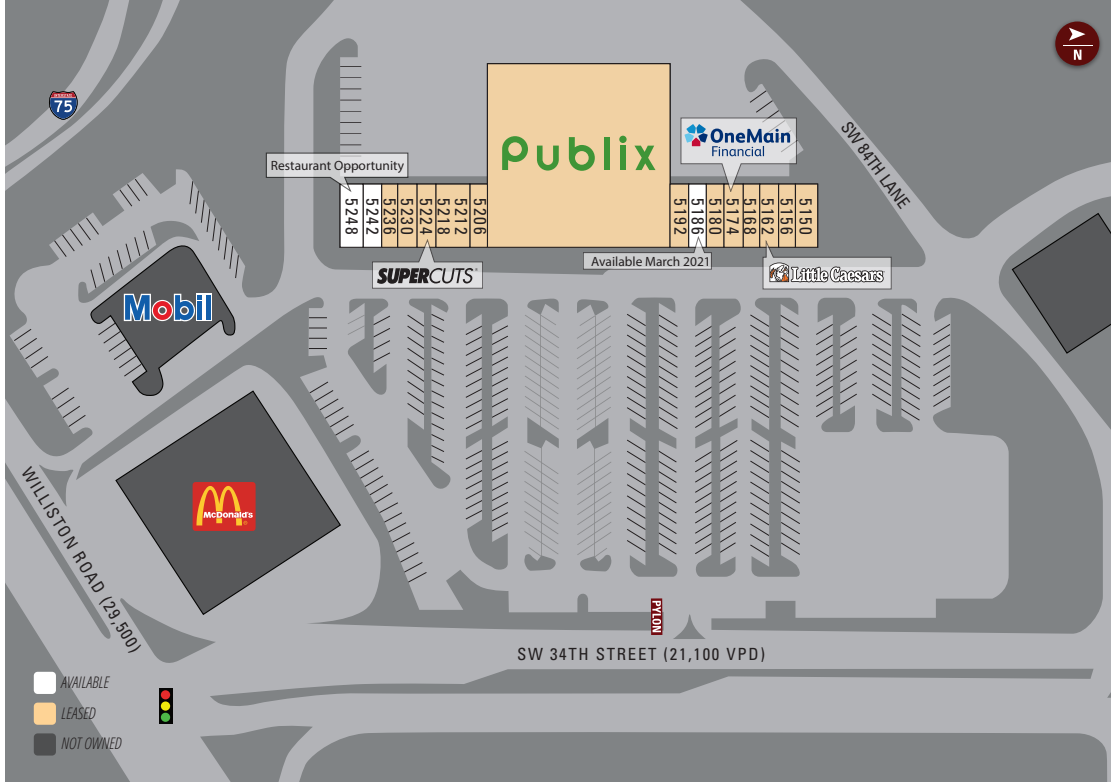

Suite	Tenant	Size
	Publix	38,997
5150	Mahzu Sushi & Grill	2,110
5156	Bleubird Wings	1,400
5162	Little Caesar's Pizza	1,435
5168	First Wok in Gainesville	1,120
5174	OneMain Financial	1,645
5180	Dr. Ku, DDS	1,400
5186	AVAILABLE March 2021	1,400
5192	Jigz Liquors	1,400
5206	Manpower Staffing	1,200
5212/5218	GatorTec	2,400
5224	Supercuts Corporate	1,200
5230	NY Nails	1,200
5236	Ideal Image	1,200
5242	AVAILABLE	1,200
5248	AVAILABLE	1,810

**TOTAL 61,117**



**Tyler Wilkins**

407.581.6245 | [twilkins@crossmanco.com](mailto:twilkins@crossmanco.com)

3333 South Orange Avenue, Suite 201, Orlando, FL

Licensed Real Estate Broker. No warranty expressed or implied has been made to the accuracy of the information provided herein, no liability assumed for error or omission.



Crossman & Company

[www.crossmanco.com](http://www.crossmanco.com)

# Publix #1038 - Shoppes at Williston

5200 SW 34th Street  
Gainesville, FL 32608  
29.605, -82.372

## FOOT TRAFFIC OVERVIEW

EST. # OF CUSTOMERS ANNUALLY



EST. # OF VISITS ANNUALLY



AVG. VISITS / CUSTOMER



AVG. LENGTH-OF-STAY / VISIT



TOP 3 DAYS



Friday	129,420
Saturday	127,680
Monday	118,027

# OF VISITS

TOP 3 HOURS



5-6 PM	152,217
4-5 PM	143,302
6-7 PM	136,291

# OF VISITS

Data provided by Placer Labs Inc. (www.placer.ai) Dec 1, 2019 - Nov 30, 2020

## SITE VISIT DENSITY

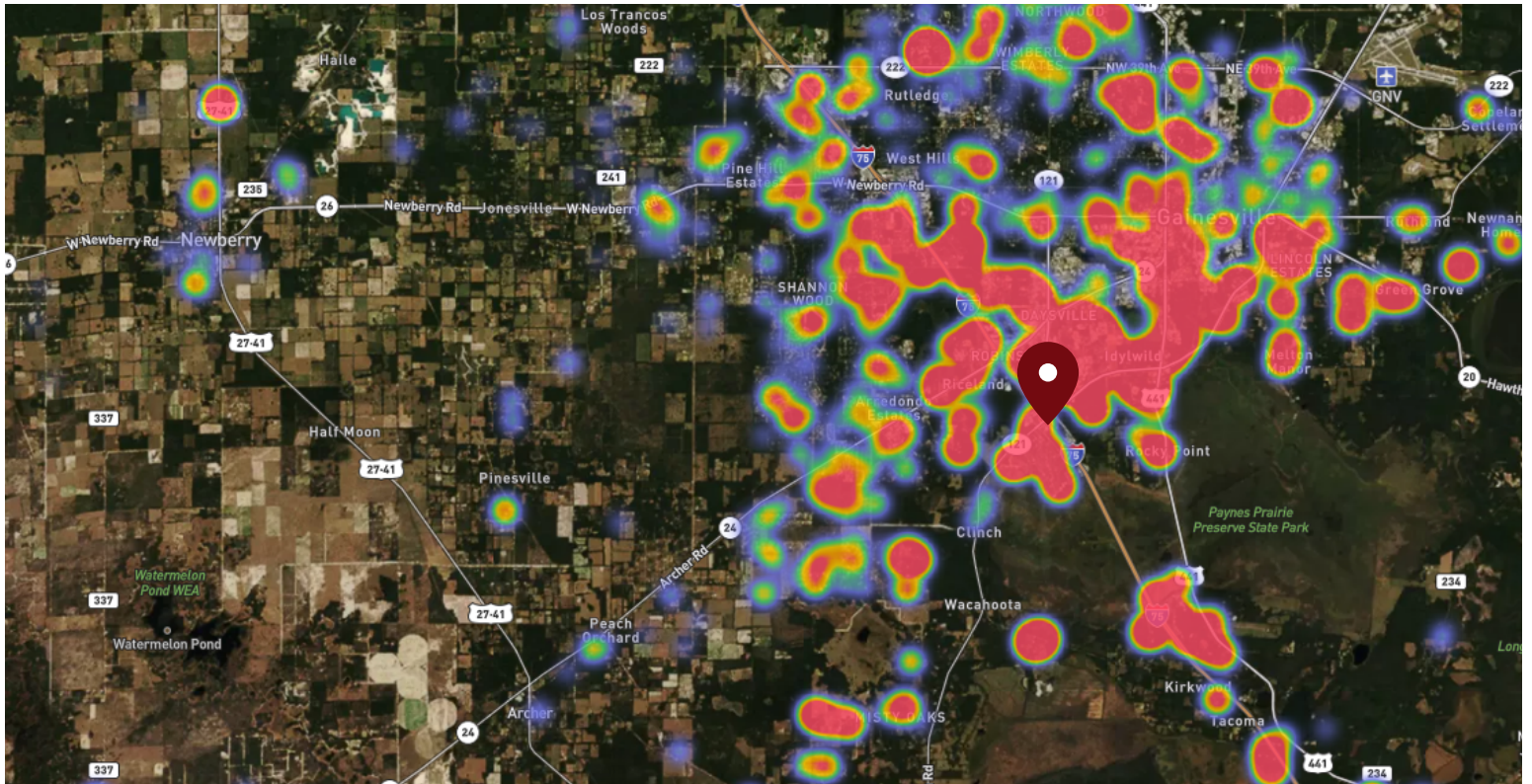

Red, orange, and yellow colors represent the location of 60% of site visitors

Data provided by Placer Labs Inc. (www.placer.ai)

### Tyler Wilkins

407.581.6245 | [twilkins@crossmanco.com](mailto:twilkins@crossmanco.com)

3333 South Orange Avenue, Suite 201, Orlando, FL

Licensed Real Estate Broker. No warranty expressed or implied has been made to the accuracy of the information provided herein, no liability assumed for error or omission.



[www.crossmanco.com](http://www.crossmanco.com)