

FIND YOUR CONNECTION HERE

100

SYLVAN AVENUE
ENGLEWOOD CLIFFS, NJ



64,000 SF AVAILABLE FOR LEASE

SINGLE OR MULTI-TENANT OPPORTUNITY (DIVISIBLE)



100

SYLVAN AVENUE
ENGLEWOOD CLIFFS, NJ

BUILDING OVERVIEW

RBA: 64,000 SF (divisible)

Land: 5.4 AC

Built: 1981

Stories: 2

Parking: Ratio of 4/1,000 SF

CORPORATE NEIGHBORS

CNBC

Unilever

LG Electronics

Ferrari North America



FIRST FLOOR

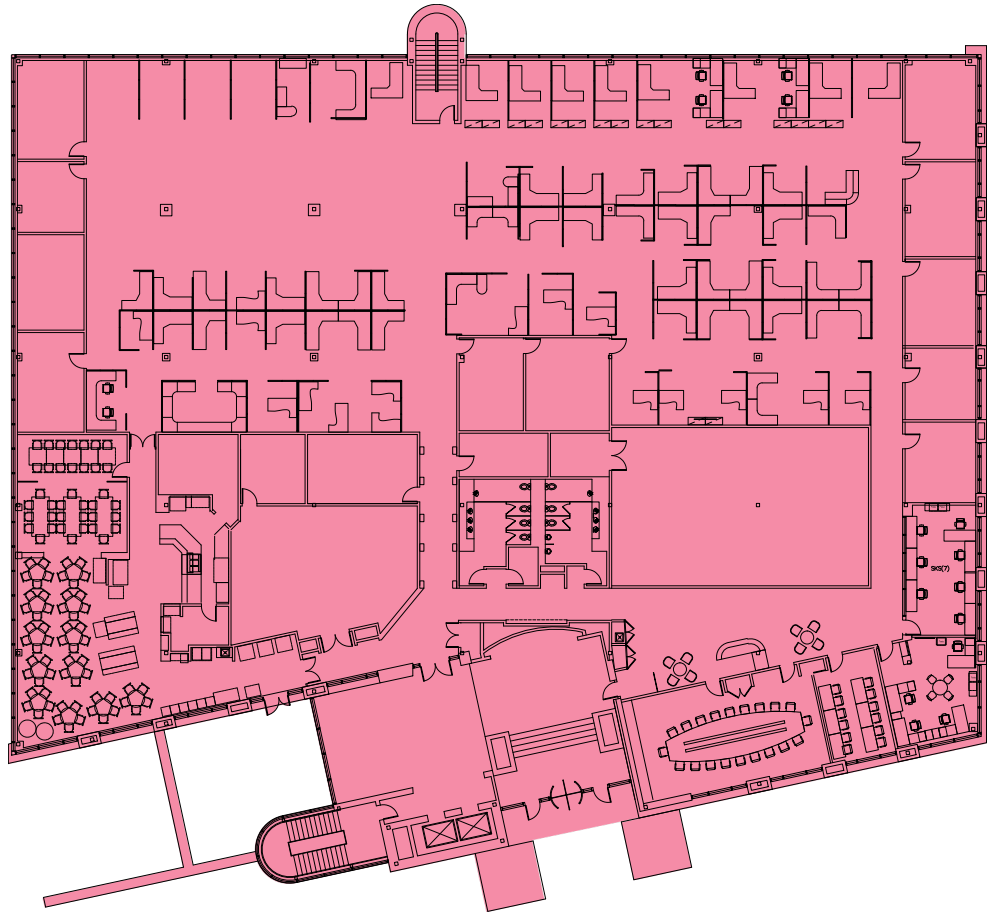

SECOND FLOOR

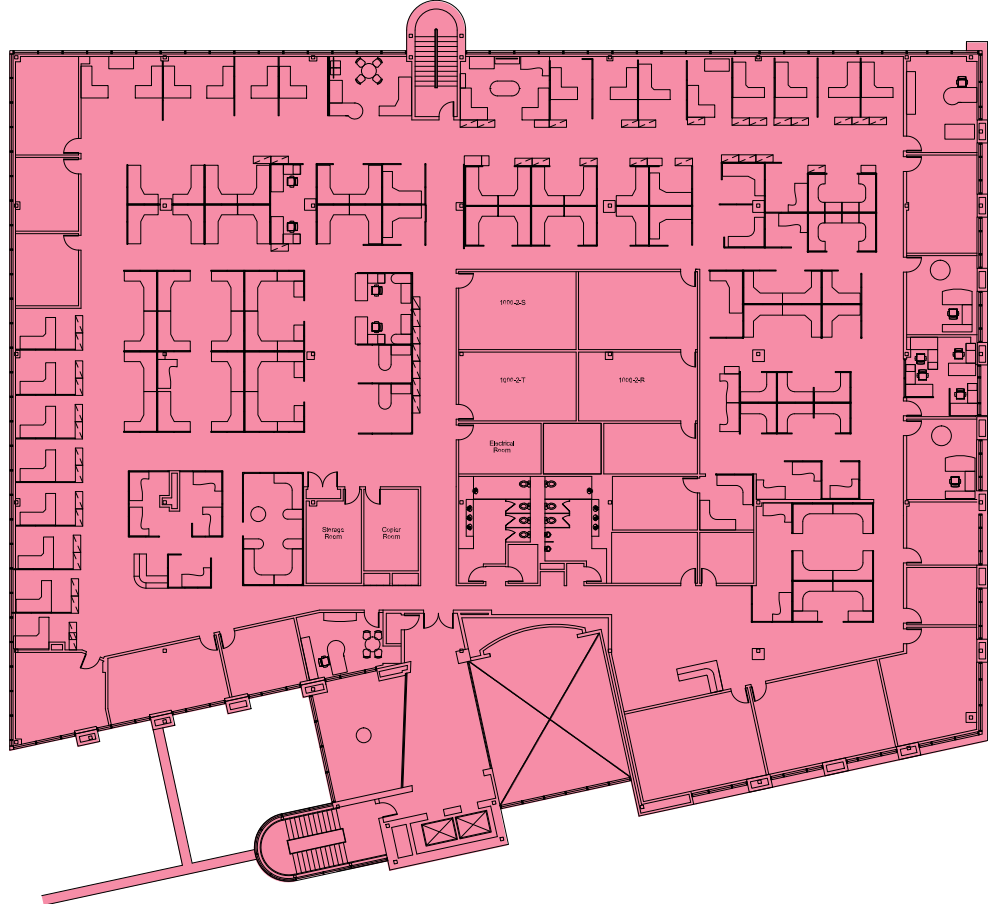

LOCATION

LOCAL AMENITIES MAP

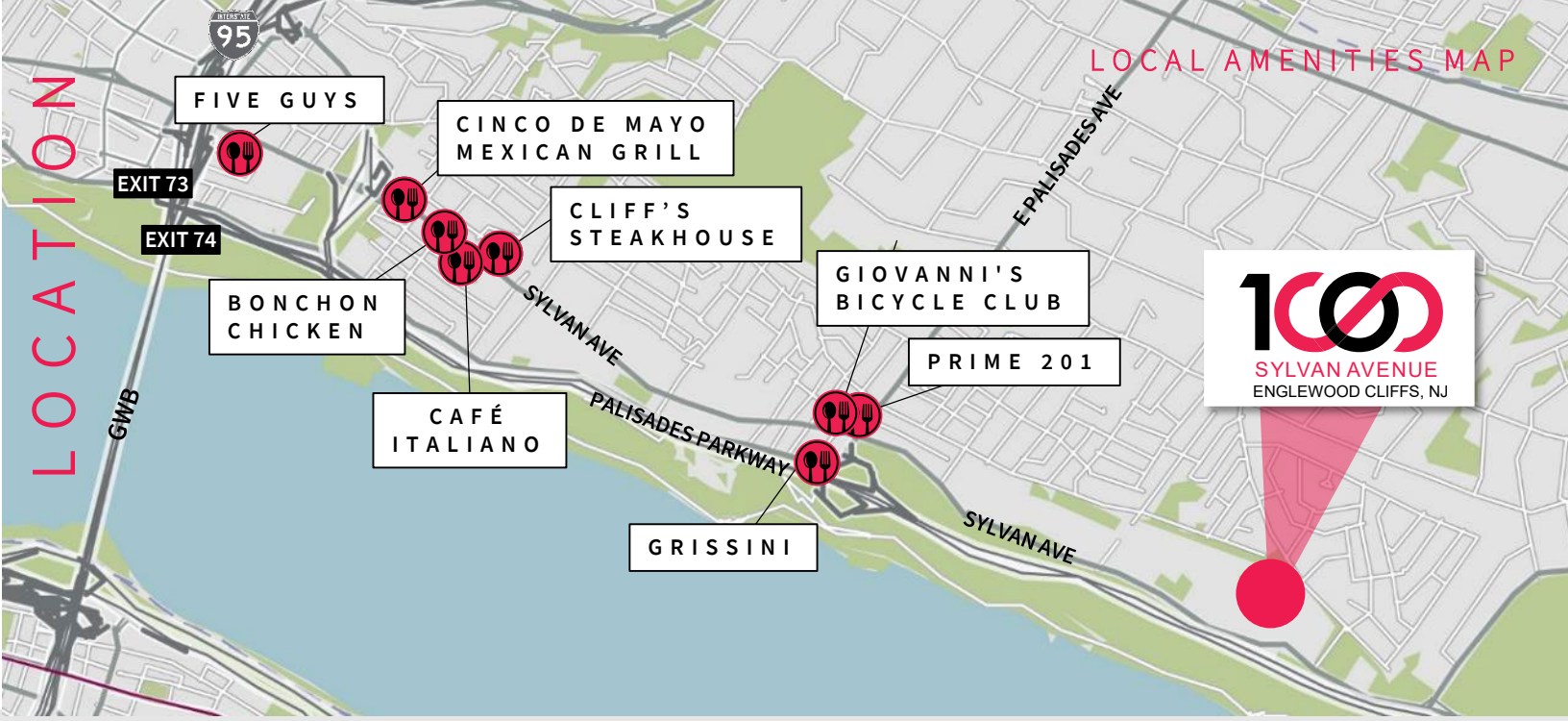

REGIONAL MAP



1000 Sylvan Avenue, Sylvan Corporate Center, is located in Englewood Cliffs, New Jersey. Only three miles north of the George Washington Bridge, travel time to midtown Manhattan is approximately 20 minutes. The buildings are also in close proximity to I-80, I-95 (New Jersey Turnpike), Routes 4, 46, 1 & 9, the Palisades and Garden State Parkways and The Governor Mario M. Cuomo Bridge.



For more information, please contact:

Frank D. Recine
 +1 973 829 4738
 frank.recine@am.jll.com

Mike Pietrowicz
 +1 973 829 4749
 mike.pietrowicz@am.jll.com