

# Sunbird Plaza Marlton, New Jersey 08053



# RD MANAGEMENT LLC

# Marlton, New Jersey

## Sunbird Plaza

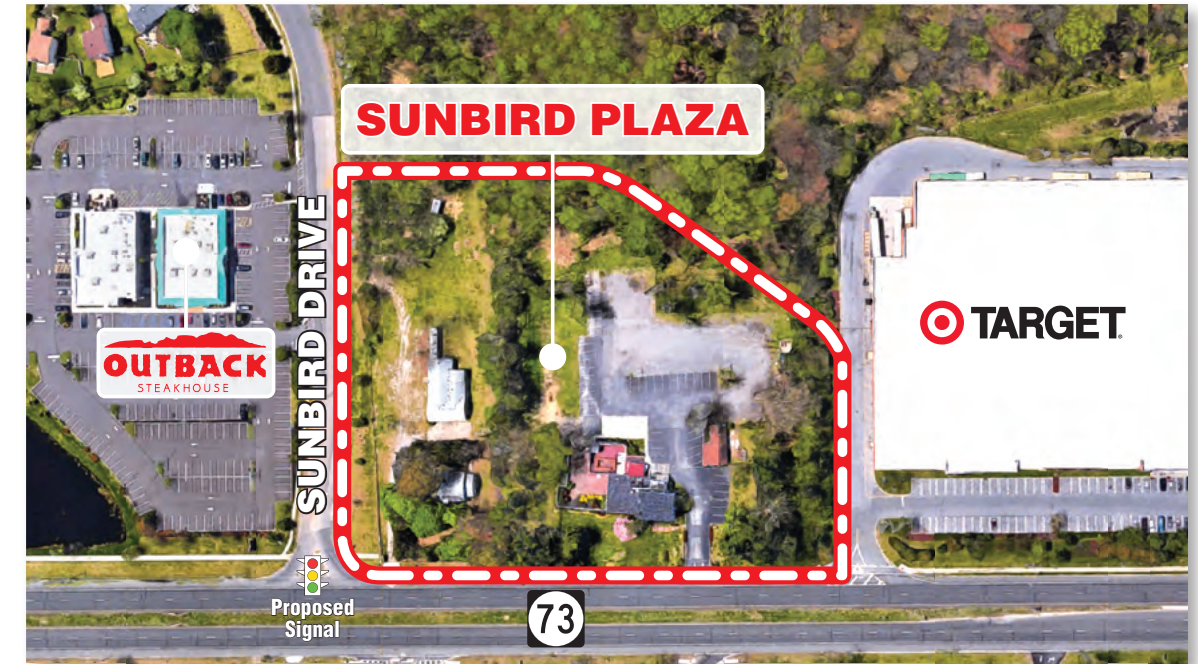

**Location:** Sunbird Plaza is a proposed new development located in Burlington County at the intersection of Route 73 and Sunbird Drive in Marlton, New Jersey 08053.

**Type:** Neighborhood Strip Shopping Center

**GLA:** 26,016 sf

**Traffic:** Two way average daily traffic 37,560 cars per day

- Vital Statistics:**
- New development coming Fall 2019
  - ±19,200 sf box could be made available
  - Potential Pad Site Available
  - Next to Target on busy Route 73 South
  - Near Willow Ridge (Marshalls, Old Navy, Bed Bath & Beyond, Ulta Beauty)

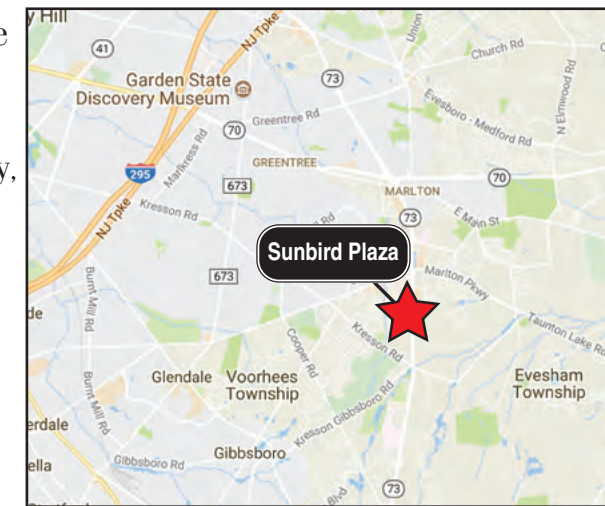

Demographics	3 mile	5 mile	10 mile
<b>Population</b>			
2023 (projection)	58,586	155,243	592,456
2018 (estimate)	58,888	155,957	597,284
2010 (census)	59,136	156,137	598,836
<b>Number of HH</b>			
2023 (projection)	23,522	63,633	243,917
2018 (estimate)	22,930	62,041	238,892
2010 (census)	22,112	59,563	229,994
<b>Average HH Income</b>			
2023 (projection)	\$170,127	\$148,661	\$131,737
2018 (estimate)	\$138,527	\$121,841	\$108,486
2010 (census)	\$115,394	\$103,463	\$89,446
<b>Median Age</b>			
2018 (estimate)	43.8	42.4	40.8
<b>Daytime Population</b>			
2018 (estimate)	64,060	153,061	490,585

**RD Management LLC**  
**Darren Sasso**  
 212-265-6600 x354  
 dsasso@rdmanagement.com

810 Seventh Avenue, 10th floor  
 New York, NY 10019

**RD Management LLC is ranked one of the Top 100 Retail Real Estate Owners in the U.S.**

Information furnished is from sources deemed reliable, but is not guaranteed by RD Management and is subject to change in price, corrections, errors and omissions, prior sales or withdrawal without notice.



# Sunbird Plaza

State Highway 73 and Sunbird Drive  
Marlton, New Jersey 08053



**Darren Sasso**  
212-265-6600 x354  
dsasso@rdmanagement.com  
810 Seventh Avenue, 10th floor  
New York, NY 10019

## Retail Tenant Key

- 1. Retail A (160' x 120') ±19,200 sf
- 2. Retail B (55' x 30') ±1,650 sf
- 3. Royal Farms 5,166 sf

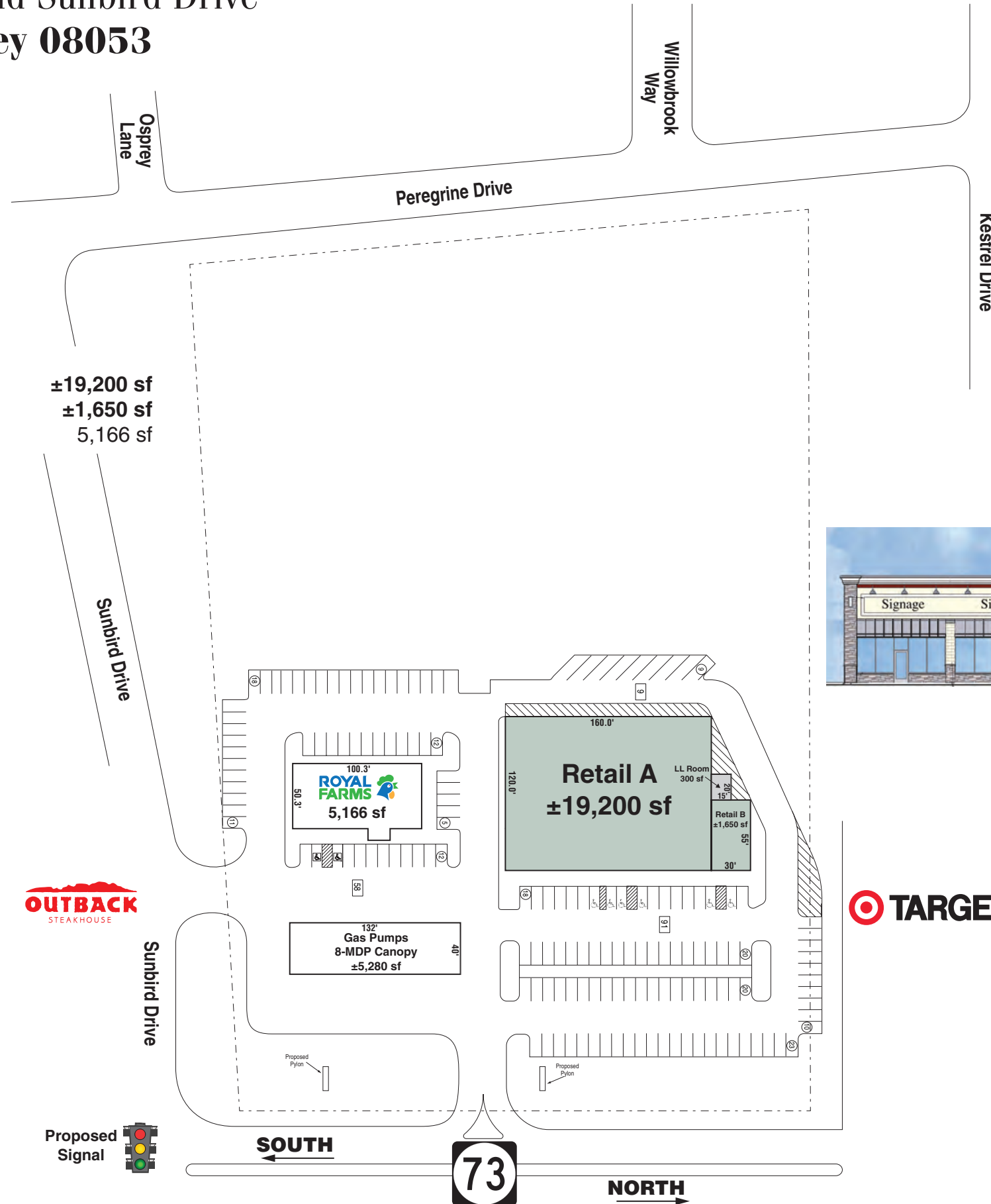

→

**Willow Ridge Shopping Center**



**SOUTH**



**NORTH**