



- New, Professional Medical Office Building
- Space is Framed Out, Can Be Finished Within 90 Days
- Prime Location at Intersection of University Dr. & Bonnie Brae
- Blocks from Presbyterian Hospital & Cook Children's
- Across the Street from Future Rayzor Ranch 412 Acre Mixed Use Development

EMERY MEDICAL OFFICE BLDG

MEDICAL OFFICE SPACE 2,950^{+/-} SF

2220 EMERY ST., DENTON, TX 76201



FOR LEASE

LEASE RATE \$20/NNN

AVAILABLE SPACE - 2,950 SF
BUILDING SIZE - 11,950 SF
LEASE RATE - \$20/SF
LEASE TYPE - NNN

PROPERTY DESCRIPTION

Brand new professional medical office building available for lease. The space has been framed out and can be completed in 90 days.

Located at the heavily traveled and highly visible intersection of University Drive & Bonnie Brae just blocks from Presbyterian Hospital and Cook Children's. Also, across the street is the future Rayzor Ranch, a planned 412 acre, mixed use development featuring residential, retail, office, medical facilities, public parks, museums and entertainment.

FOR MORE INFORMATION PLEASE CONTACT **ALEX PAYNE/BRAD ANDRUS**

1517 Centre Place Dr., Ste 250 Denton, TX 76205
Copyright©2015 Axis Realty Group

Office 940.891.2947 Alex 972.979.7727 Brad 940.368.3588

www.axisrealty.biz

alex@axisrealty.biz/brad@axisrealty.biz

EMERY MEDICAL OFFICE BUILDING 2220 EMERY ST, DENTON, TX 76201

FLOOR PLAN

OFFICE SPACE

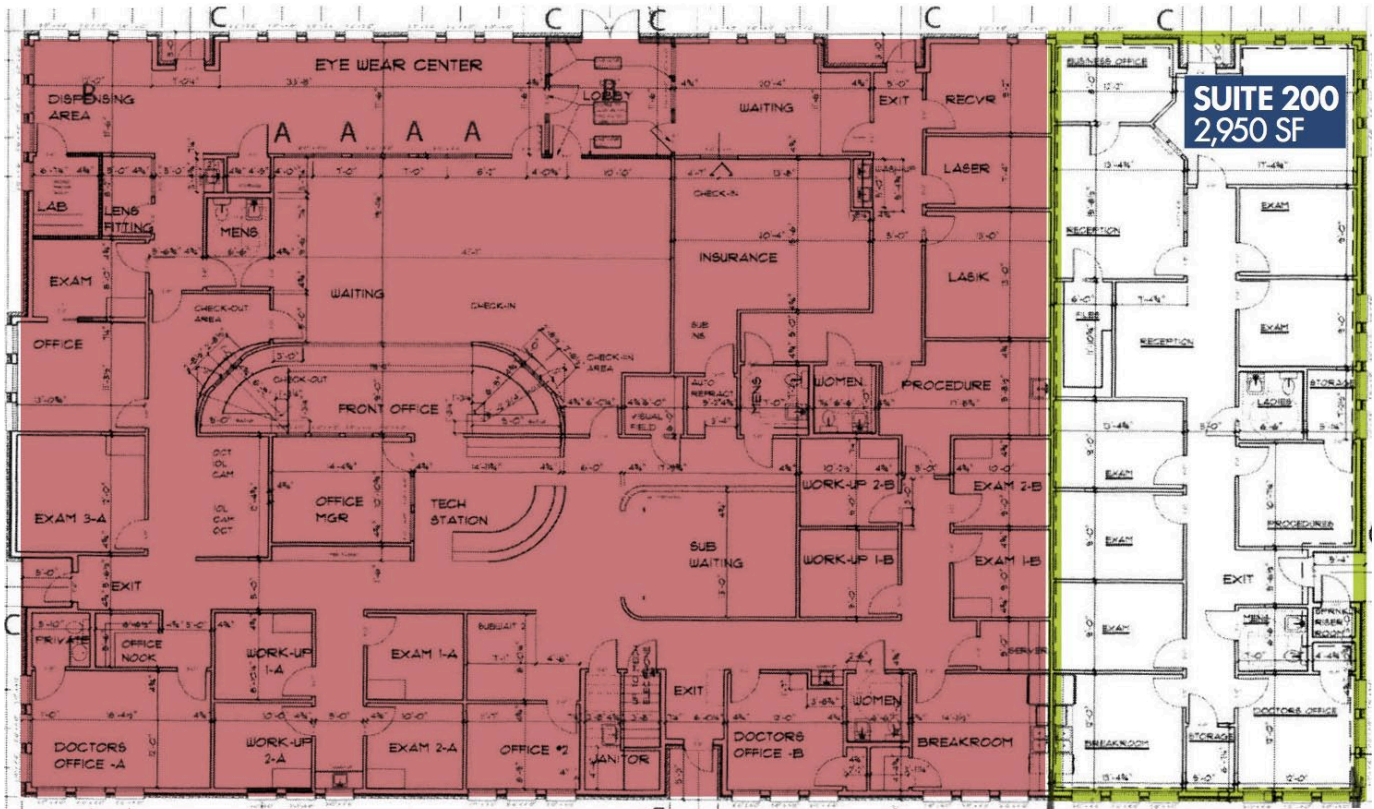

FOR MORE INFORMATION PLEASE CONTACT **ALEX PAYNE/BRAD ANDRUS**

1517 Centre Place Dr., Ste 250 Denton, TX 76205 Office 940.891.2947 Alex 972.979.7727 Brad 940.368.3588

Copyright©2015 Axis Realty Group

www.axisrealty.biz

alex@axisrealty.biz / brad@axisrealty.biz