



MAYHUGH
COMMERCIAL ADVISORS

FOR LEASE

3,600 +/- SF OFFICE / WAREHOUSE

12369 CRYSTAL COMMERCE LOOP - UNIT 200 - FORT MYERS, FL 33966



Property Description: Located on Crystal Commerce Loop off Crystal Drive between Metro Parkway and Plantation Road, with easy access to Colonial Boulevard and Daniels Parkway. Zoned IL (Lee County) offers an array of business uses.

Price P/S/F:	\$11.00 MG
Monthly Lease Rate:	\$3,300.00 + sales tax
Office Space:	1,410 +/- SF
Warehouse Space:	2,190 +/- SF
Total Unit Size:	3,600 +/- SF
Building Size:	7,200 +/- SF
OH Doors:	1 (12'X14")
Clear Height:	20"
Parking:	11 marked spots
Zoning:	IL (Lee County)
Year Built:	2006



Advisors:

Bryan Burchers

239-699-3120

bryan@mayhughcommercial.com

Chase Mayhugh, SIOR, CCIM

239-898-9685 (Cell)

chase@mayhughcommercial.com

Available Immediately!

Mayhugh Commercial Advisors, Inc.

13690 Eagle Ridge Dr.

Fort Myers, FL 33912

Office: 239-278-4945

Fax: 239-278-1964

Drawing not to scale. The statements, information and figures presented herein in this offering, while not warranted or guaranteed, are secured from a source we believe to be reliable. Subject to prior sale, withdrawal and price change without notice.

MayhughCommercial.com



MAYHUGH
COMMERCIAL ADVISORS

FOR LEASE

3,600 +/- SF OFFICE / WAREHOUSE

12369 CRYSTAL COMMERCE LOOP - UNIT 200 - FORT MYERS, FL 33966

Floor Plan: Suite 100

Office Area: 1,410 +/- SF

Warehouse Area: 2,190 +/- SF

Total: 3,600 +/- SF

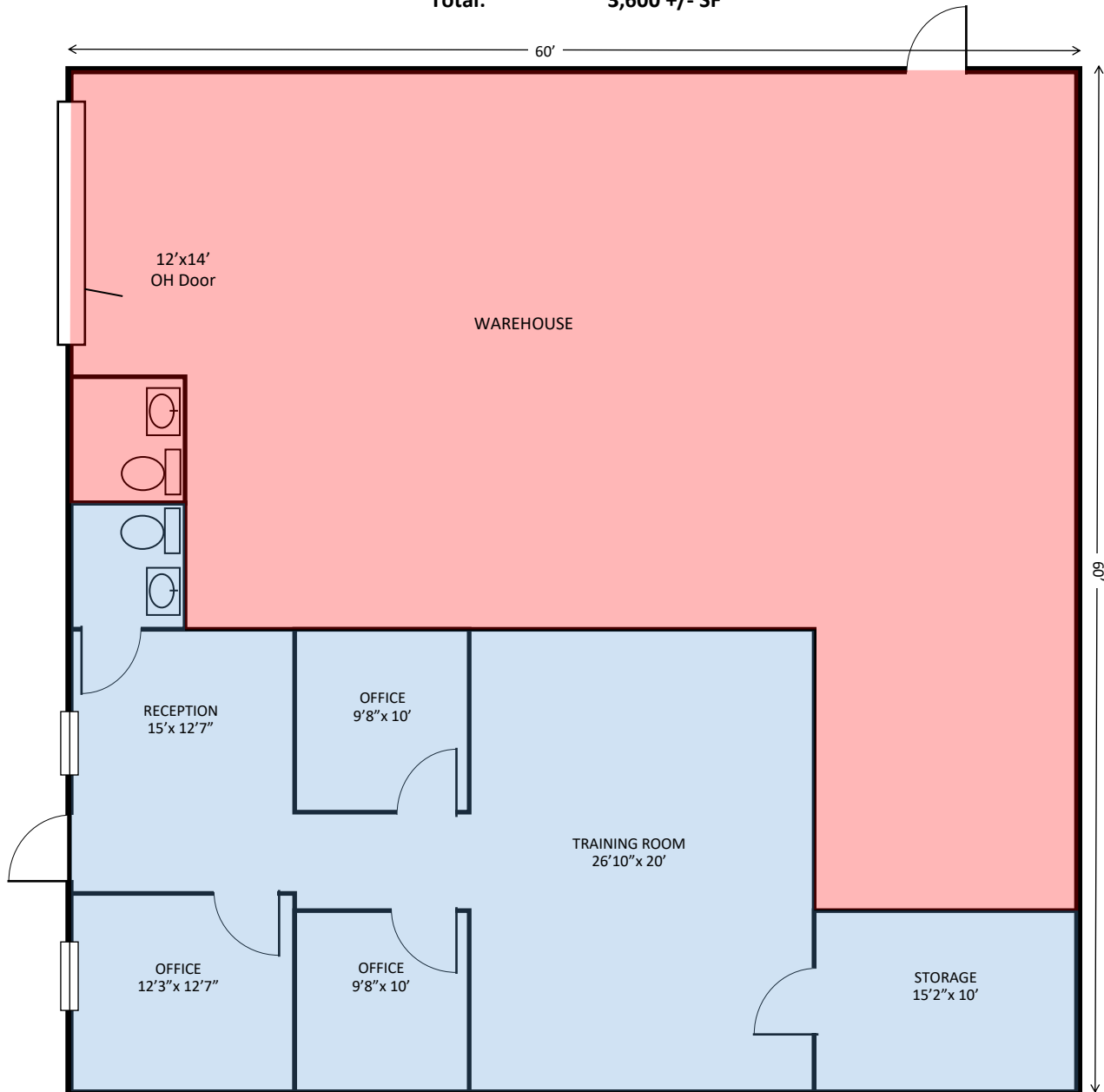

Mayhugh Realty, Inc.
13690 Eagle Ridge Dr.
Fort Myers, FL 33912
MayhughCommercial.com

Bryan Burchers
239-699-3120
bryan@mayhughcommercial.com

Chase Mayhugh, SIOR, CCIM
239-898-9685
chase@mayhughcommercial.com



MAYHUGH
COMMERCIAL ADVISORS

FOR LEASE

3,600 +/- SF OFFICE / WAREHOUSE

12369 CRYSTAL COMMERCE LOOP - UNIT 200 - FORT MYERS, FL 33966



Mayhugh Realty, Inc.
13690 Eagle Ridge Dr.
Fort Myers, FL 33912
MayhughCommercial.com

Bryan Burchers
239-699-3120
bryan@mayhughcommercial.com

Chase Mayhugh, SIOR, CCIM
239-898-9685
chase@mayhughcommercial.com