

F R E M O N T

I N D U S T R I A L P A R K

📍 48541 WARM SPRINGS BLVD., FREMONT, CA



NEWMARK

FOR
LEASE

±61,340 SF

SUITE 509

▶ **JOE KELLY**
408.987.4111
joe.kelly@ngkf.com
CA RE License #01420963

FEATURES

- ±61,340 SF for Lease
- ±9,500 SF HVAC office area
- 1200 amps, 480 volt, 3 phase
- 24' minimum clear height
- 1.6/1,000 parking
- 17 dock high doors
- 4 grade level doors
- Sprinklers: .45/2,000 GPM
- Available July 1, 2021
- CALL TO TOUR

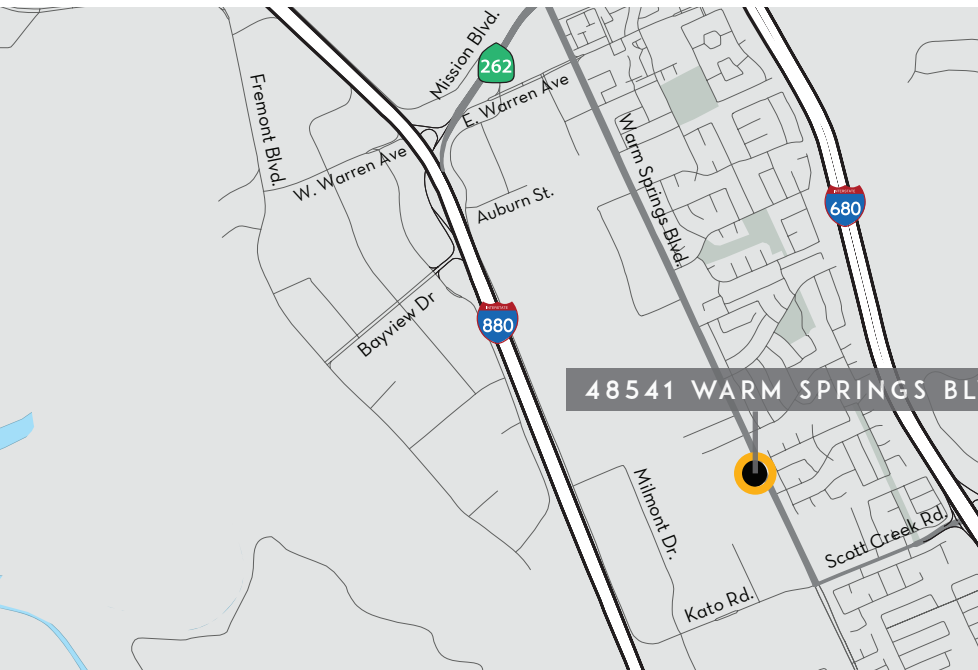

48541 WARM SPRINGS BLVD.



F R E M O N T
I N D U S T R I A L P A R K

AERIAL MAP



FREMONT
INDUSTRIAL PARK



± 61,340 SF
AVAILABLE

SUITE 509



48541 WARM SPRINGS BLVD., FREMONT, CA

REGIONAL MAP

 **Caltrain Route**

 **BART Route**

Proposed BART Route

 **AMTRAK**

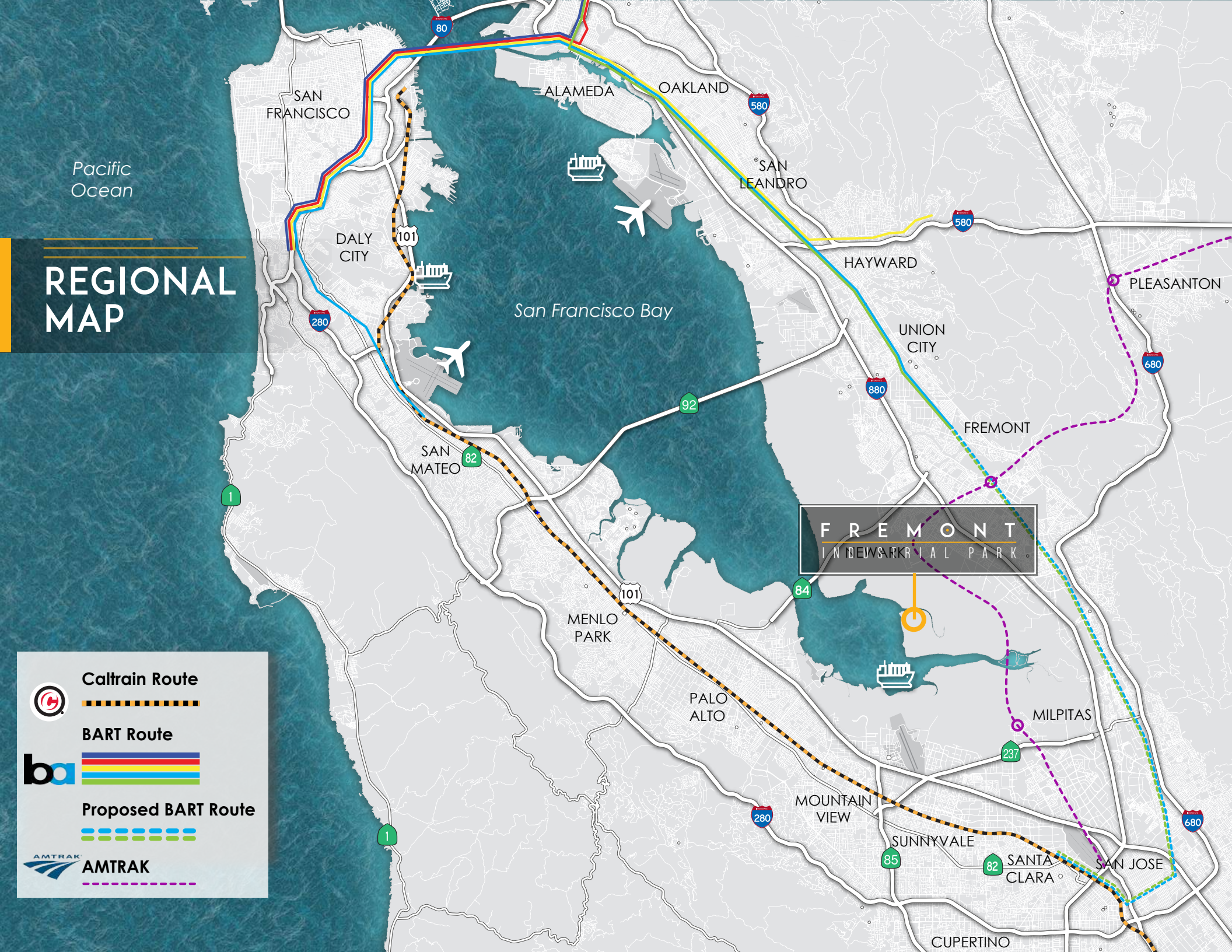

FLOORPLAN

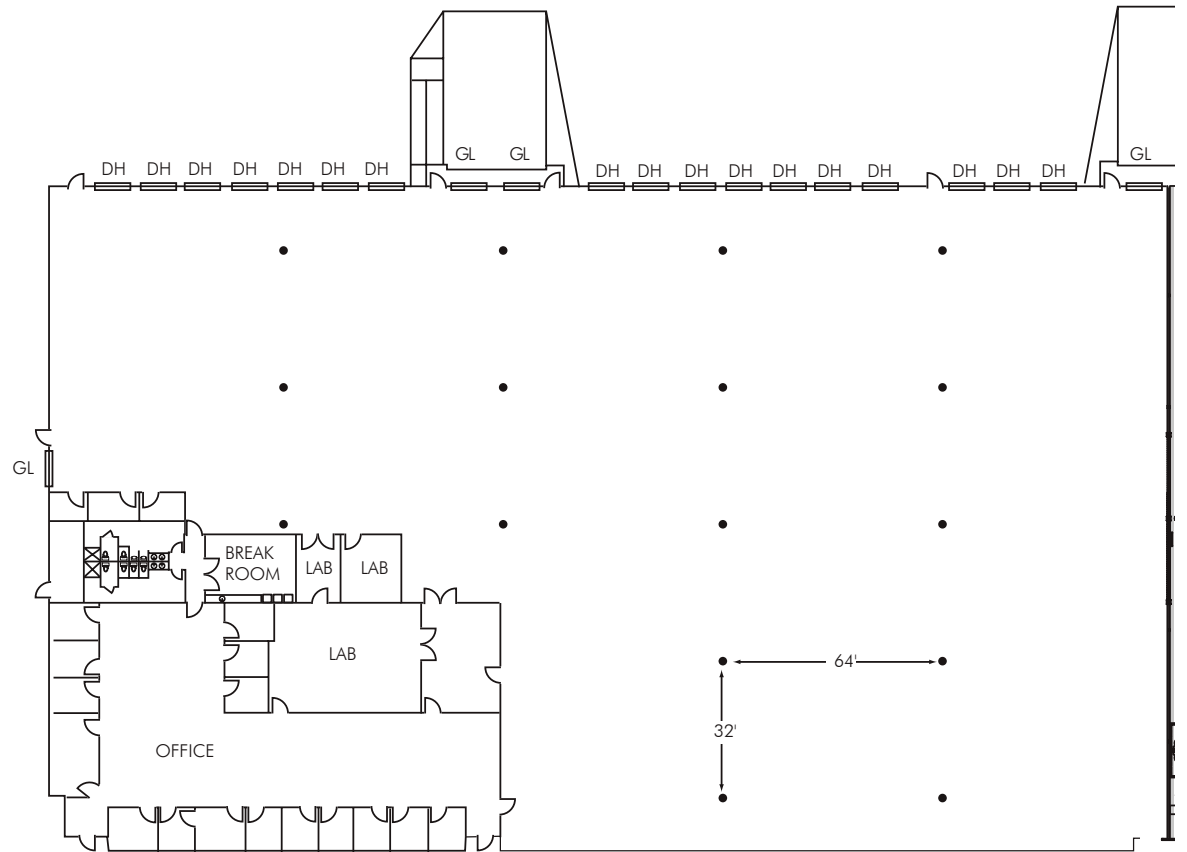

F R E M O N T

INDUSTRIAL PARK

AVAILABLE FOR LEASE

SUITE 509
± 61,340 SF

48541 WARM SPRINGS BLVD., FREMONT, CA

3055 OLIN AVENUE, SUITE 2200, SAN JOSE, CA 95128

NEWMARK

The distributor of this communication is performing acts for which a real estate license is required. The information contained herein has been obtained from sources deemed reliable but has not been verified and no guarantee, warranty or representation, either express or implied, is made with respect to such information. Terms of sale or lease and availability are subject to change or withdrawal without notice. 19-0427 | 01/21

▶ **JOE KELLY**
408.987.4111
joe.kelly@ngkf.com
CA RE License #01420963