

230 COMMERCIAL STREET

Sunnyvale, California | ±4,025 SF For Lease



Kelly Yoder
Director

P +1 408 615 3427
kelly.yoder@cushwake.com
LIC #01821117

Steve Horton
Executive Vice Chairman

P +1 408 615 3412
steve.horton@cushwake.com
LIC #01127340



300 Santana Row, Fifth Floor
San Jose, California 95128

P +1 408 615 3400
F +1 408 615 3444

www.cushmanwakefield.com

230 COMMERCIAL STREET

Sunnyvale, California

SUITE 130: ±4,025 SF

- 50% Office, 50% Warehouse
- Grade Level Loading
- ±3/1,000 Parking
- Sprinklered
- Shared Fenced Yard
- Available Now

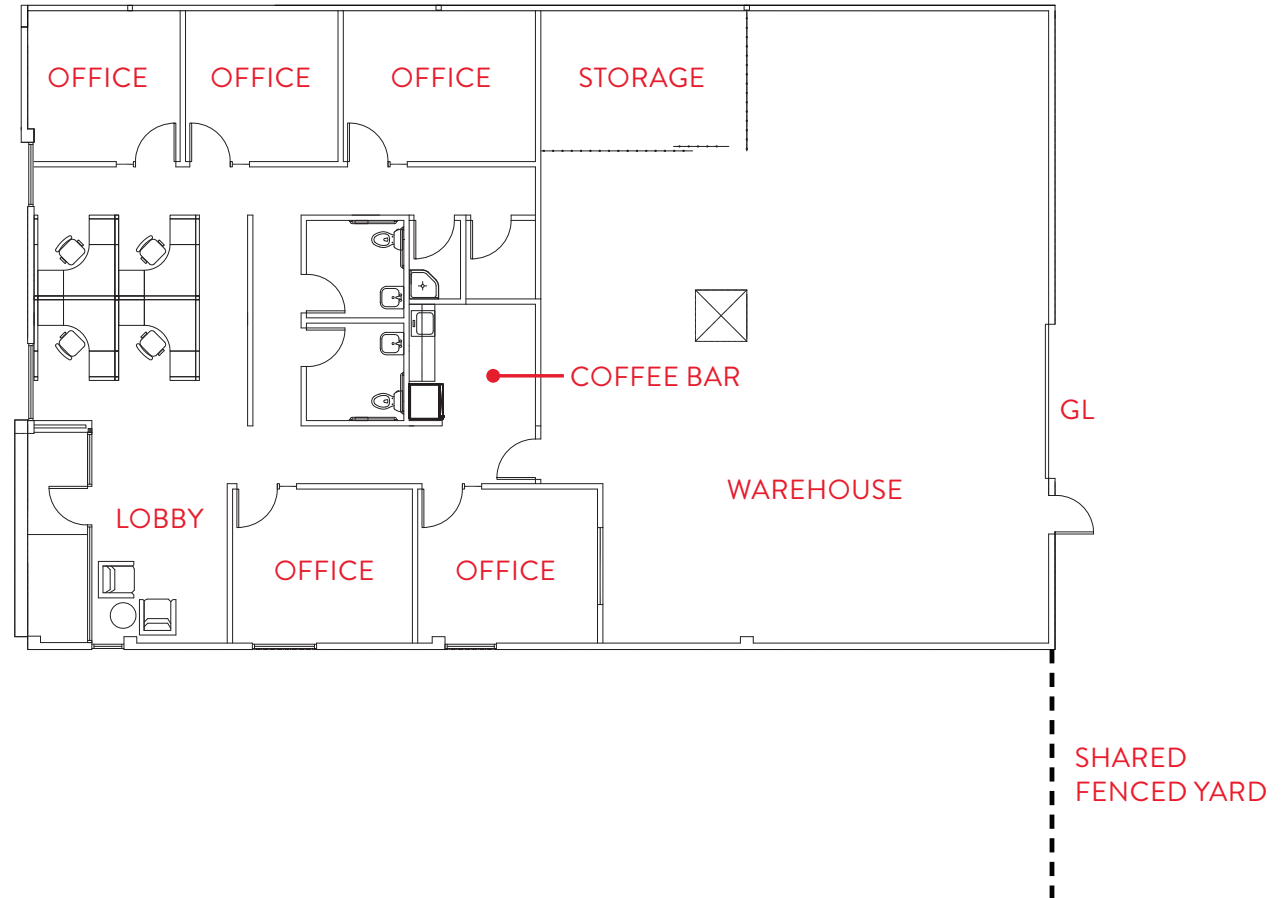

230 COMMERCIAL STREET

Sunnyvale, California



230 COMMERCIAL STREET

Sunnyvale, California

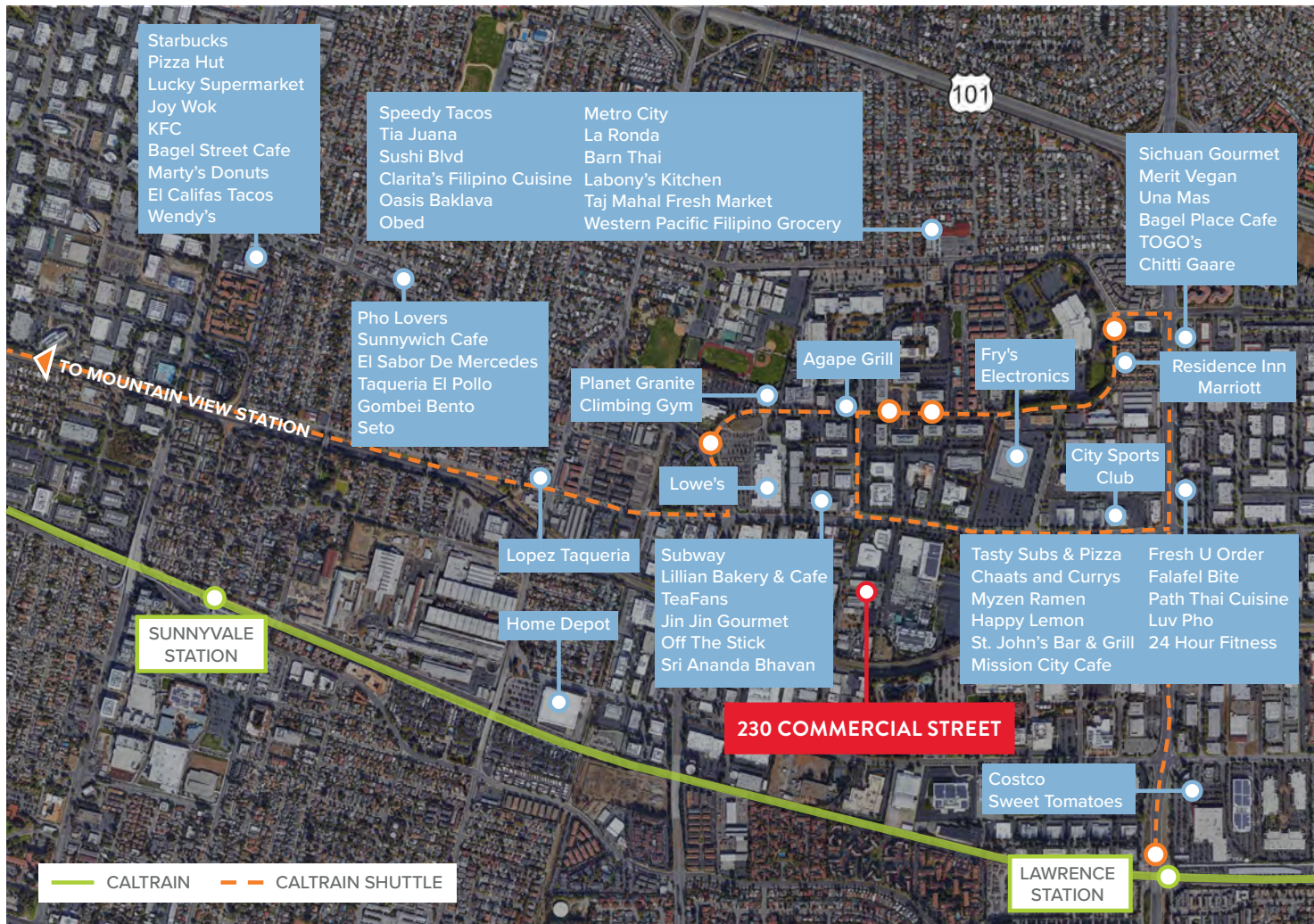

230 COMMERCIAL STREET

Sunnyvale, California | ±4,025 SF For Lease

Kelly Yoder
Director

P +1 408 615 3427
kelly.yoder@cushwake.com
LIC #01821117

Steve Horton
Executive Vice Chairman

P +1 408 615 3412
steve.horton@cushwake.com
LIC #01127340



300 Santana Row, Fifth Floor
San Jose, California 95128

P +1 408 615 3400
F +1 408 615 3444

www.cushmanwakefield.com