



# Prime Evansville Retail Space

5700 E Virginia St. Evansville, IN 47715



## Details:

- \$11/SF NNN
- Pylon signage
- High Visibility
- Close proximity to big box stores
- Free rent available - ask broker for details

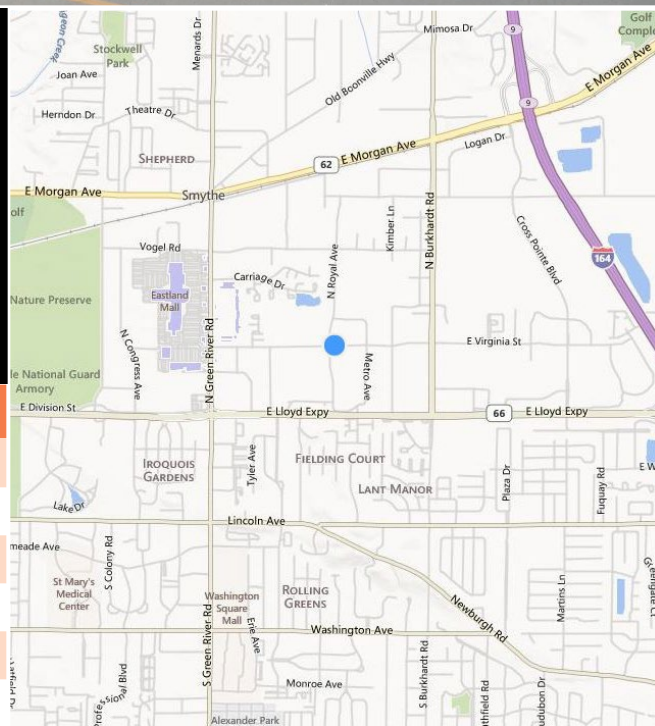

Suite	SF	Features
5618	2,000	Four offices, restroom, rear entrance
5622	2,000	Three offices, rear entrance
5708	2,000	Two offices, restroom
5710	2,000	Rear entrance
5714	2,000	Restroom, rear entrance
5720	6,000	His and hers restrooms, rear entrance

**Keith Dedrick SIOR, CCIM**  
 Cell: 317-502-3622  
 E-mail: keith@ccgbrokers.com

**Corporate Commercial Group**  
 11495 N Pennsylvania, Suite 225 Carmel, IN 46032  
 Office: 317-818-1941  
 Fax: 317-818-1943





# Prime Evansville Retail Space

5700 E Virginia St. Evansville, IN 47715



**Keith Dedrick SIOR, CCIM**

Cell: 317-502-3622

E-mail: keith@ccgbrokers.com

**Corporate Commercial Group**

11495 N Pennsylvania, Suite 225 Carmel, IN 46032

Office: 317-818-1941

Fax: 317-818-1943





# Prime Evansville Retail Space

5700 E Virginia St. Evansville, IN 47715

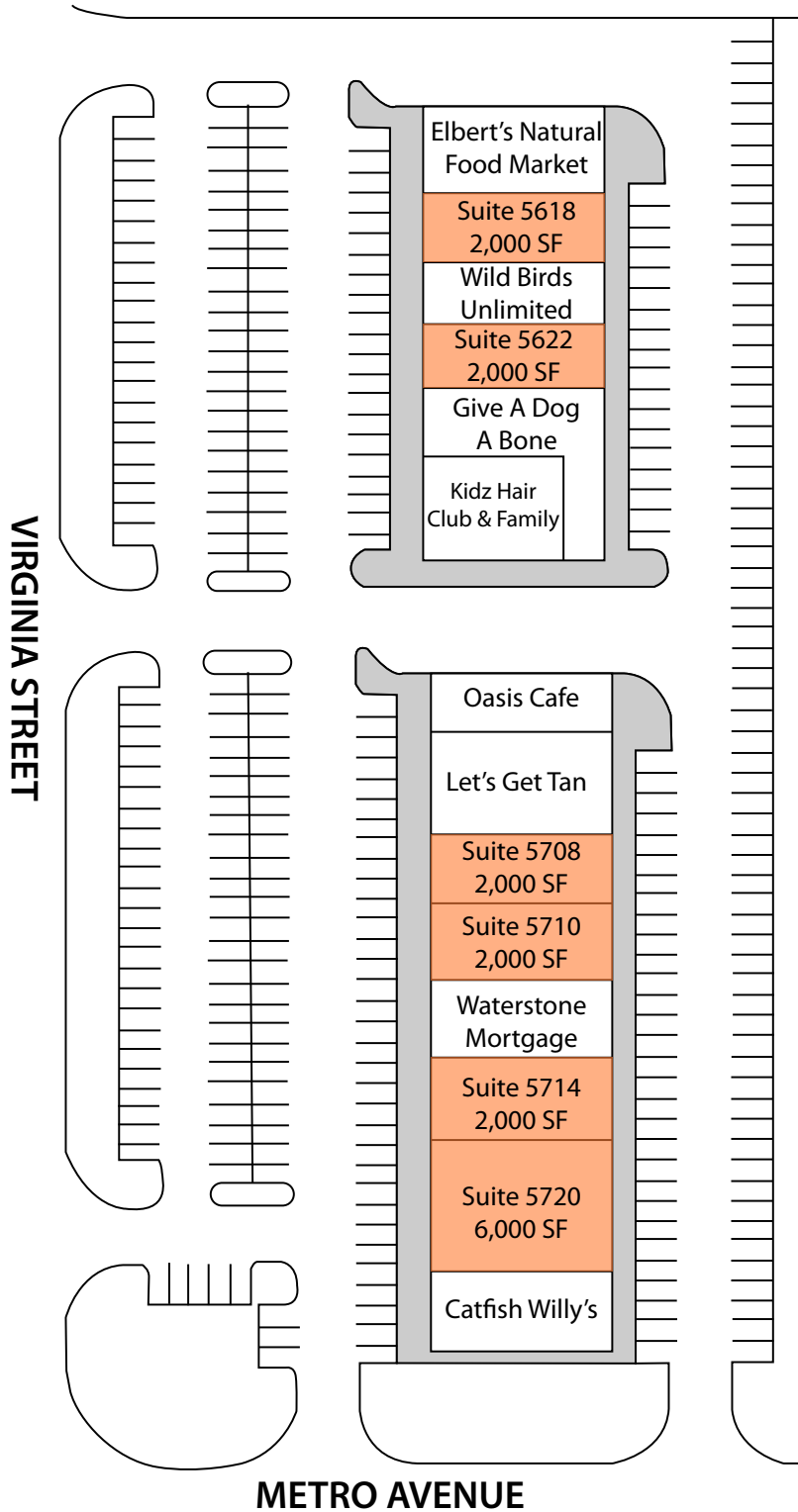

**Keith Dedrick** SIOR, CCIM

Cell: 317-502-3622

E-mail: keith@ccgbrokers.com

**Corporate Commercial Group**

11495 N Pennsylvania, Suite 225 Carmel, IN 46032

Office: 317-818-1941

Fax: 317-818-1943





# Prime Evansville Retail Space

5700 E Virginia St. Evansville, IN 47715



Measure	1 Mile Radius	3 Mile Radius	5 Mile Radius
Population 2019	5,264	59,475	123,250
Annual Population Rate	0.20%	0.38%	0.41%
Households 2019	2,586	26,444	51,917
Ave. Household Size 2019	2.02	2.18	2.30
Median Household Income 2019	\$37,037	\$43,827	\$42,786
Ave. Household Income 2019	\$59,602	\$61,743	\$60,863
Median Home Value 2019	\$164,379	\$124,356	\$118,221
Total Employed Population 2019	2,809	30,390	60,320
White Collar	69.7%	60.2%	55.1%
Services	15.6%	17.5%	20.1%
Blue Collar	14.7%	22.4%	24.7%

**Keith Dedrick SIOR, CCIM**  
 Cell: 317-502-3622  
 E-mail: keith@ccgbrokers.com

**Corporate Commercial Group**  
 11495 N Pennsylvania, Suite 225 Carmel, IN 46032  
 Office: 317-818-1941  
 Fax: 317-818-1943

