

FOR SALE

32,248 SF Industrial
Warehouse Building

2315 S. Keeler Avenue
CHICAGO, IL 60623



Property Aerial

PROPERTY SPECIFICATIONS

For more information,
please contact:

MARK A. NELSON, SIOR

Principal

312 267-1101

Mark@NelsonHill.com

BRIAN C. ETTEN

Vice President

312 781-6499

BEtten@NelsonHill.com

NelsonHill

1111 S. Western Avenue
Chicago, IL 60612

All information contained herein is
from sources deemed reliable and is
submitted subject to errors, omissions
and to change of price or terms
without notice.

Building Size	± 32,248 Sq. Ft.
Land Size	± 56,628 Sq. Ft. (1.3 Acres)
Office	± 7,000 SF (2-Stories)
Ceiling Height	19' Clear
Construction	Masonry
Loading	2 Exterior Docks, 1 Drive-in-Door
Parking	25 Car Parking Spaces
Zoning	M1-2
2016 Taxes	\$15,072.95 (\$0.47 PSF)
Sale Price	\$1,575,000
Comments	<ul style="list-style-type: none">Recently renovated; new high efficiency lightingNew windows, freshly painted and updated officesLess than 10-minute walk from CTA Pink LineEasily accessible via Cicero AvenueLess than 2-miles from both the 1-290 and I-55 Expressways



FOR SALE

32,248 SF Industrial
Warehouse Building

2315 S. Keeler Avenue
CHICAGO, IL 60623

PROPERTY AERIAL



PROPERTY LOCATION

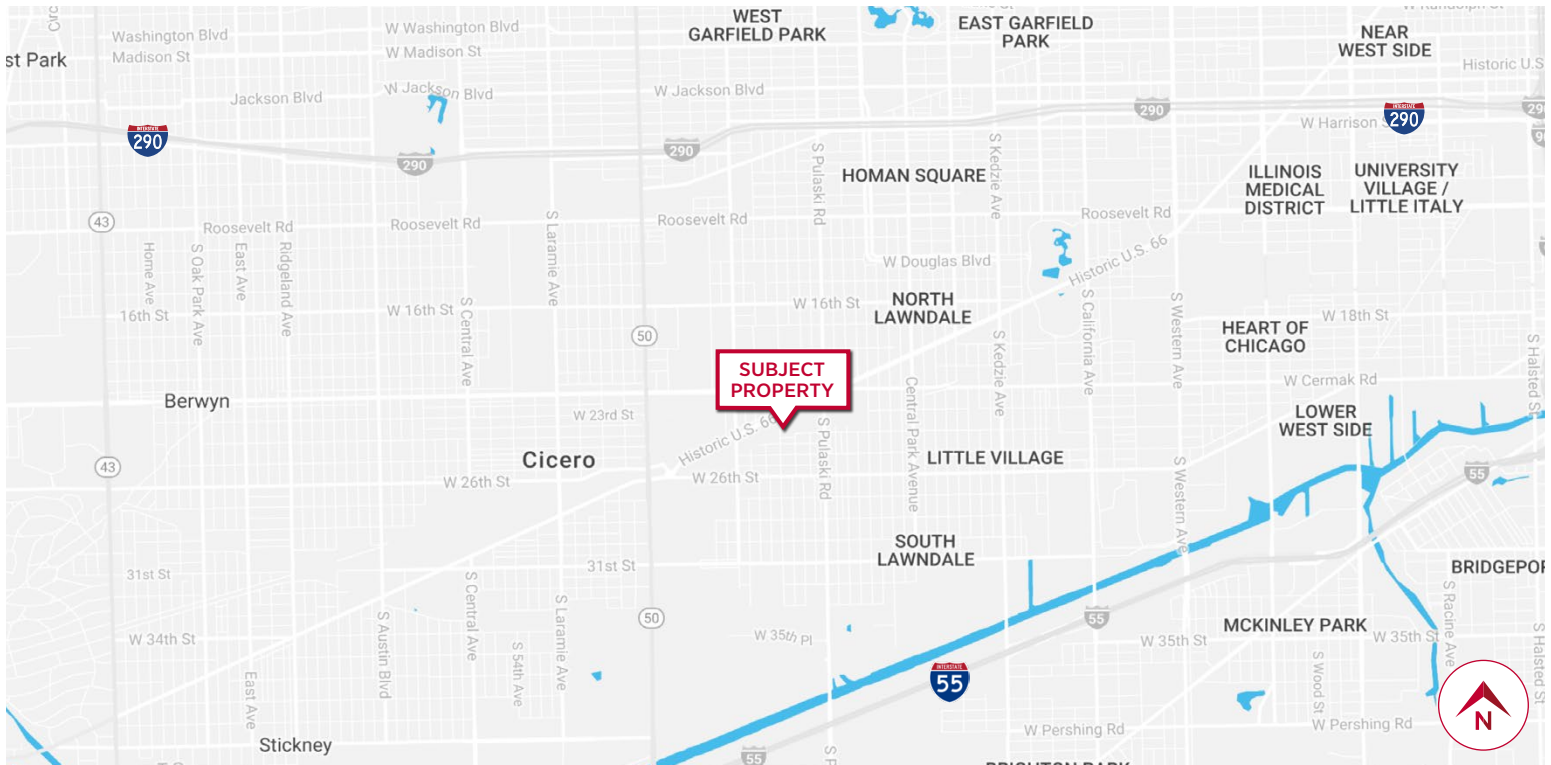

FOR SALE

32,248 SF Industrial
Warehouse Building

2315 S. Keeler Avenue
CHICAGO, IL 60623

PROPERTY EXTERIOR



PROPERTY INTERIOR

