

# 16,000 SF

## Industrial Space For Lease



## Prologis Northpark 3

533 Northpark Central Drive, Suite 100  
Houston, TX 77073 USA

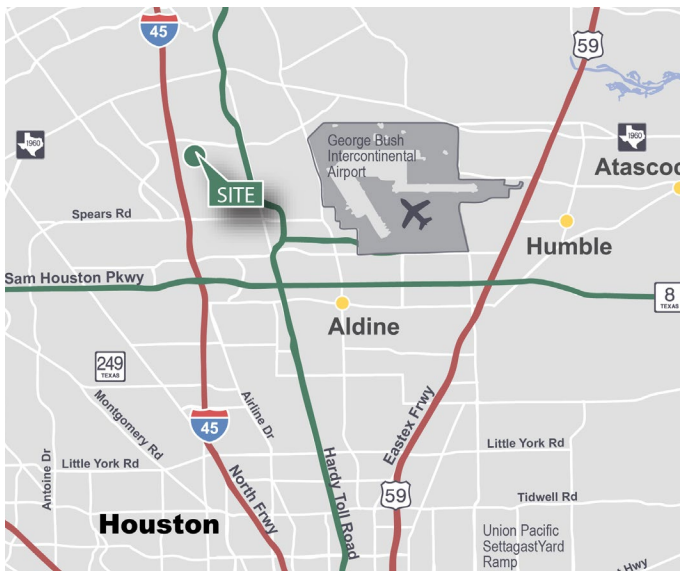

### LOCATION

- Conveniently located along I-45 North between Airtex Drive and Richey Road
- Easy access to I-45, Beltway 8 and the Hardy Toll Road
- Part of the master planned Prologis Park Northpark
- Unincorporated Harris County
- Double Freeport tax exemption

### FACILITY

- 16,000 SF available
- 100% office
- 18' clear height
- 1 dock-high door
- 30' x 40' column spacing

### ADVANTAGES AND AMENITIES

- Fully sprinklered
- 89 car parking spaces (5.5 per 1,000 SF)
- Fenced and secured parking section

# 16,000 SF

## Industrial Space For Lease

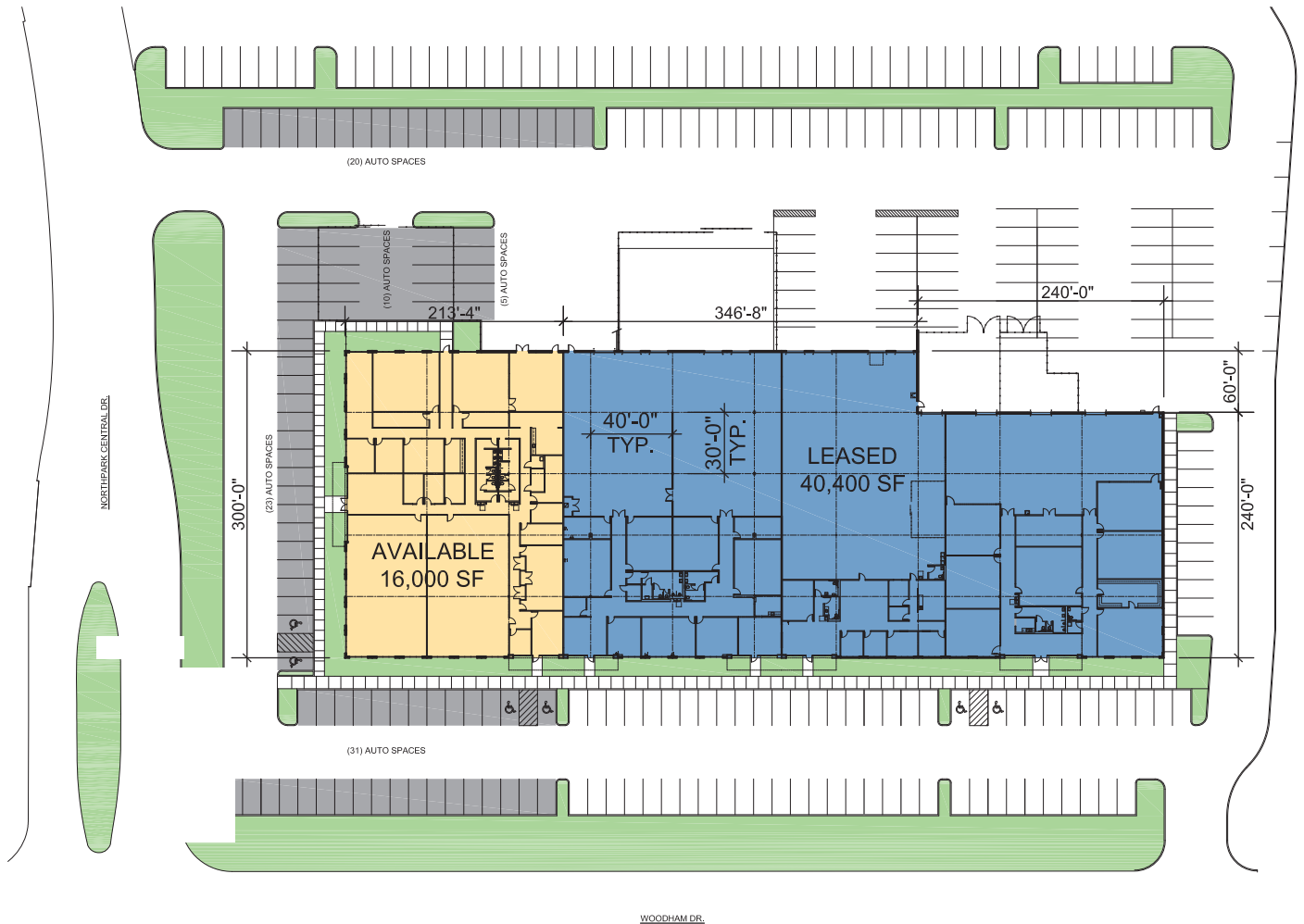

### Cushman & Wakefield

Jason Dillee

jason.dillee@cushwake.com

ph +1 713 345 1432

cell +1 832 741 0733

1330 Post Oak Blvd, Suite 2700

Houston, TX 77056 USA

### Cushman & Wakefield

Nathan Wynne

nathan.wynne@cushwake.com

ph +1 713 345 1431

cell +1 713 206 3881

1330 Post Oak Blvd, Suite 2700

Houston, TX 77056 USA

### Prologis

Alicia Pillows

anye@prologis.com

ph +1 713 613 6930

cell +1 713 409 1306

1296 North Post Oak Road

Houston, TX 77055 USA