



MEACHAM/OPPENHEIMER, INC.

Commercial Brokerage | Investment Sales | Property Management

8 N. San Pedro St., Suite 300 San Jose, California 95110

Tel: 408.378.5900 www.moinc.net

**MARINA VILLAGE
SHOPPING CENTER**
951-C Marina Village Pkwy
Alameda, CA 94501

RETAIL PAD END CAP FOR LEASE GROCERY ANCHORED CENTER

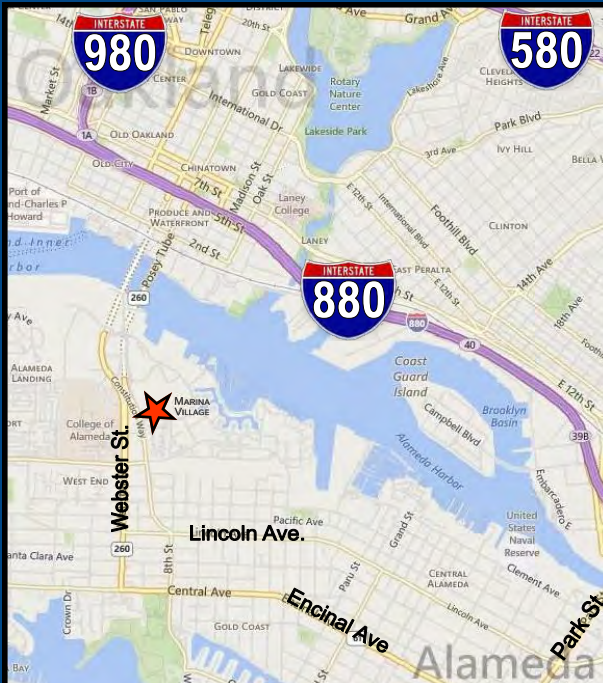

PROPERTY INFORMATION:

- Community Shopping Center, Anchored by Lucky's and CVS Pharmacy
- 972± SF End Cap Space
- \$3.00 PSF, NNN(\$1.05)
- Marina Village Co-Tenants Include Wells Fargo Bank, Goodyear Tires, Carl's Jr., 360° Burritos and Subway
- Surrounded by Large Daytime and Residential Community
- Close Proximity To Marina Village Business Park and College of Alameda

FOR MORE INFORMATION CONTACT:

MEACHAM/OPPENHEIMER, INC.

8 No. San Pedro St., Suite 300

San Jose, California 95110

Tel: 408.378.5900

www.moinc.net

Ryan Warner

Lic. #01397580

rwarner@moinc.net

(408) 477-2505 Direct

(408) 378-5900 Main

MARINA VILLAGE SHOPPING CENTER
951 Marina Village Parkway • Alameda, California 94501



ESTIMATED AREA DEMOGRAPHICS:

	<u>1 MILE</u>	<u>3 MILES</u>	<u>5 MILES</u>
POPULATION:	24,320	222,363	427,102
AVG. HH INCOME:	\$127,601	\$99,355	\$116,675
EMPLOYEES:	13,257	130,126	210,705

MEACHAM/OPPENHEIMER, INC.
8 No. San Pedro St., Suite 300
San Jose, California 95110
Tel: 408.378.5900
www.moinc.net

Ryan Warner
Lic. #01397580
rwagner@moinc.net
(408) 378-5900

MARINA VILLAGE SHOPPING CENTER
951 Marina Village Parkway • Alameda, California 94501

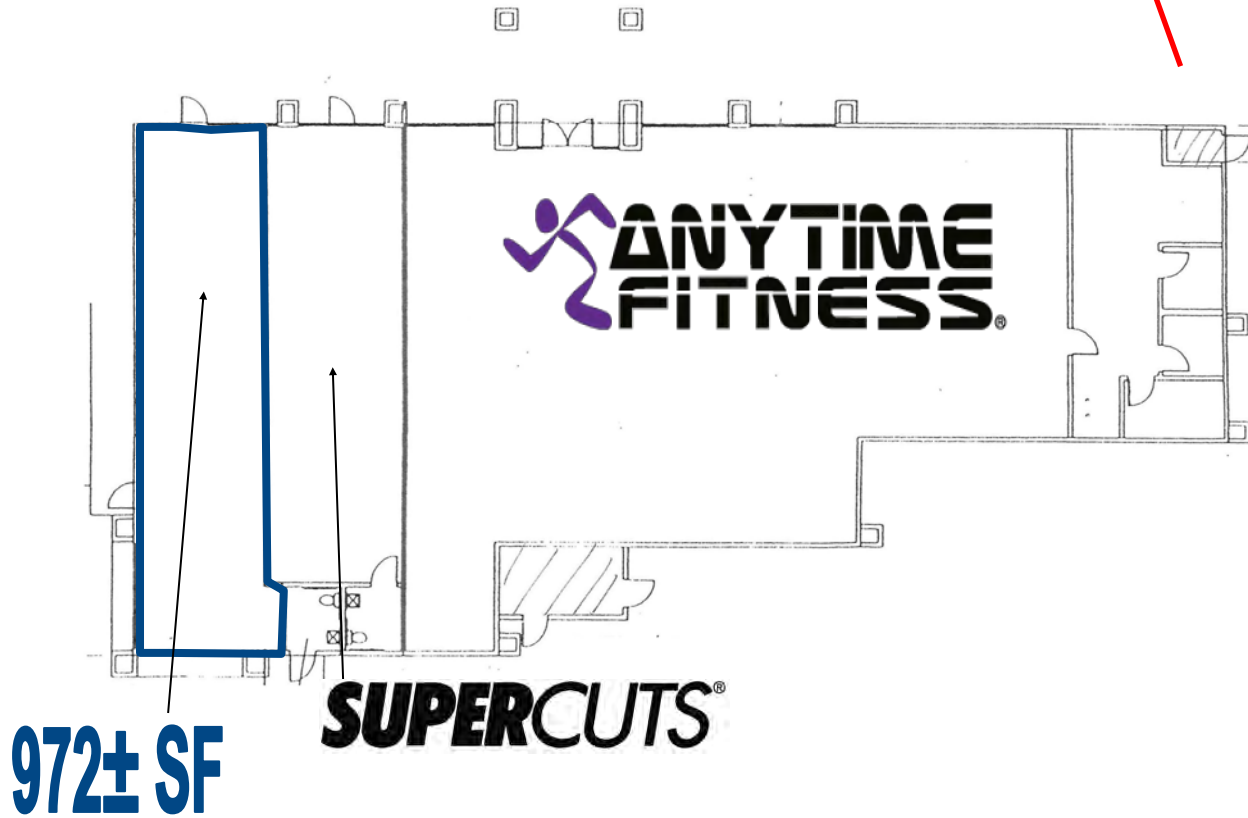

MEACHAM/OPPENHEIMER, INC.
8 No. San Pedro St., Suite 300
San Jose, California 95110
Tel: 408.378.5900
www.moinc.net

Ryan Warner
Lic. #01397580
rwarner@moinc.net
(408) 378-5900

MARINA VILLAGE SHOPPING CENTER
 951 Marina Village Parkway • Alameda, California 94501



Site Plan Not To Scale

972± SF
 AVAILABLE

SUPERCUTS®

MEACHAM/OPPENHEIMER, INC.
 8 No. San Pedro St., Suite 300
 San Jose, California 95110
 Tel: 408.378.5900
 www.moinc.net

Ryan Warner
 Lic. #01397580
rwarners@moinc.net
(408) 378-5900