



**COLDWELL  
BANKER  
COMMERCIAL**

RIO GRANDE VALLEY

## MODERN SHOPS ON 83

\$20.00 SF/yr (NNN)

AVAILABLE SPACE

1,360 - 9,768 SF



Retail

Michael Pacheco  
956 739 5172  
[michael.pacheco@cbcworldwide.com](mailto:michael.pacheco@cbcworldwide.com)

©2021 Coldwell Banker. All Rights Reserved. Coldwell Banker and the Coldwell Banker Commercial logos are trademarks of Coldwell Banker Real Estate LLC. The Coldwell Banker® System is comprised of company owned offices which are owned by a subsidiary of Realogy Brokerage Group LLC and franchised offices which are independently owned and operated. The Coldwell Banker System fully supports the principles of the Equal Opportunity Act.

COLDWELL BANKER COMMERCIAL  
RIO GRANDE VALLEY  
508 E Dove Ave, McAllen, TX 78504  
956.631.1322

FOR LEASE

[CBCWORLDWIDE.COM](http://CBCWORLDWIDE.COM)



## MODERN SHOPS ON 83

4313 S. Bentsen Road, McAllen, TX 78503

LEASE



### OFFERING SUMMARY

Available SF:	1,360 - 9,768 SF
Lease Rate:	\$20.00 YR
NNN:	\$6.00 YR
Lot Size:	1.11 Acres
Year Built:	2015
Building Size:	13,090 SF
Market:	Rio Grande Valley
Submarket:	McAllen

CBCWORLDWIDE.COM

Michael Pacheco  
956 739 5172  
michael.pacheco@cbcworldwide.com

### PROPERTY OVERVIEW

Modern Shops on 83 is perfectly situated in one of McAllen, TX's busiest, commercial, districts, and has excellent frontage on Interstate 2. The mixed-use center has great access from Interstate 2, and is surrounded by dense, mixed-use development making it an excellent location for any retail, medical or office user.

### PROPERTY HIGHLIGHTS

- Proximity to Shopping, Dining and Entertainment
- Excellent Visibility Frontage on Interstate 2
- Heavy Traffic Location
- Expressway Frontage





# MODERN SHOPS ON 83

4313 S. Bentsen Road, McAllen, TX 78503

LEASE



CBCWORLDWIDE.COM

Michael Pacheco  
956 739 5172  
michael.pacheco@cbcworldwide.com

 **COLDWELL  
BANKER  
COMMERCIAL**  
RIO GRANDE VALLEY



# MODERN SHOPS ON 83

4313 S. Bentsen Road, McAllen, TX 78503

LEASE

### KEYED NOTES

① PLUMBING LEAVEOUT

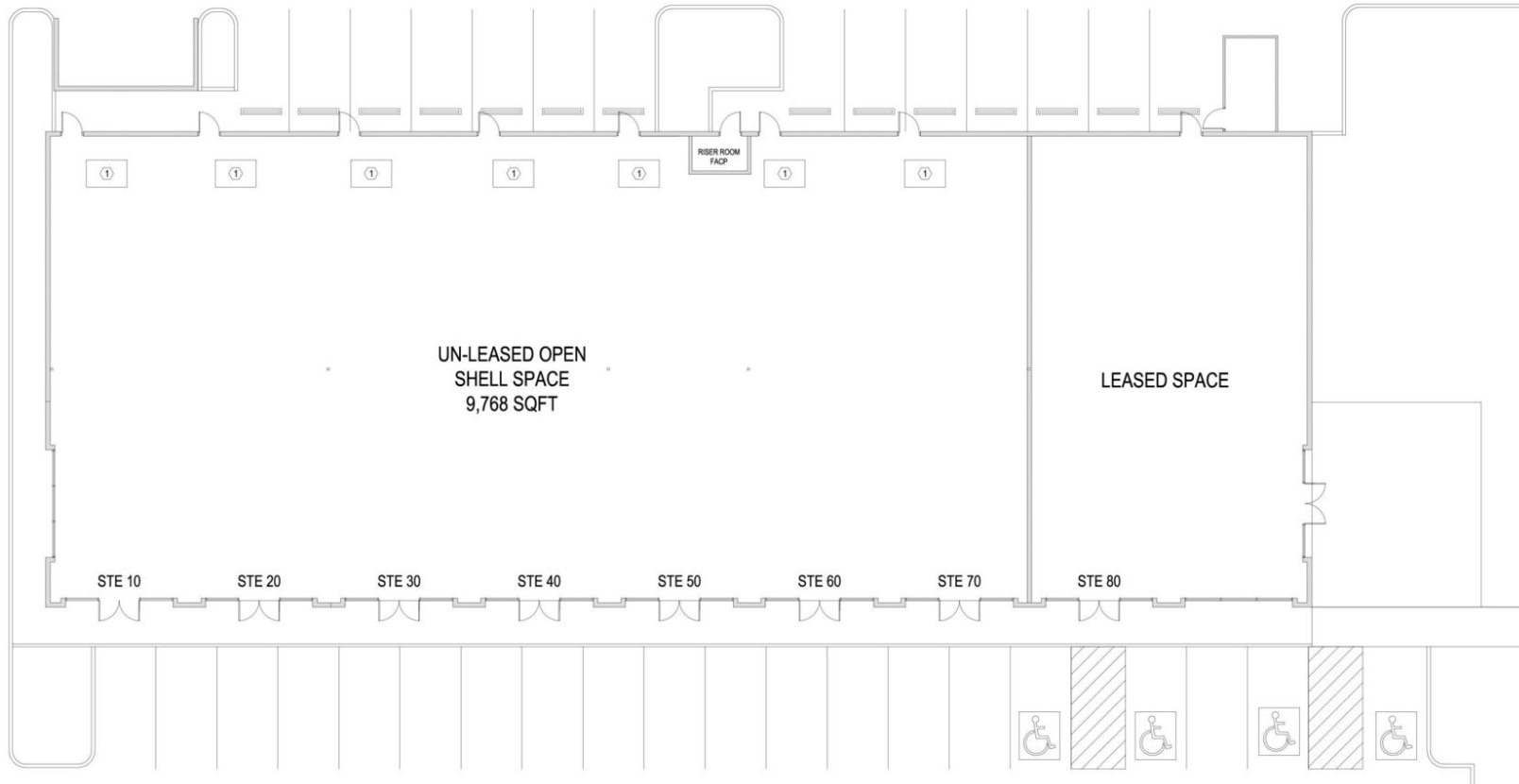

① 4313 S. BENTSEN RD FLOOR PLAN  
NORTH SCALE: 1/16" = 1'-0"

CBCWORLDWIDE.COM

Michael Pacheco  
956 739 5172  
michael.pacheco@cbcworldwide.com



## MODERN SHOPS ON 83

4313 S. Bentsen Road, McAllen, TX 78503

LEASE

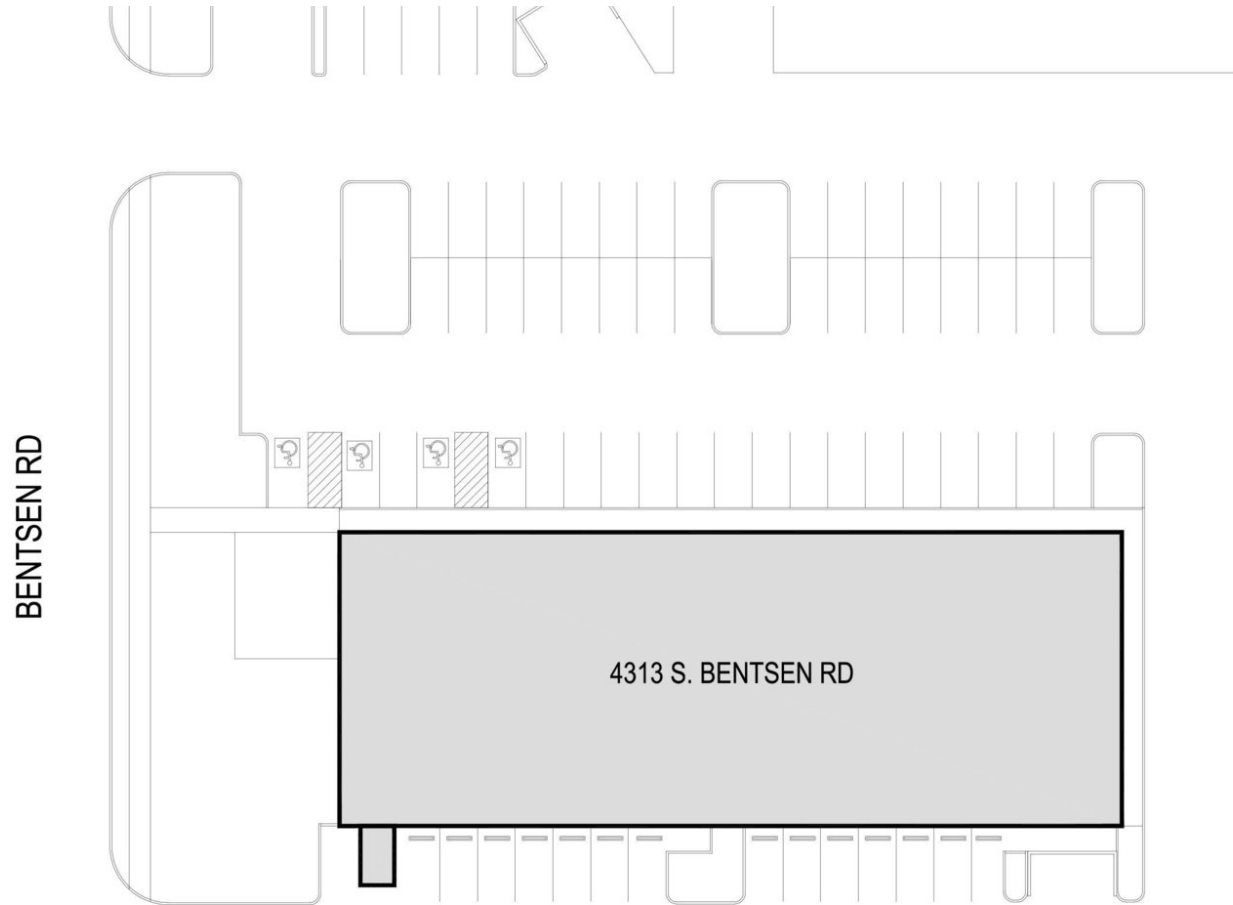

▲ 4313 S. BENTSEN RD SITE PLAN

CBCWORLDWIDE.COM

Michael Pacheco  
956 739 5172  
michael.pacheco@cbcworldwide.com



## MODERN SHOPS ON 83

4313 S. Bentsen Road, McAllen, TX 78503

LEASE

### LEASE INFORMATION

Lease Type:	NNN	Lease Term:	Negotiable
Total Space:	1,360 - 9,768 SF	Lease Rate:	\$20.00 SF/yr

### AVAILABLE SPACES

SUITE	TENANT	SIZE (SF)	LEASE TYPE	LEASE RATE
4313 S. Bentsen Road, Ste 1	Available	1,360 - 9,768 SF	NNN	\$20.00 SF/yr
4313 S. Bentsen Road, Ste 2	Available	1,360 - 9,768 SF	NNN	\$20.00 SF/yr
4313 S. Bentsen Road, Ste 3	Available	1,360 - 9,768 SF	NNN	\$20.00 SF/yr
4313 S. Bentsen Road, Ste 4	Available	1,360 - 9,768 SF	NNN	\$20.00 SF/yr
4313 S. Bentsen Road, Ste 5	Available	1,360 - 9,768 SF	NNN	\$20.00 SF/yr
4313 S. Bentsen Road, Ste 6	Available	1,360 - 9,768 SF	NNN	\$20.00 SF/yr
4313 S. Bentsen Road, Ste 7	Available	1,360 - 9,768 SF	NNN	\$20.00 SF/yr

CBCWORLDWIDE.COM

Michael Pacheco  
 956 739 5172  
 michael.pacheco@cbcworldwide.com





## MODERN SHOPS ON 83

4313 S. Bentsen Road, McAllen, TX 78503

LEASE

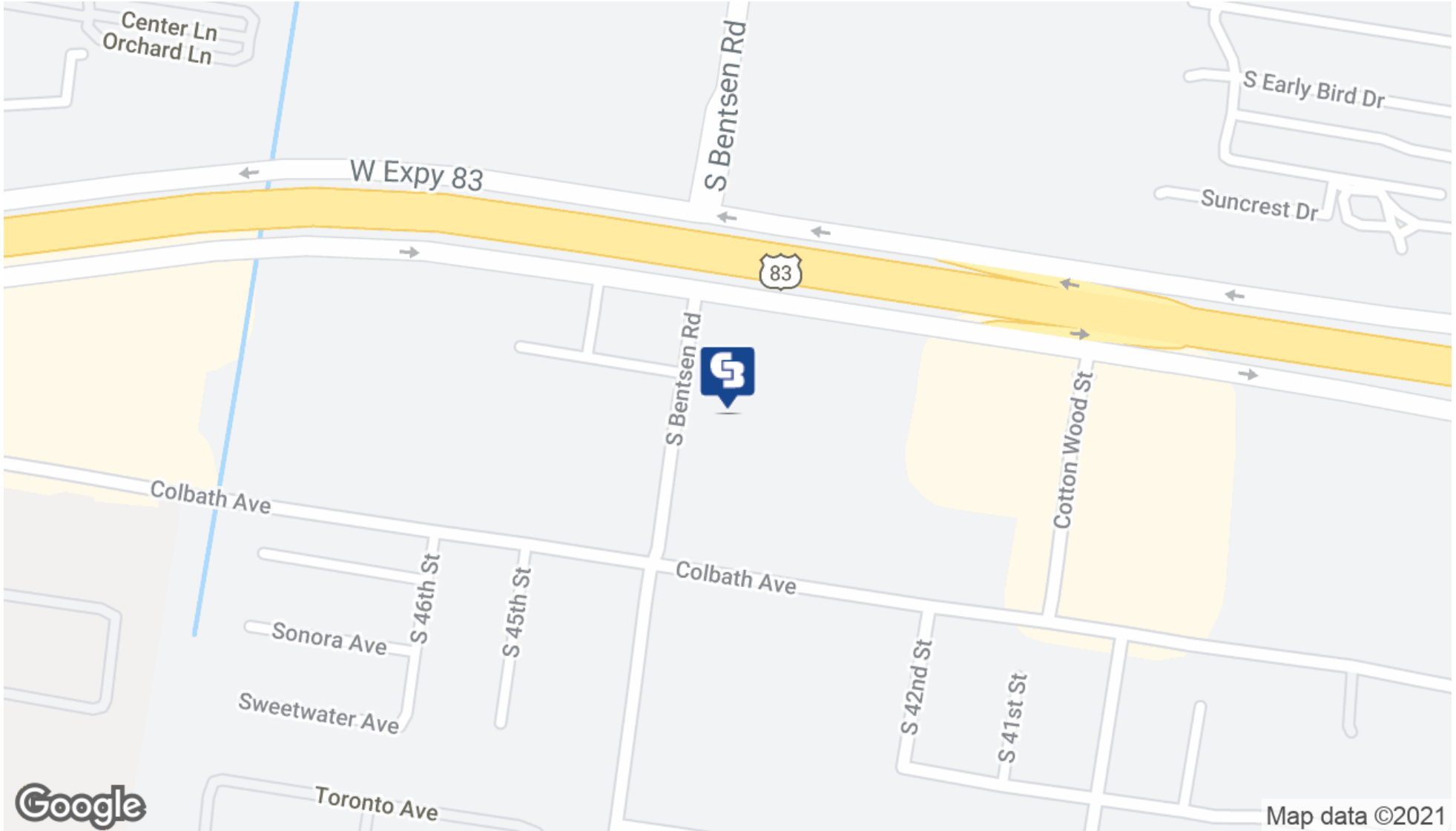

CBCWORLDWIDE.COM

Michael Pacheco  
956 739 5172  
michael.pacheco@cbcworldwide.com

 **COLDWELL  
BANKER  
COMMERCIAL**  
RIO GRANDE VALLEY





## MODERN SHOPS ON 83

4313 S. Bentsen Road, McAllen, TX 78503

LEASE

POPULATION	1 MILE	3 MILES	5 MILES
Total Population	6,125	68,403	169,258
Average age	32.5	33.9	32.2
Average age (Male)	30.2	32.1	30.8
Average age (Female)	34.2	35.2	33.5

HOUSEHOLDS & INCOME	1 MILE	3 MILES	5 MILES
Total households	1,934	21,185	52,645
# of persons per HH	3.2	3.2	3.2
Average HH income	\$37,558	\$49,565	\$54,033
Average house value	\$64,700	\$125,978	\$140,049

\* Demographic data derived from 2010 US Census

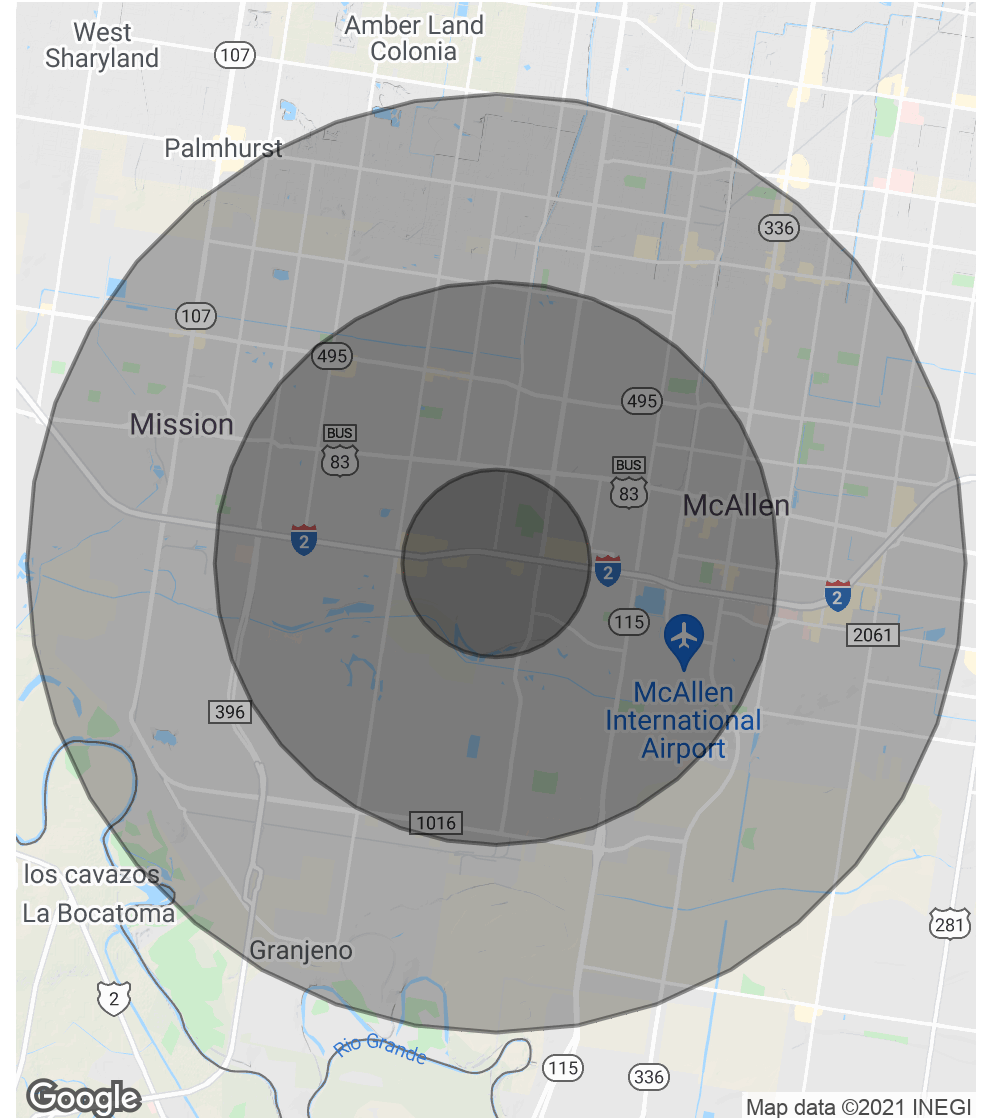

CBCWORLDWIDE.COM

Michael Pacheco  
 956 739 5172  
 michael.pacheco@cbcworldwide.com