

FOR LEASE

6820 - 6978 Kimball Drive
Gig Harbor, WA 98335



GIG HARBOR WATERFRONT



KIMBALL DRIVE



7,000 CPD

WET COAST
RESTAURANT COMPANY



68,000 CPD

PIONEER WAY



PIONEER PLAZA & KIMBALL CENTER

Jeremiah Durr | Don Whittles

First Western Properties—Tacoma Inc. | 253.472.0404
6402 Tacoma Mall Blvd, Tacoma, WA 98409 | fwp-inc.com

PIONEER PLAZA/KIMBALL CENTER is a staple property in the Gig Harbor market located at the central Wollochet exit. The center has excellent access and visibility from Hwy 16, Pioneer Way and Kimball Drive.

6820 - 6978 KIMBALL DRIVE:

- Excellent location just off Highway 16
- Centrally located in the Gig Harbor market
- Direct access from 4 points off Kimball Drive
- Immediate access to all directions on Highway 16



Population



Average HH Income



Daytime Population

Regis - 2018

	Population	Average HH Income	Daytime Population
Mile 1	6,073	\$108,976	7,649
Mile 3	24,983	\$124,364	22,996
Mile 5	63,260	\$123,553	42,976

TENANTS



LOCATION DETAILS



68,000 CPD
HWY 16



10,000 CPD
Pioneer Way



Centrally located in
Gig Harbor market



3.6 miles from
Tacoma Narrows Bridge

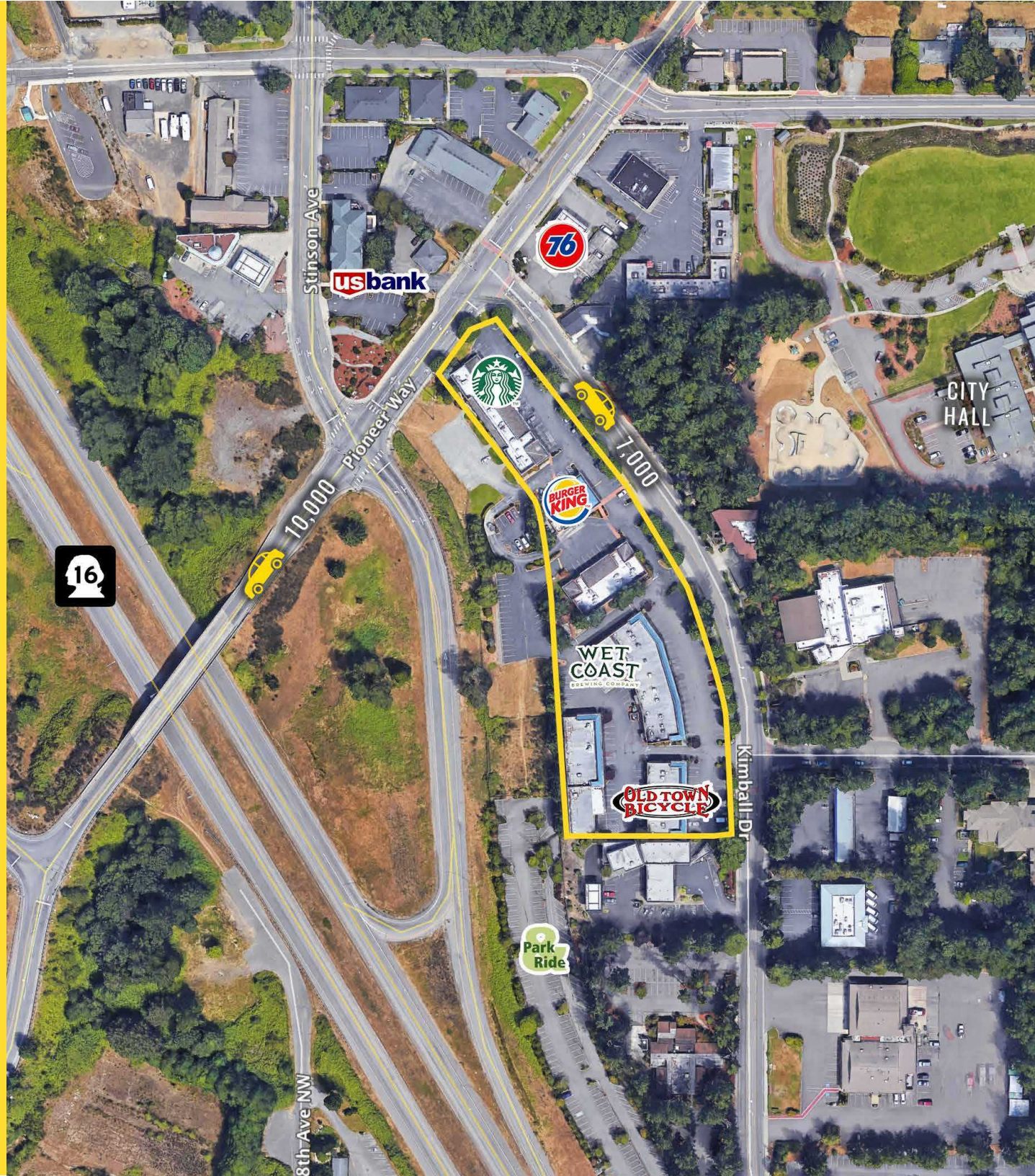

PIONEER PLAZA

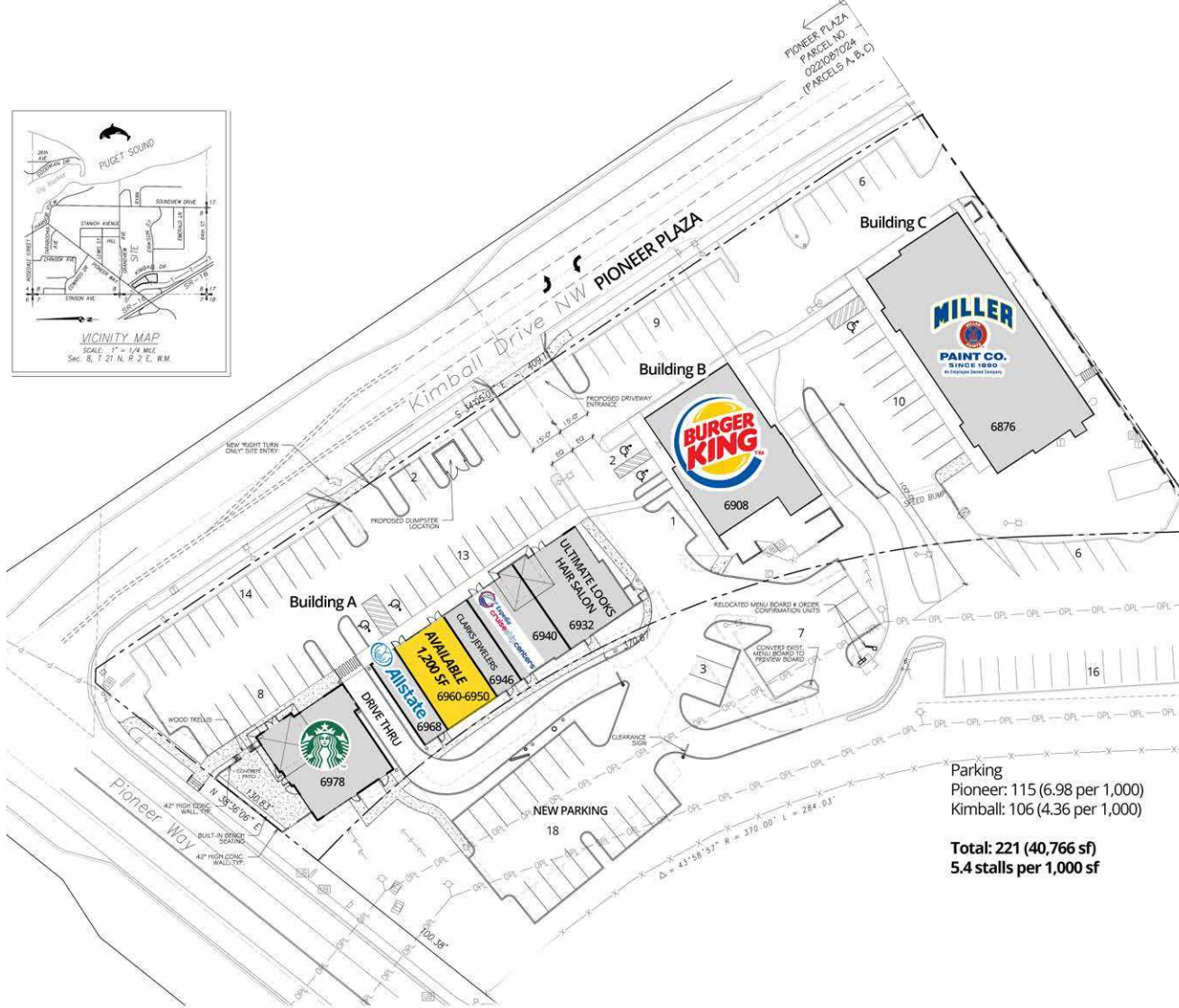
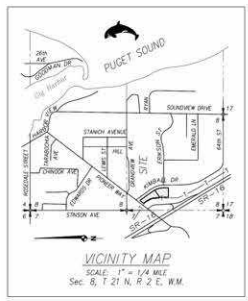

Suite	SF	Tenant	Rate
6978	2,072	Starbucks	Leased
6968	615	Allstate Insurance	Leased
6960 - 6950	1,200	AVAILABLE	\$29 PSF, NNN
6946	596	Clark's Jewelers	Leased
6940	1,216	Expedia CruiseShipCenters	Leased
6932	1,632	Ultimate Looks Hair Design	Leased
6908	3,285	Burger King	Leased
6876	5,855	Miller Paint	Leased

KIMBALL CENTER



Suite	SF	Tenant	Rate
6820A #1, #2	1,616	Kinza Teriyaki	Leased
6820A #3	813	The Village Barber	Leased
6820A #4	1,175	Subway	Leased
6820A #5, #61/2	1,363	Microlynx	Leased
6820A #61/2, #7, #8	2,281	Wild Birds Unlimited	Leased
6820A #8 #9/680C #3	4,683	Wet Coast Brewery	Leased
6820B #1, #2, #3	2,800	Old Town Bicycle	Leased
6820B #4	894	TNT Nail & Spa	Leased
6820B #5	600	CPR Cell Phone Repair	Leased
6820B #6	900	AVAILABLE	\$26 PSF, NNN
6823D&E	7,170	Harbor Dance	Leased

SITE PLAN

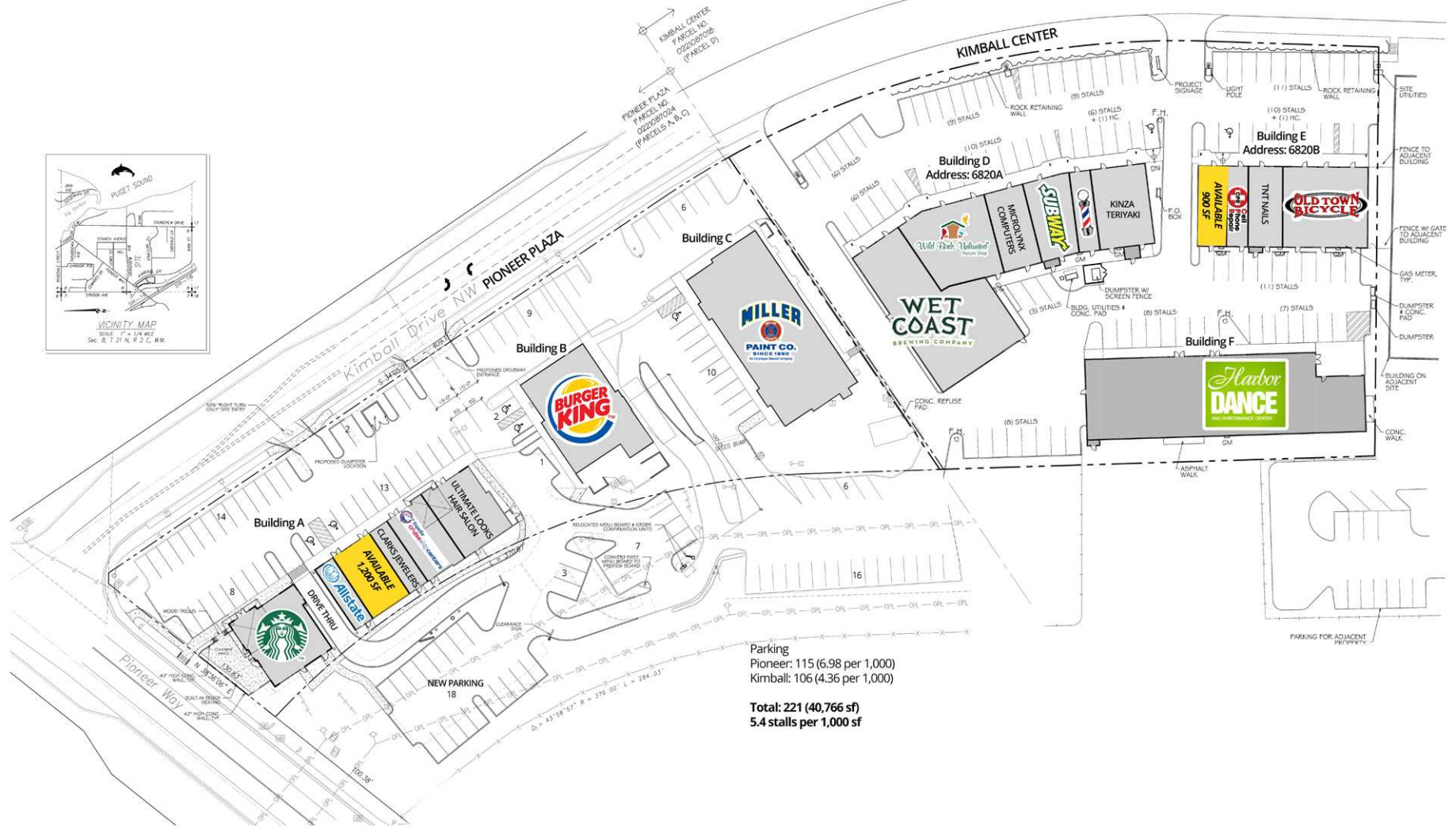

TACOMA | KIRKLAND | PORTLAND | SEATTLE



RETAIL FOCUSED. RESULTS DRIVEN.

JEREMIAH DURR

253.471.5506
jdurr@firstwesternproperties.com

DON WHITTLES

253.471.5509
dwhittle@firstwesternproperties.com



First Western Properties—Tacoma Inc. | 253.472.0404
6402 Tacoma Mall Blvd, Tacoma, WA 98409 | fwp-inc.com

© First Western Properties, Inc. DISCLAIMER: The above information has been secured from sources believed to be reliable, however, no representations are made to its accuracy. Prospective tenants or buyers should consult their professional advisors and conduct their own independent investigation. Properties are subject to change in price and/or availability without notice.