

FOR SALE

Office Building / Development Opportunity



554 Long Hill Rd., Groton, CT 06340

FOR SALE
\$360,000

Norm Peck

**PEQUOT
COMMERCIAL**

15 Chesterfield Road, Suite 4
East Lyme, CT 06333

860-447-9570 x133
860-444-6661 Fax
npeck@pequotcommercial.com

- > 3,276sf three story building, well-maintained inside and out.
- > Located on 0.94 acre with 80' road frontage
- > Main Retail district; High visibility with 22,200 Daily Average Traffic counts
- > Currently fully occupied
- > Only 1/2 mile to I-95
- > Zone OMF—Office/Multi Family
- > 23 Parking spaces
- > Taxes \$7,514
- > Public Water/Sewer. Heat Pump
- > Development or re-development potential

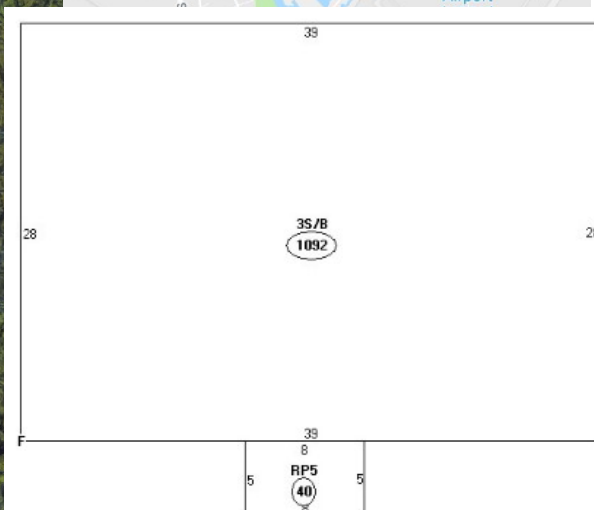
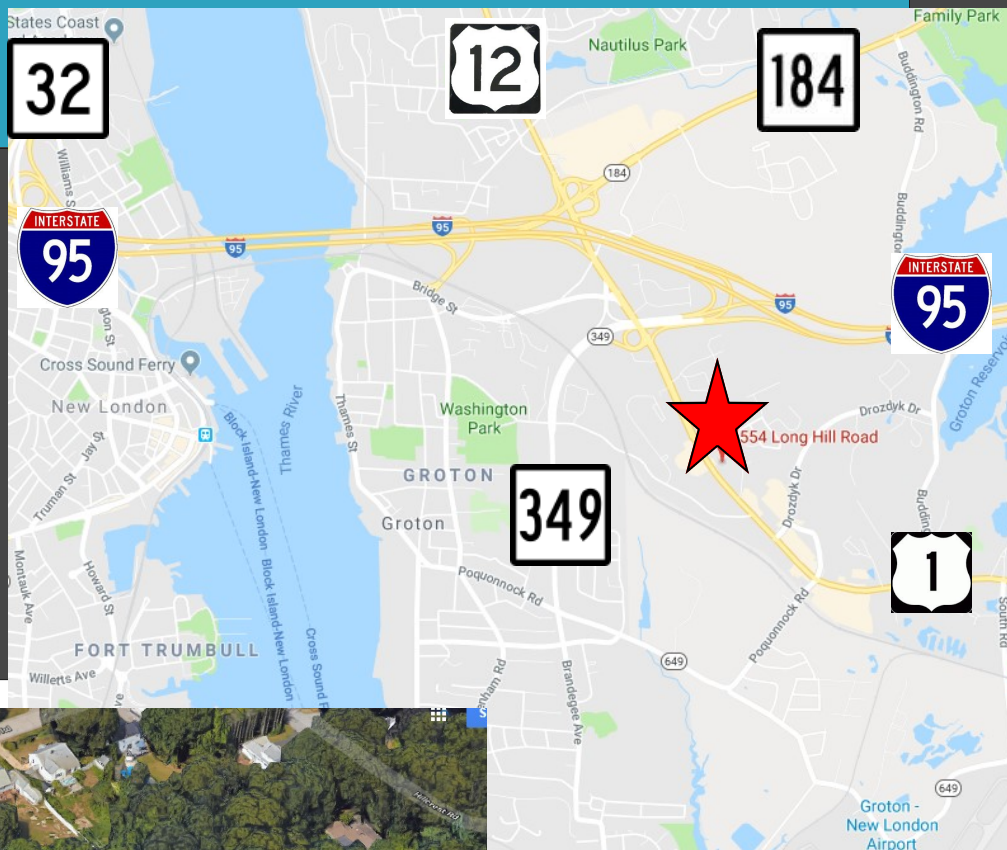

DEMOGRAPHICS	3 MILE	5 MILE	10 MILE
Total Population	49,021	81,015	140,787
Total Households	19,865	32,877	57,601
Household Income \$0—\$30,000	30.41%	25.24%	19.77%
 \$30,001-\$60,000	24.93%	23.10%	22.29%
 \$60,001-\$100,000	23.87%	22.97%	23.48%
 \$100,001+	20.80%	28.69%	34.46%

Information deemed reliable but not guaranteed and offerings subject to errors, omissions, change of price or withdrawal without notice.

5.1-3 TABLE OF PERMITTED USES														Sheet 1
PERMITTED USES	RESIDENTIAL DISTRICTS				COMMERCIAL DISTRICTS *					INDUSTRIAL DISTRICTS				SECTION
	RS	R	RMF	RU	OMF	CA	CB	DD	WF	IA	IPA	IPB	IPC	
RESIDENTIAL														
One Family Dwelling	X	X	C	X	X	X	X		X				C	7.1-20
Two Family Dwelling		X	C	C	X	X	X		X				C	7.1-20
Multi-Family Dwelling			C		C	C		C	C					7.1-16
Boarding and Rooming House			C	X	X	X	X		X					7.1-20
Hotel or Motel					X	X	X	X		X	C	C		7.1-31
Executive Hotel/Motel Suites					C	C	C	C		C	C	C		7.1-28
Mobile Home Parks (existing)	C	C	C	C	C	C	C	C	C	C	C	C	C	7.1-15
Residential Life Care Communities	C	C	C	C	C	C		C			C	C	C	7.1-1
Caretaker/Security Service Dwelling	AC	AC	AC	AC	AC	AC	AC	AC	AC	AC	A	AC	AC	7.1-30
Accessory Apartments	AC	AC	AC	AC	AC	AC	AC		AC				AC	7.1-34
Community Residential Counseling Facility			C		C	C	C	C						7.1-37
Active Senior Housing	C	C	C	C	C	C							C	7.1-45
SIGNS														
Accessory	AC	AC	AC	AC	AC	AC	AC	AC	AC	AC	AC	AC	AC	7.3
Non-Accessory						C	C	C		C				7.3
AGRICULTURAL AND RESOURCE ACTIVITIES														
Commercial Farm or Nursery	C	C	C	C	C	C	C	C		C	C	C	C	7.1-9
Filling or Extraction of Earth Products	C	C	C	C	C	C	C	C	C	C	C	C	C	7.1-10
Keeping of Hens	AC	AC	AC	AC	AC	AC	AC	AC	AC	AC	AC	AC	AC	7.1-47
* For uses permitted in MX zones, see Section 6.13-4														

X - the use is Permitted as a matter of right, subject to applicable district regulations

C - the use is Permitted in the designated district but subject to both applicable district regulations and the special conditions set forth in Section 7.1.

A - the use is Permitted only as an accessory use in the designated district

5-4

C - the use is Permitted in the designated district but subject to both applicable district regulations and the special conditions set fourth in Section 7.1.

A - the use is Permitted only as an accessory use in the designated district

5.1-3 TABLE OF PERMITTED USES														Sheet 3
PERMITTED USES	RESIDENTIAL DISTRICTS				COMMERCIAL DISTRICTS					INDUSTRIAL DISTRICTS				SECTION
	RS	R	RMF	RU	OMF	CA	CB	DD	WF	IA	IPA	IPB	IPC	
FINANCIAL, BUSINESS, AND GOVERNMENT SERVICES														
Advertising Services					X	X	X	X	X	X	X	X	X	
Auto, Truck ,and Trailer Rental							X	C		X		A*		7.1-43
Banking and Credit Services					X	X	X	X		X	X	X		
Cleaning and Maintenance Services							X			X	X	X	X	
Collection Services					X	X	X	X	X	X	X	X	X	
Consulting Services					X	X	X	X	X	X	X	X	X	
Detective and Protective Services					X	X	X	X	X	X	X	X	X	
Duplicating and Mailing Services						X	X	X		X	X	X	X	
Employment Services					X	X	X	X	X	X	X	X	X	
General Offices					X	X	X	X		X	X	X	X	
Insurance Services					X	X	X	X		X	X	X	X	
Investment Services					X	X	X	X		X	X	X	X	
Office Equipment Rental and Leasing					X	X	X	X		X	X	X	X	
Offices of Government Agencies					X	X	X	X		X	X	X	X	
Other Town of Groton Services	X	X	X	X	X	X	X	X	X	X	X	X	X	
Real Estate Services					X	X	X	X		X	X	X	X	
Research and Testing Services					X					X	X	X	X	
Secretarial and Stenographic Services					X	X	X	X	X	X	X	X	X	
*Accessory to Warehousing Only														

X - the use is Permitted as a matter of right, subject to applicable district regulations

C - the use is Permitted in the designated district but subject to both applicable district regulations and the special conditions set forth in Section 7.1.

A - the use is Permitted only as an accessory use in the designated district

5.1-3 TABLE OF PERMITTED USES														Sheet 4
PERMITTED USES	RESIDENTIAL DISTRICTS				COMMERCIAL DISTRICTS					INDUSTRIAL DISTRICTS				SECTION
	RS	R	RMF	RU	OMF	CA	CB	DD	WF	IA	IPA	IPB	IPC	
PERSONAL, REPAIR, AND CONSTRUCTION SERVICES														
Beauty and Barber Services						X	X	X	X					
Car Wash						C	C	C		X				7.1-26
Cemetery - New				C						C	C	C	C	7.1-4 A.
Cemetery - Existing	C	C	C	C	C	C	C	C	C	C	C	C	C	7.1-4 B.
Commercial Kennel or Stable				C						C	C	C	C	7.1-14
Contractor's and Construction Equipment and Vehicle Storage				C			X			X				7.1-6
Day Spa					X	X	X	X	X					
Funeral and Crematory Services						X	X							
Home Occupation	AC	AC	AC	AC	AC									7.1-11
Ignition, Brake, Muffler, and Similar Limited Repair						C	X	C		X				7.1-25
Laundering, Dry Cleaning, and Dyeing							X			X				
Laundry and Dry Cleaning (Self-Service or Pick-Up Only)					X	X	X	X						
Motor Vehicle Body and Paint Shop						A	X			X				
Motor Vehicle - General Repairs						A	X			X				
Photographic Services					X	X	X	X	X	X	X	X		
Repair of Machinery							X			X				
Repair of Office Equipment and Personal and Household Items						X	X	X		X		X		
Self-Service Storage Facility						C	C			C	C	C	C	7.1-39
Shoe and Leather Goods Repair					X	X	X	X						
Tailoring, Dressmaking, and Apparel Repair					X	X	X	X						

X - the use is Permitted as a matter of right, subject to applicable district regulations

C - the use is Permitted in the designated district but subject to both applicable district regulations and the special conditions set forth in Section 7.1.

A - the use is Permitted only as an accessory use in the designated district

5-7

C - the use is Permitted in the designated district but subject to both applicable district regulations and the special conditions set fourth in Section 7.1.

A - the use is Permitted only as an accessory use in the designated district

5.1-3 TABLE OF PERMITTED USES														Sheet 6
PERMITTED USES	RESIDENTIAL DISTRICTS				COMMERCIAL DISTRICTS					INDUSTRIAL DISTRICTS				SECTION
	RS	R	RMF	RU	OMF	CA	CB	DD	WF	IA	IPA	IPB	IPC	
RETAIL TRADE - PERSONAL														
Apparel and Accessories						X	X	X						
Art and Hobby Supplies						X	X	X						
Bakery						X	X	X						
Books and Stationery						X	X	X						
Cameras and Photo Supplies						X	X	X						
Confectionery						X	X	X						
Dairy Products						X	X	X						
Drive Through Facilities						AC	AC	AC	AC	AC	AC	AC	AC	7.1-36
Drug Store						X	X	X						
Drug Store Pick-Up Windows/Facilities						AC	AC	AC						7.1-44
Florist					C	X	X	X						7.1-46
Fruit, Vegetables, and Other Farm Products						X	X	X						
Gifts, Novelties, and Souvenirs						X	X	X						
Grocery Store or Delicatessen						X	X	X						
Jewelry						X	X	X						
Large-Scale Destination-Oriented Commercial						X	X				X			
Liquor Store						X	X	X						
Luggage and Leather Goods						X	X	X						
Meat, Fish, and Poultry						X	X	X						
Music and Musical Instruments						X	X	X						
Newspapers and Magazines						X	X	X						
Optical Goods						X	X	X						
Restaurant					A*	X	X	X			C			7.1-40
Tobacconist						X	X	X						
Toys, Sporting Goods, and Bicycles						X	X	X						
*Accessory to Hotel/Motel Only														

X - the use is Permitted as a matter of right, subject to applicable district regulations

C - the use is Permitted in the designated district but subject to both applicable district regulations and the special conditions set forth in Section 7.1.

A - the use is Permitted only as an accessory use in the designated district

5.1-3 TABLE OF PERMITTED USES														Sheet 7
PERMITTED USES	RESIDENTIAL DISTRICTS				COMMERCIAL DISTRICTS					INDUSTRIAL DISTRICTS				SECTION
	RS	R	RMF	RU	OMF	CA	CB	DD	WF	IA	IPA	IPB	IPC	
RETAIL TRADE - HOUSEHOLD, BUILDING, MOTOR VEHICLES														
Antiques						X	X	X						
Auto and Truck Dealers (New)						X	X			X				
Auto and Truck Dealers (Used)						A	X			X				
Auto Parts and Supplies (New)						X	X	X		X				
Dry Goods						X	X	X						
Electrical Supplies							X			X				
Farm and Garden Supplies						X	X	X		X	X	X	X	
Fuel Oil Dealer							X			X				
Furniture Stores						X	X	X						
Gasoline Station						X	X	X		X				
General Merchandise and Department Stores						X	X	X						
Hardware						X	X	X						
Heating and Plumbing Supplies							X			X				
Home Furnishings						X	X	X						
Household Appliances						X	X	X						
Lumber and Building Materials Yard							X			X				
Marine Craft and Equipment Display and Sales						X	X	X	X	X				
Modular/Manufactured Homes Display and Sales						X	X			X				
Notions and Household Supplies						X	X	X						
Office Equipment and Supplies						X	X	X						
Paint, Glass, and Wallpaper						X	X	X						
Radio, Television, and Phonographic Equipment						X	X	X						
Tires, Batteries, and Accessories						X	X	X		X				
Trailer, Farm, and Heavy Equipment Sales							X			X				

X - the use is Permitted as a matter of right, subject to applicable district regulations

C - the use is Permitted in the designated district but subject to both applicable district regulations and the special conditions set forth in Section 7.1.

A - the use is Permitted only as an accessory use in the designated district

5.1-3 TABLE OF PERMITTED USES														Sheet 8
PERMITTED USES	RESIDENTIAL DISTRICTS				COMMERCIAL DISTRICTS					INDUSTRIAL DISTRICTS				SECTION
	RS	R	RMF	RU	OMF	CA	CB	DD	WF	IA	IPA	IPB	IPC	
WHOLESALE TRADE														
Assembly and Packaging of Medical Products							X			X	X	X	X	
Junk, Salvage, or Scrap Yard										C				7.1-13
Screen Printing/Embroidery of Clothing							X			X	X	X	X	
Warehousing							X			X	X	X	X	
Wholesale with Indoor Storage Only							X			X	X	X	X	
Wholesale with Outdoor Storage							X			X				
TRANSPORTATION, COMMUNICATIONS, AND UTILITIES														
Airport										X				
Automobile Parking	A	A	A	A	A	A	A	A	A	A	A	A	A	
Bus Garage and Maintenance							X			X				
Bus Passenger Station						X	X	X						
Commercial Broadcasting Antennae				X						X	X	X	X	
Electric Transformer Substation	C	C	C	C	X	X	X	X	X	X	X	X	X	7.1-22
Motor Freight Terminal							X			X				
Moving and Storage Uses							X				X	X	X	
Radio and Television Broadcasting Studios				X	X	X	X	X	X	X	X	X	X	
Railroad Freight Station										X	X	X	X	
Railroad Passenger Station	X	X	X	X	X	X	X	X	X	X	X	X	X	
Solid Waste Disposal Facility - Town				X								X		
Telecommunication Towers			C	C	C	C	C	C	C	C	C	C	C	7.1-41
Telecommunication Antennae and Facilities	C	C	C	C	C	C	C	C	C	C	C	C	C	7.1-41
Telephone Exchange Station	C	C	C	C	X	X	X	X	X	X	X	X	X	7.1-22
Waste Handling/Reduction Facilities										C		C		7.1-33
Water Storage Tanks	X	X	X	X	X	X	X	X	X	X	X	X	X	
Water and Sewer Pumping Stations	X	X	X	X	X	X	X	X	X	X	X	X	X	
Water and Sewer Treatment Plants	X	X	X	X	X	X	X	X	X	X	X	X	X	

X - the use is Permitted as a matter of right, subject to applicable district regulations

C - the use is Permitted in the designated district but subject to both applicable district regulations and the special conditions set forth in Section 7.1.

A - the use is Permitted only as an accessory use in the designated district