

**FOR SALE**

# Kearny Mesa Industrial Building

4653 Mercury Street. San Diego, California 92111

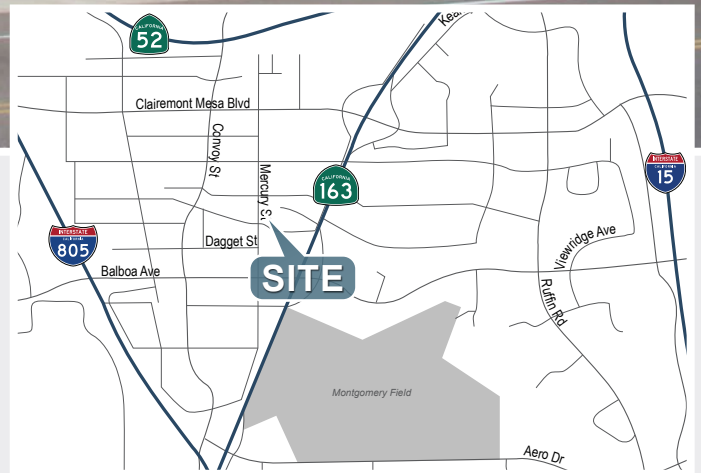

## Property Details

<b>Building Size:</b>	±14,045 SF (Divisible)
<b>Parcel Size:</b>	±31,668 SF
<b>Office Size:</b>	25% (includes 2,400 SF of showroom)
<b>Clear Height:</b>	±18'
<b>Truck Doors:</b>	7 grade level doors

## Property Highlights

- Exceptional corner location with easy freeway access
- Three phase power
- ±1,300 SF of covered area on back of building (bonus SF)
- Seller will consider leasing back 3,500 to 7,000 SF
- Skylights
- Sprinklers
- Signalized intersection
- Drive-around truck access
- Gas service
- Two electrical meters

**Sale Price** ..... **\$2,300,000**

**Randy LaChance, SIOR**  
Senior Vice President  
858.458.3374 [Direct]  
rlchance@voitco.com  
Lic. #00969674

**Glen Volk, SIOR**  
Senior Vice President  
858.458.3370 [Direct]  
gvolk@voitco.com  
Lic. #00859621

4747 Executive Dr., Suite 800, San Diego, CA 92121  
858.453.0505 | 858.408.3976 Fax | Lic #01333376 | www.voitco.com

**Voit**  
REAL ESTATE SERVICES

**FOR SALE**

# Kearny Mesa Industrial Building

4653 Mercury Street. San Diego, California 92111

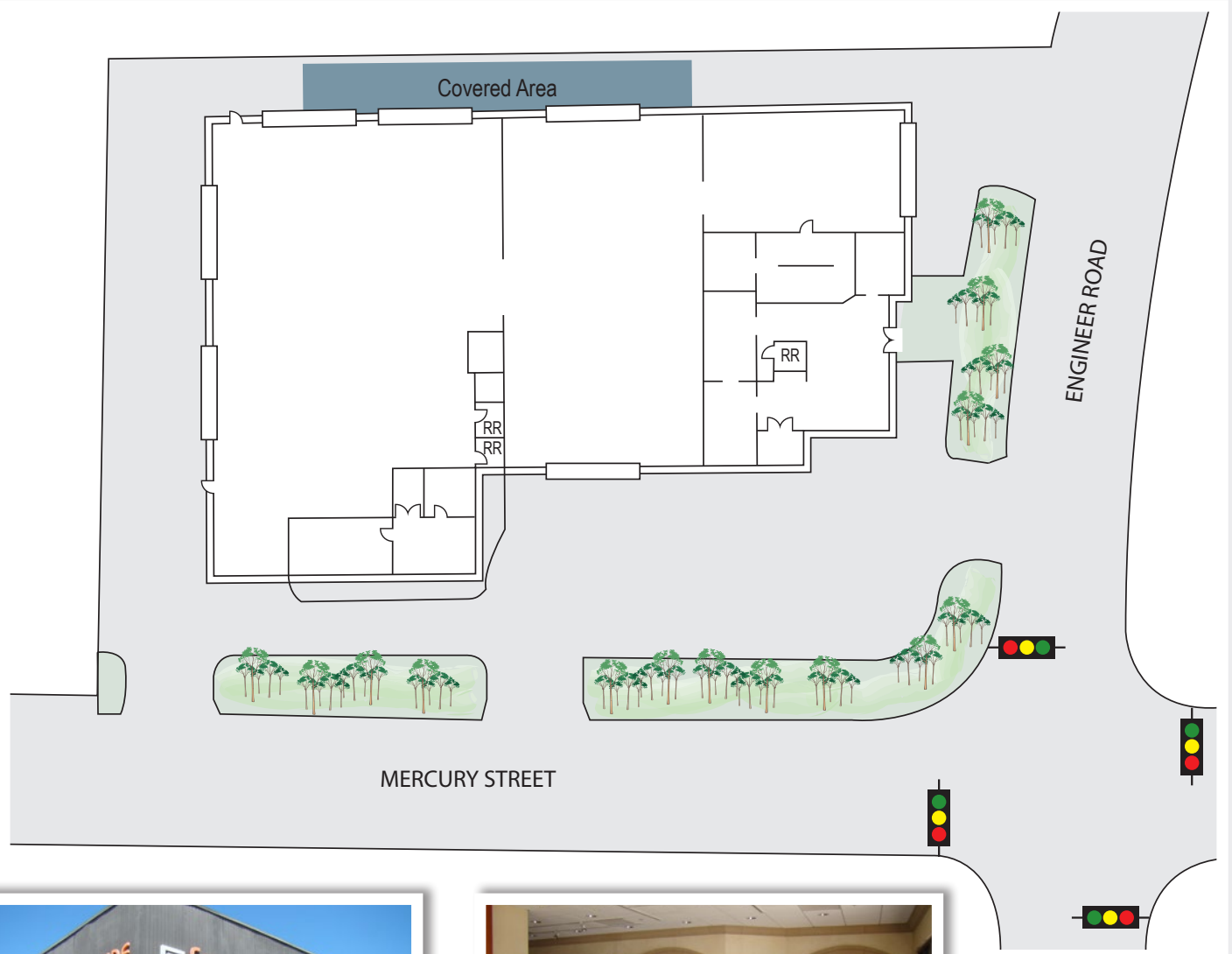

**Randy LaChance, SIOR**  
Senior Vice President  
858.458.3374 [Direct]  
rlachance@voitco.com  
Lic. #00969674

**Glen Volk, SIOR**  
Senior Vice President  
858.458.3370 [Direct]  
gvolk@voitco.com  
Lic. #00859621

4747 Executive Dr., Suite 800, San Diego, CA 92121  
858.453.0505 | 858.408.3976 Fax | Lic #01333376 | [www.voitco.com](http://www.voitco.com)

The information contained herein has been obtained from sources we deem reliable. While we have no reason to doubt its accuracy, we do not guarantee it.  
©2013 Voit Real Estate Services, Inc. All Rights Reserved. Real People. Real Solutions.® is a registered trademark of Voit Real Estate Services.

**CORFAC**  
International

**Voit**  
REAL ESTATE SERVICES