

27681 JOHN R ROAD
MADISON HEIGHTS, MICHIGAN



**SIGNATURE
ASSOCIATES**
KNOW SIGNATURE | KNOW RESULTS

OFFICE FOR SALE
1,100 Square Feet Available

REDEVELOPMENT POSSIBILITY



PROPERTY FEATURES

- 1,100 square feet available
- Zoned B-2
- Possible redevelopment with drive-thru
- Opportunity to own prime real estate with ample parking
- Retrofit in 2001
- 16 parking spaces
- Sale Price: \$140,000 (\$127.27/sf)

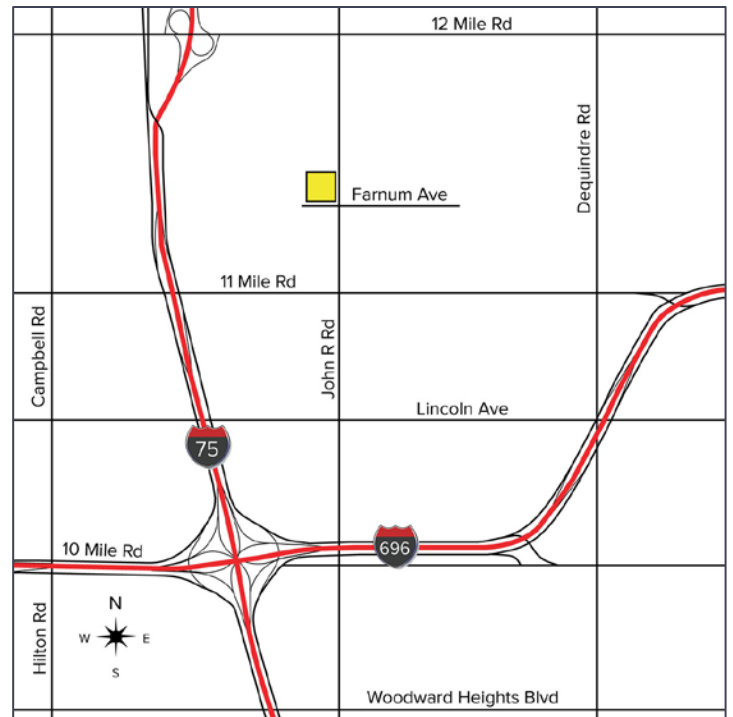

For more information, please contact:

PETER VANDERKAAY
(248) 359 3837
pvanderkaay@signatureassociates.com

SIGNATURE ASSOCIATES
One Towne Square, Suite 1200
Southfield, MI 48076
www.signatureassociates.com

27681 John R Road – Madison Heights, MI
Office For Sale

1,100
Square Feet
AVAILABLE

Aerial



For more information, please contact:
PETER VANDERKAAY
(248) 359 3837
pvanderkaay@signatureassociates.com

SIGNATURE ASSOCIATES
One Towne Square, Suite 1200
Southfield, MI 48076
www.signatureassociates.com

Information is subject to verification and no liability for errors or omissions is assumed. Price is subject to change and listing withdrawal.