

1509 NORTH MILWAUKEE

(773)486-1779 **GOLDBLATT** (773)486-1779
SEWING MACHINES, INC.
Brother SINGER 1511

BUCKTOWN / WICKER PARK,
CHICAGO

RETAIL / RESTAURANT
OPPORTUNITY



AVAILABLE



RETAIL OPPORTUNITY
1509 N. MILWAUKEE
 Wicker Park, Chicago



SPACE AVAILABLE

1,650 SF
 (Lower Level storage space included)

SITE SUMMARY

- Rare small shop retail space at the ground floor of a four-story building located in Wicker Park's popular Milwaukee Avenue retail and restaurant corridor.
- The free-standing nature of the building will allow for any retailer/restaurant to brand the entire four-story building.
- Nationally renowned 'Sweetgreen' opening soon just one-half block south!

NEIGHBORHOOD TENANTS



POPULATION DENSITY	18,931	½ Mile
	62,906	1 Mile
	128,055	1 ½ Mile
DAYTIME EMPLOYMENT	6,745	½ Mile
	23,290	1 Mile
	55,308	1 ½ Mile
AVERAGE HH INCOME	\$119,774	½ Mile
	\$104,800	1 Mile
	\$103,983	1 ½ Mile

SITE PLAN

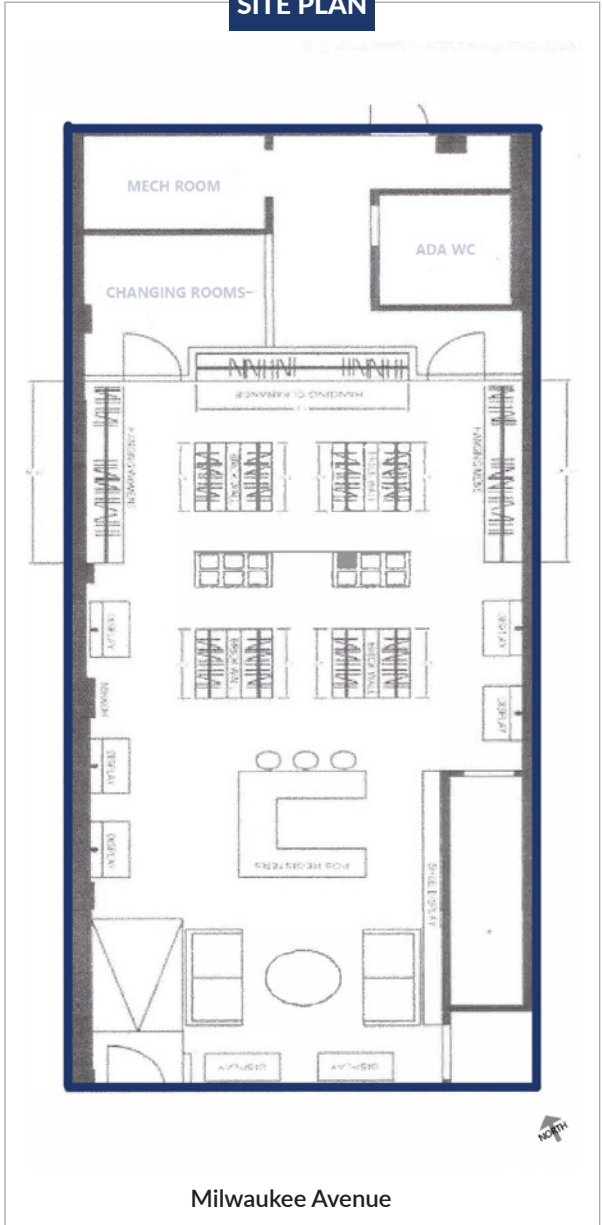

SURVEY



RETAIL OPPORTUNITY
1509 N. MILWAUKEE
 Wicker Park, Chicago



CONTACT
 Anthony Campagni
 ac@arcgrp.com
 (630) 908-5695

Elan Rasansky
 elan@arcgrp.com
 (630) 908-5696

© 2019 A•R•C Real Estate. All information is from sources believed reliable, not independently verified, and thus subject to errors, omissions, and modifications such as price listing, square footage, rates and commissions. All information, estimates and projections subject to change, market assumptions, unknown facts and conditions, and future potentialities. A•R•C Real Estate makes no express or implied representations or warranties, as facts and results may vary materially from all information, estimates and projections. All renderings presented are conceptual.

