

# VILLAGE SHOPPES OF SUGARLOAF LAWRENCEVILLE, GEORGIA



## LOCATION

3370 Sugarloaf Parkway  
Lawrenceville, GA 30044

## MAJOR STORES

Publix Super Market, Sally Beauty and Chase Bank

## NUMBER OF STORES

47

## TOTAL RETAIL SQ. FT.

147,817

## COMMENTS

Village Shoppes, anchored by Publix Super Market and five outparcels, offers a coveted position on Sugarloaf Parkway, linking Southern Lawrenceville at Grayson Highway with Highway 316.

The center is accessible via two curb cuts on Sugarloaf Parkway with a traffic light at the intersection.

Within 5 miles, the population surpasses 215,000 with an average household income of \$71,212. In 5 years, the population is expected to increase by nearly 10%.

## TRADE AREA PROFILE

### POPULATION

2015 ESTIMATE      2020 PROJECTION

1 mi - 11,199      1 mi - 12,255

3 mi - 76,887      3 mi - 83,134

5 mi - 215,225      5 mi - 232,551

### 2015 MEDIAN AGE

1 mi - 36

3 mi - 36

5 mi - 35

### 2015 AVERAGE HH INCOME

1 mi - \$77,762

3 mi - \$74,454

5 mi - \$71,212

Source: Urban Retail Properties, LLC Market Research  
© 2016 The Nielsen Company. All rights reserved.

## FOR MORE INFORMATION CONTACT

URBAN RETAIL PROPERTIES, LLC • 561-394-6433 • [www.urbanretail.com](http://www.urbanretail.com)  
925 S. FEDERAL HIGHWAY, SUITE 700 • BOCA RATON, FL 33432

Austin Merola

(561) 394-6837

[amerola@urbanretail.com](mailto:amerola@urbanretail.com)

URBAN



RETAIL PROPERTIES, LLC

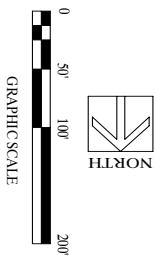
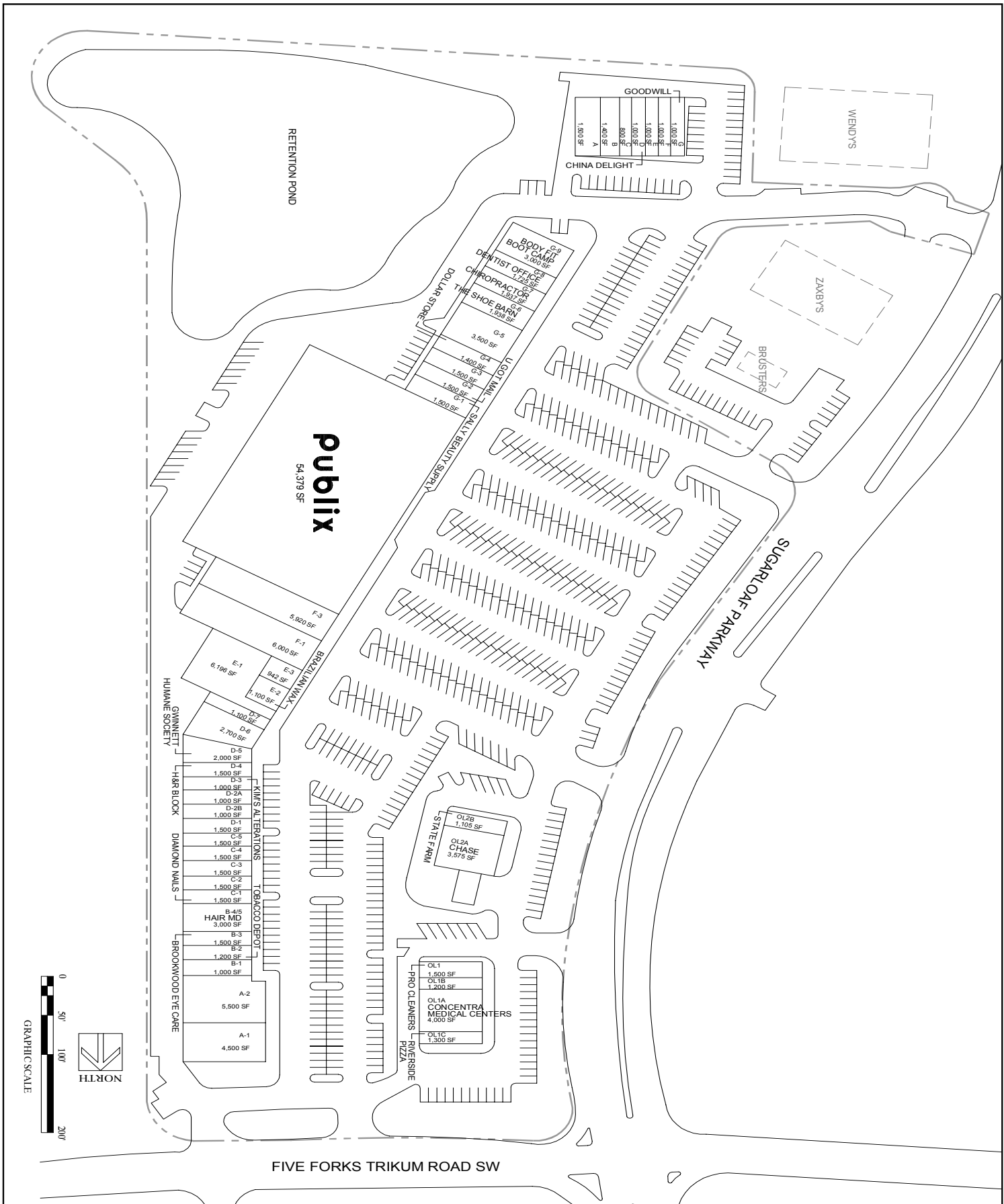

# VILLAGE SHOPPES OF SUGARLOAF LAWRENCEVILLE, GA 30044

**LEASE  
PLAN**

LEASING &  
MANAGEMENT  
AGENTS:

**URBAN**



111 East Wacker Drive  
Suite 2000  
Lawrenceville, GA 30044  
770.962.5200

MAY 2016