

KENT MANUFACTURING CAMPUS

22610 88TH AVE S | KENT, WASHINGTON

LAST SPACE AVAILABLE!

BUILDING 22610

Suite 103: 13,951 SF (2,917 SF office)

- Ample 3-phase power
- Fully fenced and secured site
- Grade level loading
- Great access to SR-167
- Ideal for manufacturing tenants of all sizes

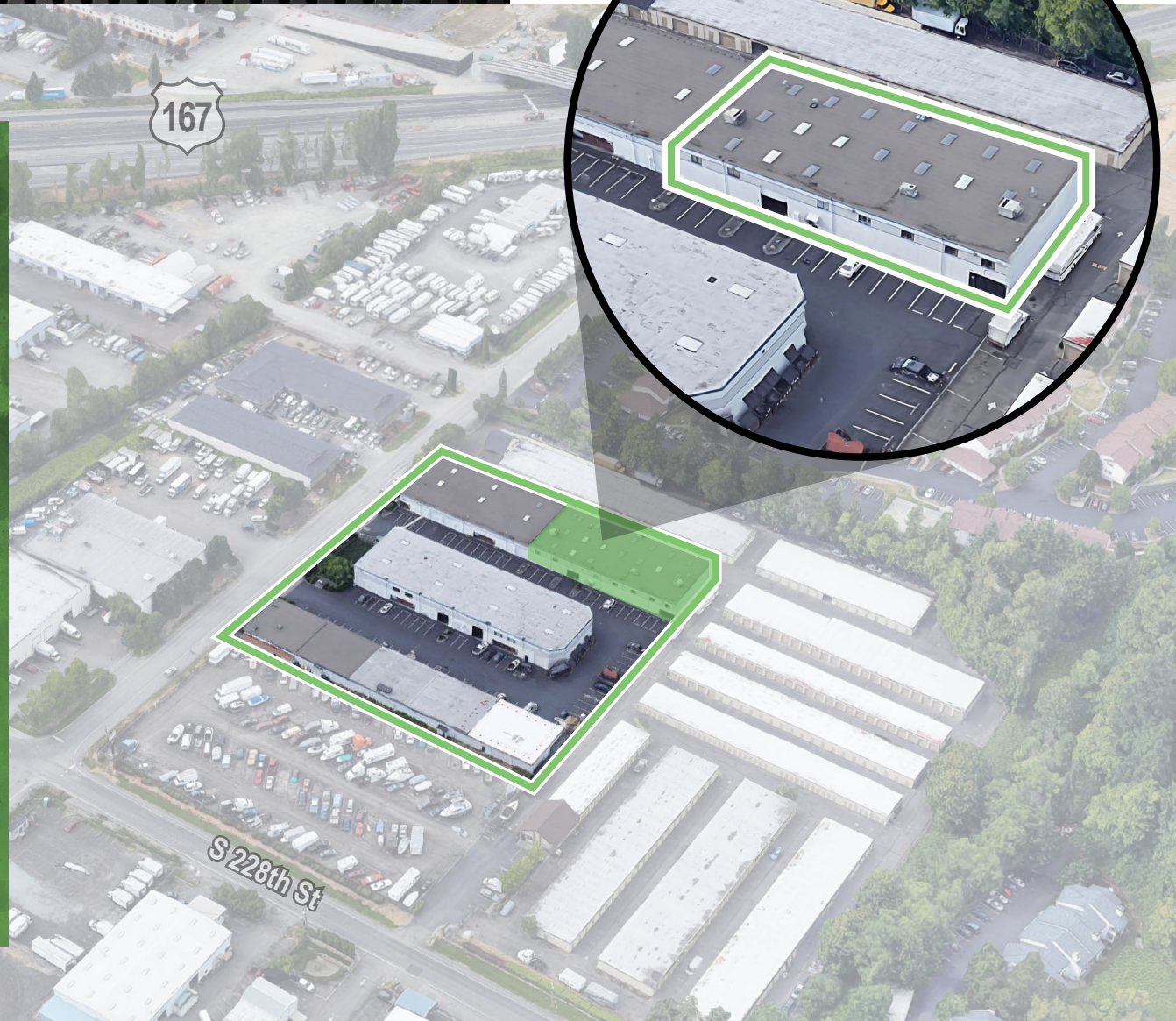

NEWMARK

THAD MALLORY, SIOR
425.362.1410
thad.mallory@ngkf.com

CAM WARREN
425.362.1395
cam.warren@ngkf.com

The information contained herein has been obtained from sources deemed reliable but has not been verified and no guarantee, warranty or representation, either express or implied, is made with respect to such information. Terms of sale or lease and availability are subject to change or withdrawal without notice.

KENT MANUFACTURING CAMPUS

22610 88TH AVE S | KENT, WASHINGTON

BUILDING 22610

Suite 103: 13,951 SF (2,917 SF office)

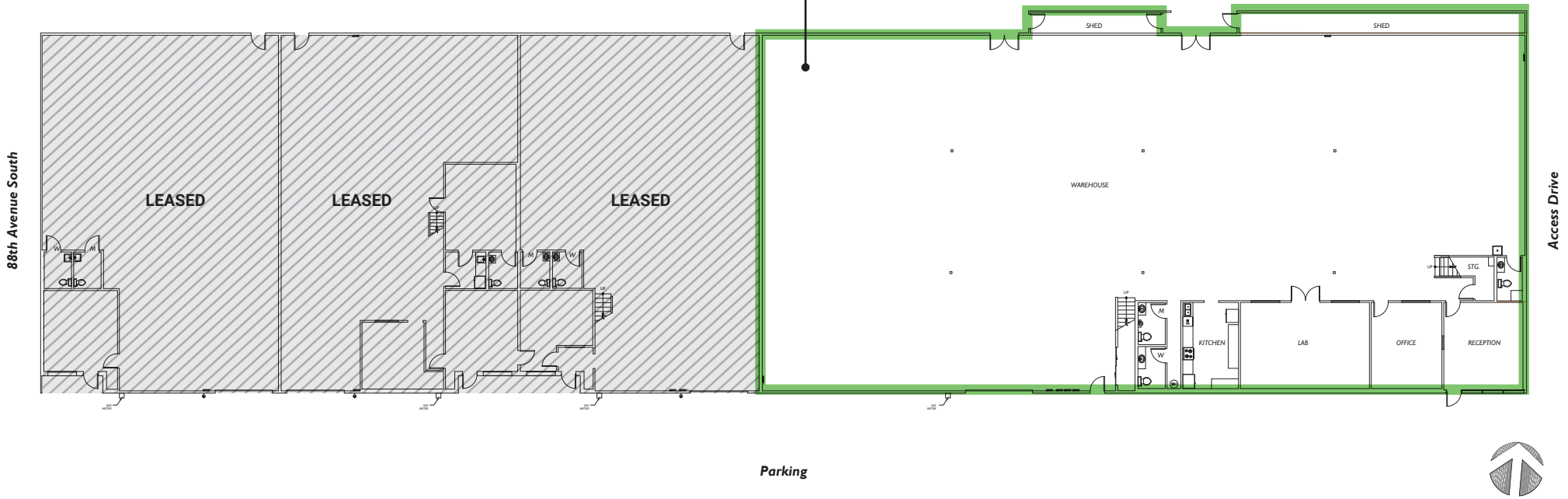

Contact broker for rates

NEWMARK

THAD MALLORY, SIOR
425.362.1410
thad.mallory@ngkf.com

CAM WARREN
425.362.1395
cam.warren@ngkf.com

The information contained herein has been obtained from sources deemed reliable but has not been verified and no guarantee, warranty or representation, either express or implied, is made with respect to such information. Terms of sale or lease and availability are subject to change or withdrawal without notice.