

# PLAT OF SURVEY

**CHICAGOLAND SURVEY CO.**

6501 W. 65TH STREET CHICAGO, ILLINOIS 60638 (312) 271-9447

## PLAT OF SURVEY

OF

Lots 9, 10, 11 and 12 in Block 110 in Cornell, a Subdivision in Sections 26 and 35, Township 38 North, Range 14, East of the Third Principal Meridian, in Cook County, Illinois.

South line of E. 79<sup>TH</sup> STREET

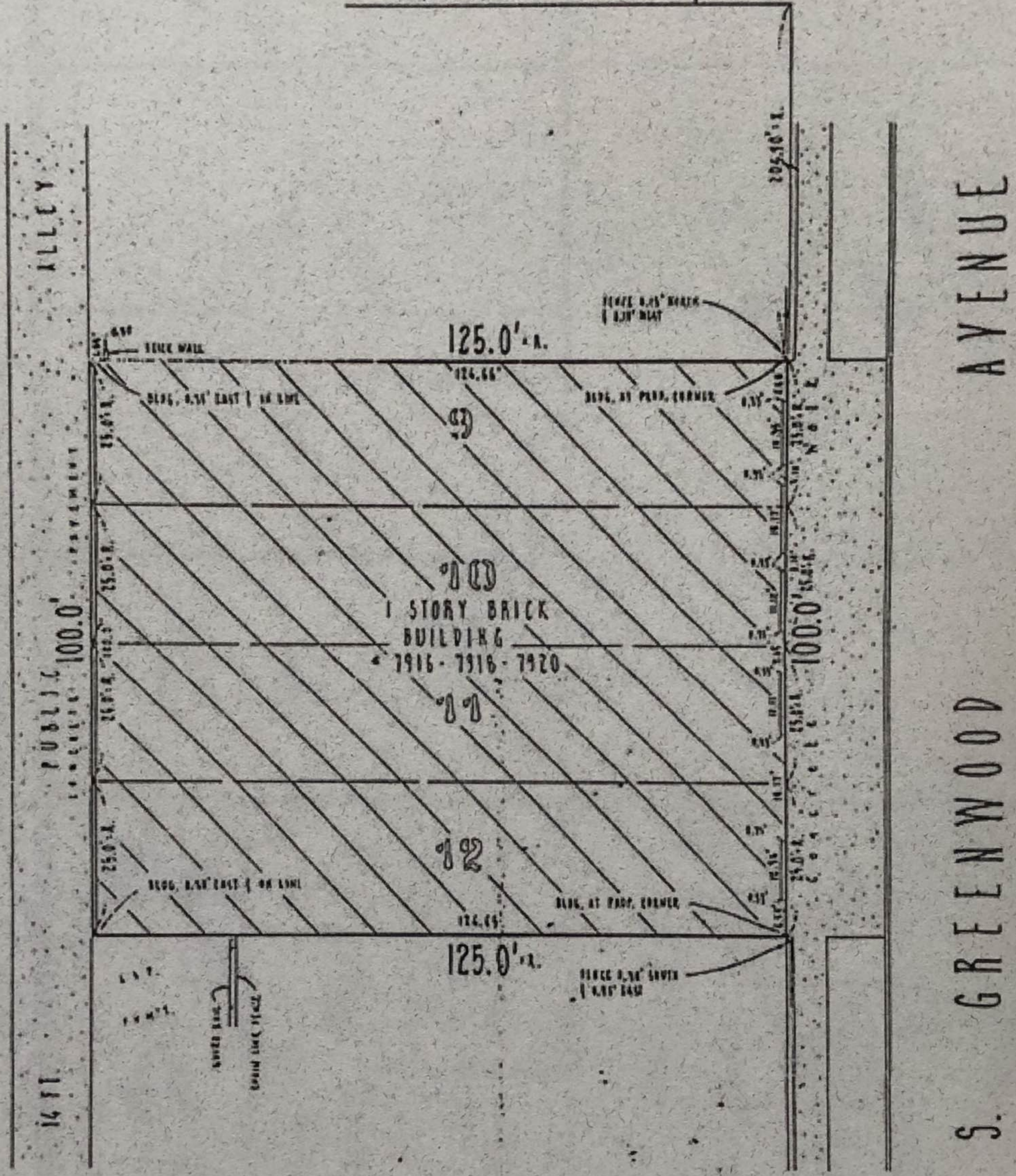

NOTE: MEASUREMENTS AS SHOWN ON THIS PLAT ARE NOT TO BE USED FOR ANY CONSTRUCTION PURPOSE.



DISTANCES ARE SHOWN IN FEET AND DECIMAL PART THEREOF AND CORRECTED TO 62° F.

FOR BUILDING LINE AND OTHER RESTRICTIONS NOT SHOWN ON THE SURVEY PLAT, REFER TO YOUR ABSTRACT, DEED, AND LOCAL BUILDING REGULATIONS.

UTILITY DATA, OTHER THAN PHYSICAL EVIDENCE VISIBLE ON THE GROUND, IS SHOWN AS PROVIDED BY THE PRIVATE AND PUBLIC AGENCIES AND SHOULD BE ASSUMED AS APPROXIMATE.

STATE OF ILLINOIS  
COUNTY OF COOK

WE, CHICAGOLAND SURVEY COMPANY, DO HEREBY CERTIFY THAT WE HAVE SURVEYED THE ABOVE DESCRIBED PROPERTY AND HEREON DRAWN IS A CORRECT REPRESENTATION OF SAID SURVEY.  
DATED IN CHICAGO JUL 12, 1992