

1433 EAST THOMAS ROAD

1433 EAST THOMAS ROAD, PHOENIX, ARIZONA

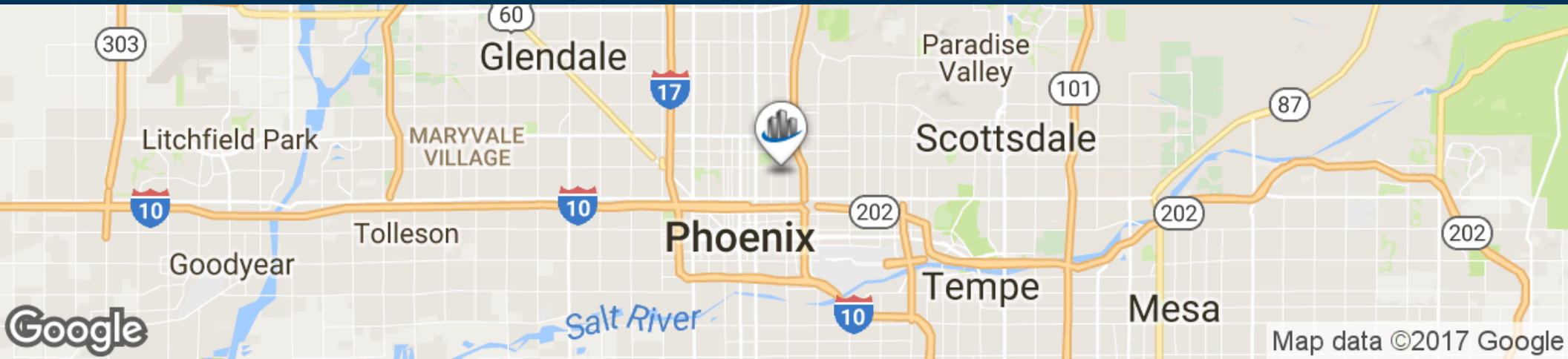

PROPERTY SUMMARY

Available SF:	867 SF
Lease Rate:	Negotiable (MG)
Building Size:	3,900 SF
Building Class:	C
Year Built:	1980
Cross Streets:	16th Street & East Thomas Road

AVAILABLE SPACES

Suite	SF Available	Lease Rate
Suite 2	867	Negotiable

PROPERTY HIGHLIGHTS

- Excellent Frontage on Thomas Road
- High Traffic Area (32,797 VPD on Thomas Road)
- Monument Signage Available
- Covered Parking Spaces Available
- Close to the SR-51 and I-10 Freeways

Total Households:

Total Population:

Average HH Income:

	1 Mile	3 Miles	5 Miles
Total Households:	7,501	60,122	129,889
Total Population:	20,416	146,649	327,843
Average HH Income:	\$49,145	\$51,459	\$56,929

1433 EAST THOMAS ROAD

1433 EAST THOMAS ROAD, PHOENIX, ARIZONA

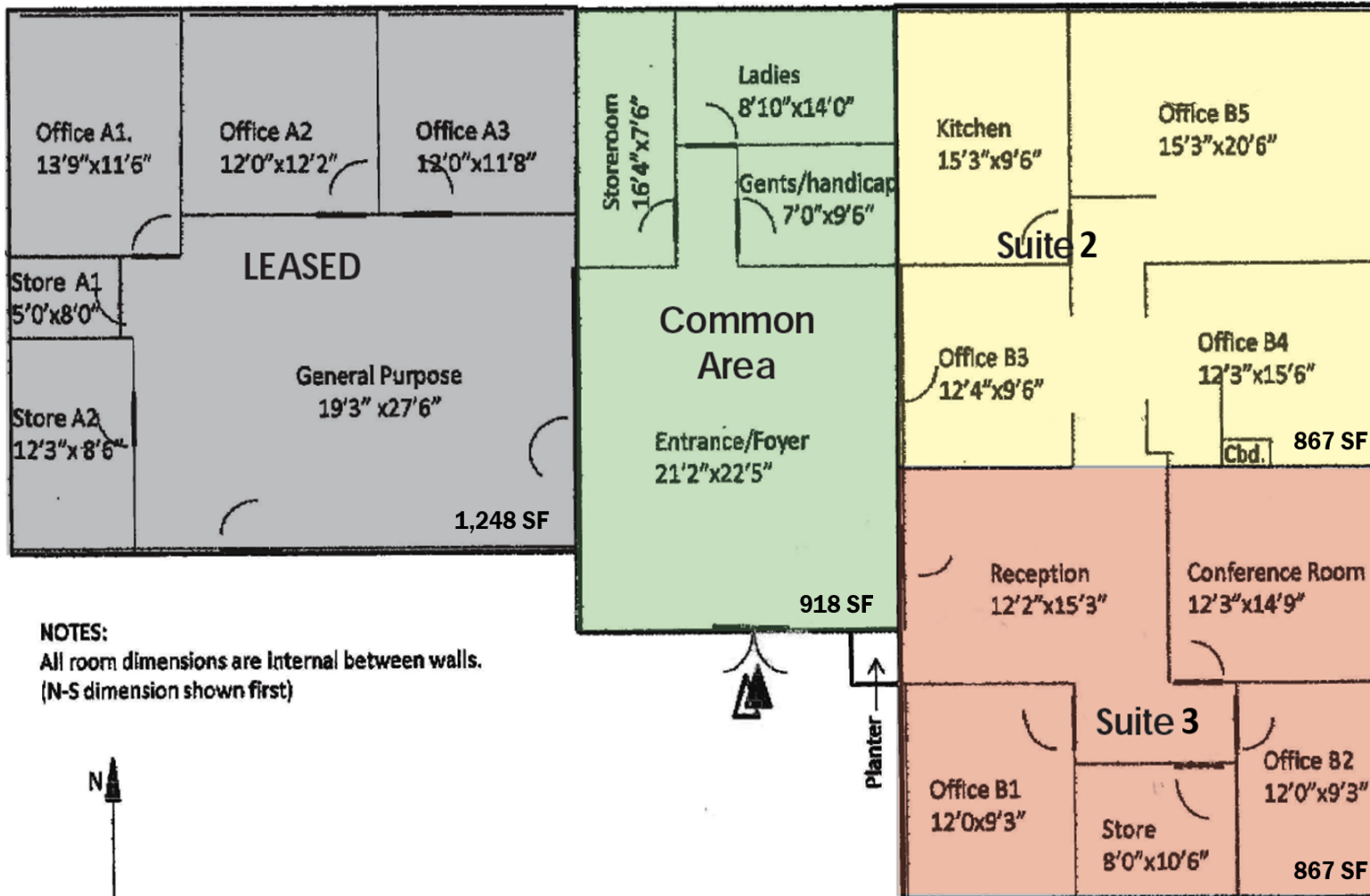

NOTES:
All room dimensions are internal between walls.
(N-S dimension shown first)



1433 EAST THOMAS ROAD

1433 EAST THOMAS ROAD, PHOENIX, ARIZONA



1433 EAST THOMAS ROAD

1433 EAST THOMAS ROAD, PHOENIX, ARIZONA



1433 EAST THOMAS ROAD

1433 EAST THOMAS ROAD, PHOENIX, ARIZONA



SUBJECT