

# AMBROSE CROSSING

## 976 PEARL ROAD

BRUNSWICK, OHIO 44212

COMING FALL 2019 - For Lease



**ERIC M. SCHREIBMAN, J.D.** / Vice President / [eschreibman@crescorealestate.com](mailto:eschreibman@crescorealestate.com) / 216 525 1471  
**GEORGE J. POFOK, CCIM, SIOR** / Sr. Vice President / [gpofok@crescorealestate.com](mailto:gpofok@crescorealestate.com) / 216 525 1469

*Independently Owned and Operated / A Member of the Cushman & Wakefield Alliance*

Cushman & Wakefield Copyright 2018. No warranty or representation, express or implied, is made to the accuracy or completeness of the information contained herein, and same is submitted subject to errors, omissions, change of price, rental or other conditions, withdrawal without notice, and to any special listing conditions imposed by the property owner(s). As applicable, we make no representation as to the condition of the property (or properties) in question. "One of the licensees of CRESCO has an interest in the entity that owns the property." For the marketing materials, "A CRESCO licensee has an interest in the ownership entity."



3 Summit Park Drive, Suite 200  
Cleveland, Ohio 44131  
Main 216.520.1200  
Fax 216.520.1828  
[crescorealestate.com](http://crescorealestate.com)



# AMBROSE CROSSING

## 976 PEARL ROAD

BRUNSWICK, OHIO 44212

COMING FALL 2019 - For Lease

## PROPERTY HIGHLIGHTS

- Brand new development, moments from the well-traveled Route 303 commercial district
- Traffic count at Pearl Road and Route 303 is 25,476 VPD
- Generous tenant improvement allowance packages
- High image branding opportunity - potential for signage along Pearl Road
- Design your own suite
- Ideal for healthcare users - co-locate with the St. Ambrose multi-purpose sports facility and Littlest Angels Preschool

## PROPERTY SPECIFICATIONS

|              |                       |            |             |
|--------------|-----------------------|------------|-------------|
| TOTAL SF     | Up to 8,500 SF        | ROOF       | Rubber      |
| LAND         | 2.3 acres             | PARKING    | 90 (shared) |
| CONSTRUCTED  | 2019                  | LEASE RATE | \$19.50 NET |
| CONSTRUCTION | Brick / Block / Metal |            |             |



**ERIC M. SCHREIBMAN, J.D.** / Vice President / [eschreibman@crescorealestate.com](mailto:eschreibman@crescorealestate.com) / 216 525 1471  
**GEORGE J. POFOK, CCIM, SIOR** / Sr. Vice President / [gpfok@crescorealestate.com](mailto:gpfok@crescorealestate.com) / 216 525 1469

*Independently Owned and Operated / A Member of the Cushman & Wakefield Alliance*

Cushman & Wakefield Copyright 2018. No warranty or representation, express or implied, is made to the accuracy or completeness of the information contained herein, and same is submitted subject to errors, omissions, change of price, rental or other conditions, withdrawal without notice, and to any special listing conditions imposed by the property owner(s). As applicable, we make no representation as to the condition of the property (or properties) in question. "One of the licensees of CRESCO has an interest in the entity that owns the property." For the marketing materials, "A CRESCO licensee has an interest in the ownership entity."



3 Summit Park Drive, Suite 200  
Cleveland, Ohio 44131  
Main 216.520.1200  
Fax 216.520.1828  
[crescorealestate.com](http://crescorealestate.com)

# AMBROSE CROSSING

## 976 PEARL ROAD

BRUNSWICK, OHIO 44212

COMING FALL 2019 - For Lease

FLOORPLAN

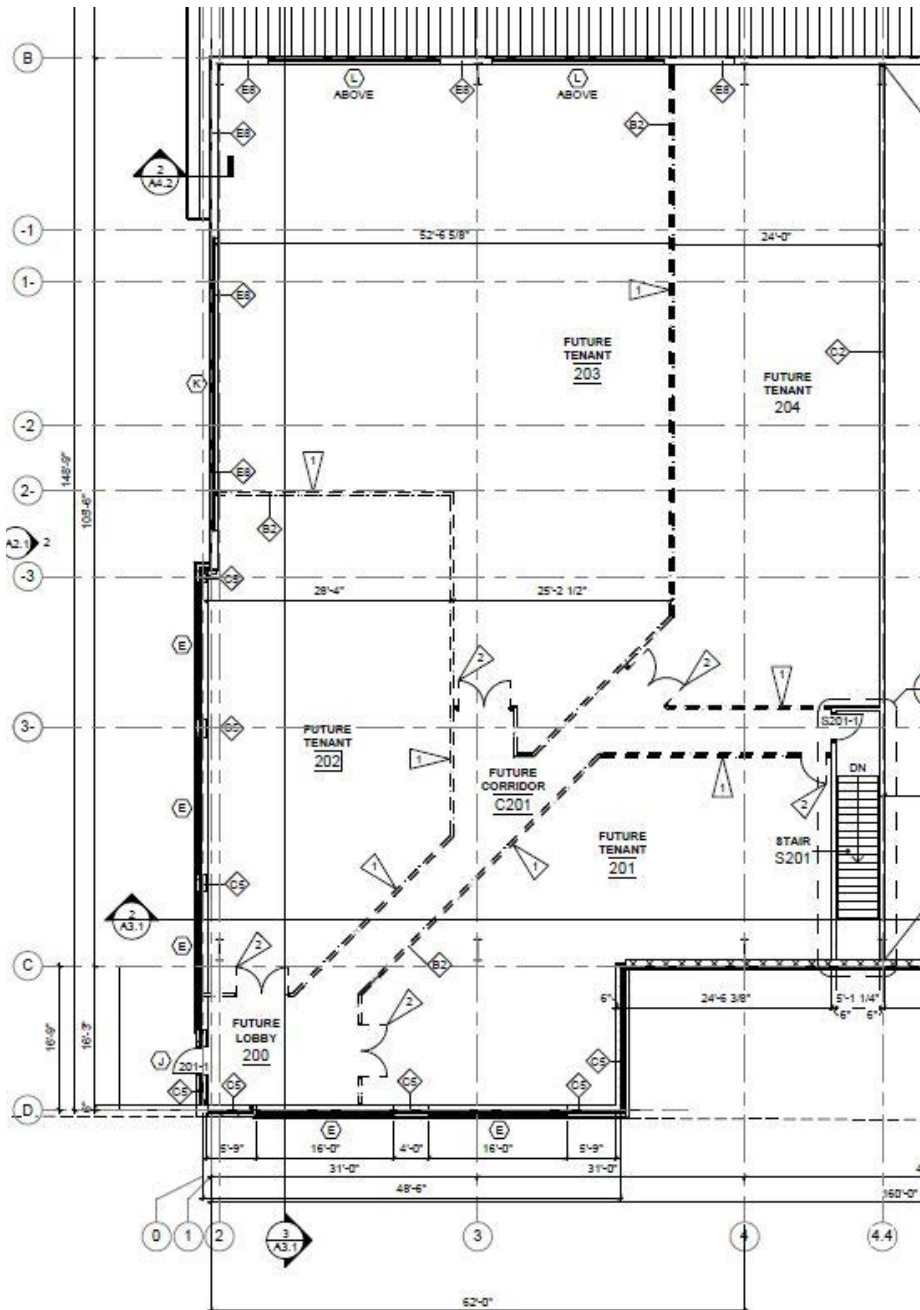

**ERIC M. SCHREIBMAN, J.D.** / Vice President / [eschreibman@crescorealestate.com](mailto:eschreibman@crescorealestate.com) / 216 525 1471  
**GEORGE J. POFOK, CCIM, SIOR** / Sr. Vice President / [gpfok@crescorealestate.com](mailto:gpfok@crescorealestate.com) / 216 525 1469

Independently Owned and Operated / A Member of the Cushman & Wakefield Alliance

Cushman & Wakefield Copyright 2018. No warranty or representation, express or implied, is made to the accuracy or completeness of the information contained herein, and same is submitted subject to errors, omissions, change of price, rental or other conditions, withdrawal without notice, and to any special listing conditions imposed by the property owner(s). As applicable, we make no representation as to the condition of the property (or properties) in question. "One of the licensees of CRESCO has an interest in the entity that owns the property." For the marketing materials, "A CRESCO licensee has an interest in the ownership entity."



3 Summit Park Drive, Suite 200  
 Cleveland, Ohio 44131  
 Main 216.520.1200  
 Fax 216.520.1828  
[crescorealestate.com](http://crescorealestate.com)

# AMBROSE CROSSING 976 PEARL ROAD BRUNSWICK, OHIO 44212

COMING FALL 2019 - For Lease

MAP



**ERIC M. SCHREIBMAN, J.D.** / Vice President / [eschreibman@crescorealestate.com](mailto:eschreibman@crescorealestate.com) / 216 525 1471  
**GEORGE J. POFOK, CCIM, SIOR** / Sr. Vice President / [gpfok@crescorealestate.com](mailto:gpfok@crescorealestate.com) / 216 525 1469

Independently Owned and Operated / A Member of the Cushman & Wakefield Alliance

Cushman & Wakefield Copyright 2018. No warranty or representation, express or implied, is made to the accuracy or completeness of the information contained herein, and same is submitted subject to errors, omissions, change of price, rental or other conditions, withdrawal without notice, and to any special listing conditions imposed by the property owner(s). As applicable, we make no representation as to the condition of the property (or properties) in question. "One of the licensees of CRESCO has an interest in the entity that owns the property." For the marketing materials, "A CRESCO licensee has an interest in the ownership entity."



3 Summit Park Drive, Suite 200  
 Cleveland, Ohio 44131  
 Main 216.520.1200  
 Fax 216.520.1828  
[crescorealestate.com](http://crescorealestate.com)