

# 127

INDEPENDENCE DRIVE  
MENLO PARK

## FOR LEASE

±14,500 SF Available

# SIGNAGE

 ARRINEX

127

# SIGNAGE



**JACK TROEDSON**

650.688.8520

jtroedson@ngkf.com

CA RE License #00833129

**MIKE COURSON**

650.688.8527

mcourson@ngkf.com

CA RE License #01358961

**CARTER LYMAN**

650.688.8559

carter.lyman@ngkf.com

CA RE License #02067725

The distributor of this communication is performing acts for which a real estate license is required. The information contained herein has been obtained from sources deemed reliable but has not been verified and no guarantee, warranty or representation, either express or implied, is made with respect to such information. Terms of sale or lease and availability are subject to change or withdrawal without notice.

245 Lytton Avenue, Suite 150, Palo Alto, CA 94301 // 20-0341.01/20

127

INDEPENDENCE DRIVE  
MENLO PARK

- ◆ ±14,500 SF
- ◆ Available October 1, 2020
- ◆ Perfect for Medical Device Companies
- ◆ 2 Class 100k Labs/Clean Rooms
- ◆ 2 Roll Up Doors for Shipping/Receiving
- ◆ Expansive 2nd Floor Mezzanine/Storage Area
- ◆ Flexible Lease Term
- ◆ Close to Hwy 101 and Dumbarton Bridge
- ◆ Steps from Hotel Nia & Facebook's New Menlo Park HQ Campus
- ◆ ±3.3/1000 Parking

## FIRST FLOOR

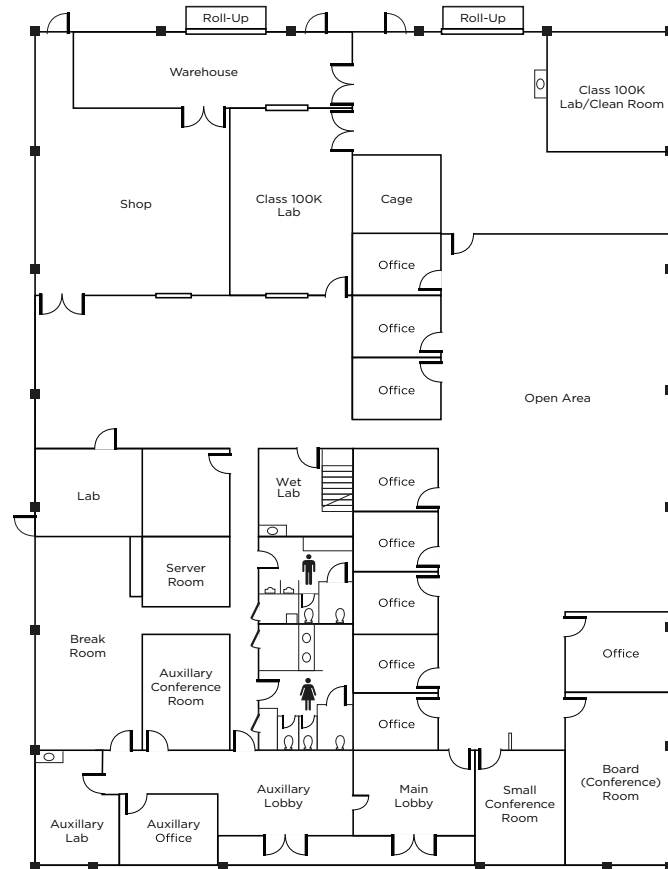

## SECOND FLOOR

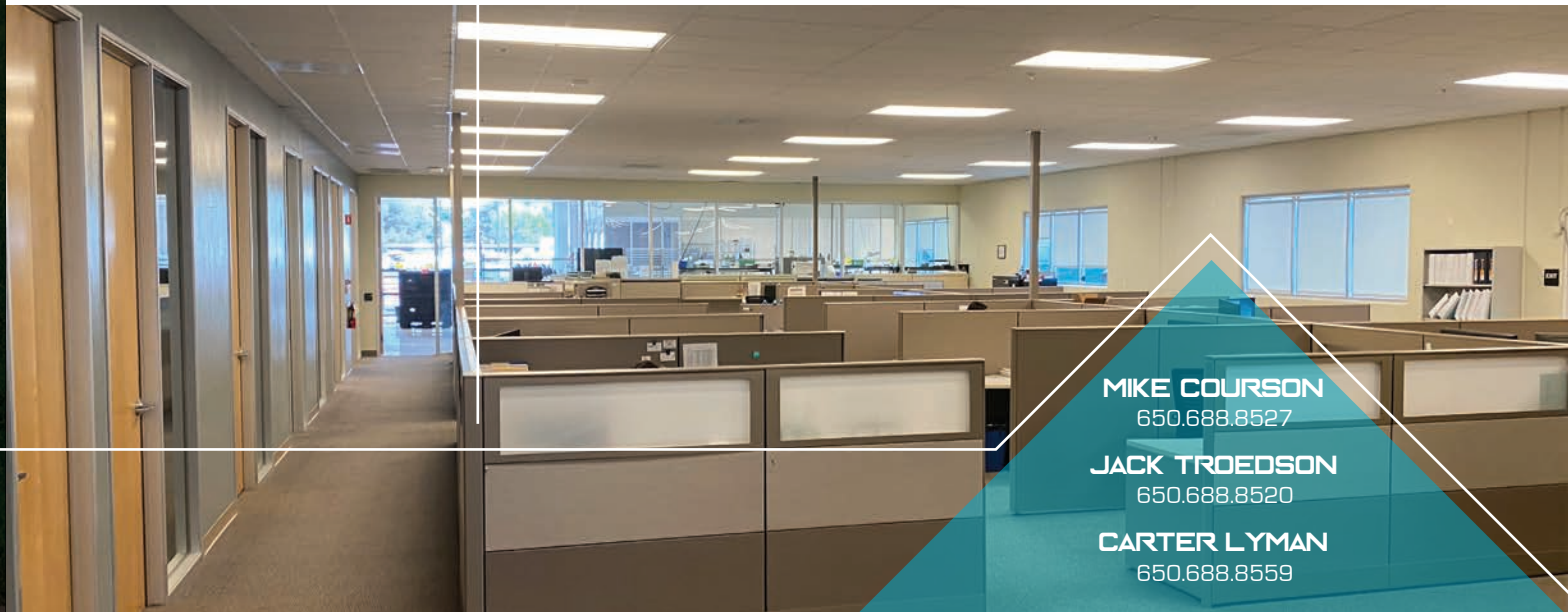
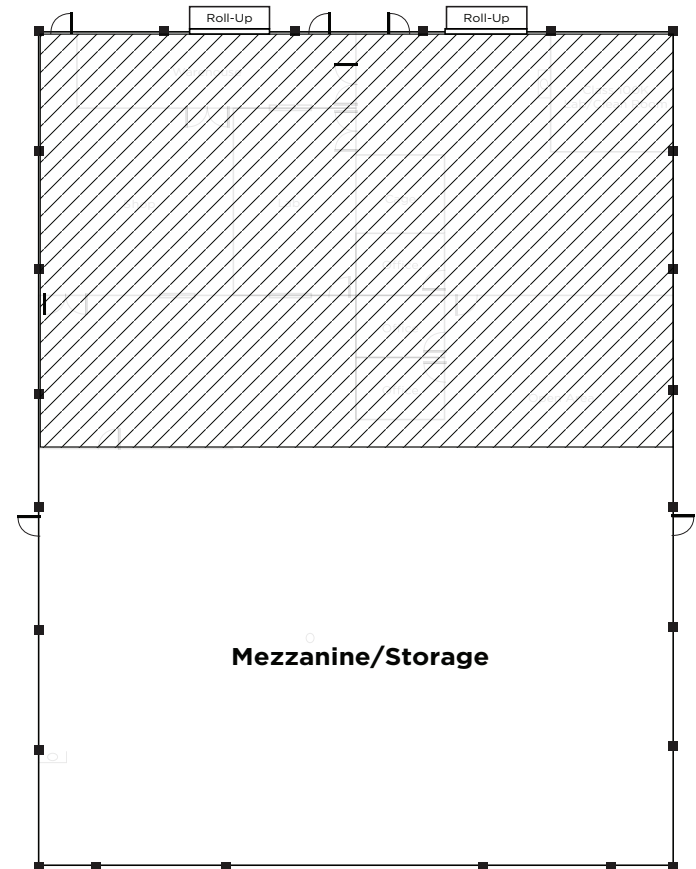

MIKE COURSON  
650.688.8527

JACK TROEDSON  
650.688.8520

CARTER LYMAN  
650.688.8559

## NEIGHBORING TENANTS

- |                         |                            |  |
|-------------------------|----------------------------|--|
| 1. Orrick               | 10. Apria Healthcare       | 19. Carr & Ferrell LLP                   |
| 2. Bowers & Wilkins     | 11. Boardvantage           | 20. L3Harris Randtron<br>Antenna Systems |
| 3. Abbott Vascular      | 12. Ayasdi                 | 21. Whisbi Technologies                  |
| 4. EarLens Corporation  | 13. E Trade Financial      | 22. Spaces                               |
| 5. Memry Corporation    | 14. Galileo Planning Group | 23. Boston Scientific                    |
| 6. Hogan Lovells US LLP | 15. Facebook               | 24. Earp David                           |
| 7. Latham & Watkins LLP | 16. Corcept Therapeutics   | 25. Foundry                              |
| 8. Horizon Distributors | 17. Randtron               | 26. Corium International Inc             |
| 9. Kespry               | 18. Studio Red             |  |

## NEARBY SERVICES

- |                          |                       |
|--------------------------|-----------------------|
| 1. Delucchi's Market     | 9. Hotel Nia          |
| 2. Squeeze Inn           | 10. Porta Blu         |
| 3. Los Gallos Taqueria   | 11. Coffee Bar        |
| 4. Freewheel Brewing Co. | 12. FedEx Ship Center |
| 5. Starbucks             |                       |
| 6. U.S. Post Office      |                       |
| 7. Chevron Menlo Park    |                       |
| 8. Lee's Deli            |                       |



**MIKE COURSON**  
650.688.8527

**JACK TROEDSON**  
650.688.8520

**CARTER LYMAN**  
650.688.8559