

FOR LEASE

107 North G Street
Tacoma, WA 98403



BECOME A PART OF TACOMA'S HISTORIC GEM - THE STADIUM DISTRICT



STADIUM RETAIL

Kyle Prosser | Justin Holmes

First Western Properties—Tacoma Inc. | 253.472.0404
6402 Tacoma Mall Blvd, Tacoma, WA 98409 | fwp-inc.com

STADIUM DISTRICT RETAIL is located north of Downtown Tacoma, The Stadium Historic Business District is in the heart of the city's North End neighborhood. Stadium District is home to the incredible architecture of Stadium High School – made famous by the late 90's hit movie 10 Things I Hate About You – and the beauty of Wright Park. The Stadium District consists of long time businesses that have been serving Tacoma residents with quality service for many years. In addition, new establishments such as the Rhein Haus, Anthem Coffee & Tea, Mud Bay Pets and many other new retail businesses have contributed to the growing popularity of this district in Tacoma!

**+/- 20,700 TOTAL SF \$40.00 PSF PLUS NNN
(1,400-9,350 SF)**

- Located in highly desirable Stadium District
- New Building planned for development
- On new light rail line (to be completed by 2022)
- Restaurant space available with patio
- Adjacent to 160+ new units of apartments
- Close proximity to Downtown Tacoma & hospitals



Population



Average HH Income



Daytime Population

Regis - 2018

	Population	Average HH Income	Daytime Population
Mile 1	18,464	\$54,032	35,743
Mile 3	82,054	\$83,537	108,213
Mile 5	232,848	\$84,729	211,789

NEARBY TENANTS



STADIUM DISTRICT



LOCATION AERIAL



LOCATION AERIAL

RUSTON WAY -
TACOMA WATERFRONT

PROCTOR
DISTRICT



STADIUM
HIGH SCHOOL
1,600 STUDENTS



STADIUM
DISTRICT

UNIVERSITY
OF PUGET
SOUND

SIXTH AVE BUSINESS DISTRICT

MultiCare
TACOMA GENERAL
HOSPITAL

DOWNTOWN
TACOMA

ST JOSEPH
MEDICAL
CENTER

ALLENMORE
HOSPITAL

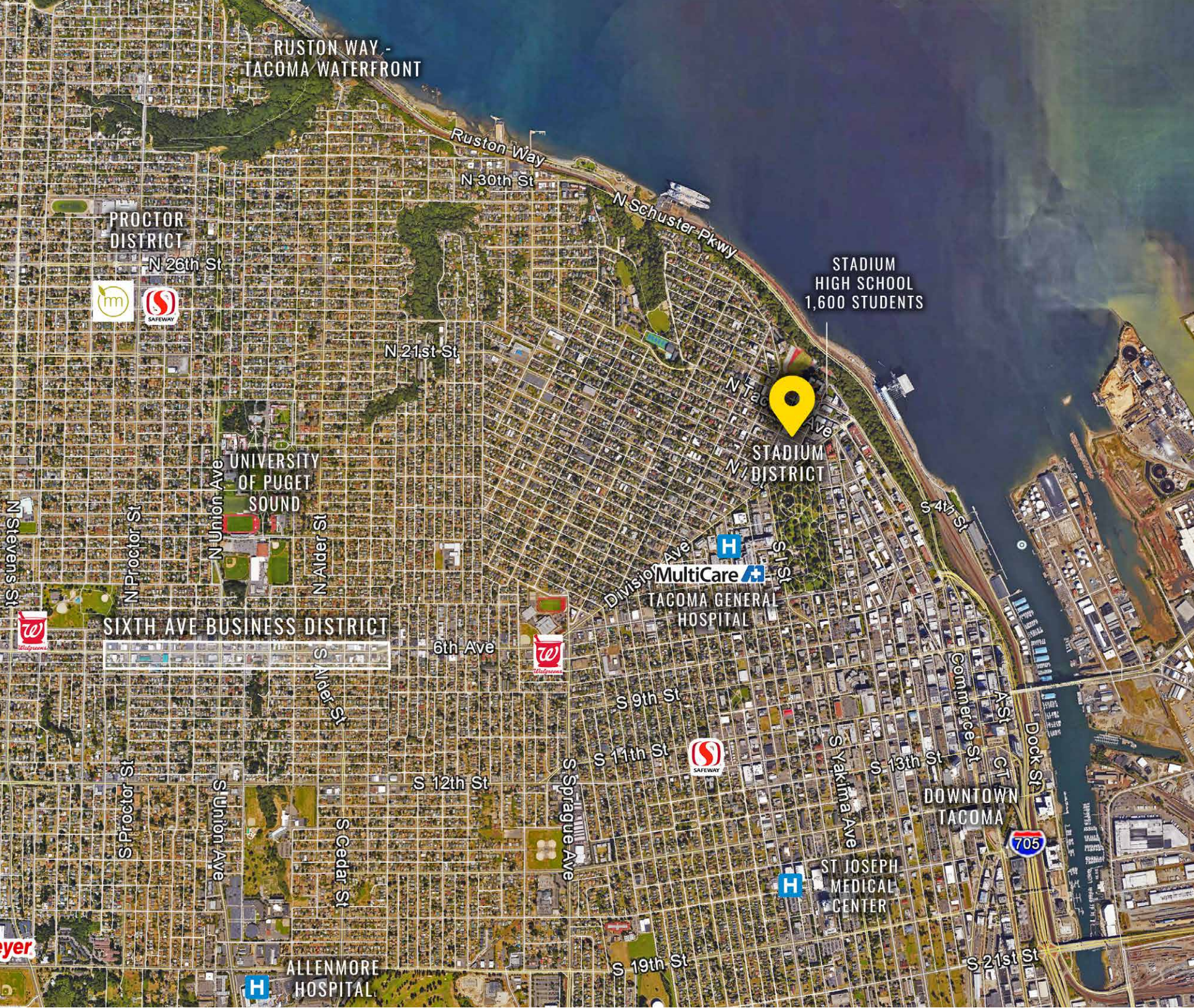

SITE PLAN

LEVEL 2

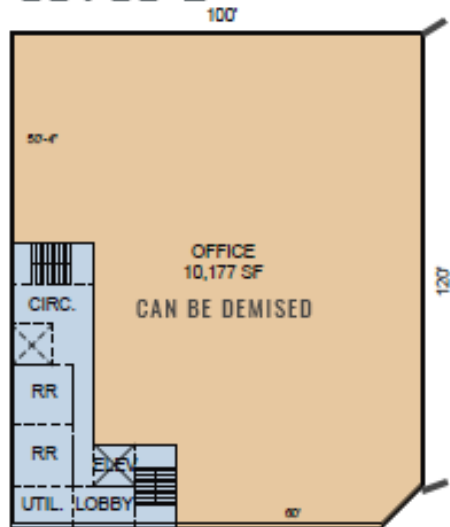

GROUND LEVEL

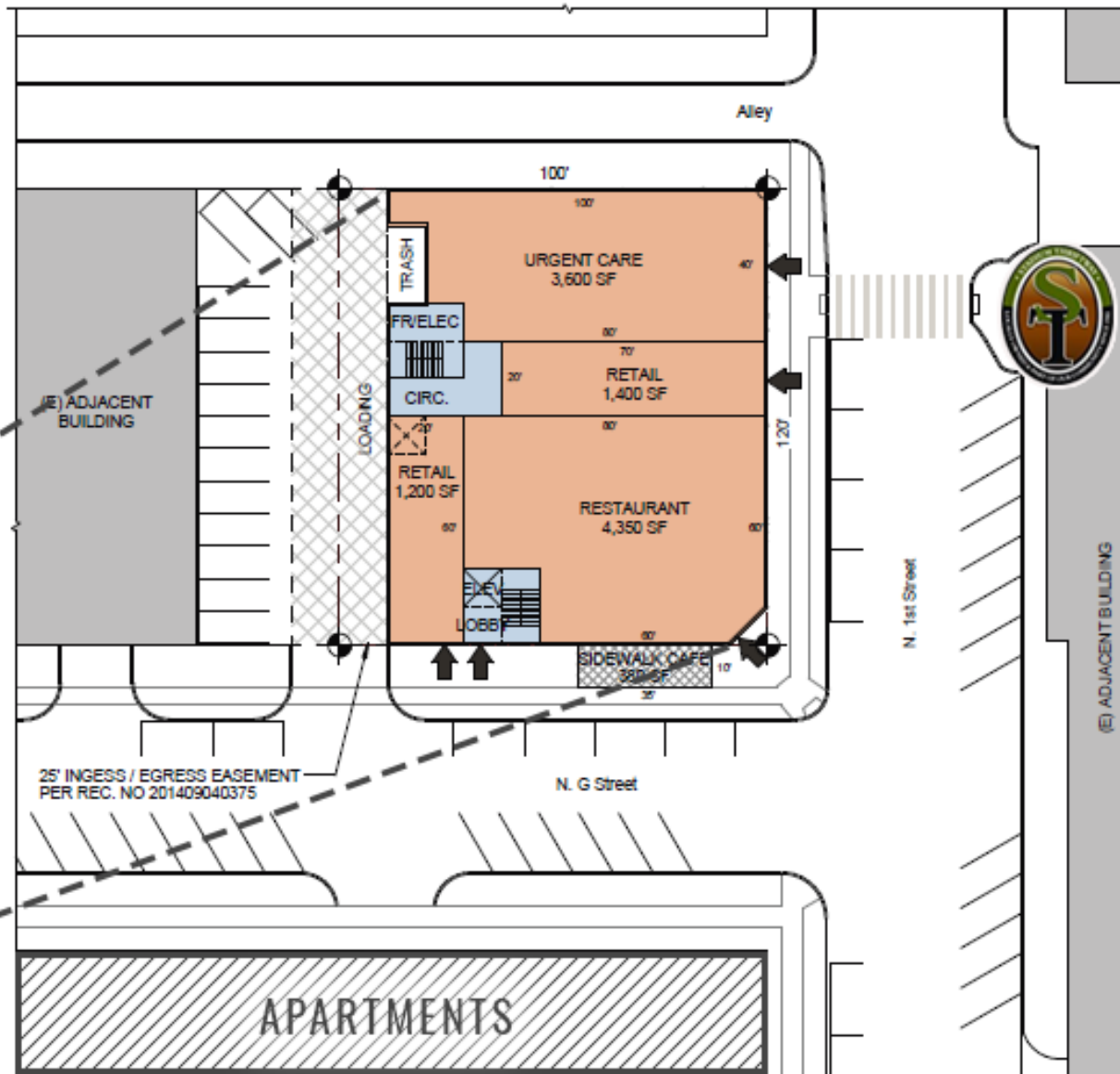



TACOMA, WA is rooted in the arts and has a vibrant urban core that is alive with culture. Situated along the Puget Sound, Tacoma is a mid-sized urban port city of Pierce County just over 30 miles south of Seattle. The museum district is home for its world-renowned Museum of Glass, while the waterfront, parks, gardens and wildlife make Tacoma a nature wonderland ready for all to explore.

TACOMA | KIRKLAND | SEATTLE | PORTLAND



RETAIL FOCUSED. RESULTS DRIVEN.

KYLE PROSSER

253.284.3633
kyle@firstwesternproperties.com

JUSTIN HOLMES

253.447.2282
justin@firstwesternproperties.com



First Western Properties—Tacoma Inc. | 253.472.0404
6402 Tacoma Mall Blvd, Tacoma, WA 98409 | fwp-inc.com

© First Western Properties, Inc. DISCLAIMER: The above information has been secured from sources believed to be reliable, however, no representations are made to its accuracy. Prospective tenants or buyers should consult their professional advisors and conduct their own independent investigation. Properties are subject to change in price and/or availability without notice.