

# FOR LEASE

6,408 SF AVAILABLE FOR LEASE  
2005 108<sup>th</sup> Street, Grand Prairie, TX



GREAT SOUTHWEST PKWY

SUITE 502  
6,408 SF  
AVAILABLE

108<sup>th</sup> STREET



# FOR LEASE

6,408 SF AVAILABLE FOR LEASE  
2005 108<sup>th</sup> Street, Grand Prairie, TX



## GENERAL BUILDING INFORMATION (SUITE 502)

- 6,408 SF AVAILABLE
- 3,868 SF WAREHOUSE
- 2,540 SF OFFICE
- 16' CLEAR HEIGHT
- ONE (1) DOCK HIGH DOOR
- ONE (1) RAMP DOOR
- FIVE (5) PARKING SPACES
- 2019 ROOF
- REAR-LOAD SERVICE
- PROFESSIONALLY LANDSCAPED
- ELECTRICAL POWER: 200 AMP
- (48' 0" W x 80' 0" DEEP)

*Leasing By:*

*Owned + Managed By:*



**Michael W. Spain**  
Executive Vice President  
972 337 9325  
mspain@Bradford.com

**Brock Wilson**  
Senior Vice President  
972 776 7081  
bwilson@bradford.com



# FOR LEASE

6,408 SF AVAILABLE FOR LEASE  
2005 108<sup>th</sup> Street, Grand Prairie, TX



## MARKETED BY:

**Michael W. Spain**  
Executive Vice President  
972 337 9325  
mspain@Bradford.com

**Brock Wilson**  
Senior Vice President  
972 776 7081  
bwilson@bradford.com

**SUITE 502**  
**6,408 SF**  
**AVAILABLE**

**WOODLANDS BUSINESS PARK**  
**GREAT SOUTHWEST**



## SF BREAKDOWN

|                 |                 |
|-----------------|-----------------|
| WAREHOUSE SF    | 3,868-sf        |
| OFFICE SF       | 2,540-sf        |
| <b>TOTAL SF</b> | <b>6,408-sf</b> |

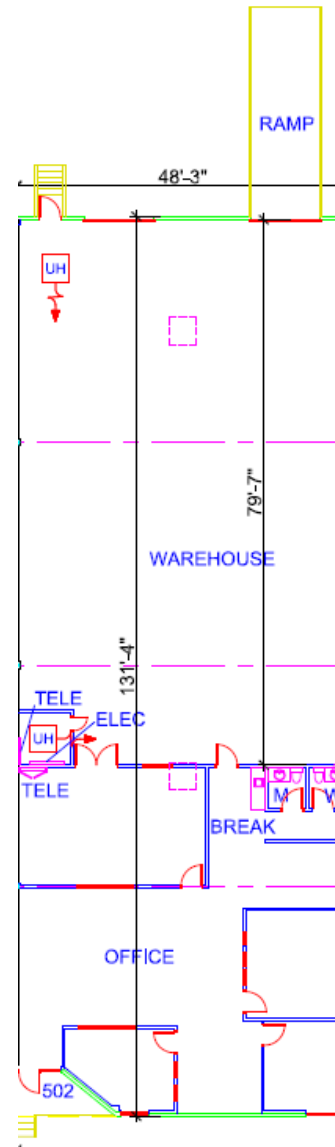



# FOR LEASE

6,408 SF AVAILABLE FOR LEASE  
2005 108<sup>th</sup> Street, Grand Prairie, TX





# FOR LEASE

6,408 SF AVAILABLE FOR LEASE  
2005 108<sup>th</sup> Street, Grand Prairie, TX

