

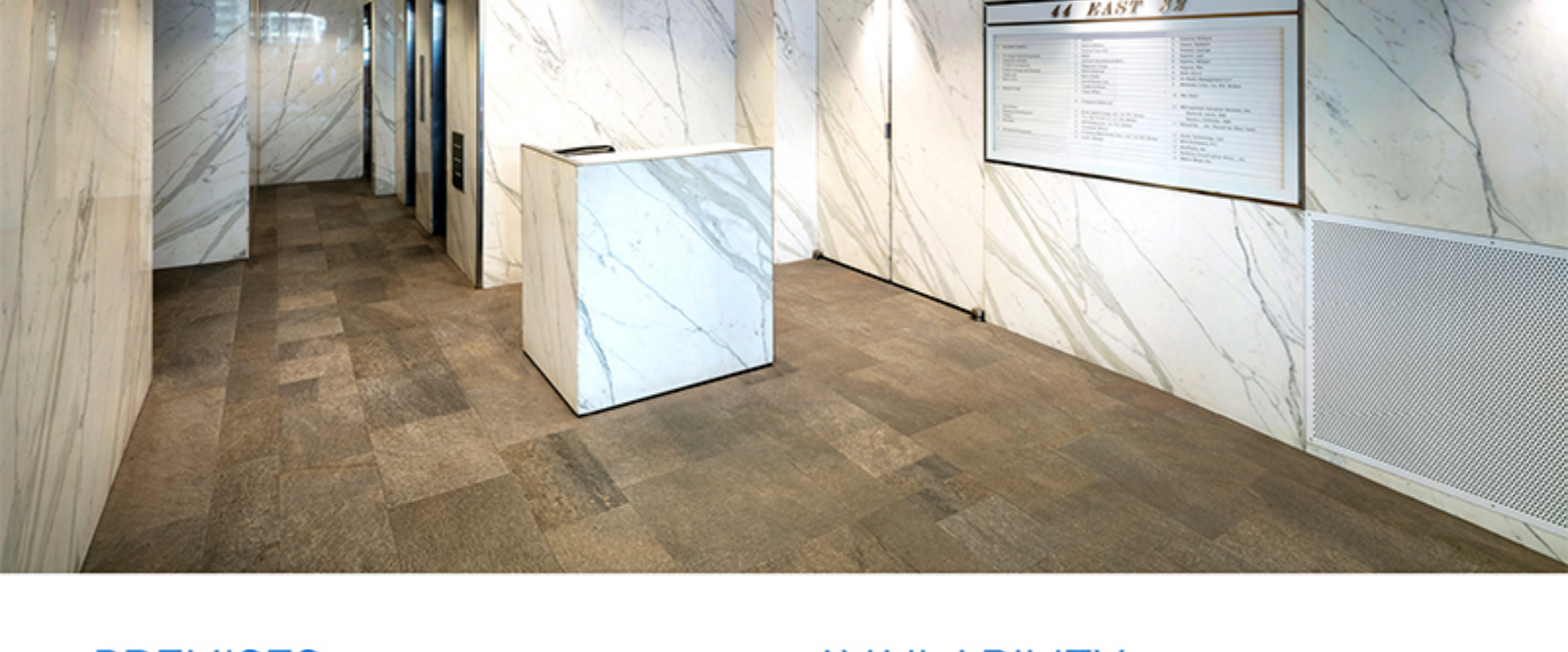

44  
EAST  
32  
ST

PRE-BUILT

NEWMARK



#### PREMISES

Entire 10th Floor - **7,229 RSF**

#### AVAILABILITY

Immediate

#### ASKING RENT

Upon Request

#### TERM

5-10 years

#### COMMENTS

- Ground-floor tenant: The Cutting Room
- Newly renovated lobby and elevators
- Close proximity to subway and bus lines
- Great for TAMI-type companies
- Long-term, stable ownership
- Pre-Built

**PAUL DAVIDSON**

212-372-2051

paul.davidson@nmrk.com

**ROY LAPIDUS**

212-372-2170

rlapidus@gfpre.com

**NEWMARK**

#### VIRTUALLY STAGED TOUR

CLICK TO VIEW

360°

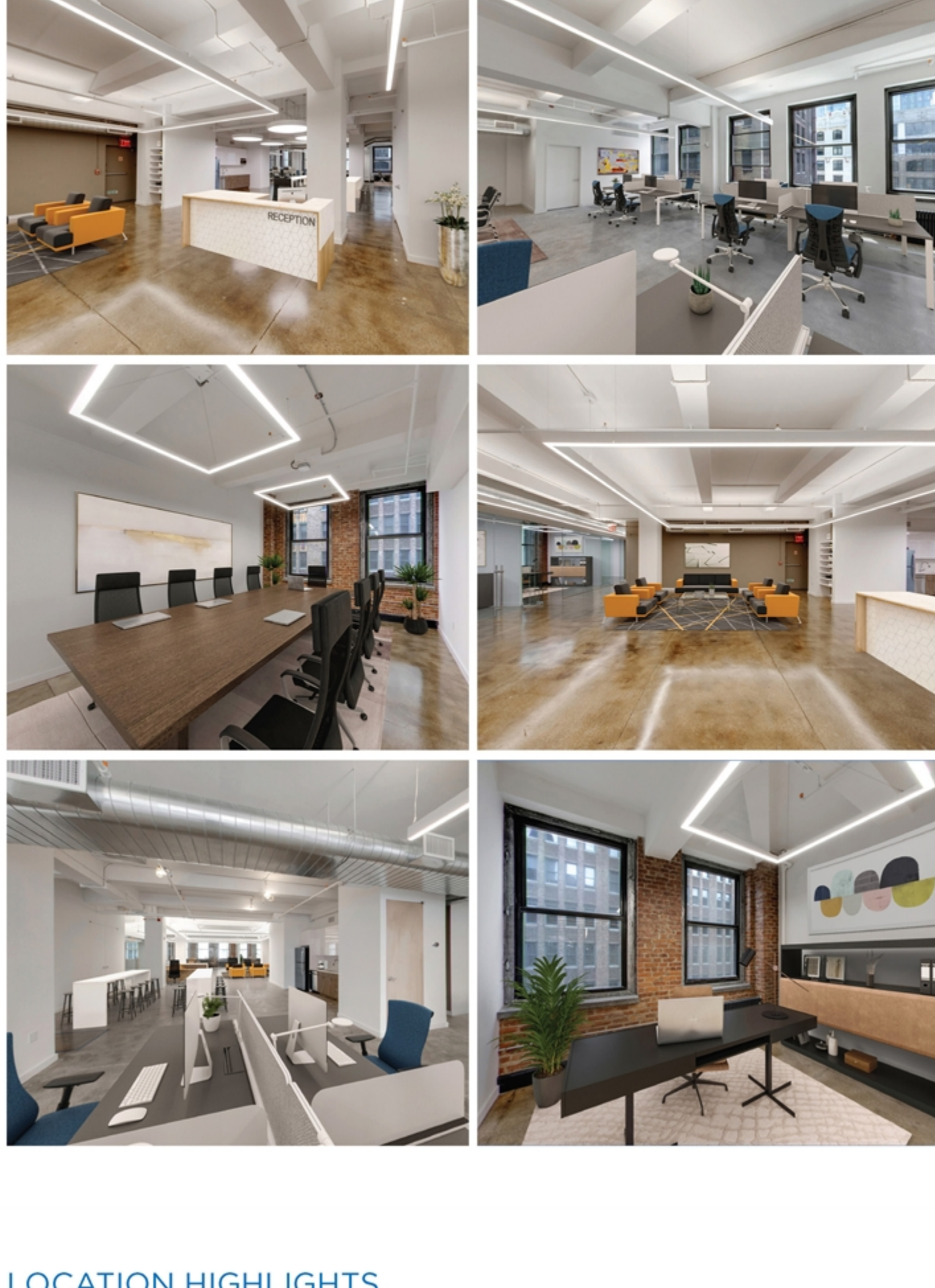

#### LOCATION HIGHLIGHTS



Located in the much desirable Transit Triangle with Penn Station, Grand Central Station and The Port Authority all within a 10 minute walk.



Go across the street to Exhale Spa. Around the corner sits world-renowned Wolfgang's Steakhouse. For the best coffee there's Gregory's.

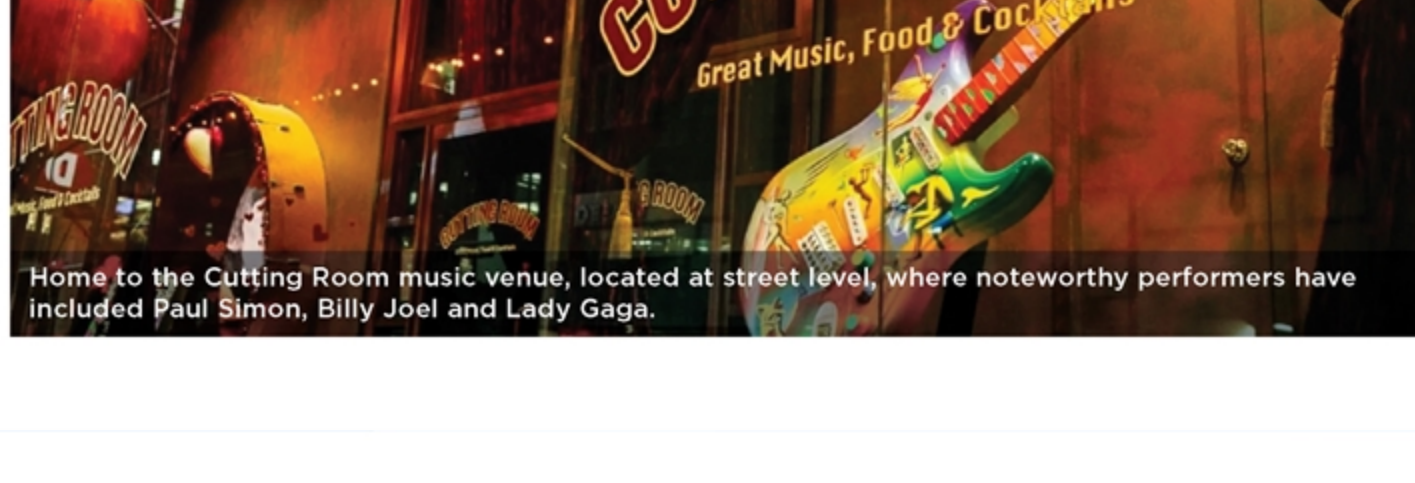

Home to the Cutting Room music venue, located at street level, where noteworthy performers have included Paul Simon, Billy Joel and Lady Gaga.

#### FLOOR PLAN

**7,229 RSF | 10th Floor**



**PAUL DAVIDSON**

212-372-2051

paul.davidson@nmrk.com

**ROY LAPIDUS**

212-372-2170

rlapidus@gfpre.com

**NEWMARK**



44  
EAST  
32  
ST

**PAUL DAVIDSON**

212-372-2051

paul.davidson@nmrk.com

**ROY LAPIDUS**

212-372-2170

rlapidus@gfpre.com

**NEWMARK**

The information contained herein has been obtained from sources deemed reliable but has not been verified and no guarantee, warranty or representation, either express or implied, is made with respect to such information. Terms of sale or lease and availability are subject to change or withdrawal without notice.

DOWNLOAD BROCHURE

125 Park Avenue, New York, NY 10017 | 212-372-2051

The information contained herein has been obtained from sources deemed reliable but has not been verified and no guarantee, warranty or representation, either express or implied, is made with respect to such information. Terms of sale or lease and availability are subject to change or withdrawal without notice.

©2022 Newmark. All Rights Reserved.