

# FORMER BANK BUILDING FOR SALE

824 LANSDOWNE AVENUE, DREXEL HILL, PA

±2,931 SF ON ±0.32 ACRES FOR SALE



## property highlights.

- Rare free-standing building with drive thru available in the heart of Drexel Hill (Delaware County)
- Accessible from Lansdowne Avenue and State Road
- Traffic Count on Lansdowne Avenue: 27,878 VPD
- Across the street from the Bond Shopping Center with Acme, Dollar Tree, Petco
- Property Tax Estimate (2019): \$26,055.71
- Pylon sign available on Lansdowne Avenue
- Asking Price: \$950,0000
- Zoning: C2

## stats.

2019 DEMOGRAPHICS*	1 MILE	3 MILES	5 MILES
EST. POPULATION	27,257	260,607	608,115
EST. HOUSEHOLDS	10,226	99,323	230,772
EST. AVG. HH INCOME	\$94,788	\$84,116	\$81,442



**METRO**<sup>®</sup>  
COMMERCIAL  
REAL ESTATE, INC.

MetroCommercial.com | PHILADELPHIA, PA | PLYMOUTH MEETING, PA | MOUNT LAUREL, NJ | NAPLES, FL

get in touch.

**GREG JONES**

office 610.825.5222  
direct 610.260.2662

[gjones@metrocommercial.com](mailto:gjones@metrocommercial.com)



\*DEMOGRAPHICS BASED ON A 5-MILE RADIUS

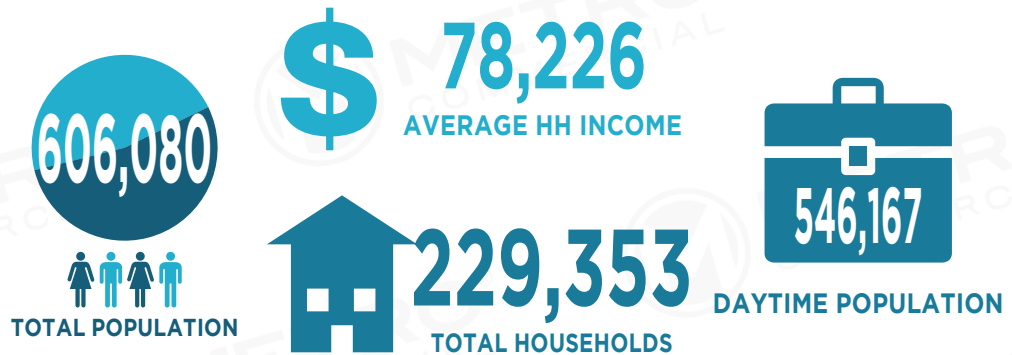

### 5 Mile Schools and Colleges

- Upper Darby High School - 3,625
- PCOM - 2,287
- Beverly Hills Middle School - 1,415
- Drexel Hill Middle School - 1,254
- Monsignor Bonner & Archbishop Prendergast Catholic High School - 860
- Penn Wood High School - 743
- Highland Park Elementary School - 723
- Hillcrest Elementary School - 696
- Bywood Elementary School - 624
- Saint Andrew School - 420
- St. Bernadette of Lourdes School - 315

### Major Attractions

- Lower Swedish Cabin
- Merry Place
- Philadelphia Zoo
- Belmont Plateau
- Llanerch Country Club
- Bala Golf Club
- Please Touch Museum

### Major Employers

- University Of Penn-Med Group - 5,000
- Lankenau Medical Center - 2,175
- Penn Presbyterian Medical Center - 1,775
- Bryn Mawr Hospital - 1,494
- St Joseph's University - 1,354
- Delaware County Memorial Hospital - 1,350
- ESF Concepts For Children - 1,200
- Mercy Philadelphia Hospital - 1,100
- Veterinary Hospital Univ Of PA - 800
- Whole Foods Market - 800
- Inglis House - 800
- Bryn Mawr College - 750
- Ellen Pure - 700
- Wistar Institute - 580
- Care Pavilion Of Walnut Park - 508
- Wharton School - 501

**824 LANSDOWNE AVENUE  
DREXEL HILL, PA**



The information and images contained herein are from sources deemed reliable. However, Metro Commercial Real Estate, Inc. makes no representation whatsoever as to their accuracy or authenticity. Images shown may be modified for illustrative purposes. Images may be out-of-date and not current. 10.17.19

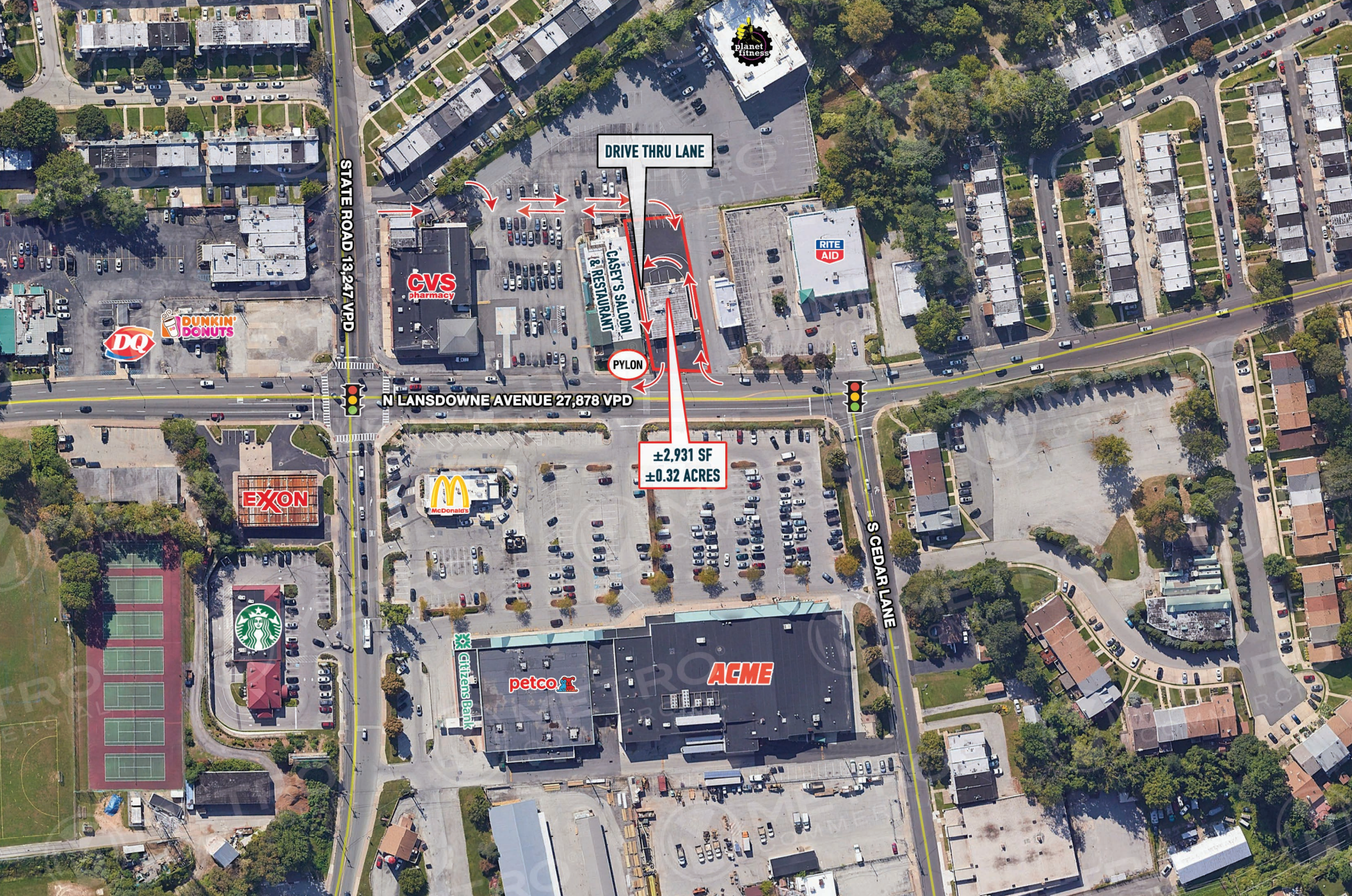

STATE ROAD 19, 247 VPD

DRIVE THRU LANE

N LANSDOWNE AVENUE 27,878 VPD

±2,931 SF  
±0.32 ACRES

S CEDAR LANE

824 LANSDOWNE AVENUE  
DREXEL HILL, PA



The information and images contained herein are from sources deemed reliable. However, Metro Commercial Real Estate, Inc. makes no representation whatsoever as to their accuracy or authenticity. Images shown may be modified for illustrative purposes. Images may be out-of-date and not current. 10.17.19

# SPACE PLAN

N LANSLOWNE AVENUE 27,878 VPD

DRIVE-THRU LANE

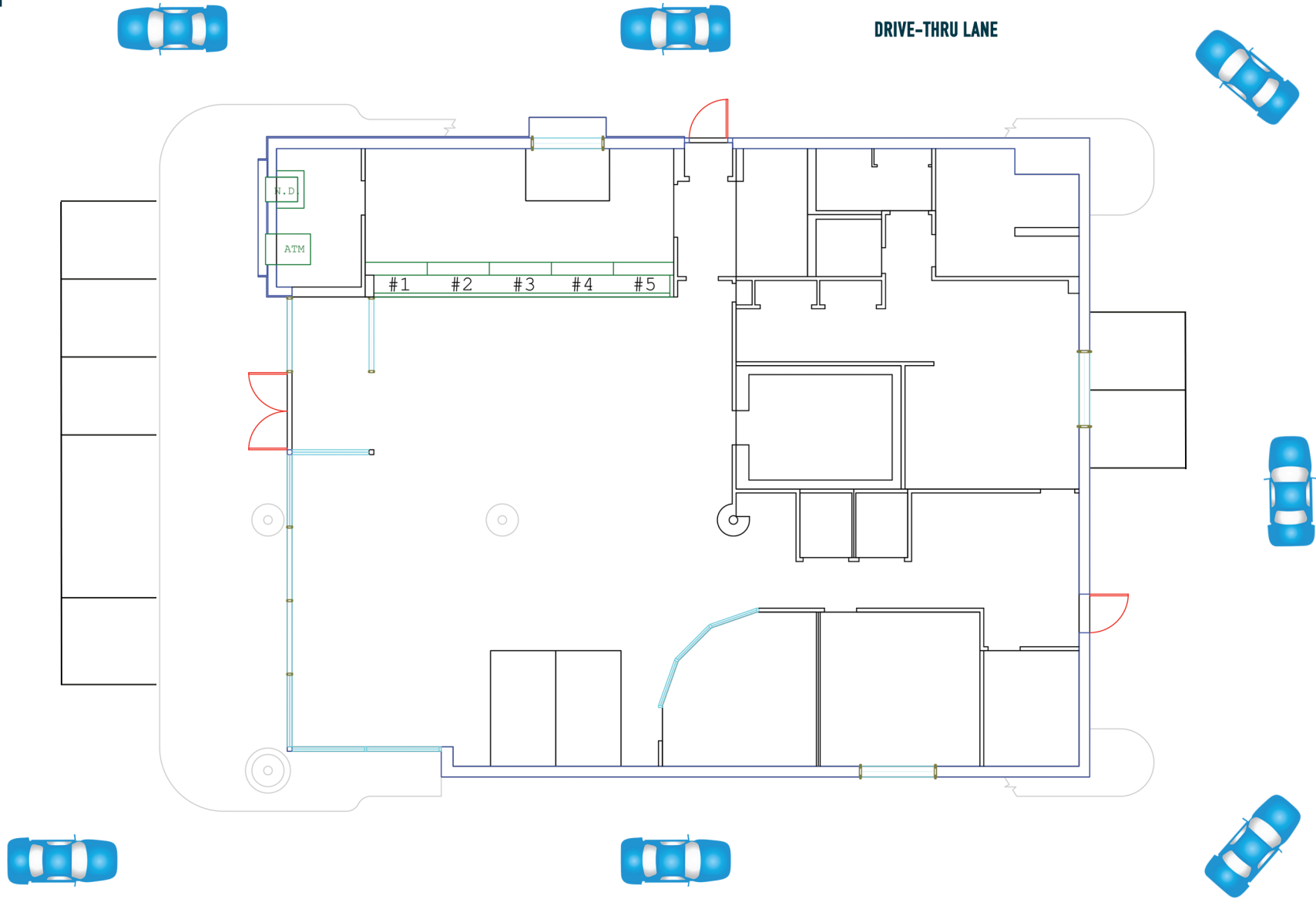

The information and images contained herein are from sources deemed reliable. However, Metro Commercial Real Estate, Inc. makes no representation whatsoever as to their accuracy or authenticity. Images shown may be modified for illustrative purposes. Images may be out-of-date and not current. 10.17.19

824 LANSLOWNE AVENUE  
DREXEL HILL, PA





The information and images contained herein are from sources deemed reliable. However, Metro Commercial Real Estate, Inc. makes no representation whatsoever as to their accuracy or authenticity. Images shown may be modified for illustrative purposes. Images may be out-of-date and not current. 10.17.19

**824 LANSDOWNE AVENUE  
DREXEL HILL, PA**





The information and images contained herein are from sources deemed reliable. However, Metro Commercial Real Estate, Inc. makes no representation whatsoever as to their accuracy or authenticity. Images shown may be modified for illustrative purposes. Images may be out-of-date and not current. 10.17.19

**824 LANSDOWNE AVENUE**  
**DREXEL HILL, PA**

