

328 S. Beverly Drive, Suite D, Beverly Hills, CA 90212



OFFICE/RETAIL/STUDIO  
SPACE WITH COURTYARD

FOR LEASE



GREG ECKHARDT  
310.395.2663 X103  
GECKO@PARCOMMERCIAL.COM  
LIC# 01255469

ARTHUR PETER  
310.395.2663 X101  
ARTHUR@PARCOMMERCIAL.COM  
LIC# 010686613

## PROPERTY CHARACTERISTICS



# 328 S. Beverly Drive, Suite D Beverly Hills, CA 90212

**SIZE:** Approximately 600 square feet

**RATE:** \$2,995 per month, MG  
(Net of electric)

**TERM:** 1 - 3 years

**AVAILABLE:** Immediately



- **Hard to find small office/retail space with private bathroom in charming building**
- **Just north of Olympic**
- **Near a high concentration of restaurants, retail and office space**
- **Neighbors include Four Seasons Hotel, Urth Cafe Beverly Hills, Peet's Coffee and more**



**GREG ECKHARDT**  
310.395.2663 X103

GECKO@PARCOMMERCIAL.COM  
LIC# 01255469

**ARTHUR PETER**  
310.395.2663 X101

ARTHUR@PARCOMMERCIAL.COM  
LIC# 010686613

# AREA & PLATT MAP

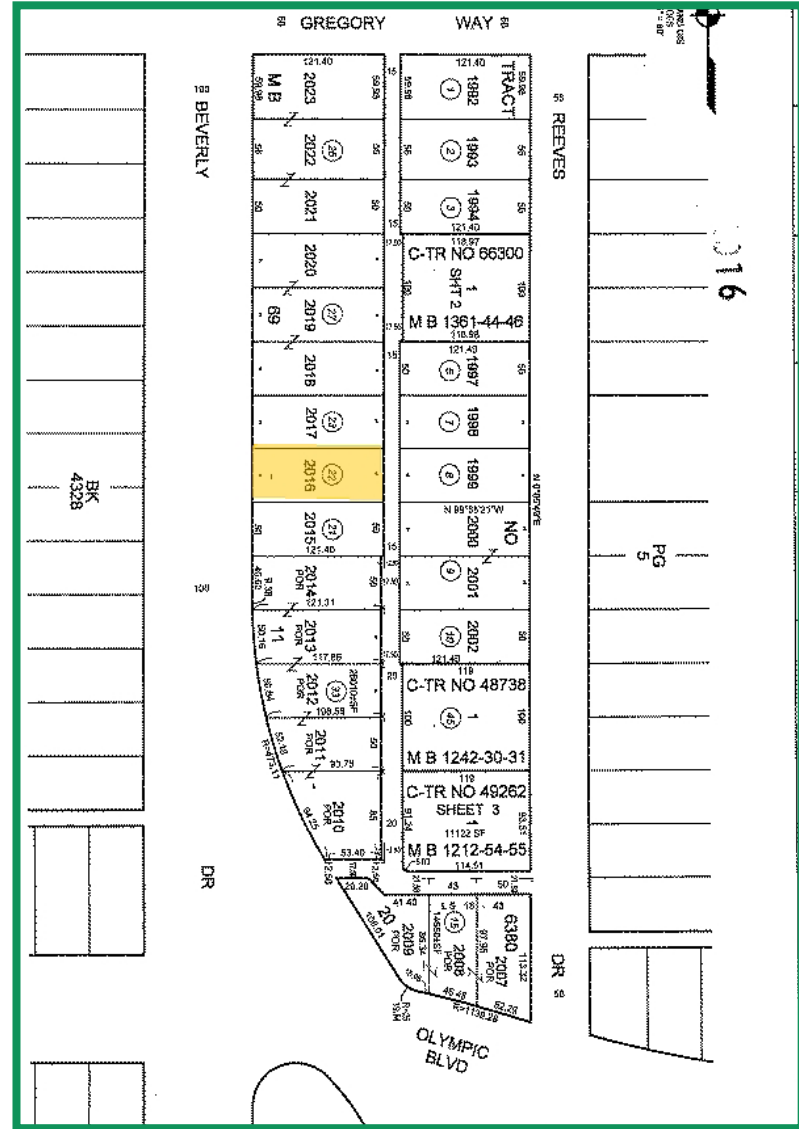
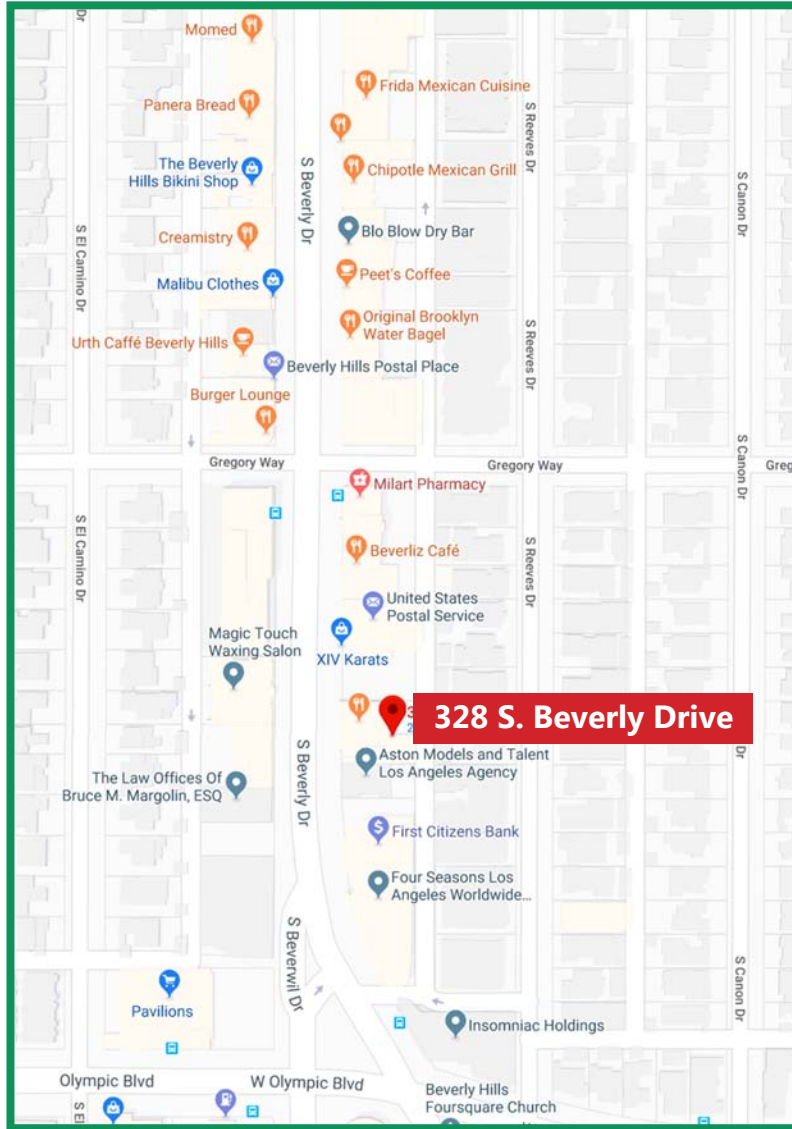

**GREG ECKHARDT**  
**310.395.2663 X103**  
**GECKO@PARCOMMERCIAL.COM**  
**LIC# 01255469**

**ARTHUR PETER**  
**310.395.2663 X101**  
**ARTHUR@PARCOMMERCIAL.COM**  
**LIC# 010686613**