



FOR LEASE - PROPOSED RETAIL DEVELOPMENT

NWC Holt Blvd. & Grove Ave.

1179 & 1191 E. Holt Blvd., Ontario, CA 91761



FEATURES:

- Estimated 3Q 2018 Delivery
- Express Car Wash Proposed For Northern Portion Of Site
- Proposed Future Realignment of I-10 FWY To Exit Grove Ave.
- Shop And Pad Spaces From ±1,200 - ±5,000 SF
- Drive Thru Pads Available
- Signalized Intersection With Strong Traffic Counts
- Within 2 Miles Of The Ontario International Airport, Averaging 6.2 Million Passengers Per Year (Wikipedia.com)
- Under-Served Trade Area With A Growing Daytime Population

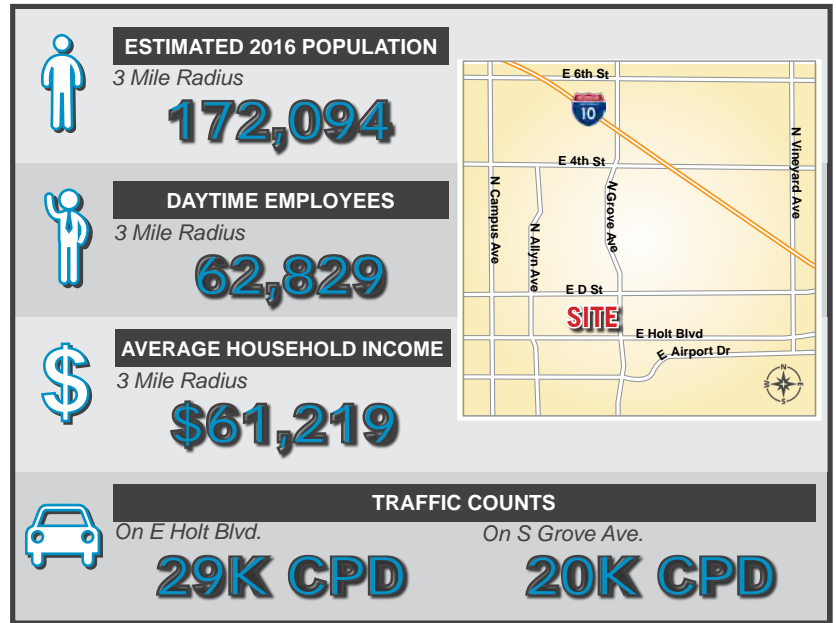

LEE & ASSOCIATES
COMMERCIAL REAL ESTATE SERVICES

JON FRIESEN
951.276.3603
jfriesen@leeriverside.com
Lic. #00913077

JEFF STANLEY
951.276.3612
jstanley@leeriverside.com
Lic. #01016436



FOR LEASE - PROPOSED RETAIL DEVELOPMENT

NWC Holt Blvd. & Grove Ave.

1179 & 1191 E. Holt Blvd., Ontario, CA 91761

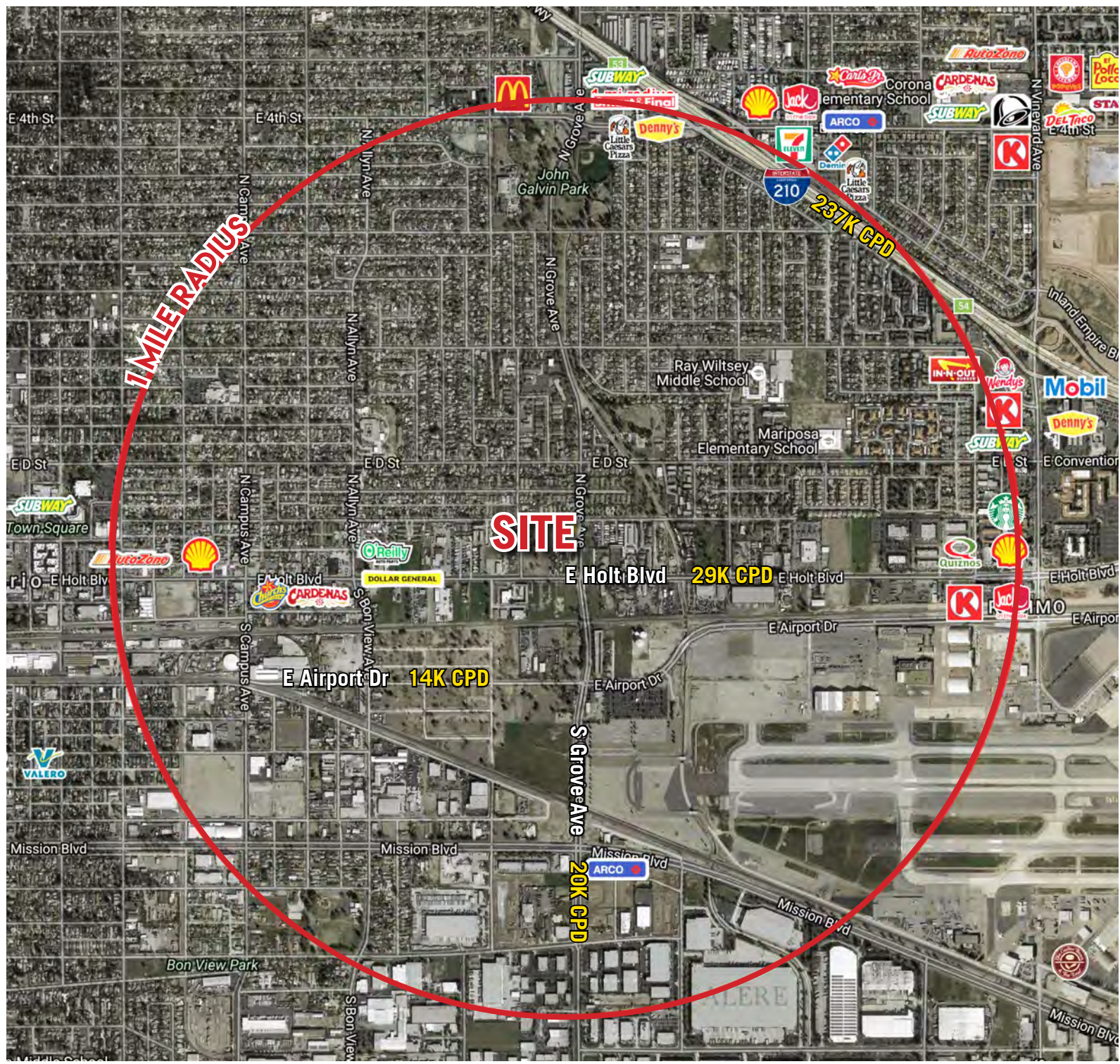

Rev.1.18.17

LEE & ASSOCIATES
 COMMERCIAL REAL ESTATE SERVICES

JON FRIESEN
 951.276.3603
 jfriesen@leeriverside.com
 Lic. #00913077

JEFF STANLEY
 951.276.3612
 jstanley@leeriverside.com
 Lic. #01016436

No warranty or representation has been made to the accuracy of the foregoing information. Terms of sale or lease and availability are subject to change or withdrawal without notice. Lee & Associates Commercial Real Estate Services, Inc. - Riverside. 3240 Mission Inn Avenue - Riverside, CA 92507 | Corporate ID# 01048055



FOR LEASE - PROPOSED RETAIL DEVELOPMENT

NWC Holt Blvd. & Grove Ave.

1179 & 1191 E. Holt Blvd., Ontario, CA 91761

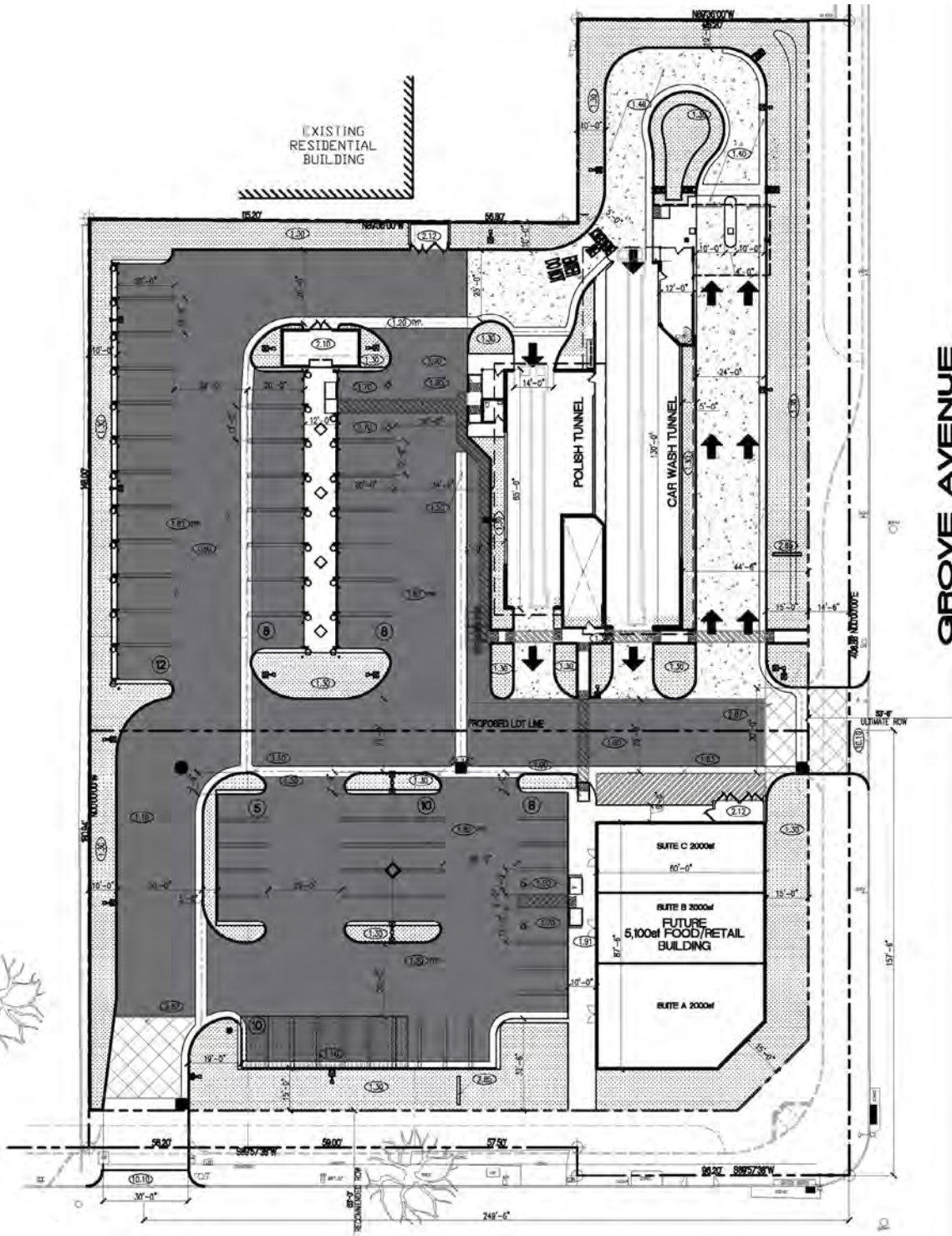

LEE & ASSOCIATES

COMMERCIAL REAL ESTATE SERVICES

JON FRIESEN

951.276.3603

jfriesen@leeriverside.com

Lic. #00913077

JEFF STANLEY

951.276.3612

jstanley@leeriverside.com

Lic. #01016436

No warranty or representation has been made to the accuracy of the foregoing information. Terms of sale or lease and availability are subject to change or withdrawal without notice.

Lee & Associates Commercial Real Estate Services, Inc. - Riverside. 3240 Mission Inn Avenue - Riverside, CA 92507 | Corporate ID# 01048055