

HEADWAY OFFICE PARK

4410, 4500 & 4620
NORTH STATE ROAD 7
Lauderdale Lakes, Florida 33319

FOR LEASE

UP TO 90,000 SF AVAILABLE

PROPERTY FEATURES

- New ownership
- Multi-Building Availability for up to 90K SF
- Exterior building signage available
- 4/1,000 SF parking ratio, free of charge
- Professional Class B office buildings with lakefront setting
- Immediate access to Florida's Turnpike & easy access to I-95
- Proximity to Banking, Retail and Restaurants
- Immediate Occupancy Available

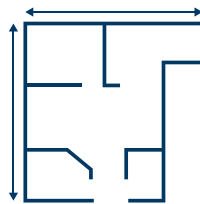

FULL BUILDING with
45K SF AVAILABLE
Offering Exterior Building Signage

NEW
OWNERSHIP

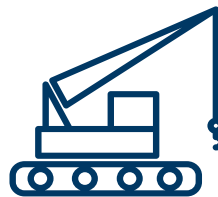

**MAJOR BUILDING
RENOVATIONS
UNDERWAY**

For leasing information, please contact:

Donna Korn
Managing Director
+1 954 377 0498
donna.korn@cushwake.com

Beau Ladwig
Associate
+1 954 938 2610
beau.ladwig@cushwake.com

Cushman & Wakefield of Florida, LLC
515 East Las Olas Blvd., Suite 900
Fort Lauderdale, Florida 33301
cushwakesouthfl.com

HEADWAY OFFICE PARK

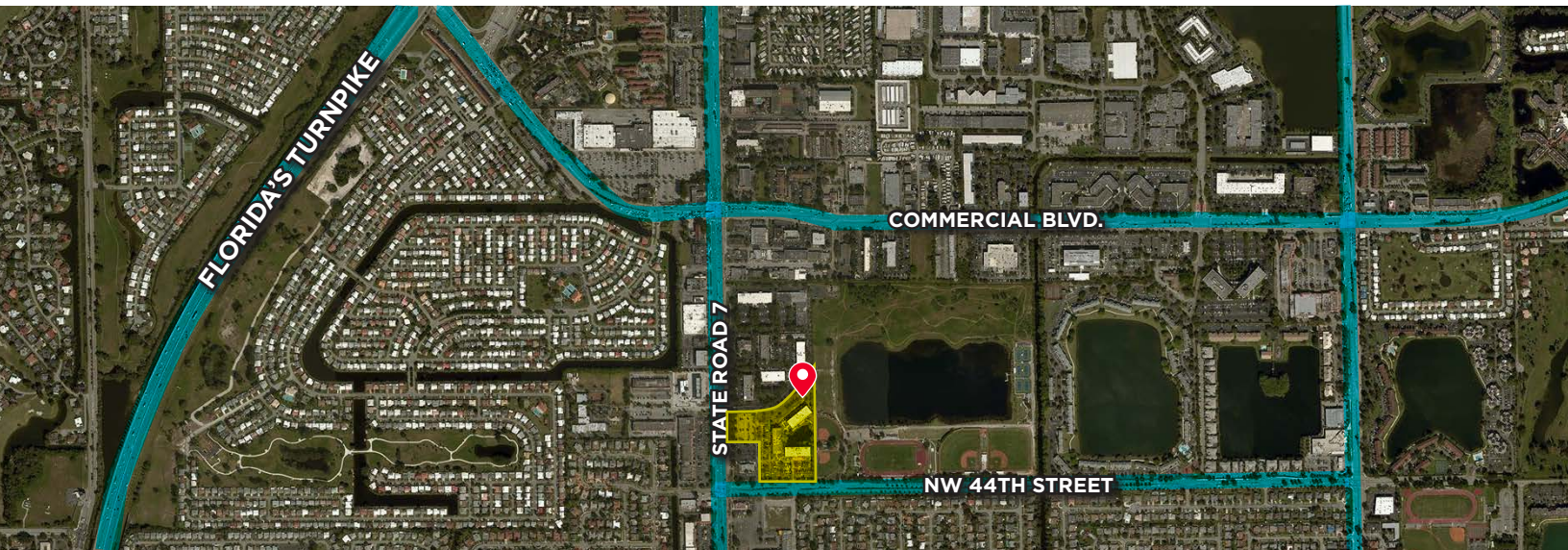

RENTAL RATE	\$21.00 Full Service
BUILDING SIZE	4410 N. State Road 7 - ±42,041 4500 N. State Road 7 - ±42,016 4620 N. State Road 7 - ±42,072
STORIES	3
PARKING	4/1,000, parking ratio, free of charge, additional parking available

For leasing information, please contact:

Donna Korn
Managing Director
+1 954 377 0498
donna.korn@cushwake.com

Beau Ladwig
Associate
+1 954 938 2610
beau.ladwig@cushwake.com

Cushman & Wakefield of Florida, LLC
515 East Las Olas Blvd., Suite 900
Fort Lauderdale, Florida 33301
cushwakesouthfl.com

©2019 Cushman & Wakefield. All rights reserved. The information contained in this communication is strictly confidential. This information has been obtained from sources believed to be reliable but has not been verified. NO WARRANTY OR REPRESENTATION, EXPRESS OR IMPLIED, IS MADE AS TO THE CONDITION OF THE PROPERTY (OR PROPERTIES) REFERENCED HEREIN OR AS TO THE ACCURACY OR COMPLETENESS OF THE INFORMATION CONTAINED HEREIN, AND SAME IS SUBMITTED SUBJECT TO ERRORS, OMISSIONS, CHANGE OF PRICE, RENTAL OR OTHER CONDITIONS, WITHDRAWAL WITHOUT NOTICE, AND TO ANY SPECIAL LISTING CONDITIONS IMPOSED BY THE PROPERTY OWNER(S). ANY PROJECTIONS, OPINIONS OR ESTIMATES ARE SUBJECT TO UNCERTAINTY AND DO NOT SIGNIFY CURRENT OR FUTURE PROPERTY PERFORMANCE.