

Property Features

- ❖ **Last remaining floor available**
- ❖ Outstanding location
- ❖ Immediate occupancy
- ❖ **Divisions of up to 10,000 sq. ft.**
- ❖ Two passenger elevators
- ❖ Entrances on Flushing Avenue & Debevoise Street
- ❖ 5 story building
- ❖ Signage available
- ❖ Approximately 13' ceilings
- ❖ Large windows
- ❖ Efficient layouts
- ❖ 24 hour access



~ Ideal for Non-Profit, General Office, Film & TV Production, Community, Tech Use ~

**20,000 Sq. Ft.
Flex/Office Space
For Lease**

**Entire 4th
Floor**

Location

In the heart of Williamsburg
Easy access to Brooklyn Queens
Expressway

Transportation

Close to **J** & **M** subway lines and
B57, B43 & B46 bus lines

CALL FOR PRICING

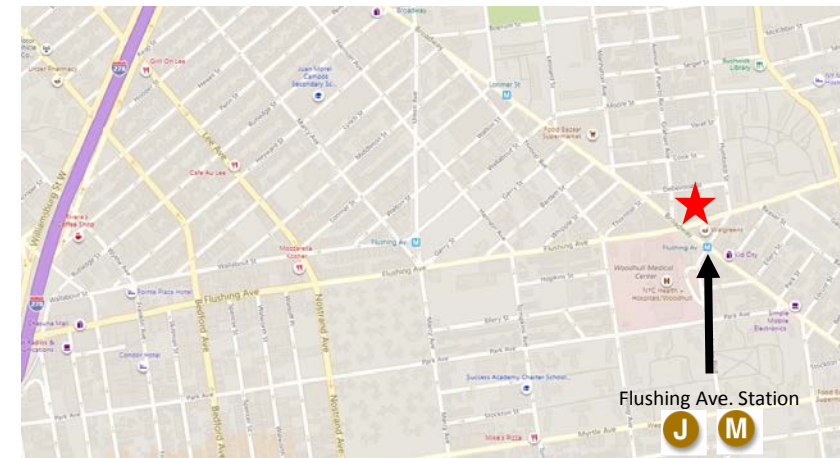

For Further Information and Inspection, Please Contact Exclusive Agent:
Melissa Grasso • Salesperson • (718) 371-0127 • mgrasso@s-z.com

Kaufman Astoria Studios 35-11 35th Avenue, Long Island City, NY 11106 • (718) 392-5959 • Fax (718) 937-6546
www.s-z.com

785 Flushing Avenue, Williamsburg, Brooklyn, NY

**Sholom &
Zuckerbrot Realty LLC**
Established 1962

INTERIOR PHOTOS



For Further Information and Inspection, Please Contact Exclusive Agent:
Melissa Grasso • Salesperson • (718) 371-0127 • mgrasso@s-z.com

Kaufman Astoria Studios 35-11 35th Avenue, Long Island City, NY 11106 • (718) 392-5959 • Fax (718) 937-6546
www.s-z.com



FOURTH FLOOR GROSS AREA LAYOUT

For Further Information and Inspection, Please Contact Exclusive Agent:
Melissa Grasso • Salesperson • (718) 371-0127 • mgrasso@s-z.com

Kaufman Astoria Studios 35-11 35th Avenue, Long Island City, NY 11106 • (718) 392-5959 • Fax (718) 937-6546
www.s-z.com

FOURTH FLOOR DIVISIONS OPTION #1

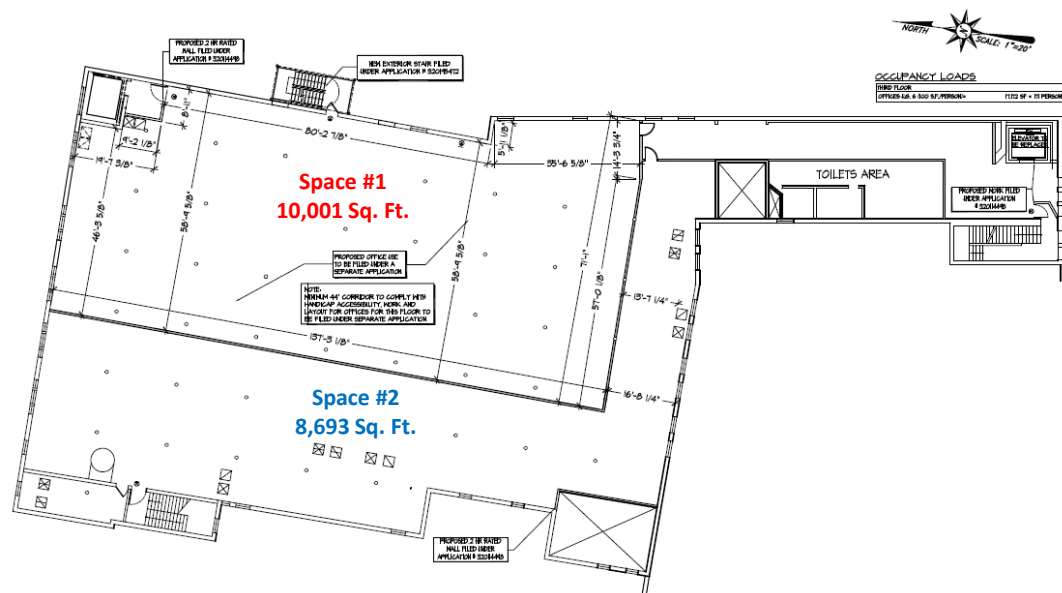

FOURTH FLOOR DIVISIONS OPTION #2

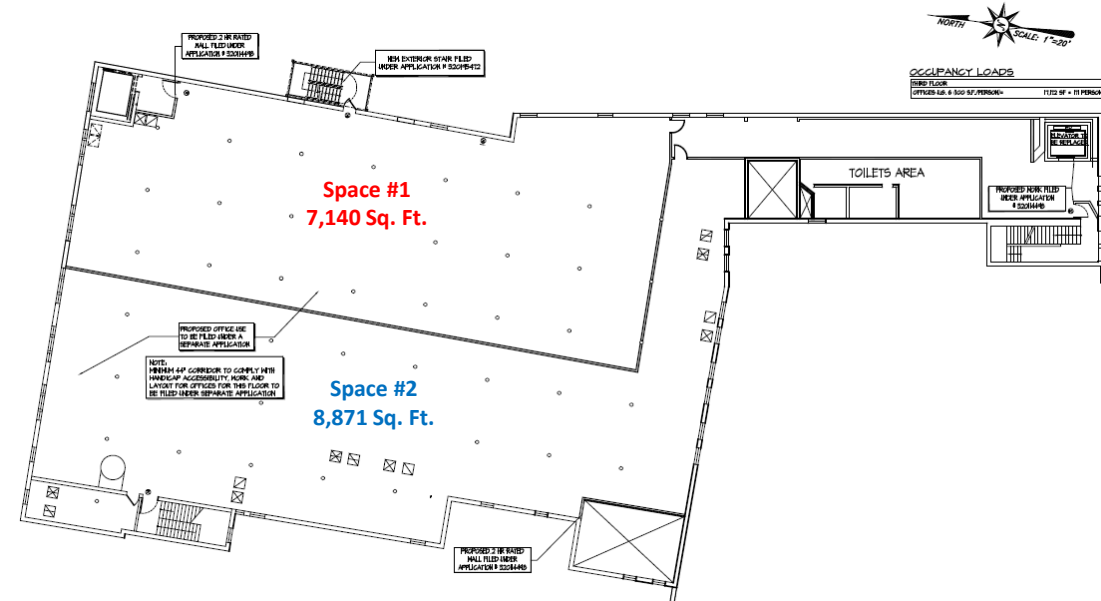

For Further Information and Inspection, Please Contact Exclusive Agent:
Melissa Grasso • Salesperson • (718) 371-0127 • mgrasso@s-z.com

Kaufman Astoria Studios 35-11 35th Avenue, Long Island City, NY 11106 • (718) 392-5959 • Fax (718) 937-6546
www.s-z.com

FOURTH FLOOR DIVISIONS OPTION #3

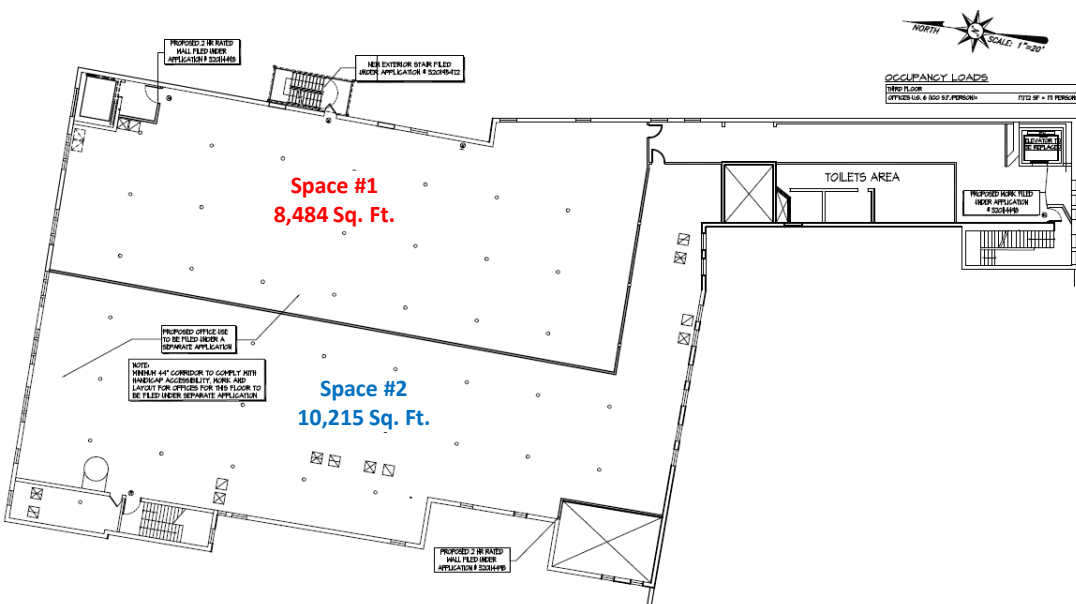

FOURTH FLOOR DIVISIONS OPTION #4

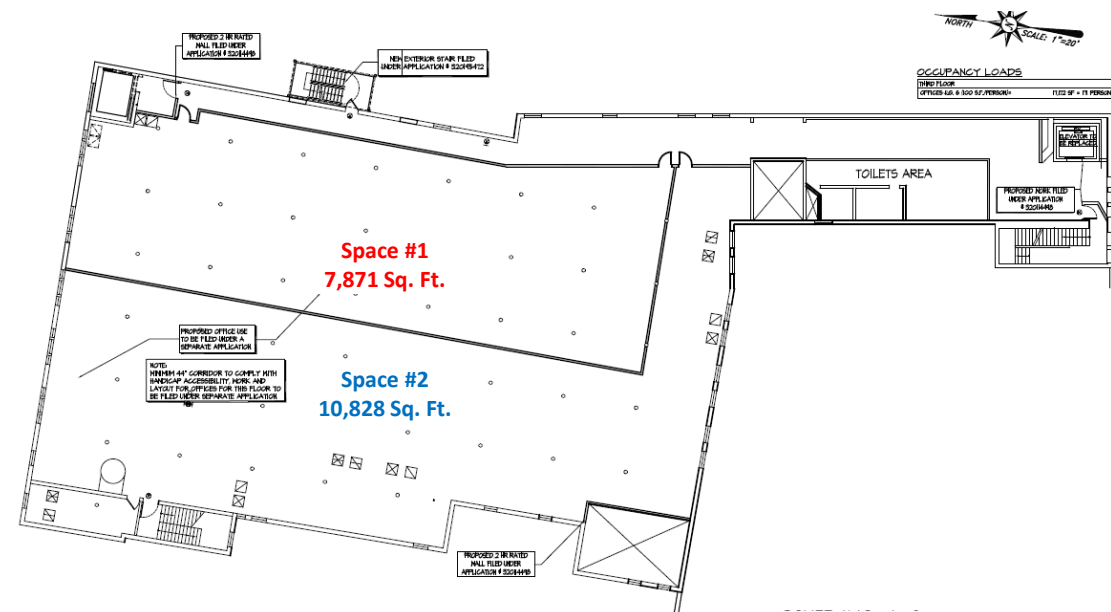

For Further Information and Inspection, Please Contact Exclusive Agent:

Melissa Grasso • Salesperson • (718) 371-0127 • mgrasso@s-z.com

Kaufman Astoria Studios 35-11 35th Avenue, Long Island City, NY 11106 • (718) 392-5959 • Fax (718) 937-6546

www.s-z.com

FOURTH FLOOR DIVISIONS OPTION #5

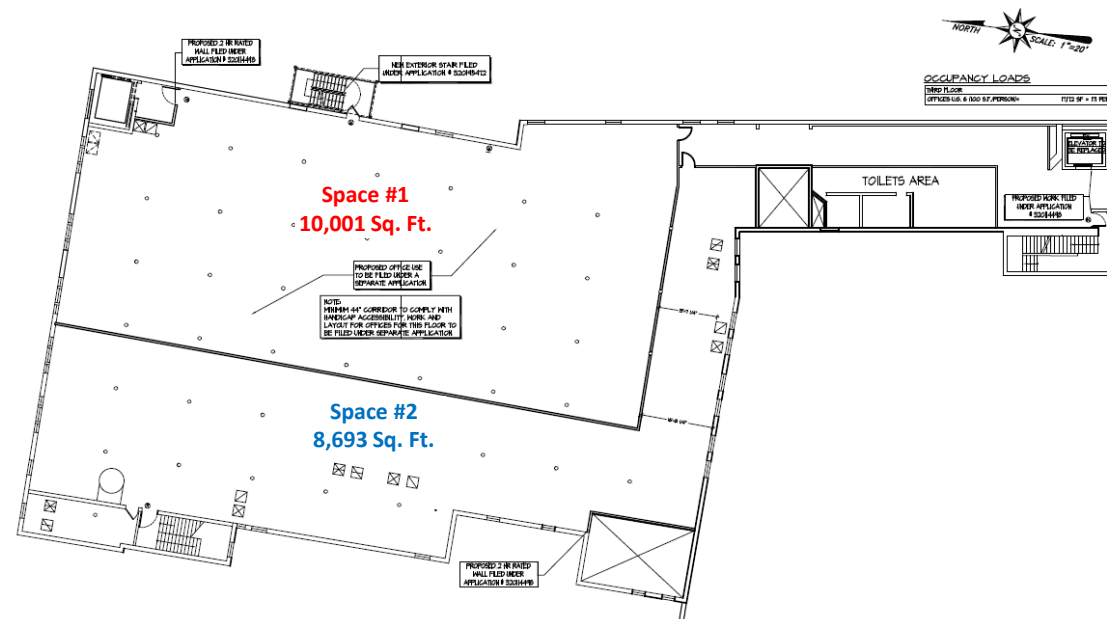

For Further Information and Inspection, Please Contact Exclusive Agent:

Melissa Grasso • Salesperson • (718) 371-0127 • mgrasso@s-z.com

Kaufman Astoria Studios 35-11 35th Avenue, Long Island City, NY 11106 • (718) 392-5959 • Fax (718) 937-6546

www.s-z.com