

27000 MEADOWBROOK RD
NOVI, MICHIGAN

HI-TECH FOR LEASE
4,700 - 12,110 Square Feet Available



**SIGNATURE
ASSOCIATES**
KNOW SIGNATURE | KNOW RESULTS

MEADOWBROOK CORPORATE PARK



PROPERTY FEATURES

- 4,700 - 12,110 square feet of office / engineering space available
- Situated on 5.99 acres
- Heavy power available
- 180 car parking
- 18' clear height
- (2) 10x10 grade level doors
- Zoned OST



For more information, please contact:

PAUL HOGE
(248) 948 0103
paulhoge@signatureassociates.com

DAVE GREEN
(248) 948 4184
dgreen@signatureassociates.com

SIGNATURE ASSOCIATES
One Towne Square, Suite 1200
Southfield, MI 48076
www.signatureassociates.com

27000 Meadowbrook Road - Novi, Michigan

Hi-Tech For Lease

4,700 – 12,110
Square Feet
AVAILABLE

Floor Plan

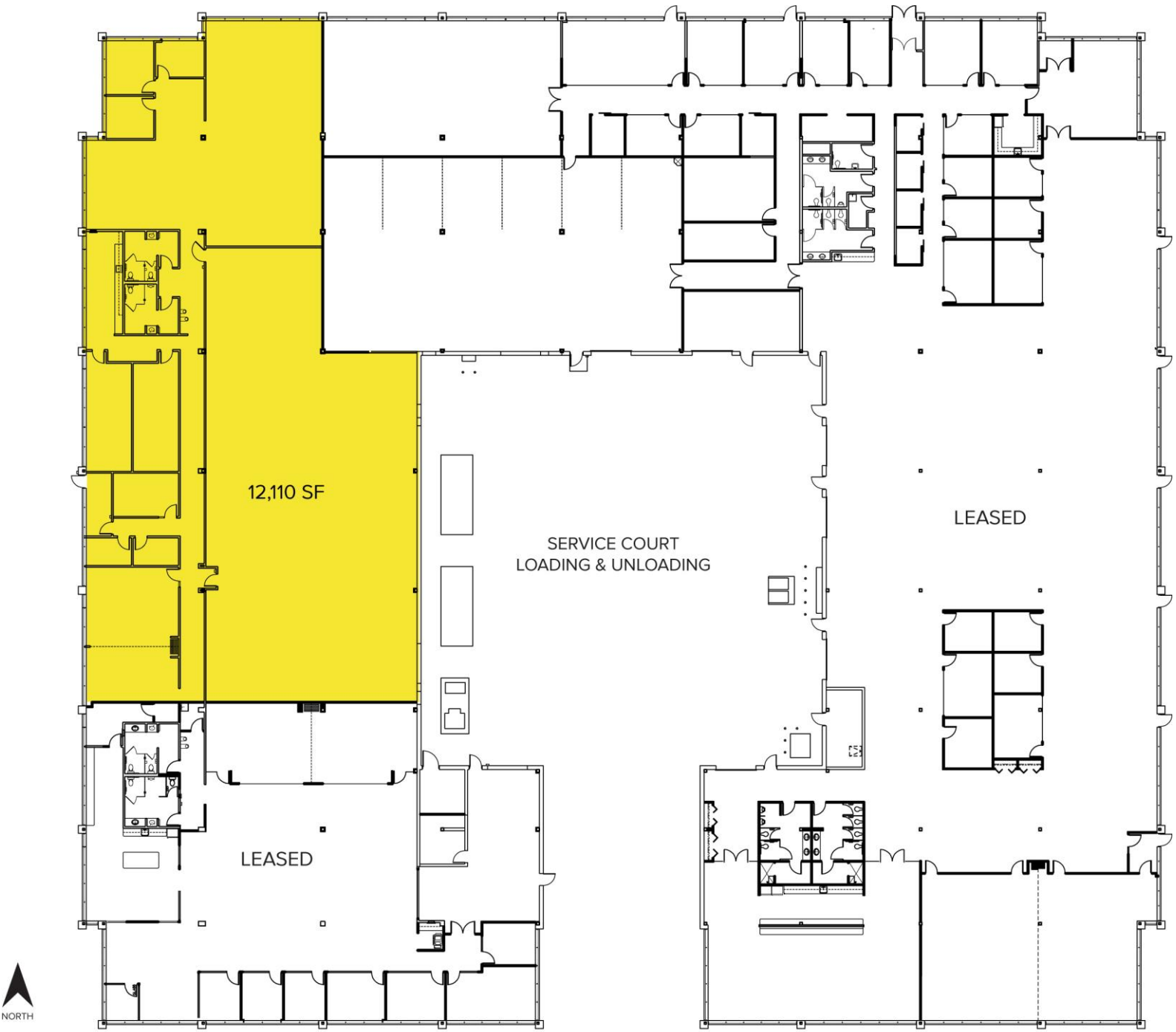

For more information, please contact:

PAUL HOGE
(248) 948 0103
paulhoge@signatureassociates.com

DAVE GREEN
(248) 948 4184
dgreen@signatureassociates.com

SIGNATURE ASSOCIATES
One Towne Square, Suite 1200
Southfield, MI 48076
www.signatureassociates.com

Information is subject to verification and no liability for errors or omissions is assumed. Price is subject to change and listing withdrawal.