

HARLEM

NEW YORK
NY

275 ST. NICHOLAS AVENUE



SPACE DETAILS

LOCATION

Northwest corner of West 124th Street

APPROXIMATE SIZE

Space A	
Ground Floor	1,400 SF*
Lower Level	1,400 SF*
Space B	
Ground Floor	1,900 SF*
Lower Level	1,900 SF*
Total	6,600 SF

**Spaces can be combined*

FRONTAGE

Space A	
20 FT on St. Nicholas Avenue	
51 FT on West 124th Street	
Space B	
11 FT on West 124th Street	
54 FT on Hancock Place	

CEILING HEIGHT

Ground Floor	12 FT 7 IN
--------------	------------

POSSESSION

Immediate

TERM

Negotiable

NEIGHBORS

Chase, Capital One, TD Bank, Duane Reade, Magic Johnson Harlem Theatre, Old Navy, Rainbow, Dollar Tree, Buffalo Wild Wings, Chuck E Cheese, McDonald's, Popeye's, Modell's Sporting Goods, Party City, DSW and Blink Fitness

COMMENTS

Corner location on St. Nicholas Avenue across the street from Harlem USA mall
One block from 125th Street express subway station with 29,000 average daily ridership and 9,335,382 annual ridership

GROUND FLOOR

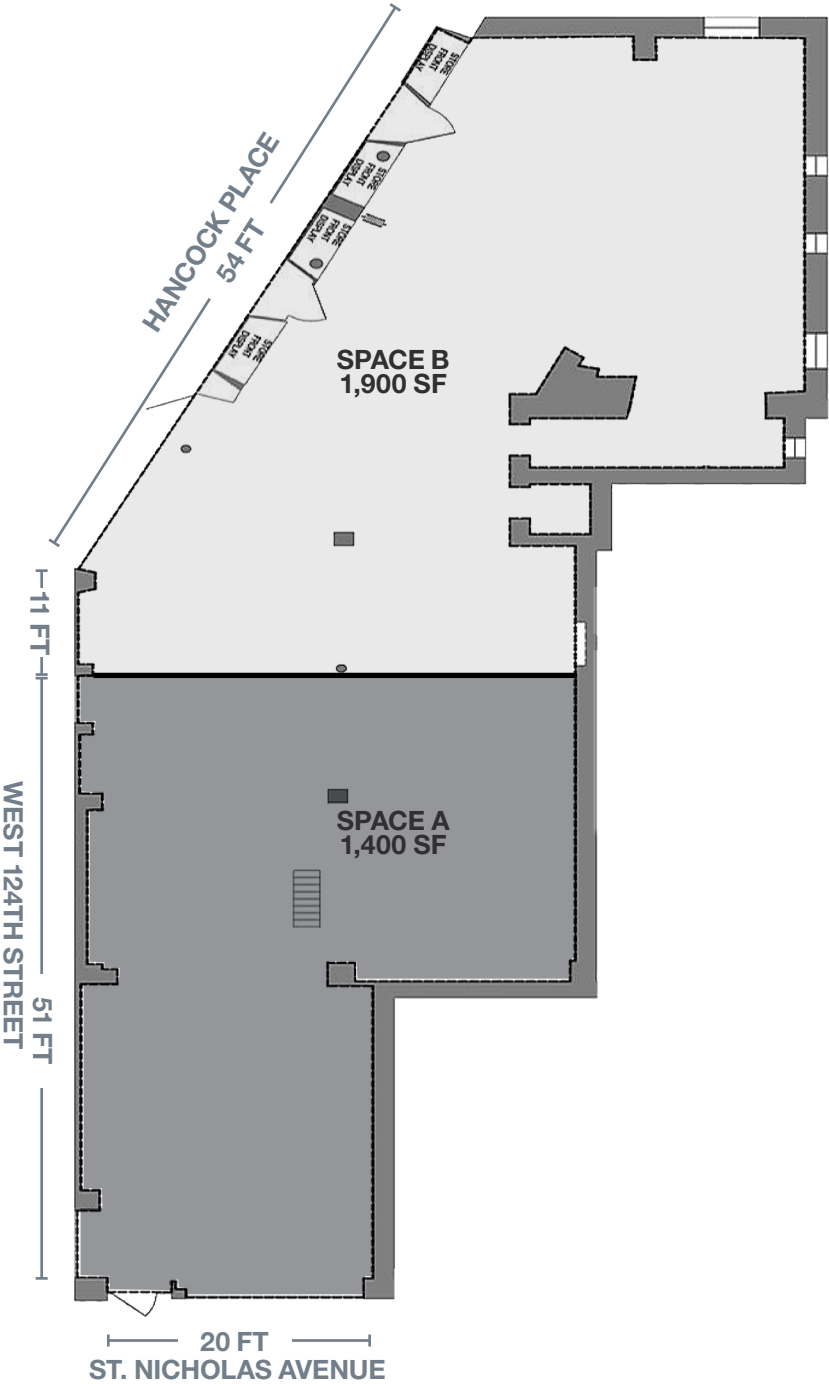

AREA RETAIL



CONTACT

EXCLUSIVE AGENTS

BARRY FISHBACH

212.331.0115

barry.fishbach@ngkf.com

YOUNG KIM

212.351.9355

young.kim@ngkf.com

ARIC TRAKHTENBERG

212.916.3386

aric.trakhtenberg@ngkf.com



NGKF.COM

© 2019 NEWMARK KNIGHT FRANK RETAIL The information contained herein has been obtained from sources deemed reliable but has not been verified and no guarantee, warranty or representation, either express or implied, is made with respect to such information. Terms of sale or lease and availability are subject to change or withdrawal without notice.