

LAND – FOR SALE

**PRICE
REDUCTION**



Property Description

- ±5.15 acres
- The site is on the southwest corner of Louetta and Terranova West Drive
- Signalized corner
- The site is at the entrance to the Terranova West subdivision
- Great site for retail development, bank or restaurant
- Asking \$7.11/sq. ft. (\$1,595,000.00)

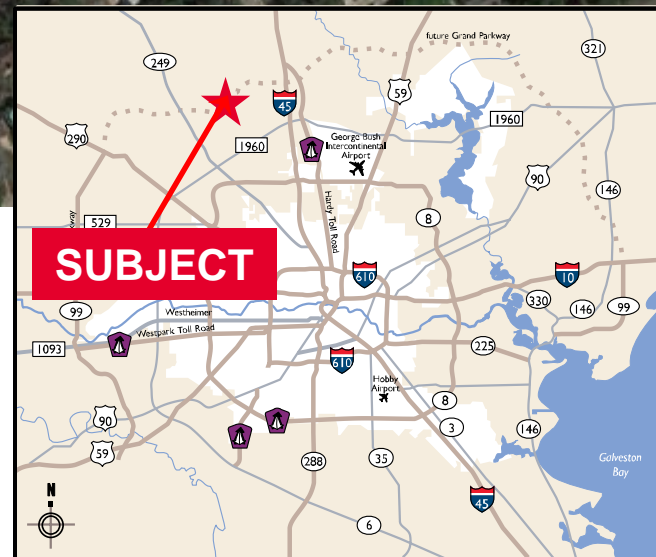

2011 24-Hour Traffic Count

TC Blvd. Jester north of Louetta Road	= 8,940
TC Blvd. Jester south of Louetta Road	= 13,760
Louetta Road west of TC Jester Blvd.	= 31,160
Louetta Road east of TC Jester Blvd.	= 38,370

For more information, contact:

Stephen Schneidau

(713) 963 2822

stephen.schneidau@cushwake.com

om

Cushman & Wakefield, ©2015. No warranty or representation, express or implied, is made to the accuracy or completeness of the information contained herein, and same is submitted subject to errors, omissions, change of price, rental or other conditions, withdrawal without notice, and to any special listing conditions imposed by the property owner(s). As applicable, we make no representation as to the condition of the property (or properties) in question. Cushman & Wakefield of Texas, Inc. – Licensed Real Estate Brokers.

1330 Post Oak Boulevard
Suite 2700
Houston, TX 77056

cushmanwakefield.com