

AVAILABLE SPACE – MADORE BUILDING

Suite 500. Office, approximately 7,883 rentable square feet, featuring private offices, kitchenettes, and easy access to building restrooms. Conveniently located building adjacent to the Pike Hillclimb, centrally located between Pike Place Market and the waterfront.

FLOOR PLAN

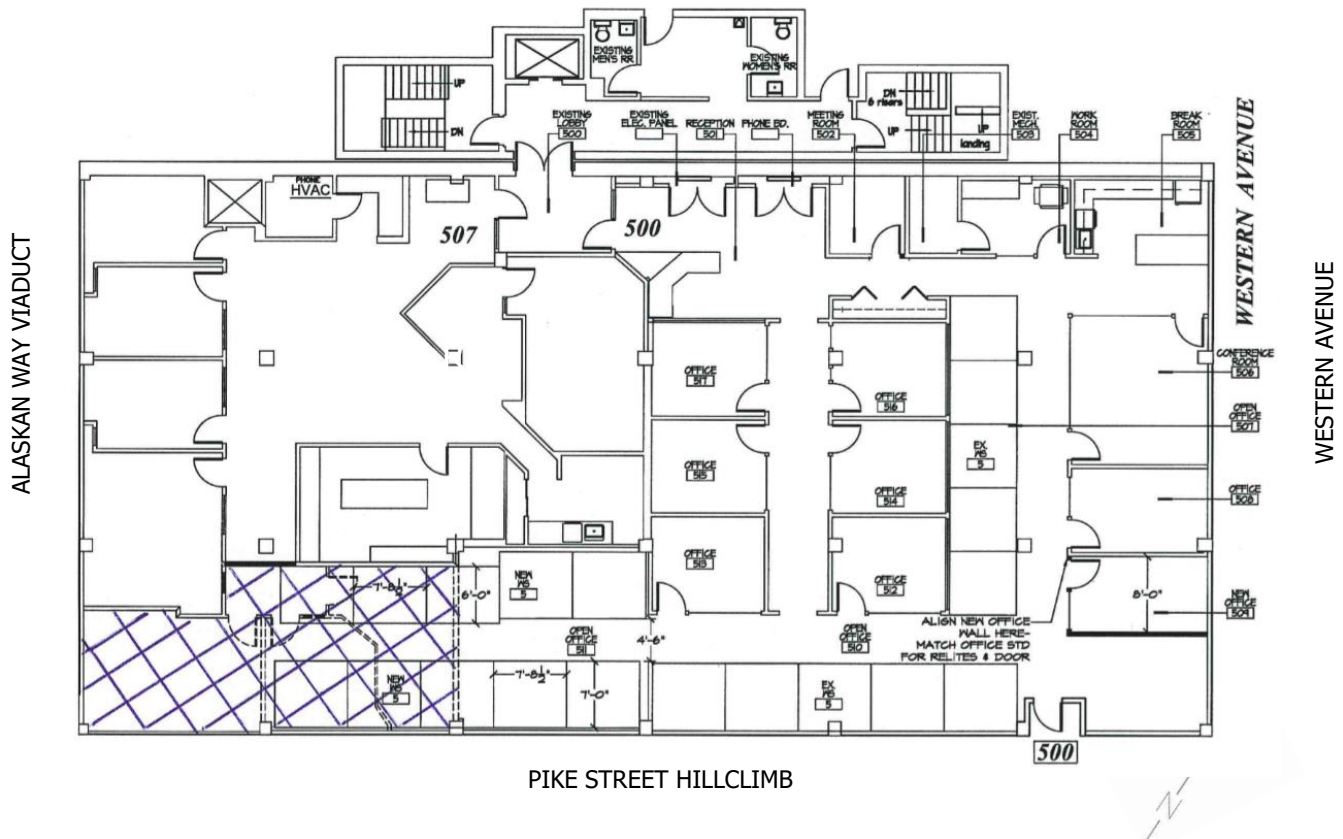

INTERIOR

Photos coming soon

Photos coming soon