



# RIVER'S BEND PROFESSIONAL

210 W. HUNDRED RD  
CHESTER, VA 23836

## SALE OR LEASE!



### NEW PROFESSIONAL OFFICE SPACE ON BUSY W. HUNDRED ROAD CORRIDOR IN CHESTER

#### PROPERTY FEATURES

- ▶ Excellent visibility from busy Route 10 / W. Hundred Road corridor
- ▶ New turn lane from Route 10 for convenient access
- ▶ Professionally-managed professional park by local property management firm
- ▶ High quality construction and landscaping design
- ▶ Excellent access to main interstates in area (I-95 < 3 miles, I-295 < 2 miles)
- ▶ Over 45,000 vehicles per day
- ▶ Ample on-site parking
- ▶ Monument sign planned for additional visibility
- ▶ Rental rates start at \$17.00, NNN

#### PROPERTY SUMMARY

<b>Available Space</b>	<b>2,390 – 7,660 square feet</b>
<b>Total Property Size</b>	7,660 square feet
<b>Total Proposed</b>	Additional 23,000 square feet
<b>Join Tenants</b>	Colonial Orthopaedics, River's Bend Family Dentistry, Southside Regional Physicians, Spine Institute of Virginia, River's Bend Child Care Center
<b>Nearby</b>	Meadowville Technology Park, Amazon, Capital One



#### For more information, contact:

Sean Eichert, (804) 419-2295  
seichert@plusmgt.com, www.plusmgt.com

Plus Management, LLC  
13281 River's Bend Blvd, Suite 201, Chester, VA 23836

# Building Plan

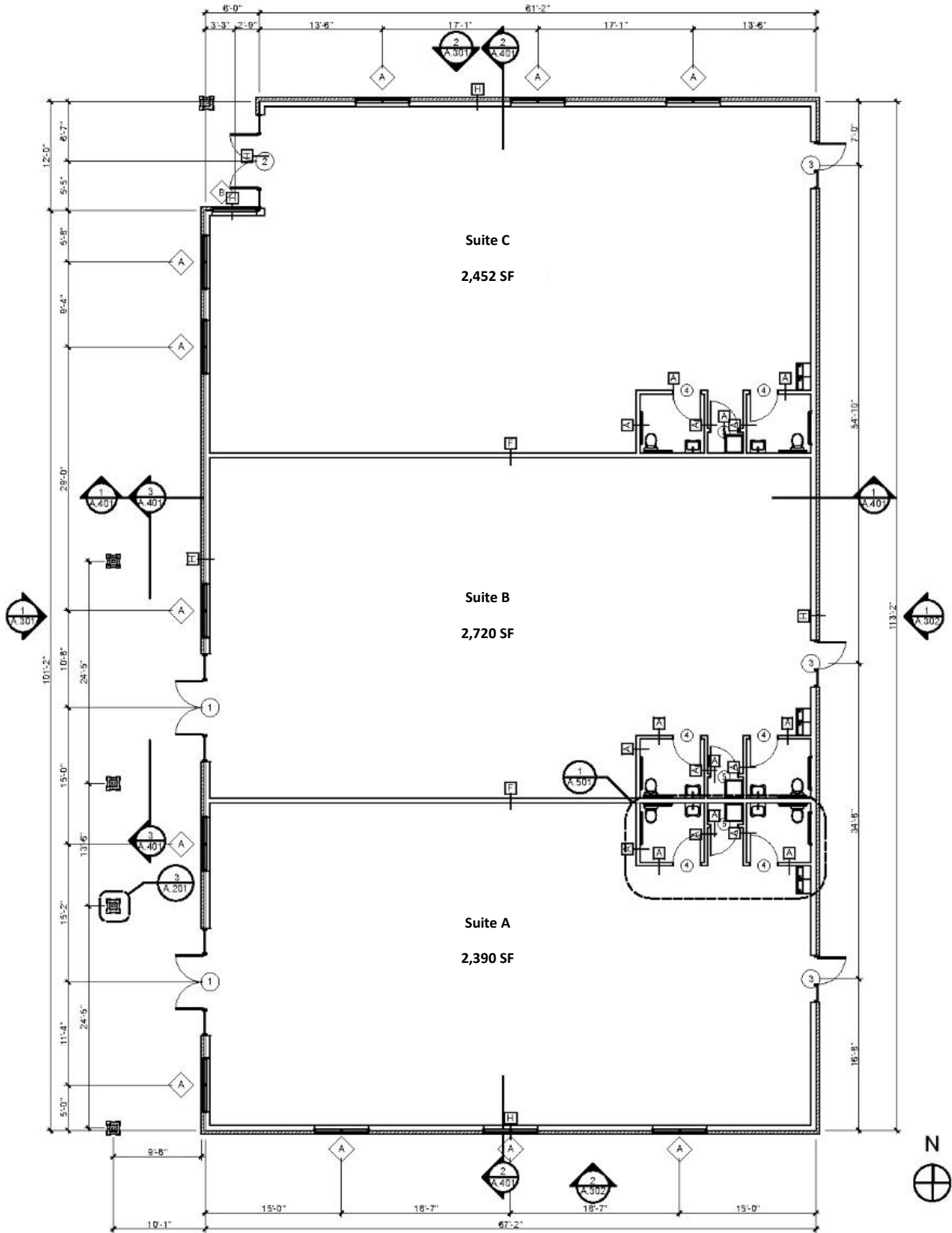

# Site Plan

