

# 15,667 SF

## Industrial Space For Lease



## Prologis Meadowridge

6675 Business Parkway  
Elkridge, MD 21075 USA

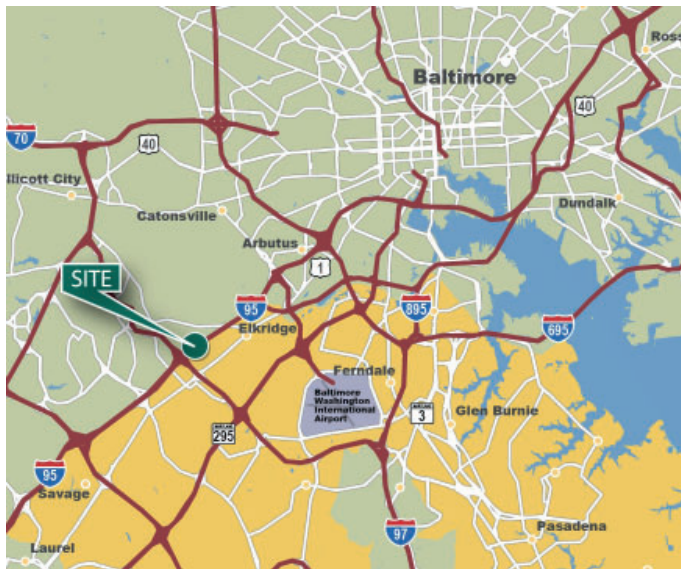

### LOCATION

- Strategic location in Meadowridge Business Park
- Within minutes to I-95, Route 1 and Route 100

### FACILITY

- 15,667 square feet available
- 3,222 square feet of office
- 1 dock door
- 1 drive-in
- 24' clear height
- 40' x 40' column spacing
- Wet sprinkler system
- M-1 zoning
- 277-480v electric service, 1,200 amps

# 15,667 SF

## Industrial Space For Lease

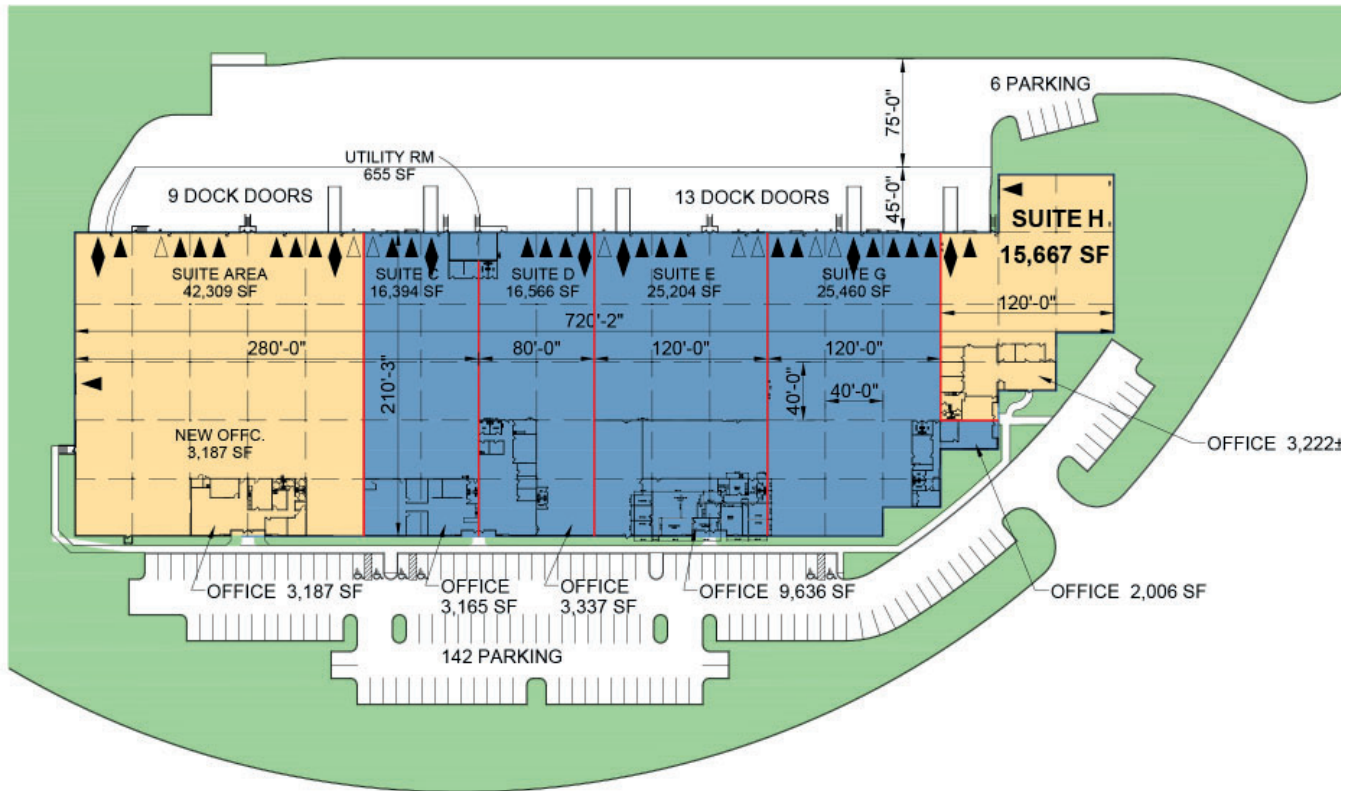

**LEGEND:**

- ▲ DOCK POSITION
- ▲ DOCK POSITION W/LEVELER
- △ FUTURE DOCK POSITION
- ◆ DRIVE-IN DOOR
- LAND
- LEASED AREA
- AVAILABLE AREA



**CBRE, Inc.**  
**Michael Elardo**  
 michael.elardo@cbre.com  
 ph +1 410 244 3128  
 cell +1 410 952 0680  
 100 E. Pratt Street  
 Suite 1700  
 Baltimore, MD 21202 USA

**CBRE, Inc.**  
**Jared Ross**  
 jared.ross@cbre.com  
 ph +1 410 244 3136  
 cell +1 240 994 6477  
 100 E. Pratt Street  
 Suite 1700  
 Baltimore, MD 21202 USA

**CBRE, Inc.**  
**Ed Harris**  
 ed.harris@cbre.com  
 ph +1 410 244 3149  
 cell +1 443 255 3149  
 100 E. Pratt Street  
 Suite 1700  
 Baltimore, MD 21202 USA

**CBRE, Inc.**  
**Mike Roden**  
 mike.roden@cbre.com  
 ph +1 410 244 3125  
 cell +1 410 961 1194  
 100 E. Pratt Street  
 Suite 1700  
 Baltimore, MD 21202 USA

**Prologis**  
**Todd Summerfield**  
 tsummerfield@prologis.com  
 ph +1 410 715 7200  
 cell +1 410 441 1145  
 6711 Columbia Gateway Dr  
 Suite 130  
 Columbia, MD 21045 USA