

SHOP SPACE AVAILABLE

AVAILABILITY

- 1,300 sf former Baskin-Robbins
- 1,307 sf
- 1,339 sf vanilla shell
- 3,571 sf fully built-out medical office

FEATURES

- Anchored by Wal-Mart Supercenter
- Excellent visibility from I-10 Freeway
- Close proximity to Palm Valley, Canyon Trails and Estrella Mountain Ranch Master Planned Communities

NOTABLE TENANTS AT THE INTERSECTION



| 2020 Demographics | 1 MILE | 3 MILE | 5 MILE |
|----------------------|----------|-----------|-----------|
| Estimated Population | 5,944 | 70,500 | 151,459 |
| Ave Household Income | \$98,682 | \$102,443 | \$100,828 |
| Daytime Employment | 3,534 | 20,021 | 33,411 |

James DeCremer
D 480 423 7958
C 602 909 0957
james.decremer@avisonyoung.com

Alec Miller
D 480 423 7955
C 480 531 0369
alec.miller@avisonyoung.com

2720 E Camelback Road
Suite 150
Phoenix, AZ 85016
avisonyoung.com



Available

3,571 sf: fully built-out medical office

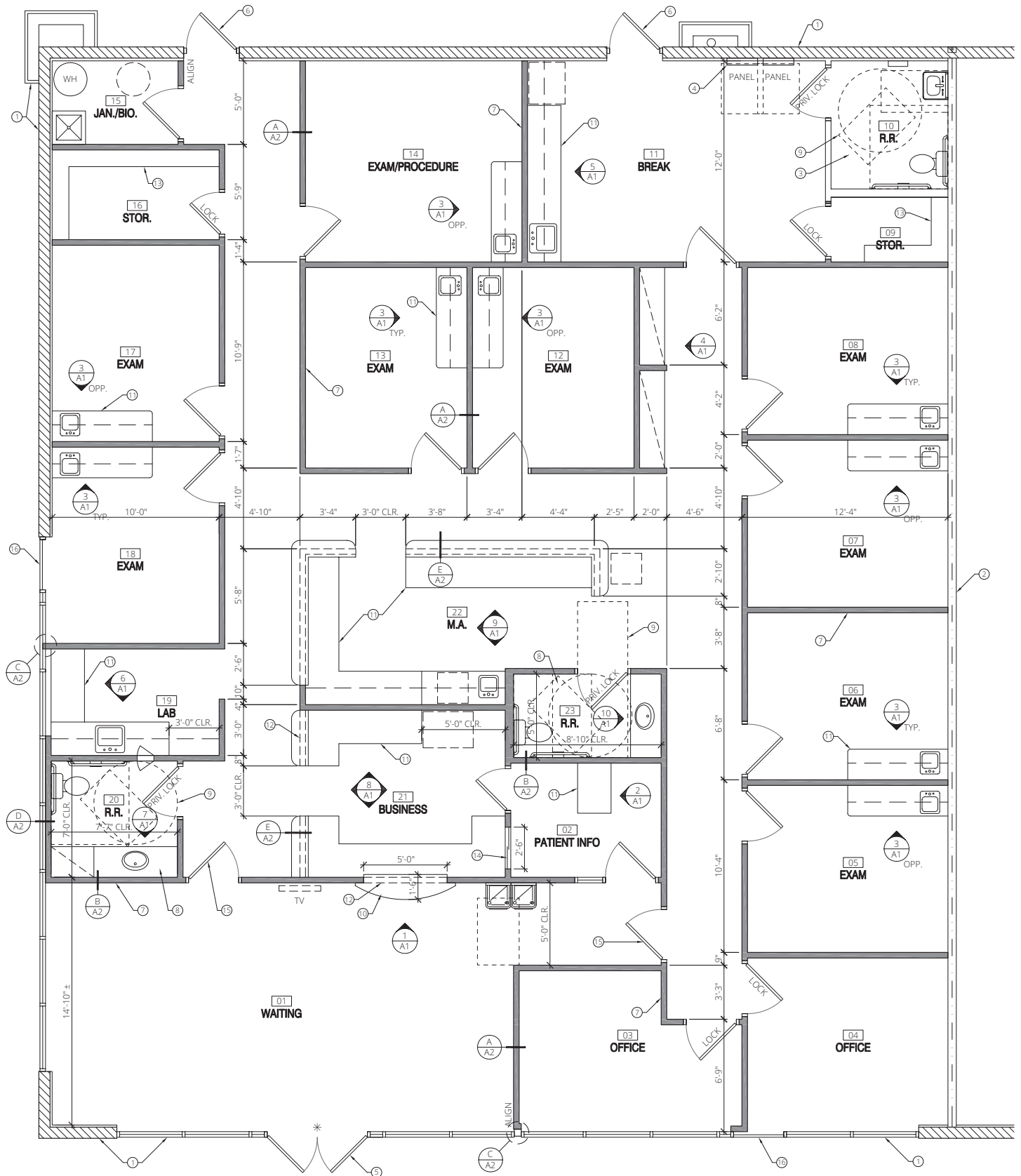



| SWC Estrella Parkway & I-10 Freeway | | | | | | |
|--|--------------------|--------|--------------------|-------|--------------------|-------|
| Goodyear, AZ 85338 | | | | | | |
| | 1 mi radius | | 3 mi radius | | 5 mi radius | |
| Population | | | | | | |
| Estimated Population (2020) | 5,944 | | 70,500 | | 151,459 | |
| Projected Population (2025) | 6,389 | | 76,952 | | 166,360 | |
| Census Population (2010) | 2,547 | | 55,219 | | 120,280 | |
| Census Population (2000) | 110 | | 17,778 | | 45,084 | |
| Projected Annual Growth (2020 to 2025) | 444 | 1.5% | 6,452 | 1.8% | 14,901 | 2.0% |
| Historical Annual Growth (2010 to 2020) | 3,397 | 13.3% | 15,281 | 2.8% | 31,179 | 2.6% |
| Historical Annual Growth (2000 to 2010) | 2,437 | 221.1% | 37,441 | 21.1% | 75,196 | 16.7% |
| Estimated Population Density (2020) | 1,893 psm | | 2,495 psm | | 1,929 psm | |
| Trade Area Size | 3.1 sq mi | | 28.3 sq mi | | 78.5 sq mi | |
| Households | | | | | | |
| Estimated Households (2020) | 2,109 | | 23,658 | | 48,494 | |
| Projected Households (2025) | 2,200 | | 25,093 | | 51,702 | |
| Census Households (2010) | 853 | | 18,546 | | 38,512 | |
| Census Households (2000) | 35 | | 6,349 | | 14,206 | |
| Estimated Households with Children (2020) | 518 | 24.6% | 7,866 | 33.3% | 19,215 | 39.6% |
| Estimated Average Household Size (2020) | 2.82 | | 2.83 | | 3.01 | |
| Average Household Income | | | | | | |
| Estimated Average Household Income (2020) | \$98,682 | | \$102,443 | | \$100,828 | |
| Projected Average Household Income (2025) | \$109,767 | | \$112,129 | | \$110,920 | |
| Estimated Average Family Income (2020) | \$104,026 | | \$112,059 | | \$110,419 | |
| Median Household Income | | | | | | |
| Estimated Median Household Income (2020) | \$92,153 | | \$85,221 | | \$81,701 | |
| Projected Median Household Income (2025) | \$110,048 | | \$100,852 | | \$96,460 | |
| Estimated Median Family Income (2020) | \$106,791 | | \$95,440 | | \$91,368 | |
| Per Capita Income | | | | | | |
| Estimated Per Capita Income (2020) | \$35,013 | | \$35,183 | | \$32,878 | |
| Projected Per Capita Income (2025) | \$37,804 | | \$37,301 | | \$35,014 | |
| Estimated Per Capita Income 5 Year Growth | \$2,791 | 8.0% | \$2,118 | 6.0% | \$2,136 | 6.5% |
| Estimated Average Household Net Worth (2020) | \$1,140,462 | | \$1,000,779 | | \$939,669 | |
| Daytime Demos (2020) | | | | | | |
| Total Businesses | 316 | | 2,028 | | 3,481 | |
| Total Employees | 3,534 | | 20,021 | | 33,411 | |
| Company Headquarter Businesses | - | - | 3 | 0.1% | 5 | 0.1% |
| Company Headquarter Employees | - | - | 832 | 4.2% | 968 | 2.9% |
| Employee Population per Business | 11.2 | | 9.9 | | 9.6 | |
| Residential Population per Business | 18.8 | | 34.8 | | 43.5 | |

| SWC Estrella Parkway & I-10 Freeway | | | | | | |
|---|--------------------|--------|--------------------|-------|--------------------|-------|
| Goodyear, AZ 85338 | | | | | | |
| | 1 mi radius | | 3 mi radius | | 5 mi radius | |
| Race & Ethnicity | | | | | | |
| White (2020) | 4,253 | 71.6% | 48,406 | 68.7% | 98,193 | 64.8% |
| Black or African American (2020) | 497 | 8.4% | 5,628 | 8.0% | 13,409 | 8.9% |
| American Indian or Alaska Native (2020) | 48 | 0.8% | 798 | 1.1% | 1,886 | 1.2% |
| Asian (2020) | 243 | 4.1% | 3,739 | 5.3% | 7,673 | 5.1% |
| Hawaiian or Pacific Islander (2020) | 7 | 0.1% | 119 | 0.2% | 336 | 0.2% |
| Other Race (2020) | 682 | 11.5% | 8,973 | 12.7% | 23,601 | 15.6% |
| Two or More Races (2020) | 214 | 3.6% | 2,836 | 4.0% | 6,361 | 4.2% |
| Not Hispanic or Latino Population (2020) | 4,453 | 74.9% | 49,674 | 70.5% | 98,578 | 65.1% |
| Hispanic or Latino Population (2020) | 1,491 | 25.1% | 20,826 | 29.5% | 52,880 | 34.9% |
| Not Hispanic or Latino Population (2025) | 4,725 | 74.0% | 53,586 | 69.6% | 107,083 | 64.4% |
| Hispanic or Latino Population (2025) | 1,663 | 26.0% | 23,366 | 30.4% | 59,277 | 35.6% |
| Not Hispanic or Latino Population (2010) | 1,667 | 65.4% | 38,043 | 68.9% | 75,659 | 62.9% |
| Hispanic or Latino Population (2010) | 880 | 34.6% | 17,176 | 31.1% | 44,621 | 37.1% |
| Not Hispanic or Latino Population (2000) | 88 | 79.4% | 12,886 | 72.5% | 29,059 | 64.5% |
| Hispanic or Latino Population (2000) | 23 | 20.6% | 4,892 | 27.5% | 16,025 | 35.5% |
| Projected Hispanic Annual Growth (2020 to 2025) | 172 | 2.3% | 2,540 | 2.4% | 6,396 | 2.4% |
| Historic Hispanic Annual Growth (2000 to 2020) | 1,468 | 323.5% | 15,934 | 16.3% | 36,855 | 11.5% |
| Age Distribution (2020) | | | | | | |
| Age Under 5 | 318 | 5.3% | 4,099 | 5.8% | 9,919 | 6.5% |
| Age 5 to 9 Years | 324 | 5.4% | 4,417 | 6.3% | 10,598 | 7.0% |
| Age 10 to 14 Years | 347 | 5.8% | 4,589 | 6.5% | 10,919 | 7.2% |
| Age 15 to 19 Years | 278 | 4.7% | 4,586 | 6.5% | 10,658 | 7.0% |
| Age 20 to 24 Years | 294 | 5.0% | 4,306 | 6.1% | 10,161 | 6.7% |
| Age 25 to 29 Years | 357 | 6.0% | 4,789 | 6.8% | 11,284 | 7.5% |
| Age 30 to 34 Years | 372 | 6.3% | 5,087 | 7.2% | 11,722 | 7.7% |
| Age 35 to 39 Years | 336 | 5.7% | 4,912 | 7.0% | 11,210 | 7.4% |
| Age 40 to 44 Years | 288 | 4.8% | 4,339 | 6.2% | 10,022 | 6.6% |
| Age 45 to 49 Years | 252 | 4.2% | 3,940 | 5.6% | 9,011 | 5.9% |
| Age 50 to 54 Years | 256 | 4.3% | 3,660 | 5.2% | 8,289 | 5.5% |
| Age 55 to 59 Years | 320 | 5.4% | 3,783 | 5.4% | 7,980 | 5.3% |
| Age 60 to 64 Years | 501 | 8.4% | 4,508 | 6.4% | 8,160 | 5.4% |
| Age 65 to 74 Years | 1,159 | 19.5% | 8,804 | 12.5% | 13,894 | 9.2% |
| Age 75 to 84 Years | 454 | 7.6% | 3,755 | 5.3% | 5,976 | 3.9% |
| Age 85 Years or Over | 89 | 1.5% | 927 | 1.3% | 1,656 | 1.1% |
| Median Age | 42.7 | | 37.9 | | 34.8 | |
| Gender Age Distribution (2020) | | | | | | |
| Female Population | 3,096 | 52.1% | 37,403 | 53.1% | 79,069 | 52.2% |
| Age 0 to 19 Years | 638 | 20.6% | 8,895 | 23.8% | 20,933 | 26.5% |
| Age 20 to 64 Years | 1,610 | 52.0% | 21,515 | 57.5% | 46,803 | 59.2% |
| Age 65 Years or Over | 848 | 27.4% | 6,993 | 18.7% | 11,332 | 14.3% |
| Female Median Age | 42.9 | | 38.1 | | 35.2 | |
| Male Population | 2,848 | 47.9% | 33,097 | 46.9% | 72,390 | 47.8% |
| Age 0 to 19 Years | 628 | 22.0% | 8,796 | 26.6% | 21,161 | 29.2% |
| Age 20 to 64 Years | 1,366 | 48.0% | 17,808 | 53.8% | 41,035 | 56.7% |
| Age 65 Years or Over | 854 | 30.0% | 6,493 | 19.6% | 10,194 | 14.1% |
| Male Median Age | 42.4 | | 37.7 | | 34.4 | |

| SWC Estrella Parkway & I-10 Freeway | | 1 mi radius | | 3 mi radius | | 5 mi radius | |
|--|-------|--------------------|--------|--------------------|---------|--------------------|--|
| Goodyear, AZ 85338 | | | | | | | |
| Household Income Distribution (2020) | | | | | | | |
| HH Income \$200,000 or More | 233 | 11.1% | 2,127 | 9.0% | 3,948 | 8.1% | |
| HH Income \$150,000 to \$199,999 | 182 | 8.6% | 1,911 | 8.1% | 3,760 | 7.8% | |
| HH Income \$100,000 to \$149,999 | 513 | 24.3% | 5,218 | 22.1% | 9,966 | 20.6% | |
| HH Income \$75,000 to \$99,999 | 310 | 14.7% | 3,864 | 16.3% | 8,091 | 16.7% | |
| HH Income \$50,000 to \$74,999 | 410 | 19.5% | 4,448 | 18.8% | 9,248 | 19.1% | |
| HH Income \$35,000 to \$49,999 | 143 | 6.8% | 2,297 | 9.7% | 5,135 | 10.6% | |
| HH Income \$25,000 to \$34,999 | 82 | 3.9% | 1,362 | 5.8% | 3,103 | 6.4% | |
| HH Income \$15,000 to \$24,999 | 115 | 5.4% | 953 | 4.0% | 2,110 | 4.4% | |
| HH Income Under \$15,000 | 121 | 5.7% | 1,478 | 6.2% | 3,132 | 6.5% | |
| HH Income \$35,000 or More | 1,792 | 85.0% | 19,865 | 84.0% | 40,149 | 82.8% | |
| HH Income \$75,000 or More | 1,238 | 58.7% | 13,120 | 55.5% | 25,765 | 53.1% | |
| Housing (2020) | | | | | | | |
| Total Housing Units | 2,283 | | 25,730 | | 52,234 | | |
| Housing Units Occupied | 2,109 | 92.4% | 23,658 | 91.9% | 48,494 | 92.8% | |
| Housing Units Owner-Occupied | 1,520 | 72.1% | 17,200 | 72.7% | 33,412 | 68.9% | |
| Housing Units, Renter-Occupied | 589 | 27.9% | 6,459 | 27.3% | 15,082 | 31.1% | |
| Housing Units, Vacant | 174 | 8.2% | 2,072 | 8.8% | 3,740 | 7.7% | |
| Marital Status (2020) | | | | | | | |
| Never Married | 1,392 | 28.1% | 16,909 | 29.5% | 38,841 | 32.4% | |
| Currently Married | 2,805 | 56.6% | 29,598 | 51.6% | 57,299 | 47.7% | |
| Separated | 166 | 3.3% | 2,807 | 4.9% | 6,063 | 5.1% | |
| Widowed | 304 | 6.1% | 2,829 | 4.9% | 5,344 | 4.5% | |
| Divorced | 289 | 5.8% | 5,251 | 9.1% | 12,476 | 10.4% | |
| Household Type (2020) | | | | | | | |
| Population Family | 5,369 | 90.3% | 59,756 | 84.8% | 130,387 | 86.1% | |
| Population Non-Family | 575 | 9.7% | 7,265 | 10.3% | 15,577 | 10.3% | |
| Population Group Quarters | - | - | 3,479 | 4.9% | 5,495 | 3.6% | |
| Family Households | 1,708 | 81.0% | 18,266 | 77.2% | 37,398 | 77.1% | |
| Non-Family Households | 401 | 19.0% | 5,392 | 22.8% | 11,096 | 22.9% | |
| Married Couple with Children | 325 | 11.6% | 5,274 | 17.8% | 12,712 | 22.2% | |
| Average Family Household Size | 3.1 | | 3.3 | | 3.5 | | |
| Household Size (2020) | | | | | | | |
| 1 Person Households | 272 | 12.9% | 4,118 | 17.4% | 8,085 | 16.7% | |
| 2 Person Households | 1,005 | 47.7% | 9,206 | 38.9% | 16,046 | 33.1% | |
| 3 Person Households | 308 | 14.6% | 3,508 | 14.8% | 7,844 | 16.2% | |
| 4 Person Households | 260 | 12.3% | 3,511 | 14.8% | 8,070 | 16.6% | |
| 5 Person Households | 149 | 7.1% | 1,917 | 8.1% | 4,673 | 9.6% | |
| 6 or More Person Households | 114 | 5.4% | 1,398 | 5.9% | 3,775 | 7.8% | |
| Household Vehicles (2020) | | | | | | | |
| Households with 0 Vehicles Available | 90 | 4.2% | 761 | 3.2% | 1,790 | 3.7% | |
| Households with 1 Vehicles Available | 683 | 32.4% | 7,266 | 30.7% | 13,516 | 27.9% | |
| Households with 2 or More Vehicles Available | 1,336 | 63.4% | 15,632 | 66.1% | 33,188 | 68.4% | |
| Total Vehicles Available | 3,871 | | 46,404 | | 97,701 | | |
| Average Vehicles Per Household | 1.8 | | 2.0 | | 2.0 | | |

SWC Estrella Parkway & I-10 Freeway**Goodyear, AZ 85338**

1 mi radius

3 mi radius

5 mi radius

Labor Force (2020)

| | | | | | | |
|---|-------|-------|--------|-------|---------|-------|
| Estimated Labor Population Age 16 Years or Over | 4,892 | | 56,453 | | 117,878 | |
| Estimated Civilian Employed | 2,917 | 59.6% | 29,484 | 52.2% | 67,492 | 57.3% |
| Estimated Civilian Unemployed | 197 | 4.0% | 2,258 | 4.0% | 4,708 | 4.0% |
| Estimated in Armed Forces | 13 | 0.3% | 511 | 0.9% | 869 | 0.7% |
| Estimated Not in Labor Force | 1,766 | 36.1% | 24,199 | 42.9% | 44,809 | 38.0% |
| Unemployment Rate | 4.0% | | 4.0% | | 4.0% | |

Occupation (2020)

| | | | | | | |
|---|-------|-------|--------|-------|--------|-------|
| Occupation: Population Age 16 Years or Over | 2,917 | | 29,484 | | 67,492 | |
| Management, Business, Financial Operations | 586 | 20.1% | 5,124 | 17.4% | 10,585 | 15.7% |
| Professional, Related | 720 | 24.7% | 6,541 | 22.2% | 13,994 | 20.7% |
| Service | 421 | 14.4% | 4,935 | 16.7% | 11,871 | 17.6% |
| Sales, Office | 700 | 24.0% | 6,811 | 23.1% | 16,658 | 24.7% |
| Farming, Fishing, Forestry | 3 | - | 64 | 0.2% | 240 | 0.4% |
| Construct, Extraction, Maintenance | 154 | 5.3% | 2,060 | 7.0% | 4,975 | 7.4% |
| Production, Transport Material Moving | 334 | 11.4% | 3,949 | 13.4% | 9,168 | 13.6% |
| White Collar Workers | 2,005 | 68.8% | 18,476 | 62.7% | 41,237 | 61.1% |
| Blue Collar Workers | 911 | 31.2% | 11,009 | 37.3% | 26,255 | 38.9% |

Consumer Expenditure (2020)

| | | | | | | |
|------------------------------|------------|-------|------------|-------|------------|-------|
| Total Household Expenditure | \$147.34 M | | \$1.69 B | | \$3.41 B | |
| Total Non-Retail Expenditure | \$77.74 M | 52.8% | \$889.92 M | 52.6% | \$1.8 B | 52.6% |
| Total Retail Expenditure | \$69.61 M | 47.2% | \$800.91 M | 47.4% | \$1.62 B | 47.4% |
| Apparel | \$5.2 M | 3.5% | \$59.9 M | 3.5% | \$121.48 M | 3.6% |
| Contributions | \$5.01 M | 3.4% | \$55.99 M | 3.3% | \$111.52 M | 3.3% |
| Education | \$4.59 M | 3.1% | \$51.45 M | 3.0% | \$103.53 M | 3.0% |
| Entertainment | \$8.48 M | 5.8% | \$96.86 M | 5.7% | \$195.03 M | 5.7% |
| Food and Beverages | \$21.52 M | 14.6% | \$248.48 M | 14.7% | \$503.33 M | 14.7% |
| Furnishings and Equipment | \$5.28 M | 3.6% | \$60.21 M | 3.6% | \$121.09 M | 3.5% |
| Gifts | \$3.82 M | 2.6% | \$42.17 M | 2.5% | \$84.01 M | 2.5% |
| Health Care | \$12.47 M | 8.5% | \$142.52 M | 8.4% | \$286.13 M | 8.4% |
| Household Operations | \$5.87 M | 4.0% | \$66.73 M | 3.9% | \$134.08 M | 3.9% |
| Miscellaneous Expenses | \$2.8 M | 1.9% | \$31.99 M | 1.9% | \$64.33 M | 1.9% |
| Personal Care | \$1.98 M | 1.3% | \$22.74 M | 1.3% | \$45.84 M | 1.3% |
| Personal Insurance | \$1.09 M | 0.7% | \$12.25 M | 0.7% | \$24.48 M | 0.7% |
| Reading | \$327.32 K | 0.2% | \$3.7 M | 0.2% | \$7.4 M | 0.2% |
| Shelter | \$30.66 M | 20.8% | \$353.03 M | 20.9% | \$715.07 M | 20.9% |
| Tobacco | \$814.05 K | 0.6% | \$9.67 M | 0.6% | \$19.84 M | 0.6% |
| Transportation | \$26.88 M | 18.2% | \$310.47 M | 18.4% | \$628.1 M | 18.4% |
| Utilities | \$10.56 M | 7.2% | \$122.68 M | 7.3% | \$248.76 M | 7.3% |

Educational Attainment (2020)

| | | | | | | |
|--|-------|-------|--------|-------|--------|-------|
| Adult Population Age 25 Years or Over | 4,384 | | 48,503 | | 99,203 | |
| Elementary (Grade Level 0 to 8) | 126 | 2.9% | 1,621 | 3.3% | 4,248 | 4.3% |
| Some High School (Grade Level 9 to 11) | 177 | 4.0% | 2,325 | 4.8% | 6,291 | 6.3% |
| High School Graduate | 873 | 19.9% | 10,834 | 22.3% | 22,793 | 23.0% |
| Some College | 1,283 | 29.3% | 13,894 | 28.6% | 27,902 | 28.1% |
| Associate Degree Only | 374 | 8.5% | 4,577 | 9.4% | 9,904 | 10.0% |
| Bachelor Degree Only | 1,003 | 22.9% | 9,327 | 19.2% | 17,437 | 17.6% |
| Graduate Degree | 548 | 12.5% | 5,924 | 12.2% | 10,628 | 10.7% |

SWC Estrella Parkway & I-10 Freeway**Goodyear, AZ 85338****1 mi radius****3 mi radius****5 mi radius****Units In Structure (2020)**

| | | | | | | |
|------------------------|-------|--------|--------|--------|--------|-------|
| 1 Detached Unit | 1,810 | 212.3% | 19,608 | 105.7% | 38,447 | 99.8% |
| 1 Attached Unit | 17 | 1.9% | 493 | 2.7% | 978 | 2.5% |
| 2 to 4 Units | 17 | 1.9% | 601 | 3.2% | 1,307 | 3.4% |
| 5 to 9 Units | 48 | 5.7% | 655 | 3.5% | 1,520 | 3.9% |
| 10 to 19 Units | 34 | 4.0% | 233 | 1.3% | 990 | 2.6% |
| 20 to 49 Units | 21 | 2.5% | 271 | 1.5% | 565 | 1.5% |
| 50 or More Units | 151 | 17.7% | 1,412 | 7.6% | 2,825 | 7.3% |
| Mobile Home or Trailer | 10 | 1.2% | 366 | 2.0% | 1,818 | 4.7% |
| Other Structure | - | - | 19 | 0.1% | 43 | 0.1% |

Homes Built By Year (2020)

| | | | | | | |
|---------------------------|-------|--------|--------|-------|--------|-------|
| Homes Built 2010 or later | 533 | 62.6% | 3,115 | 16.8% | 5,206 | 13.5% |
| Homes Built 2000 to 2009 | 1,149 | 134.7% | 11,947 | 64.4% | 23,851 | 61.9% |
| Homes Built 1990 to 1999 | 193 | 22.6% | 3,853 | 20.8% | 8,469 | 22.0% |
| Homes Built 1980 to 1989 | 140 | 16.5% | 1,547 | 8.3% | 3,620 | 9.4% |
| Homes Built 1970 to 1979 | 36 | 4.2% | 1,513 | 8.2% | 3,620 | 9.4% |
| Homes Built 1960 to 1969 | 31 | 3.7% | 800 | 4.3% | 1,870 | 4.9% |
| Homes Built 1950 to 1959 | 18 | 2.1% | 556 | 3.0% | 1,155 | 3.0% |
| Homes Built Before 1949 | 10 | 1.1% | 327 | 1.8% | 703 | 1.8% |

Home Values (2020)

| | | | | | | |
|------------------------------------|-----------|-------|-----------|-------|-----------|-------|
| Home Values \$1,000,000 or More | 3 | 0.2% | 42 | 0.2% | 106 | 0.3% |
| Home Values \$500,000 to \$999,999 | 198 | 13.0% | 1,231 | 7.2% | 2,231 | 6.7% |
| Home Values \$400,000 to \$499,999 | 257 | 16.9% | 2,024 | 11.8% | 3,276 | 9.8% |
| Home Values \$300,000 to \$399,999 | 285 | 18.8% | 4,673 | 27.2% | 7,051 | 21.1% |
| Home Values \$200,000 to \$299,999 | 489 | 32.2% | 5,962 | 34.7% | 12,660 | 37.9% |
| Home Values \$150,000 to \$199,999 | 180 | 11.8% | 2,028 | 11.8% | 4,848 | 14.5% |
| Home Values \$100,000 to \$149,999 | 51 | 3.3% | 712 | 4.1% | 1,607 | 4.8% |
| Home Values \$70,000 to \$99,999 | 4 | 0.3% | 142 | 0.8% | 383 | 1.1% |
| Home Values \$50,000 to \$69,999 | 14 | 0.9% | 79 | 0.5% | 182 | 0.5% |
| Home Values \$25,000 to \$49,999 | 2 | 0.1% | 43 | 0.3% | 230 | 0.7% |
| Home Values Under \$25,000 | 32 | 2.1% | 220 | 1.3% | 729 | 2.2% |
| Owner-Occupied Median Home Value | \$280,109 | | \$283,669 | | \$265,667 | |
| Renter-Occupied Median Rent | \$1,060 | | \$1,026 | | \$1,001 | |

Transportation To Work (2020)

| | | | | | | |
|---|-------|-------|--------|-------|--------|-------|
| Drive to Work Alone | 1,960 | 69.7% | 24,995 | 75.7% | 54,709 | 77.2% |
| Drive to Work in Carpool | 498 | 17.7% | 3,888 | 11.8% | 8,143 | 11.5% |
| Travel to Work by Public Transportation | 90 | 3.2% | 360 | 1.1% | 795 | 1.1% |
| Drive to Work on Motorcycle | 13 | 0.5% | 96 | 0.3% | 195 | 0.3% |
| Walk or Bicycle to Work | 32 | 1.1% | 409 | 1.2% | 934 | 1.3% |
| Other Means | 74 | 2.6% | 559 | 1.7% | 955 | 1.3% |
| Work at Home | 146 | 5.2% | 2,733 | 8.3% | 5,146 | 7.3% |

Travel Time (2020)

| | | | | | | |
|--------------------------------------|------|-------|-------|-------|--------|-------|
| Travel to Work in 14 Minutes or Less | 822 | 29.2% | 5,643 | 17.1% | 12,121 | 17.1% |
| Travel to Work in 15 to 29 Minutes | 826 | 29.4% | 9,738 | 29.5% | 22,874 | 32.3% |
| Travel to Work in 30 to 59 Minutes | 814 | 28.9% | 8,958 | 27.1% | 21,267 | 30.0% |
| Travel to Work in 60 Minutes or More | 303 | 10.8% | 2,922 | 8.8% | 6,465 | 9.1% |
| Average Minutes Travel to Work | 25.3 | | 24.3 | | 24.7 | |