



# For Lease

## **Aldarra Corporate Park**

- 170,302 SF shell & 10,360 SF office
- Available November 1, 2019
- Stand-alone building
- North truck court fenced and secured
- 24' clear height
- 56 dock-high doors / 2 grade-level doors
- Call agents for pricing

21318 64th Ave S  
Kent, WA

**Chris Spofford**

+1 206 607 1731

[Chris.Spofford@am.jll.com](mailto:Chris.Spofford@am.jll.com)

**David Cahill**

+1 425 974 4002

[David.Cahill@am.jll.com](mailto:David.Cahill@am.jll.com)

Jones Lang LaSalle Brokerage, Inc.



# For Lease

Aldarra Corporate Park | 170,302 SF

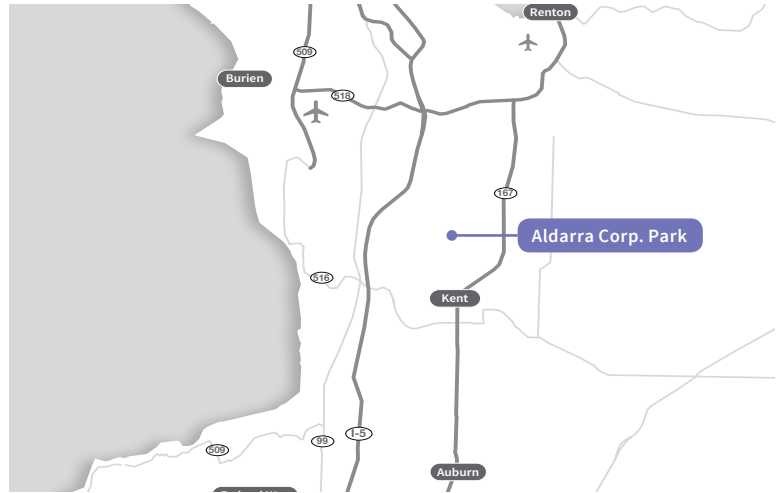

## Site Plan

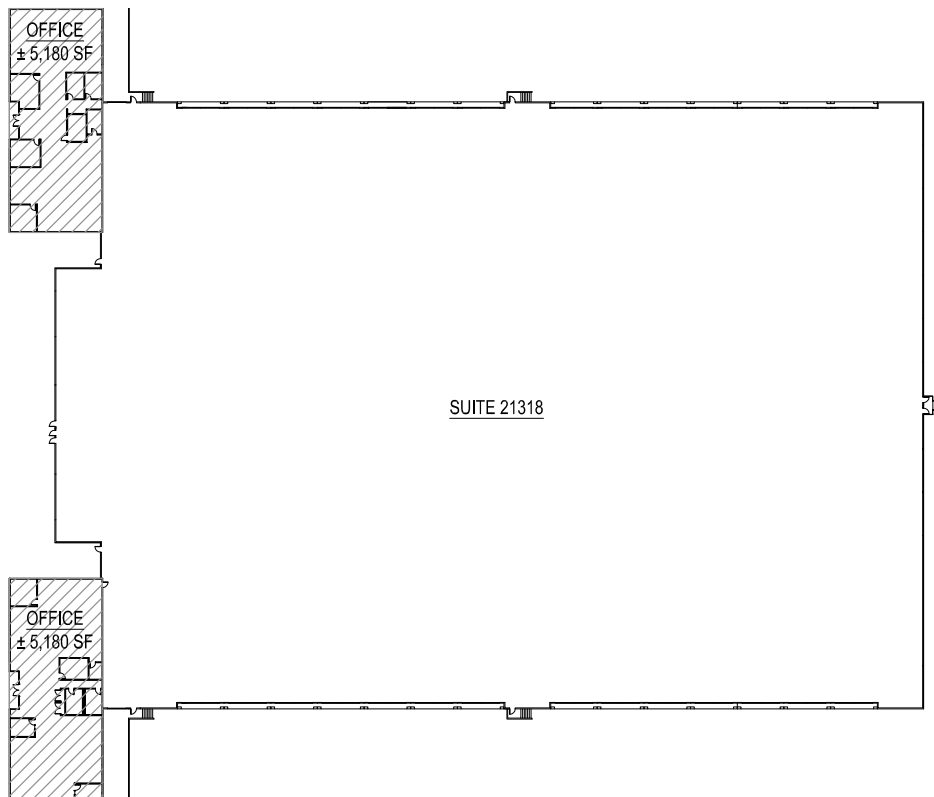

### DISCLAIMER

Although information has been obtained from sources deemed reliable, Owner, Jones Lang LaSalle, and/or their representatives, brokers or agents make no guarantees as to the accuracy of the information contained herein, and offer the Property without express or implied warranties of any kind. The Property may be withdrawn without notice. If the recipient of this information has signed a confidentiality agreement regarding this matter, this information is subject to the terms of that agreement. ©2019. Jones Lang LaSalle. All rights reserved.

