



Property Features

- 1,300 Square Feet
- Former AT&T space
- Located directly across the street from Walmart and Lowes
- Property is adjacent to Farm Fresh grocery store anchored shopping center
- Signalized intersection
- 29,000 VPD
- Excellent visibility and access

Demographics

	1 Mile	3 Miles	5 Miles
Population	3,841	34,781	42,278
Avg. HH Income	\$67,942	\$51,419	\$54,352

Join Tenants/Nearby Retailers

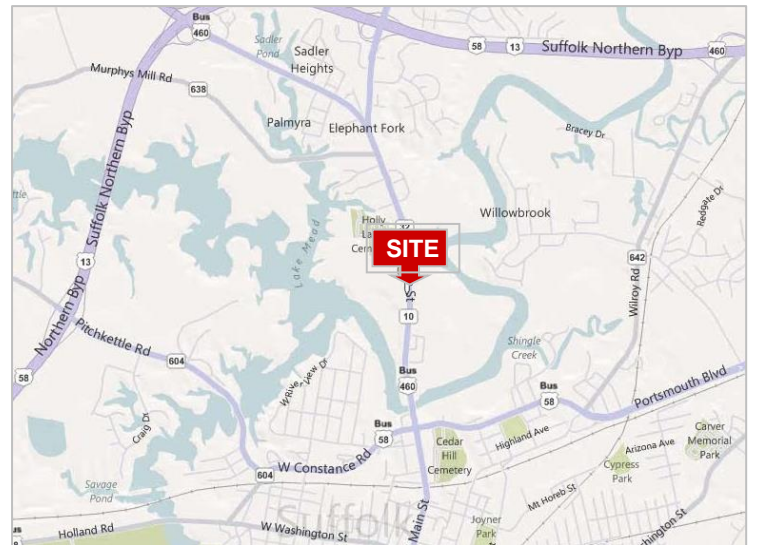
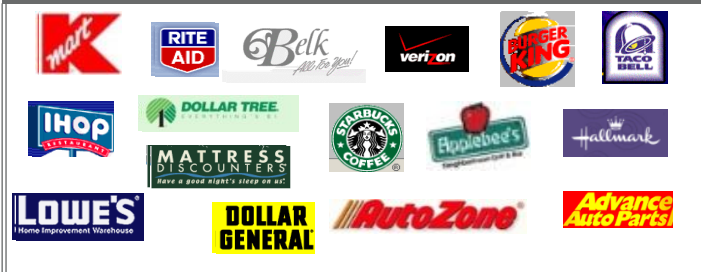

For more information, contact:

TED LEVIN
 Vice President
 757 499 4279
ted.levin@thalhimer.com

The Town Center of Virginia Beach
 222 Central Park Ave., Suite 1820
 Virginia Beach, VA 23462
www.thalhimer.com

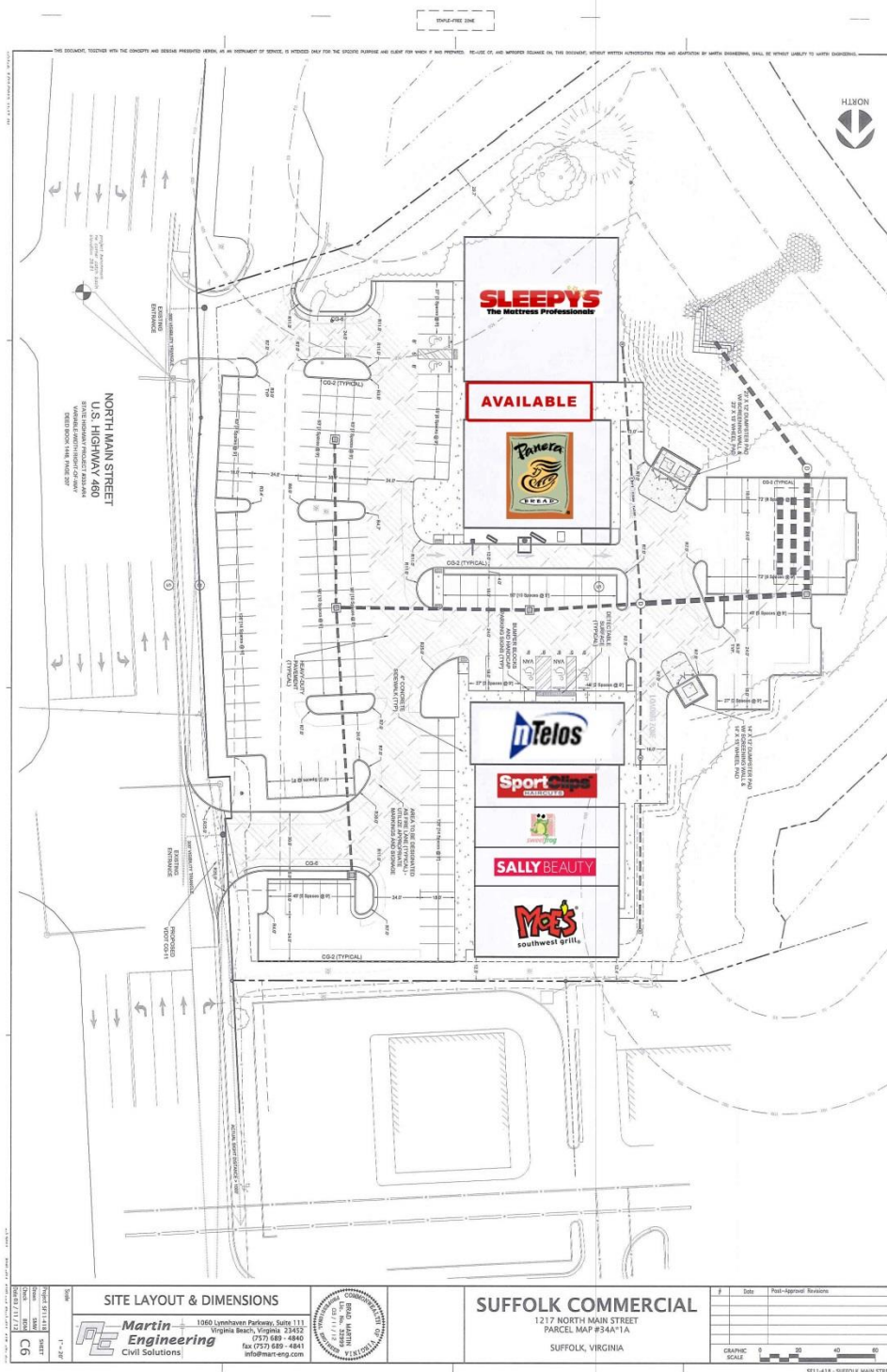

For more information, contact:

TED LEVIN
 Vice President
 757 499 4279
ted.levin@thalhimer.com

The Town Center of Virginia Beach
 222 Central Park Ave., Suite 1820
 Virginia Beach, VA 23462
www.thalhimer.com

Independently Owned and Operated / A Member of the Cushman & Wakefield Alliance

Cushman & Wakefield | Thalhimer © 2015. No warranty or representation, express or implied, is made to the accuracy or completeness of the information contained herein, and same is submitted subject to errors, omissions, change of price, rental or other conditions, withdrawal without notice, and to any special listing conditions imposed by the property owner(s). As applicable, we make no representation as to the condition of the property (or properties) in question.



For more information, contact:

TED LEVIN
Vice President
757 499 4279
ted.levin@thalhimer.com

The Town Center of Virginia Beach
222 Central Park Ave., Suite 1820
Virginia Beach, VA 23462
www.thalhimer.com

Independently Owned and Operated / A Member of the Cushman & Wakefield Alliance

Cushman & Wakefield | Thalhimer © 2015. No warranty or representation, express or implied, is made to the accuracy or completeness of the information contained herein, and same is submitted subject to errors, omissions, change of price, rental or other conditions, withdrawal without notice, and to any special listing conditions imposed by the property owner(s). As applicable, we make no representation as to the condition of the property (or properties) in question.