



Office Space for Lease

**724 OAK GROVE AVENUE
MENLO PARK, CA**

Area

Suite 100: ±3,000 SF Available

Rental Rate: \$4.50 / SF NNN (Op Ex \$2.30 / SF /Mo)

Property Highlights

- Excellent Downtown Menlo Park Location
- Large Glass Conference Room
- Extensive Windowline
- Short Walk to Restaurants, Retail and Caltrain
- Reserved Parking & Adjacent to City Parking Lots
- Call Agent to Tour or click [Link to Video Tour](#)

Location

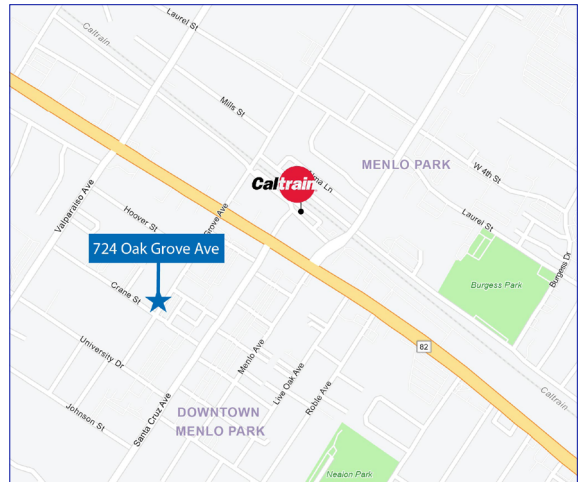

For information, please contact:

Juan de Leon

Director

t 415-305-6275

Juan.deLeon@nmrk.com

CA RE License #01383120

[nmrk.com](#)

NEWMARK

The distributor of this communication is performing acts for which a real estate license is required. The information contained herein has been obtained from sources deemed reliable but has not been verified and no guarantee, warranty or representation, either express or implied, is made with respect to such information. Terms of sale or lease and availability are subject to change or withdrawal without notice 18-1274.



For information, please contact:

Juan de Leon

Director

t 415-305-6275

Juan.deLeon@nmrk.com

CA RE License #01383120

nmrk.com

NEWMARK

The distributor of this communication is performing acts for which a real estate license is required. The information contained herein has been obtained from sources deemed reliable but has not been verified and no guarantee, warranty or representation, either express or implied, is made with respect to such information. Terms of sale or lease and availability are subject to change or withdrawal without notice 18-1274.

Floor Plan- Suite 100

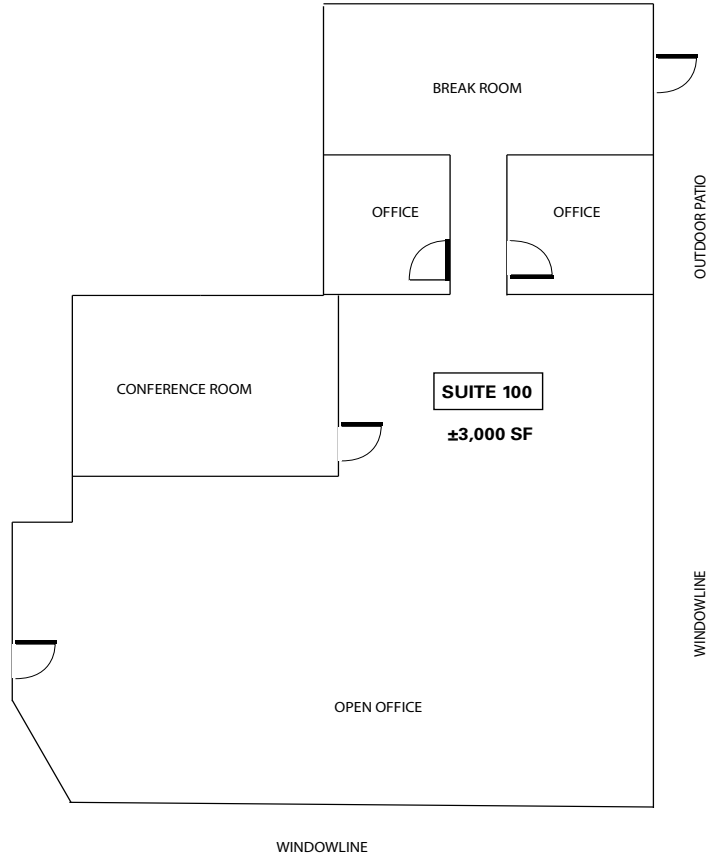
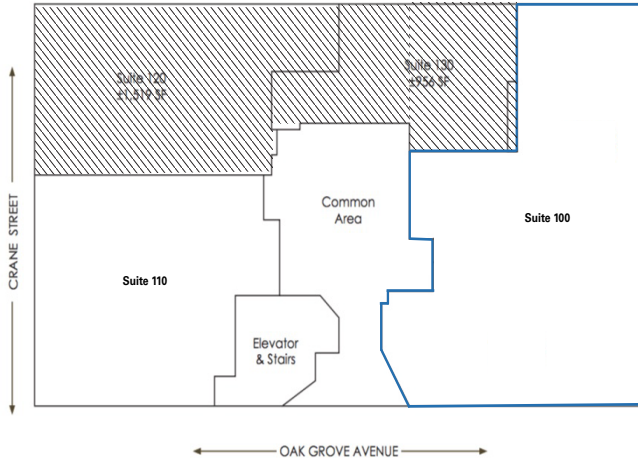

For information, please contact:

Juan de Leon

Director

t 415-305-6275

Juan.deLeon@nrmk.com

CA RE License #01383120

nrmk.com

NEWMARK

The distributor of this communication is performing acts for which a real estate license is required. The information contained herein has been obtained from sources deemed reliable but has not been verified and no guarantee, warranty or representation, either express or implied, is made with respect to such information. Terms of sale or lease and availability are subject to change or withdrawal without notice 18-1274.

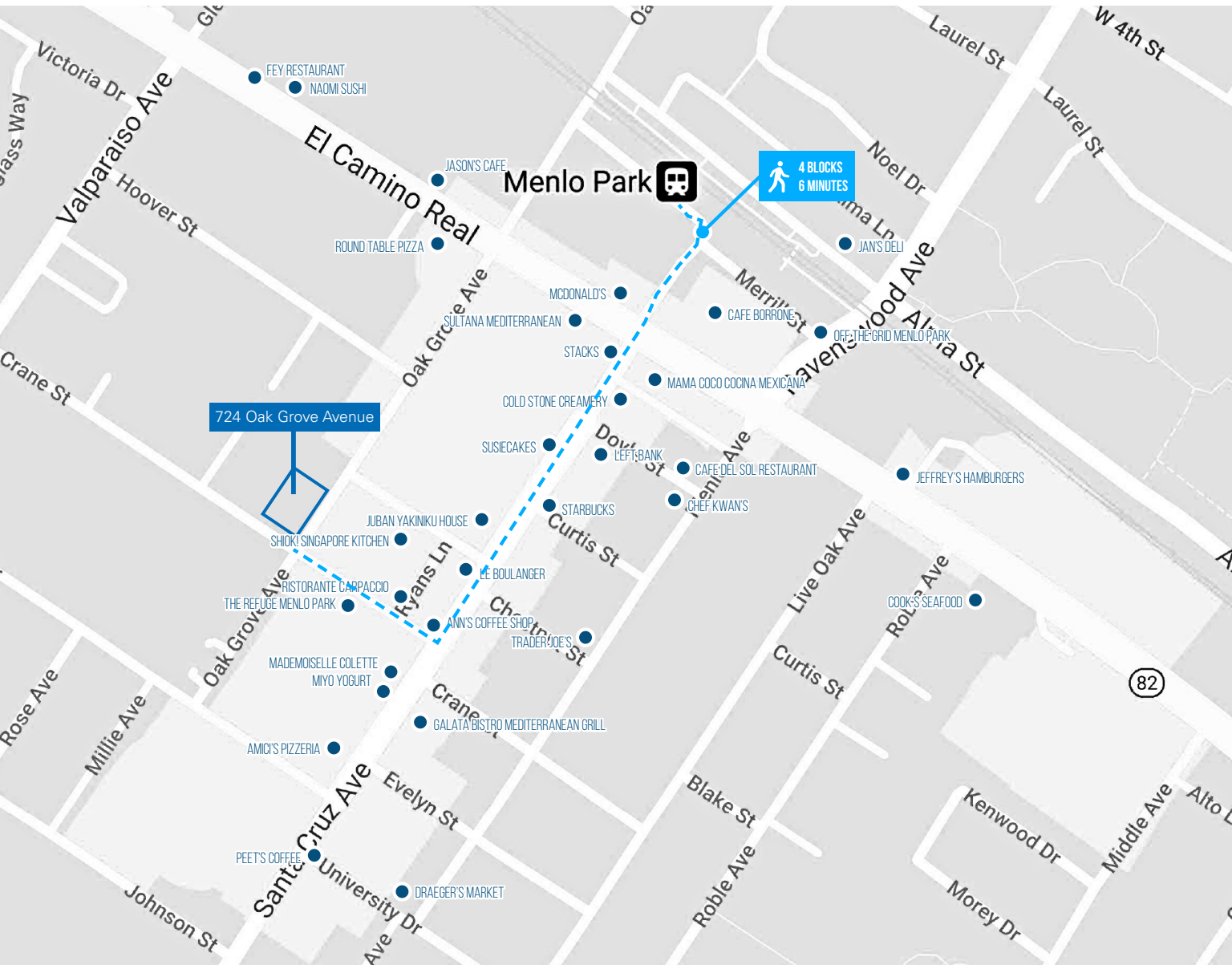

For information, please contact:

Juan de Leon

Director

t 415-305-6275

Juan.deLeon@nmrk.com

CA RE License #01383120

nmrk.com

NEWMARK

The distributor of this communication is performing acts for which a real estate license is required. The information contained herein has been obtained from sources deemed reliable but has not been verified and no guarantee, warranty or representation, either express or implied, is made with respect to such information. Terms of sale or lease and availability are subject to change or withdrawal without notice 18-1274.



AMENITIES

1. Celia's
2. Gombei Japanese
3. Oak + Violet
4. Fey
5. Naomi Sushi
6. Round Table Pizza
7. McDonald's
8. Sultana Mediterranean
9. Stacks
10. Cafe Borrone
11. Jeffrey's Hamburgers
12. Cold Stone Creamery
13. Cafe del Sol
14. Left Bank
15. Susie Cakes
16. Walgreens
17. Starbucks
18. Menlo Park Hardware
19. Juban Yakinuki House
20. Bank of the West
21. Trader Joe's
22. Le Boulanger
23. Shiok! Singapore Kitchen
24. The Refuge
25. Ristorante Carpaccio
26. Ann's Coffee Shop
27. Wells Fargo Bank
28. Mademoiselle Colette
29. Galata Bistro
30. Mediterranean Grill
31. Fleet Feet
32. Amici's East Coast Pizzeria
32. Draeger's Market

For information, please contact:

Juan de Leon

Director

t 415-305-6275

Juan.deLeon@nmrk.com

CA RE License #01383120

nmrk.com

NEWMARK

The distributor of this communication is performing acts for which a real estate license is required. The information contained herein has been obtained from sources deemed reliable but has not been verified and no guarantee, warranty or representation, either express or implied, is made with respect to such information. Terms of sale or lease and availability are subject to change or withdrawal without notice 18-1274.