



MCLEAN HILTON

OFFICE BUILDING

7918 JONES BRANCH DRIVE
MCLEAN, VIRGINIA

| | |
|------------------------------|-----------------------|
| SUITE 400: 12,415 SF* | AVAILABLE IMMEDIATELY |
| SUITE 430: 4,510 SF* | AVAILABLE IMMEDIATELY |
| SUITE 750: 8,392 SF | AVAILABLE 7/1/2020 |

***CONTIGUOUS:** 16,925 SF

ALAN ASMAN
703-749-9464
alan.asman@transwestern.com

BERNIE MCKEEVER
703-749-9483
bernie.mckeever@transwestern.com

BERNIE MCKEEVER, JR.
703-749-9462
bernard.mckeever@transwestern.com

4TH FLOOR

CONTIGUOUS: 16,925 SF

SUITE 430: 4,510 SF

AVAILABLE IMMEDIATELY

(FURNITURE FOR ILLUSTRATION
PURPOSES ONLY)

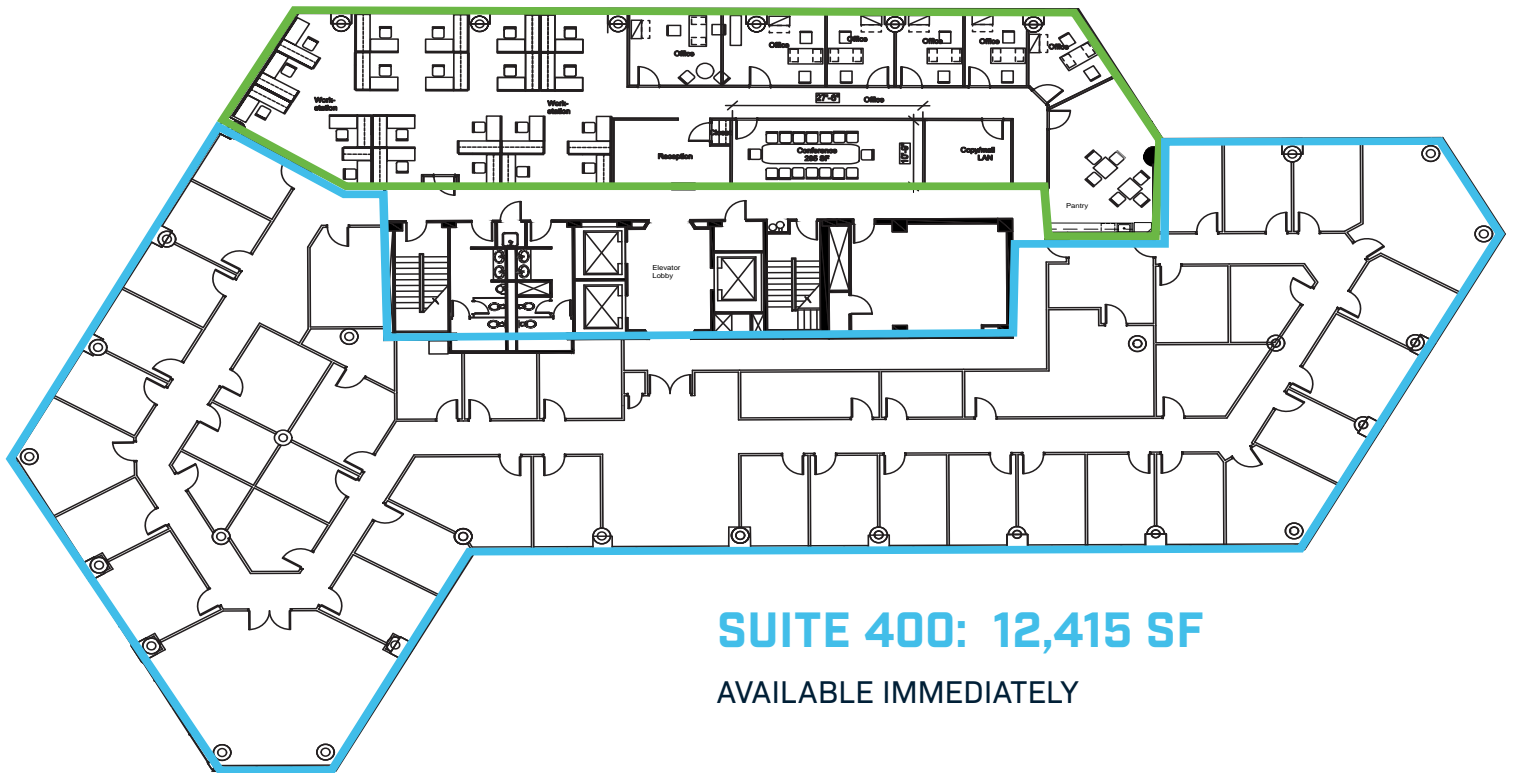

SUITE 400: 12,415 SF

AVAILABLE IMMEDIATELY

7TH FLOOR



SUITE 750: 8,392 SF

AVAILABLE 7/1/2020

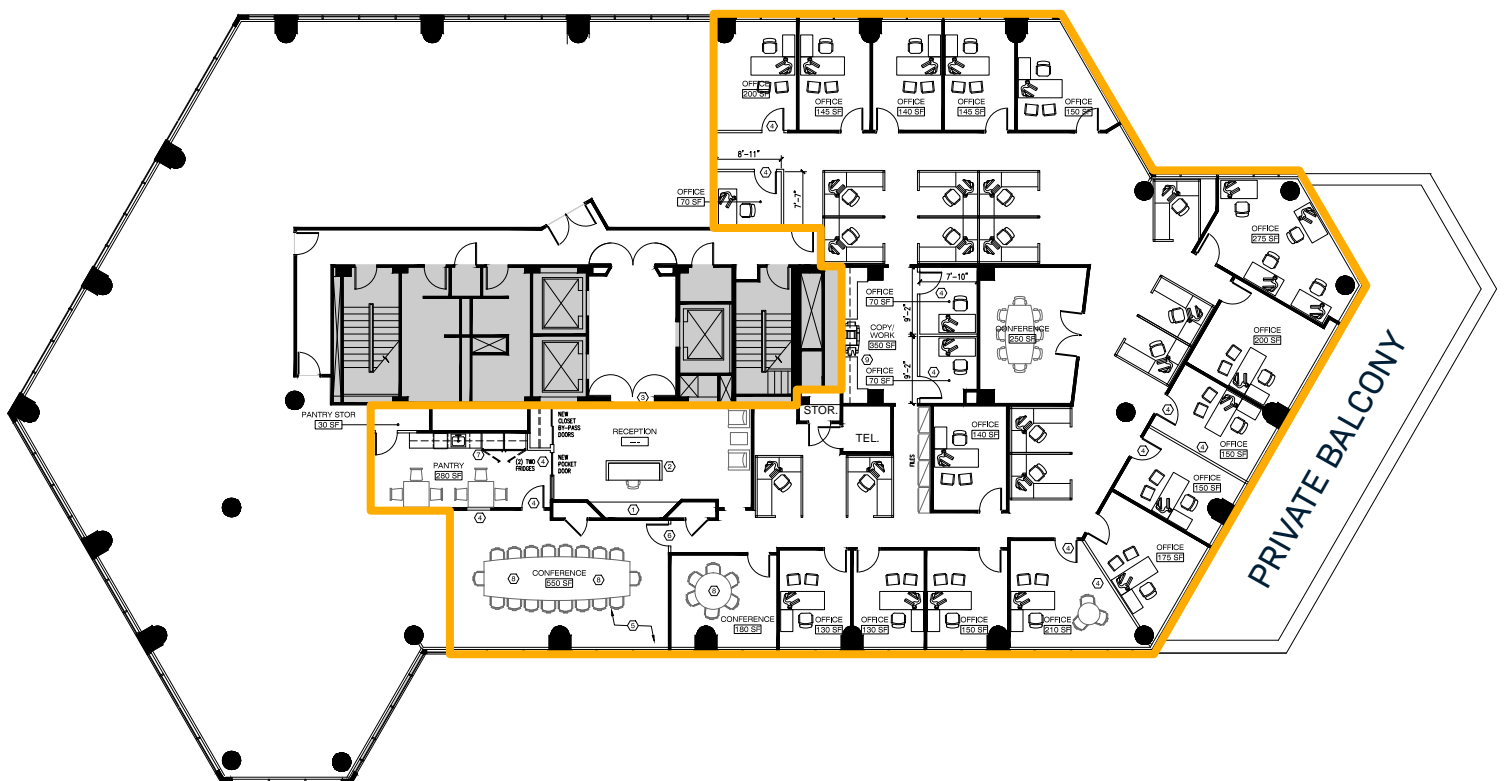
- DOUBLE DOOR ELEVATOR LOBBY ENTRANCE
- MULTIPLE CONFERENCE ROOMS
- PANTRY
- ACCESSIBLE PRIVATE BALCONY



FEATURES & AMENITIES

- Adjacent to 495 Jones Branch Dr.  Entrance/Exit and near completion, overpass for Route 
- Adjacent to McLean Hilton
- Kim's Newstand (within building)
- Abundant Covered and Surface Parking
- Responsive on-site management
- Walking distance to new dining hub Social, a collection of six upscale quick-service eateries and a standalone coffee bar
- Directly across from Republik Coffee Bar

THE NEARBY JONES BRANCH CONNECTOR IS NOW OPEN!

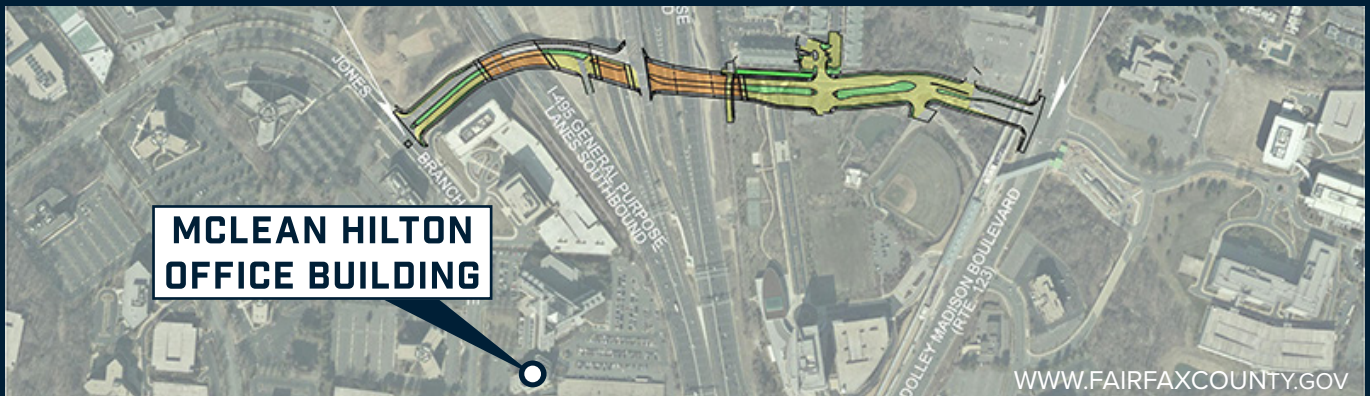

LOCATION MAP

Half a mile to Tysons Corner Metro & Tysons Corner Mall

Easy access to Dulles Toll Road and 66 East





7900 Tysons One Place
Suite 600
McLean, Virginia 22102
703.821.0040
www.transwestern.com

Alan Asman
703.749.9464
alan.asman@transwestern.com

Bernie McKeever
703.749.9483
bernie.mckeever@transwestern.com

Bernie McKeever, Jr.
703.749.9462
bernard.mckeever@transwestern.com