

GREAT LAKES CENTER

FOR LEASE

HIGHLAND VILLAGE, TEXAS (CITY OF DOUBLE OAK)

JUSTIN RD, 1/3 MILE WEST OF FM 2499

MICHAEL WILSON

AMANDA THROCKMORTON



Front Elevation

LEASING | TENANT REPRESENTATION | LAND | INVESTMENT SALES | PROPERTY MANAGEMENT



Lake Lewisville



HIGHLIGHTS

- New construction
- Super-regional retail traffic, adjacent to Highland Village Centers
- Visibility close to roadway
- New housing starts continue at heavy pace

GREAT LAKES CENTER

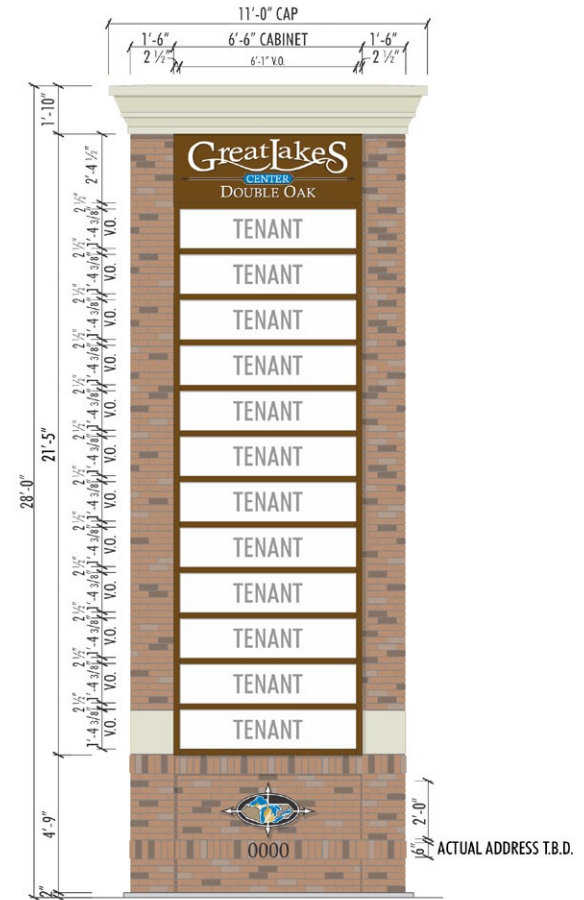
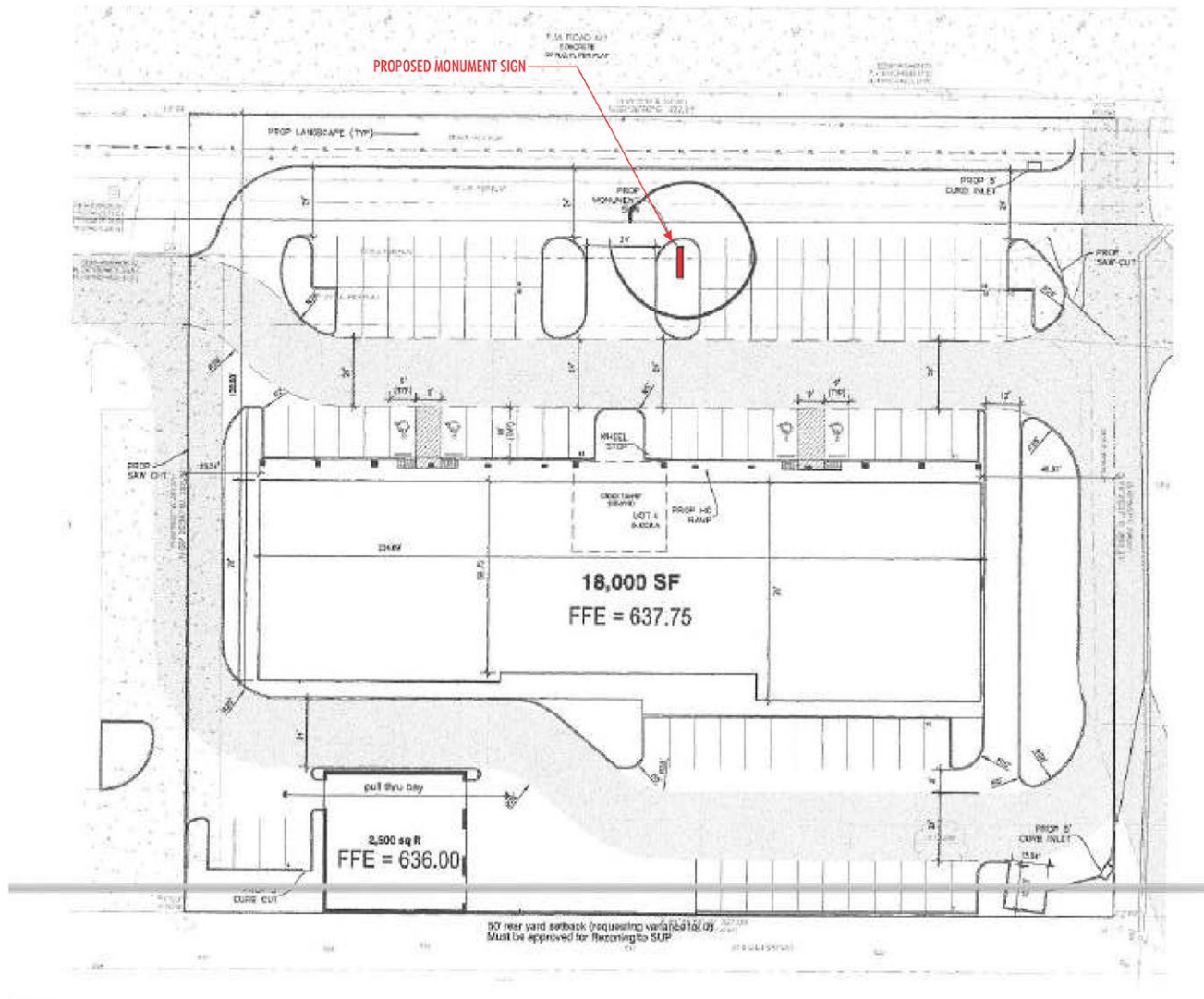

DOUBLE-FACE MULTI-TENANT PYLON SIGN (1 REQUIRED)
SCALE: 1/4" = 1'-0"

21'-5" x 6'-6" = 139.2 SQ. FT.

PROPOSED MONUMENT SIGN

DEMOGRAPHICS	1 MILE	3 MILE	5 MILE	TRAFFIC COUNTS	
2016 EST POPULATION	5,472	68,131	166,670	JUSTIN RD (FM 407)	24,917 VPD (TXDOT 2014)
2016 EST AVG HH INCOME	\$161,573	\$152,934	\$130,427	FM 2499	31,564 VPD (TXDOT 2014)

